



Country / City Slovenia / Ljubljana
University / School University of Ljubljana / Biotehna faculty
Academic year 2016 - 2017
Title of the project Green Corridors Connecting People with Nature for Eternity
Authors Maruša Čiča, Nika Pirc, Lara Rus, Živa Zupančič





PERFORMATIVE NATURE

Barcelona International Landscape Architecture Biennial

September 2018 **Barcelona**

SCHOOL PRIZE

X International Landscape Architecture Biennial

Máster d'Arquitectura del Paisatge -DUOT - UPC
ETSAB- Escola Tècnica Superior
d'Arquitectura de Barcelona
Avenida Diagonal, 649 piso 5
08028 Barcelona-Spain

TECHNICAL DOSSIER

Title of the project Green Corridors Connecting People with Nature for Eternity
Authors Maruša Čiča, Nika Pirc, Lara Rus, Živa Zupančič
Title of the course Le:NOTRE Student Competition: All Inclusive!?! Upgrading Munich's Northern Fringe, **2nd PRIZE**
Academic year 2016 - 2017
Teaching Staff Assist. Prof. Dr. Tatjana Capuder Vidmar, Dr. Tomaž Pipan
Department/Section/Program of belonging Department of Landscape Architecture
University/School University of Ljubljana / Biotechnical faculty

Written statement, short description of the project in English, no more than 250 words

The third LE:NOTRE Institute Student Competition asked for integrated approaches to develop the urban and peri-urban landscape of Munich North under the overall topic of "inclusive landscapes". The main questions and topics were urban growth and peri-urban sprawl, rural fringe, sustainable tourism and recreation, heritage and identities, landscape perception and landscape democracy. The second prize winning proposal "Green Corridors: Connecting People with Nature for Eternity" developed a set of design approaches for the regional planning framework to address these challenges holistically. The main strategy connects urban spaces with nature in variety of ways and in so doing responds to local conditions. In general, the area is improved with strategic upgrades to the green system, cycling lanes, channel system and the U-Bahn. The cycling and channel network is used, not only as a strong and coherent green system for recreation purposes, but also as a strategic design framework to organize and structure the area. The main planning concepts are green transport provision, microclimate improvement, urban edge softening, and encouraging art and socialization. For example in Dachau, the green border tree lines, avenues and terrain creates softened eastern edge. The underground buildings represent new urban edge, softly translating into the newly designed forma viva or the preserved natural habitats. Gardens, fields and picnic places are creating programmed spaces between new landforms. In urban areas and along the Würm river, green open public spaces are designed.

For further information

Máster d'Arquitectura del Paisatge -DUOT - UPC

T: + 34 93 401 64 11 / +34 93 552 0842

Contact via email at: biennial.paisatge@upc.edu

Consult the web page <http://landscape.coac.net/>

Munich's Northern Edge

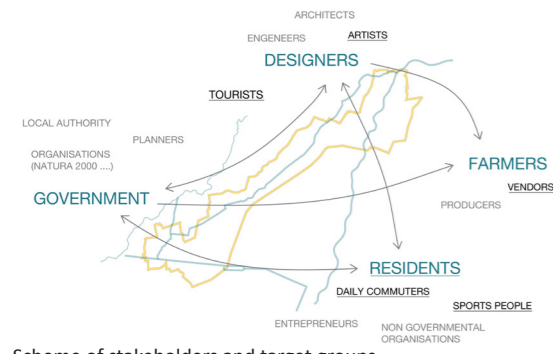

Scheme of stakeholders and target groups

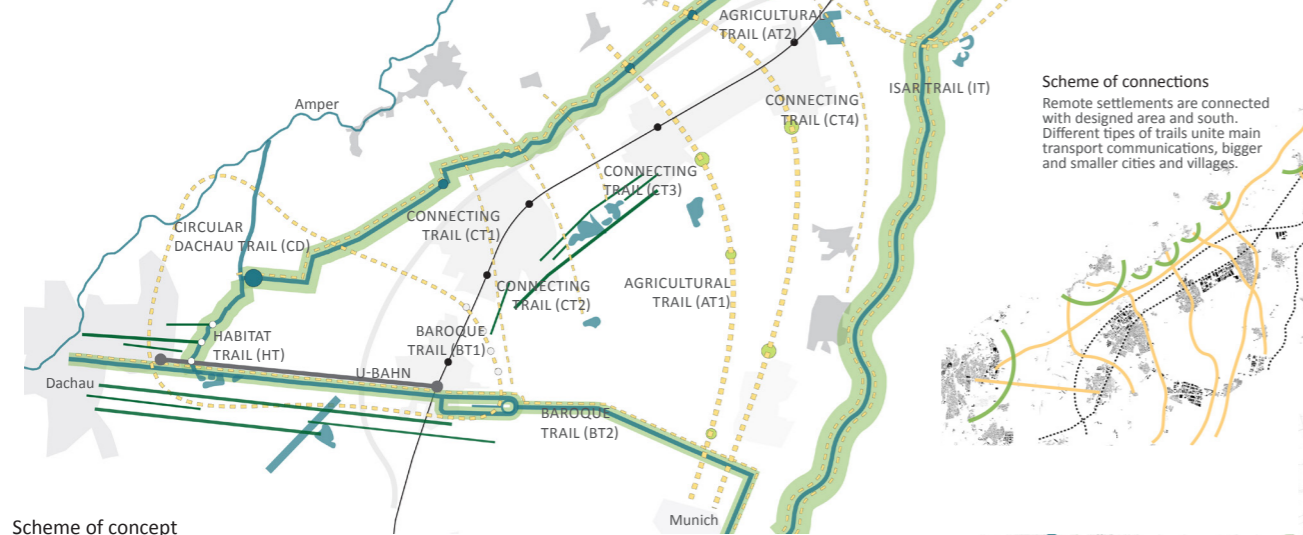

Scheme of concept



Habitat point with observatory (HT)



Baroque point (BT)

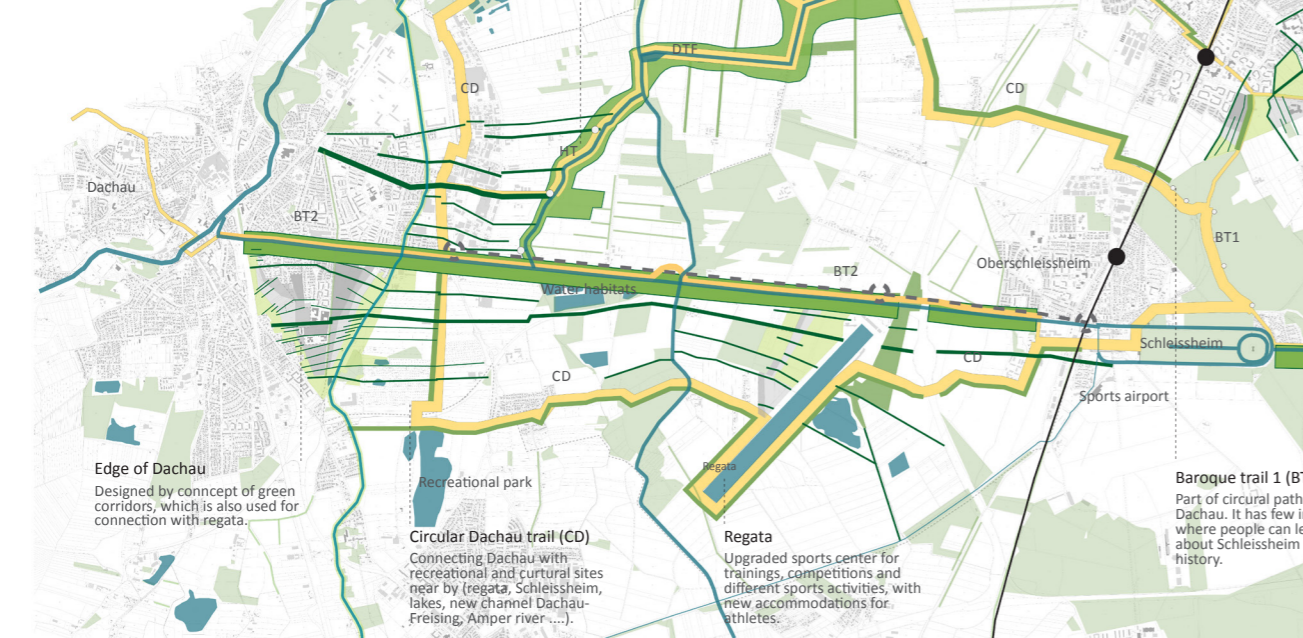

- landart ○
- U-Bahn station ⊙
- U-Bahn - - -
- bike paths —
- water —
- green connecting system —
- park —
- the spread of settlements —



Dachau City Edge



- 1 Apartment blocks (GF+5)
- 2 School (GF+1)
- 3 Kindergarten (GF)
- 4 Cinema (GF+1)
- 5 Library (GF+1)
- 6 Gallery (GF+2)
- 7 Theater (GF+1)
- 8 Market (GF+1)
- 9 Restaurant (GF)
- 10 Accommodation for artists (GF+1)
- 11 Alternative building for existing business (GF)
- 12 Alternative building for car parts business (GF)
- 13 Food production and restaurant (GF)
- 14 Food production and eco market (GF)
- 15 Art studios, art classes and gallery (GF)
- 16 Business facilities (GF)
- 17 Storage for forma viva equipment (GF)
- 18 Underground garage (B)
- 19 U-Bahn station (B+GF)

Dachau City Edge



<p>Bike paths</p> <p>Providing green transport Green parking lots</p> <p>Improving microclimate Slopes</p> <p>Softening urban edge</p>	<p>Boating channel</p> <p>Parks</p> <p>Gardens</p>	<p>U - Bahn</p> <p>Avenues along roads</p> <p>Picnic area</p>	<p>Forma viva</p> <p>Encouraging art Info points</p> <p>Encouraging cultural life Outside library</p> <p>Improving social life</p>	<p>Gallery</p> <p>Cinema</p> <p>Market</p>	<p>Art classes</p> <p>Theatre</p> <p>Steps to Würm</p>
--	---	--	--	---	---



New square, park and market connected to Würm



<p>Studios and gallery New building near forma viva provides spaces for artists. They can work there, have and take classes. There is also small gallery with exhibitions from art classes.</p>	<p>Forma viva Exhibition of sculptures in new designed park with paths and picnic area.</p>
<p>Atrium New atrium next to accommodations for artists is designed like a small garden, with possibility to work.</p>	<p>Picnic area Forma viva is combined with picnic places, where people can enjoy art works, view and nature.</p>

Art and forma viva section

<p>Fields Edge of the city is slowly changing to agricultural landscape, where farmers grow food for eco markets and restaurants.</p>	<p>Picnic area Picnic places are also part of agricultural landscape. Some of them are also connected with habitat trail and habitat observatories.</p>
<p>Restaurant and market New building is used for restaurant with local food. It also has roof garden with nice view on green city edge and riding club. There is also market with local products.</p>	<p>Riding club Is already part of Dachau city edge and it is included in new design.</p>

Food production section

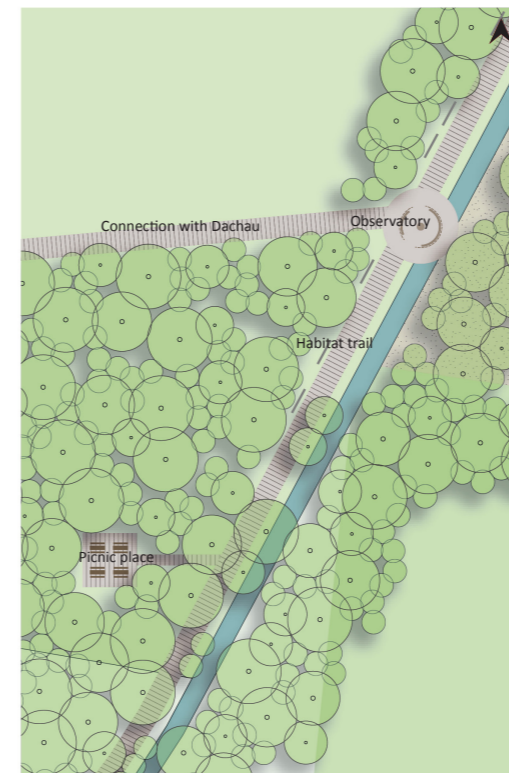

Habitat observatory and path along Würm

