



PERFORMATIVE NATURE

Barcelona International Landscape Architecture Biennial

September 2018 **Barcelona**

SCHOOL PRIZE

X International Landscape Architecture Biennial

Máster d'Arquitectura del Paisatge -DUOT - UPC

ETSAB- Escola Tècnica Superior

d'Arquitectura de Barcelona

Avenida Diagonal, 649 piso 5

08028 Barcelona-Spain

TECHNICAL DOSSIER

Title of the project Living with a dynamic river

Authors Yingjie Chen

Title of the course Landscape Architecture Design Research Project

Academic year 2017

Teaching Staff Bridget Keane, Tom Black and Jen Lynch

Department/Section/Program of belonging Master of Landscape Architecture

University/School RMIT University, School of Architecture and Urban Design

Written statement, short description of the project in English, no more than 250 words

Climate change introduces problems to address. The severe water crises as periodic flooding have become widespread. Yangtze River is chosen as the example site of this project as China has been suffering from flooding for a long time, especially for the cities in the southeast. Nanjing, the previous capital city of China has more than 2000 years history of living with the Yangtze River. This project describes the evolution process of the river system, analyses the relationship between river and city from 2000 years ago to the contemporary city. The project proposes not only deal with sustainable water strategy in 100 year-flood and 200-year-flood but also to encourage the engagement of the water and the community. Unlike traditional intervention plan which blocks people from the flood, this project brings people back to the side of the river again and creating a new relationship between water and city. The design is based on the experience of adaptive strategies, which have been evolving in the long history of people's survival under hazardous conditions, is an inspiration for us to confront the future uncertainties. The idea of the contemporary sponge city has also been referenced. But the contemporary water management neglect the social interactions and activities. Thus, this project combines the successful historical and contemporary water management, the project focus on changing and extending the river edge form along the river, reorganizing the different types of possibilities and activities, creating the communities on a sustainable path to living with water.

For further information

Máster d'Arquitectura del Paisatge -DUOT - UPC

T: + 34 93 401 64 11 / +34 93 552 0842

Contact via email at: biennial.paisatge@upc.edu

Consult the web page <http://landscape.coac.net/>

LIVING BACK TO THE HISTORY AT SITE B



MASTER PLAN

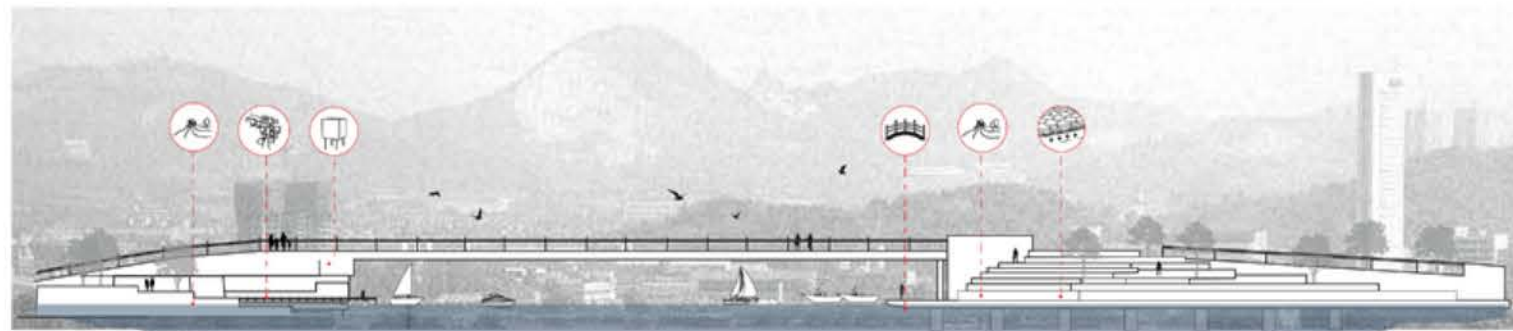

SECTION A-A' 100-YAER-FLOOD



Country / City Nanjing, China
 University / School RMIT University, School of Architecture and Design
 Academic year 2016
 Title of the project Living with dynamic river
 Authors Yingjie Chen

FLOOD EXTENSION AND WATER MANAGEMENT MAP

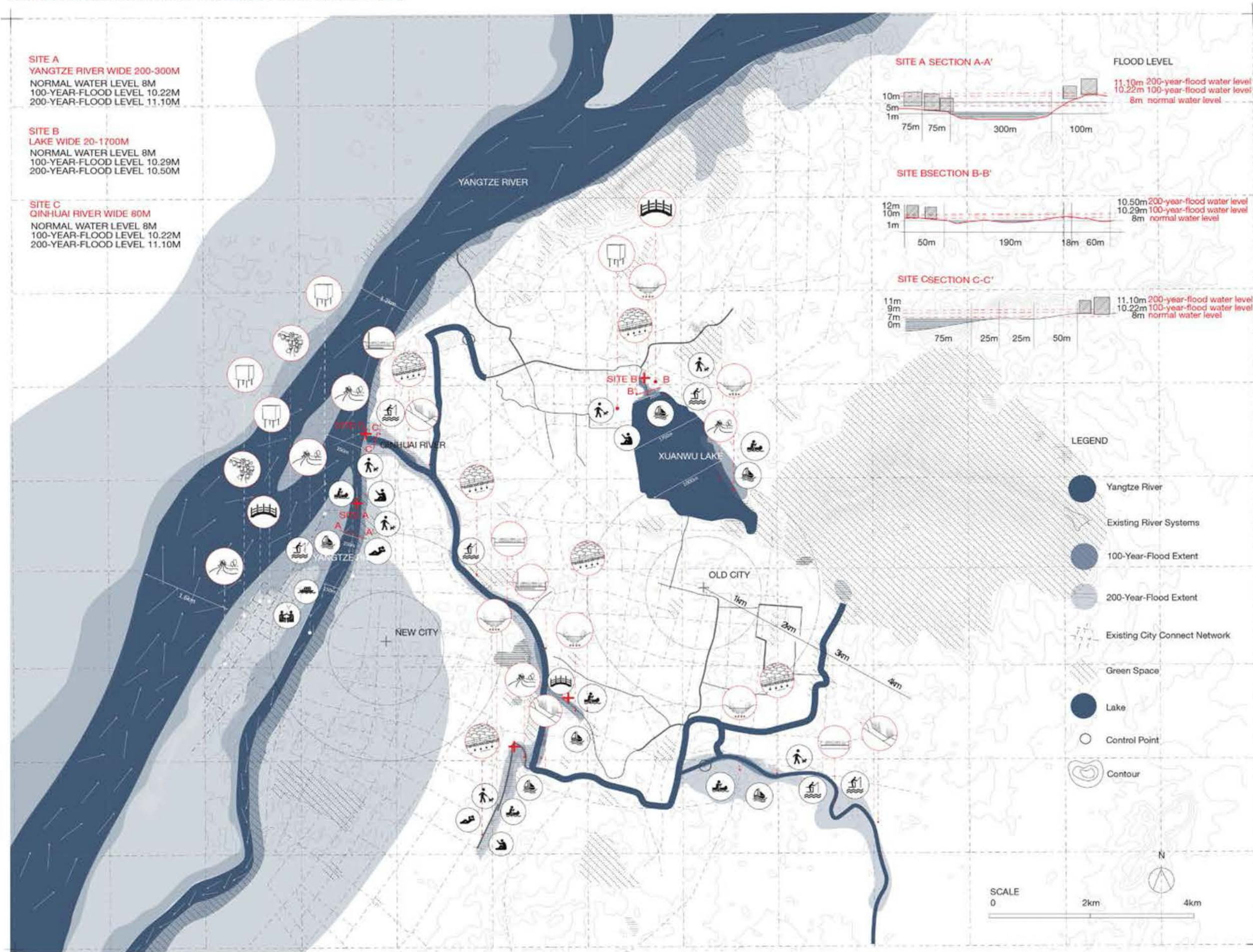

Dynamic River System

- YANGTZE RIVER
200M-3.73KM
- MAIN RIVER
50-200M
- SECONDARY RIVER
20-50M
- THIRD RIVER
5-20M
- LAKE
10-1700M

Historical Principles

- LIFTING
- DEVELOP THE TRADE
- BRIDGE
- GOODS TRANSPORT
- GO BOATING
- GO BOATING

Sponge City Principles

- BIO SWALE
- PERMEABLE PAVEMENT
- ROOF GARDEN
- TERRACE
- EDGE STONE
- RAIN GARDEN

Activity Principles

- READING
- SLEEPING
- DOG WALKING
- GO FISHING
- BOAT
- GO BOATING
- GO FISHING
- CHATING

Flood Extension map in 100-year-flood and 200-year-flood and water management plan

SHIFTING THE NEW CITY PORT AT SITE C

FOLDING

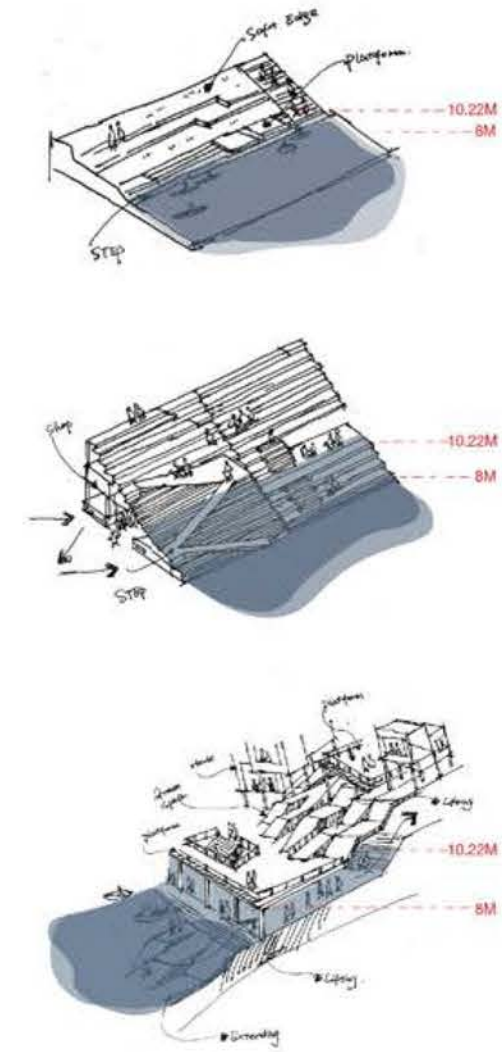

EXTENDING

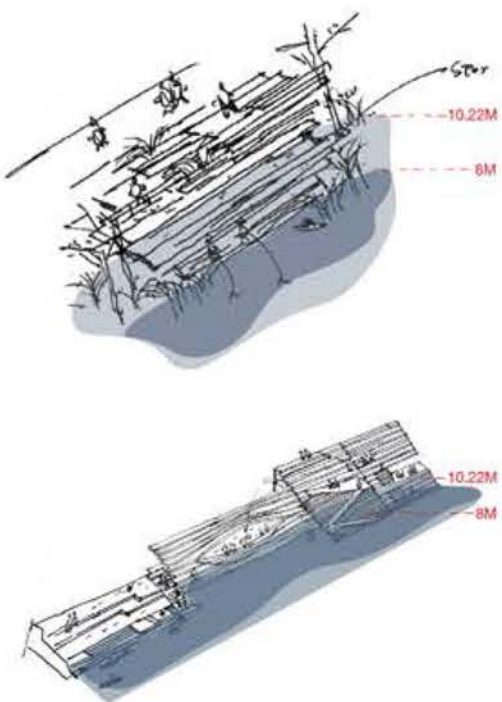

MASTER PLAN

DETAIL A

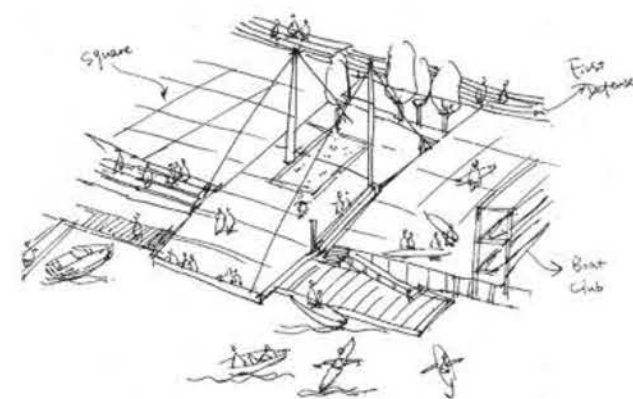

SHIFTING AND EXPANDING

DETAIL B

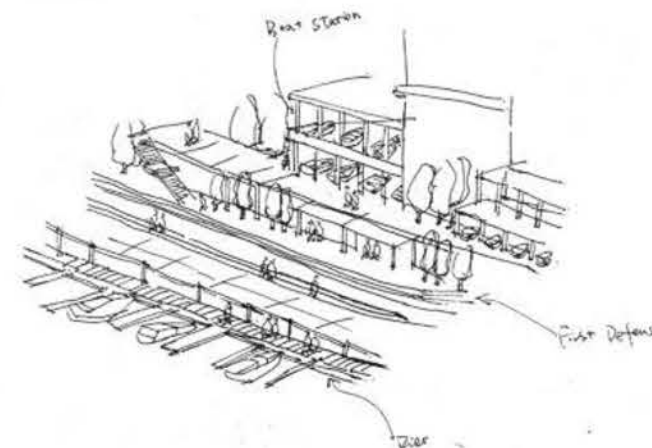

SPONGE CITY AND HISTORICAL WATER MANAGEMENT PRINCIPLES

DETAIL C

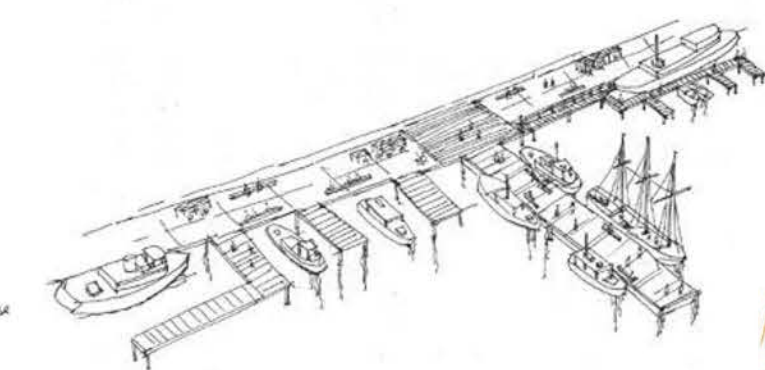

SHIFTING THE NEW CITY PORT

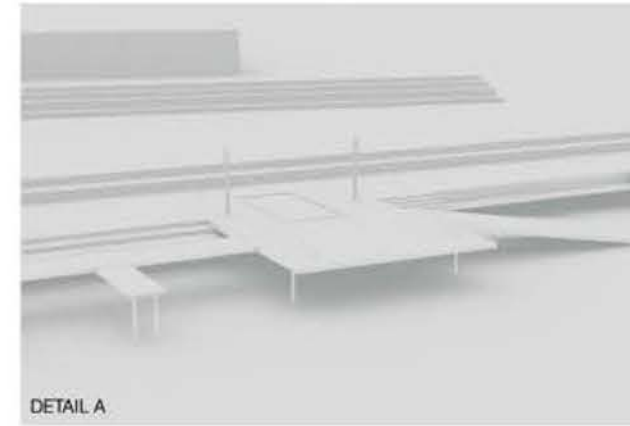

DETAIL A

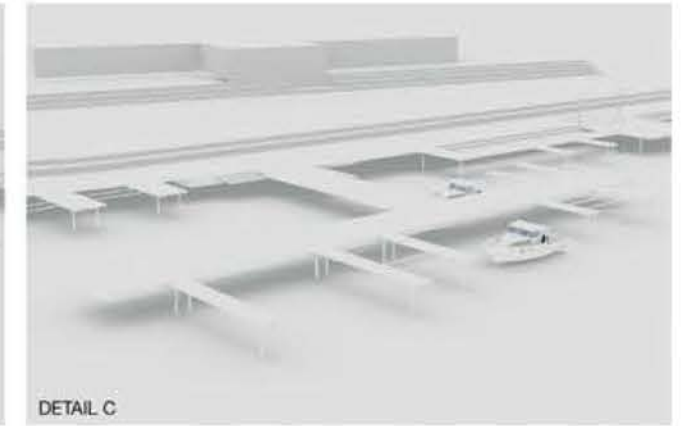

DETAIL C



SPONGE CITY WATER MANAGEMENT IN 100-YEAR-FLOOD SCENARIO