



Country / City	Italy, Imola (Bologna)
University / School	Alma Mater Studiorum University of Bologna / "Ornamental plants and landscape protection" Degree programme
Academic year	2017-2018
Title of the project	Urban Regreenation
Authors	Matteo Bagnolini, Domenico Dipinto, Tommaso Vecchi







# PERFORMATIVE NATURE

Barcelona International Landscape Architecture Biennial

September 2018 **Barcelona**

SCHOOL PRIZE

X International Landscape Architecture Biennial

**Máster d'Arquitectura del Paisatge -DUOT - UPC**

ETSAB- Escola Tècnica Superior

d'Arquitectura de Barcelona

Avenida Diagonal, 649 piso 5

08028 Barcelona-Spain

## TECHNICAL DOSSIER

Title of the project Urban regeneration  
Authors Matteo Bagnolini, Domenico Dipinto, Tommaso Vecchi  
Title of the course 'Design and Construction of Green Areas' Course unit  
Academic year 2017-2018  
Teaching Staff Anna Costa  
Department/Section/Program of belonging 'Ornamental plants and landscape protection'  
Degree programme  
University/School Alma Mater Studiorum University of Bologna

The project area consists of the open spaces along the 'Bretella', an urban infrastructure that cuts the city of Imola, to the west. It is a high-speed road, about three kilometers long, which connects the industrial area of the city with residential areas.

The project focuses its attention in the abandoned areas, those marginal sites that the route of the infrastructure draws between it and the city, trying to define its character and possible different uses. A new pedestrian and cycle system holds together areas with different functions and the ultimate goal is to repair the fracture between the two sides of the city, especially in the area near the Leonardo shopping center.

The crossover, the subdivision into levels and areas and their relationships are the fundamental themes of the master plan. The use of vegetation designs areas in which the empty/full, high/low game defines different areas but in relation to each other: the volume of the urban forest and the emptiness of the design that comes from agriculture. The system of paths holds together the themes and the areas and in particular the new raised yellow bridge, accessible from several points of the city, crosses the area and allows a complete fruition.

In the area closest to the residences, the space becomes more 'urban', almost to design a park-square: here, in a design that comes from the same lines of the city, a wellness path, a skate park and the garden of the five elements are developed.

For further information

**Máster d'Arquitectura del Paisatge -DUOT - UPC**

T: + 34 93 401 64 11 / +34 93 552 0842

Contact via email at: [biennial.paisatge@upc.edu](mailto:biennial.paisatge@upc.edu)

Consult the web page <http://landscape.coac.net/>

# URBAN REGREENATION



**MUNICIPALITY OF IMOLA**  
69938 Inhabitants  
205 km extension  
45.5 m green areas for inhabitant

**CLIMATE AND TERRITORY**  
47 masl  
13.7 C° average annual temperature  
719 mm average precipitation  
NO-SE dominant winds\*

## SWOT analysis



Size and linearity.  
Shopping center.  
City entrance from Bologna.  
Infrastructure located on a negative level.



Noise and pollution  
Breaks and views



Ecological area.  
Nice visual cones  
Empty / full  
Possible scenes.  
Linking rural-urban areas.



Urban expansion  
Abandonment

2001

1945

1853





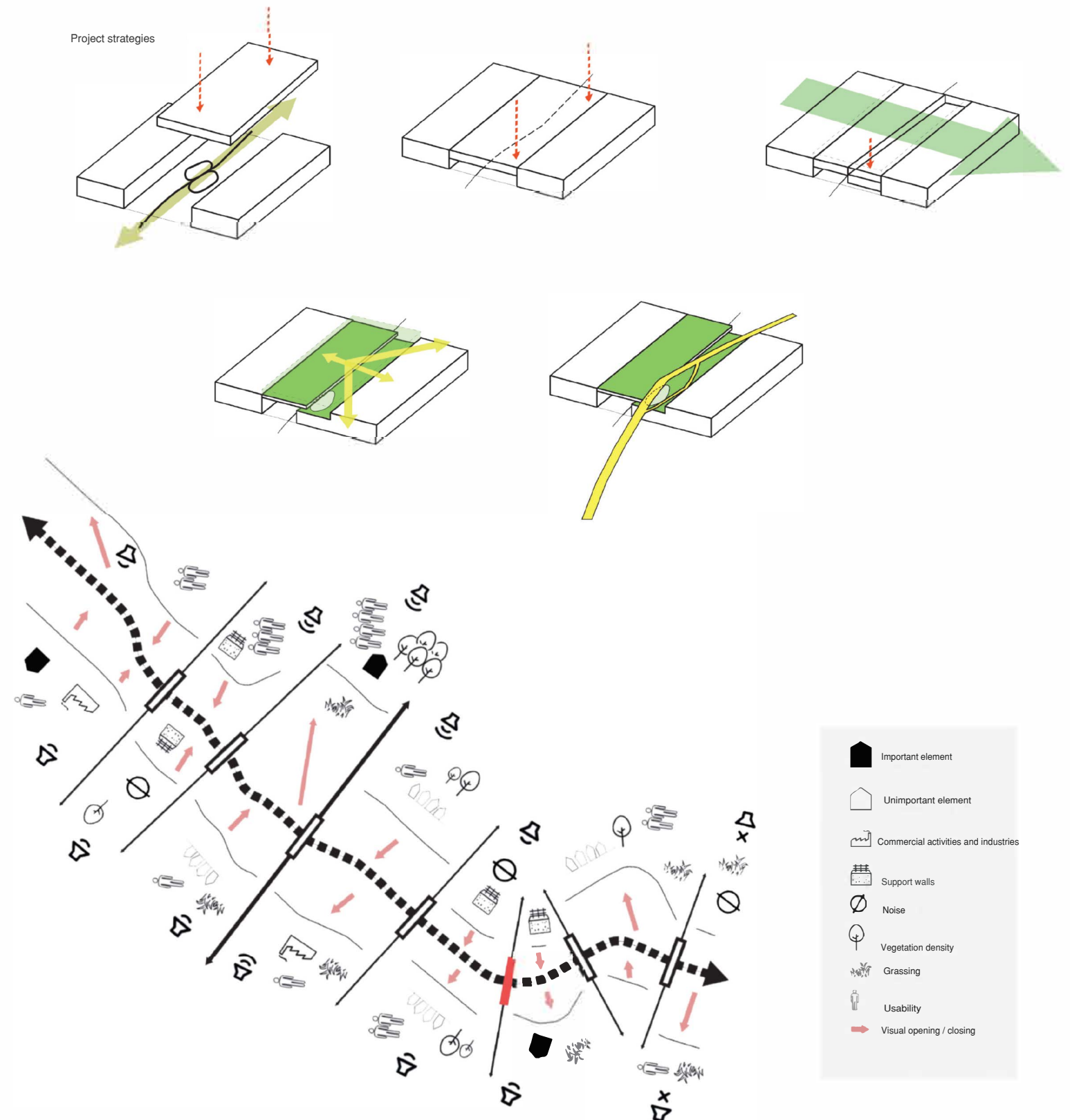
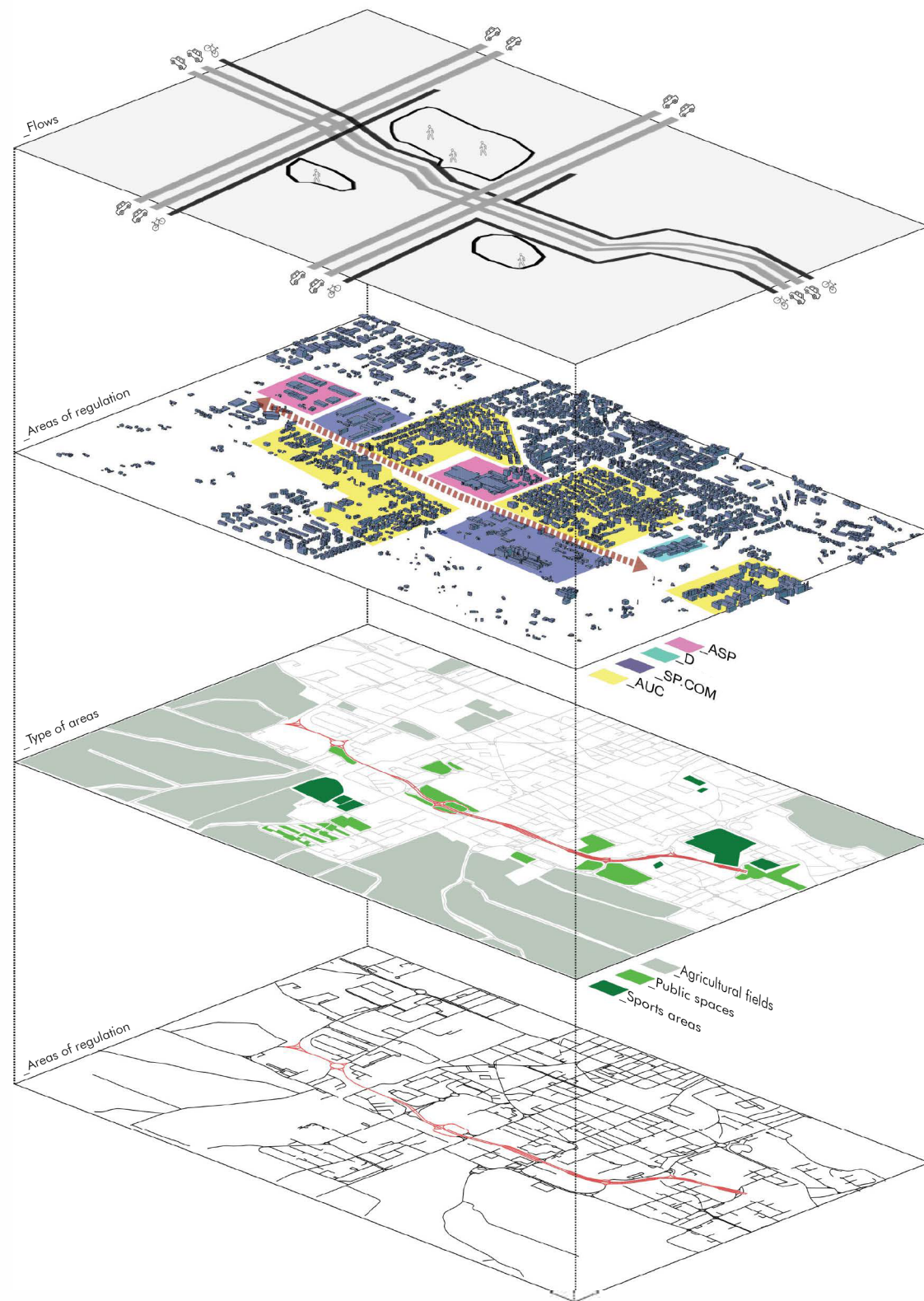



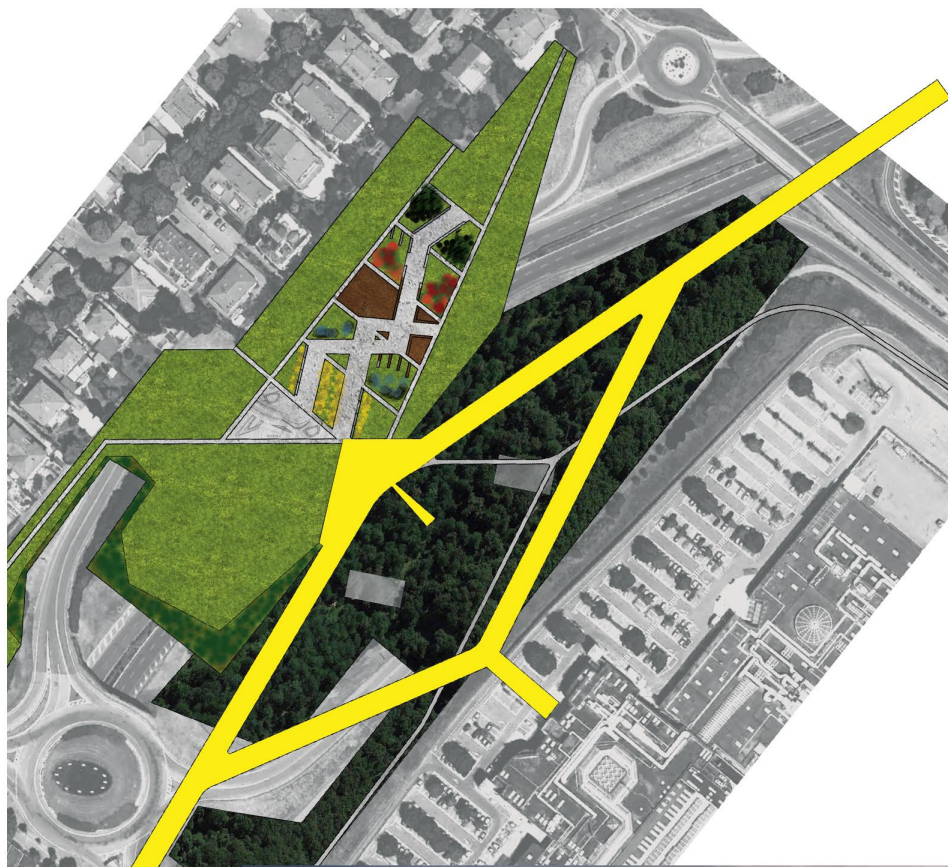

WATER

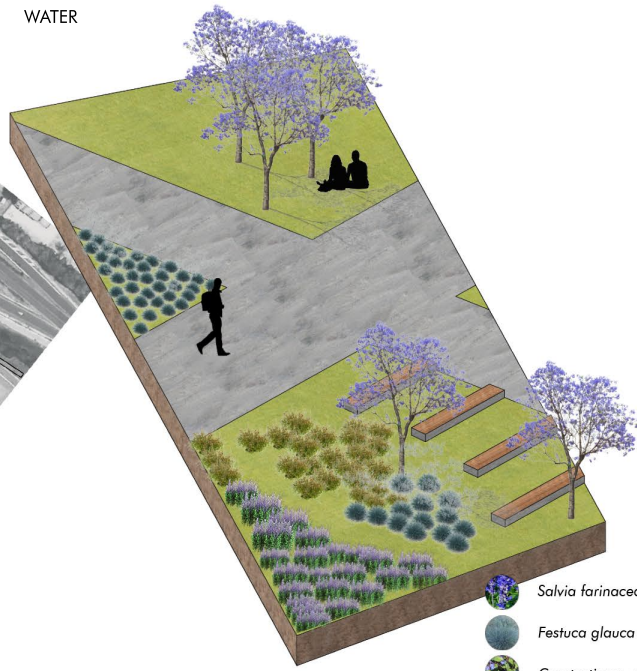

- Salvia farinacea*
- Festuca glauca*
- Ceratostigma plumbaginoides*
- Jacaranda mimosifolia*

EARTH

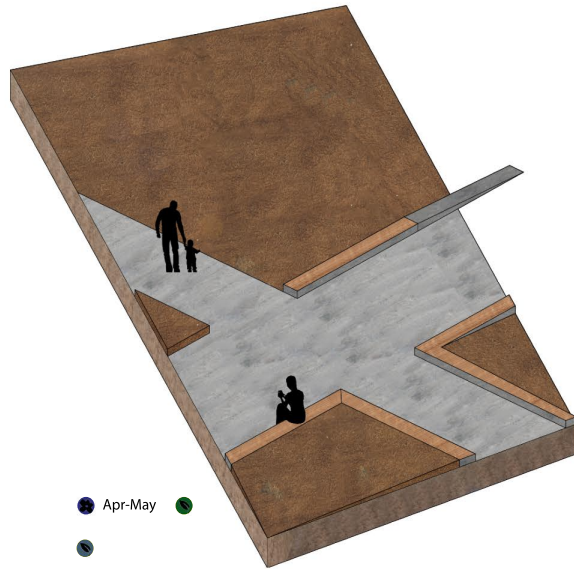

- Apr-May
- Jul-Nov

ETHER

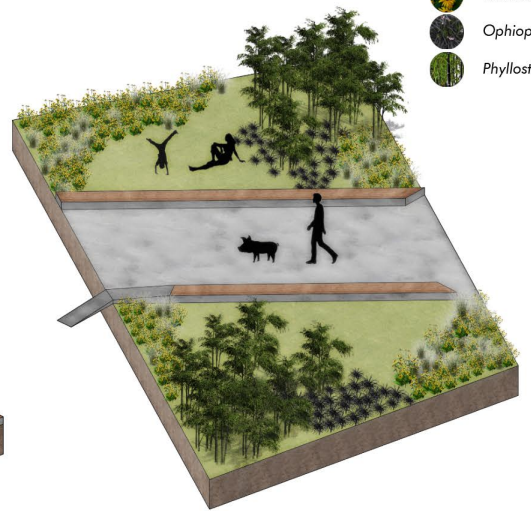

- Rudbeckia fulgida*
- Ophiopogon nigrescens*
- Phyllostachys nigra*
- Jul-Sep
- Jun-Jul
- 

- Muhlenbergia capillaris*
- Pennisetum alopecuroides*
- Calamagrostis acutiflora*
- Amelanchier Canadensis*
- Aug-Oct
- Aug-Oct
- Jun-Jul

AIR

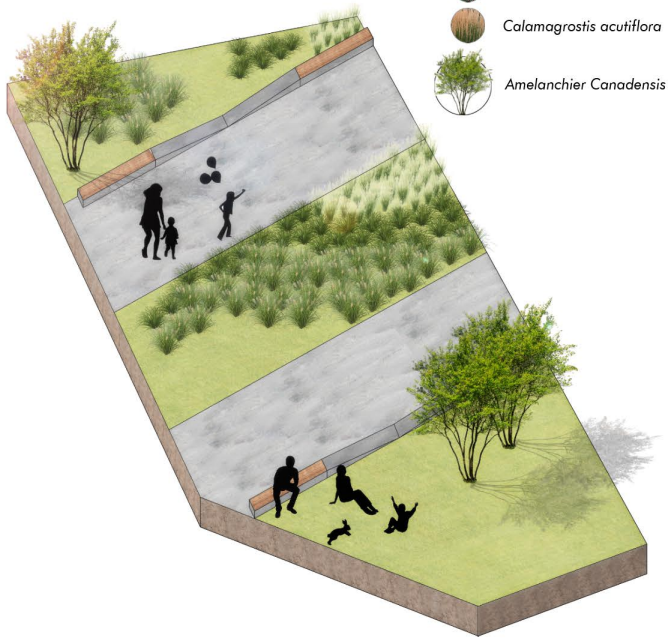

FIRE

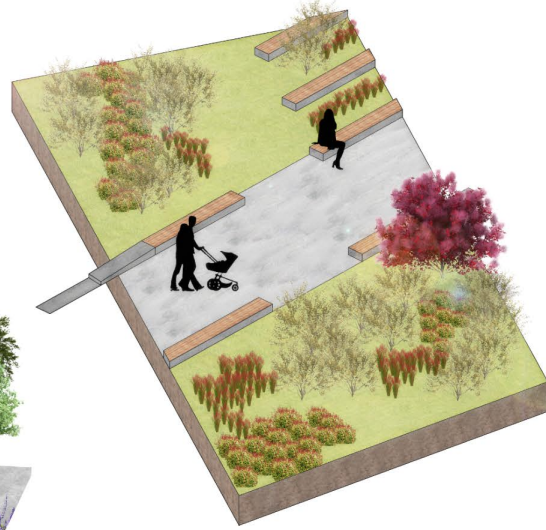

- Salvia elegans*
- Cornus alba 'Sibirica'*
- Imperata cylindrica*
- Cotinus coggygria*
- Mar-Oct
- May-Jun
- 

