



Country / City Canada / Calgary

University / School University of Calgary / Faculty of Environmental Design

Academic year 2017 / 2018

Title of the project A cross-scalar landscape approach to urban infrastructure in Inglewood and Ramsay - BREWERY FLATS

Authors Jane Durham





PERFORMATIVE NATURE

Barcelona International Landscape Architecture Biennial

September 2018 **Barcelona**

SCHOOL PRIZE

X International Landscape Architecture Biennial

Máster d'Arquitectura del Paisatge -DUOT - UPC

ETSAB- Escola Tècnica Superior

d'Arquitectura de Barcelona

Avenida Diagonal, 649 piso 5

08028 Barcelona-Spain

TECHNICAL DOSSIER

Title of the project	A cross-scalar landscape approach to urban infrastructure in Inglewood and Ramsay - BREWERY FLATS
Authors	Jane Durham
Title of the course	Landscape Architecture Studio II
Academic year	2017 / 2018
Teaching Staff	Enrica Dall'Ara
Department/Section/Program of belonging	Master of Landscape Architecture
University/School	University of Calgary / Faculty of Environmental Design

Written statement, short description of the project in English, no more than 250 words

At the corner of 9th avenue and 15th street SE, Calgary, Alberta, Canada, sits the Inglewood Brewery, a historical site that played an essential role in creating Inglewood's identity for over 100 years. The "Brewery Flats" project is constructing a public space to gather the community, while revealing potential green corridors and formalized green spaces to create a participatory cultural hub.

Through mapping the identity of Inglewood and Ramsay, a series of lost, neglected industrial and open spaces began to appear as the morphology of the urban landscape became bounded by the Canadian Pacific Railway and other mobility infrastructures. Discovering this impact created by large mobility infrastructures, the Inglewood Brewery emerged as the site where history, industry, and connectivity converge.

To reveal the beauty of an abandoned, post industrial landscape the "Brewery Flats" project establishes a variety of common spaces where the public can engage in a vibrant, historical, social setting. The common spaces consist of two plazas, a naturalized courtyard, an urban grove and an elevated walkway. Most of the abandoned buildings on site are to be demolished, as they are unsafe and decrepit. The row plantings in the project are commemorating this history while enhancing the area with native, sustainable vegetation. Lastly, the path system along the railway provides a connective green corridor that engages with the industrious nature of this landscape. "Brewery Flats" is reestablishing the heart of Inglewood, through composing a collective of spaces to enrich the experience between people, public spaces and living material.

For further information

Máster d'Arquitectura del Paisatge -DUOT - UPC

T: + 34 93 401 64 11 / +34 93 552 0842

Contact via email at: biennial.paisatge@upc.edu

Consult the web page <http://landscape.coac.net/>

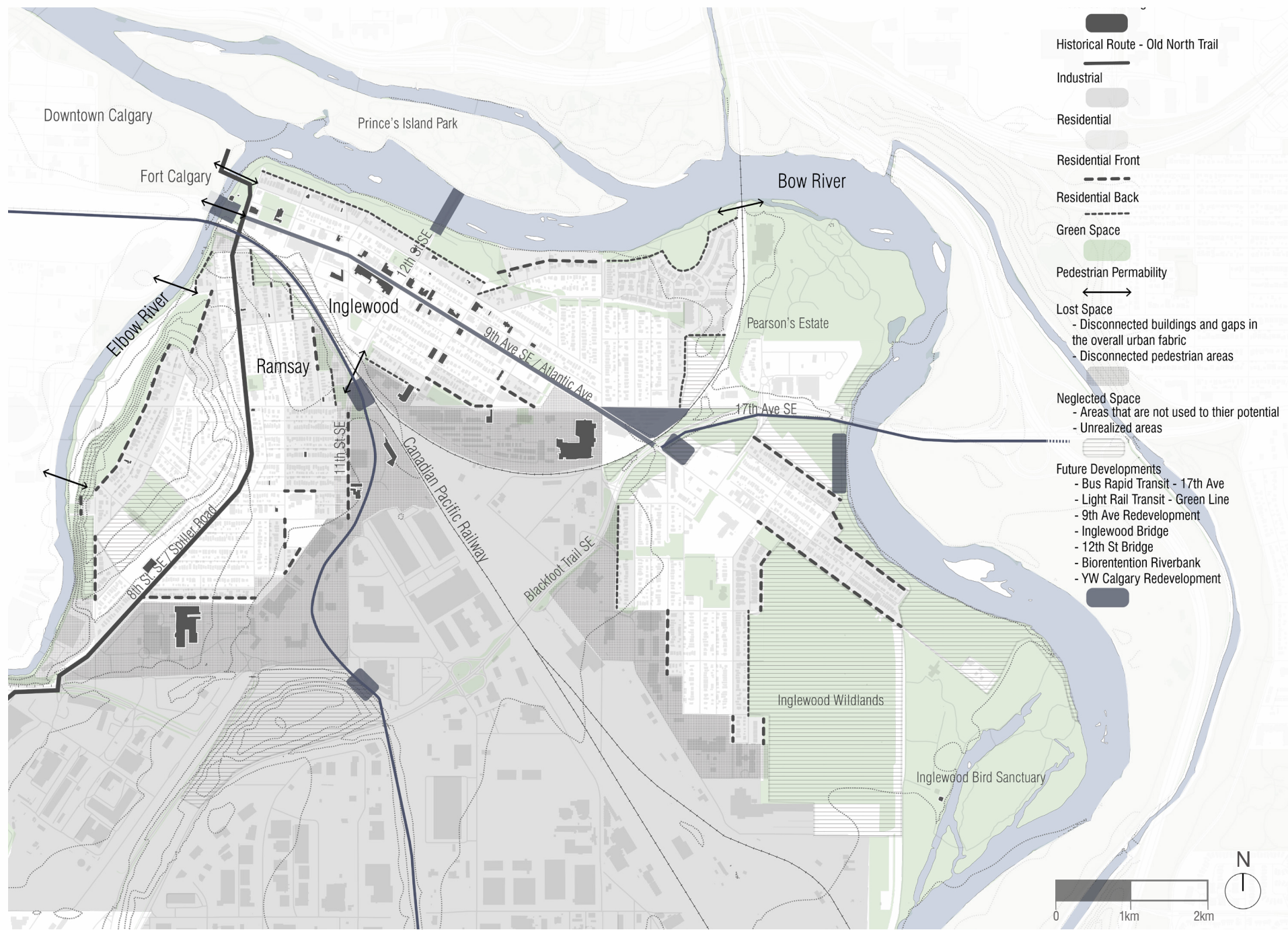

Landscape Identity - Historical Significance, the Current Urban Condition and Future Developments in Inglewood and Ramsay

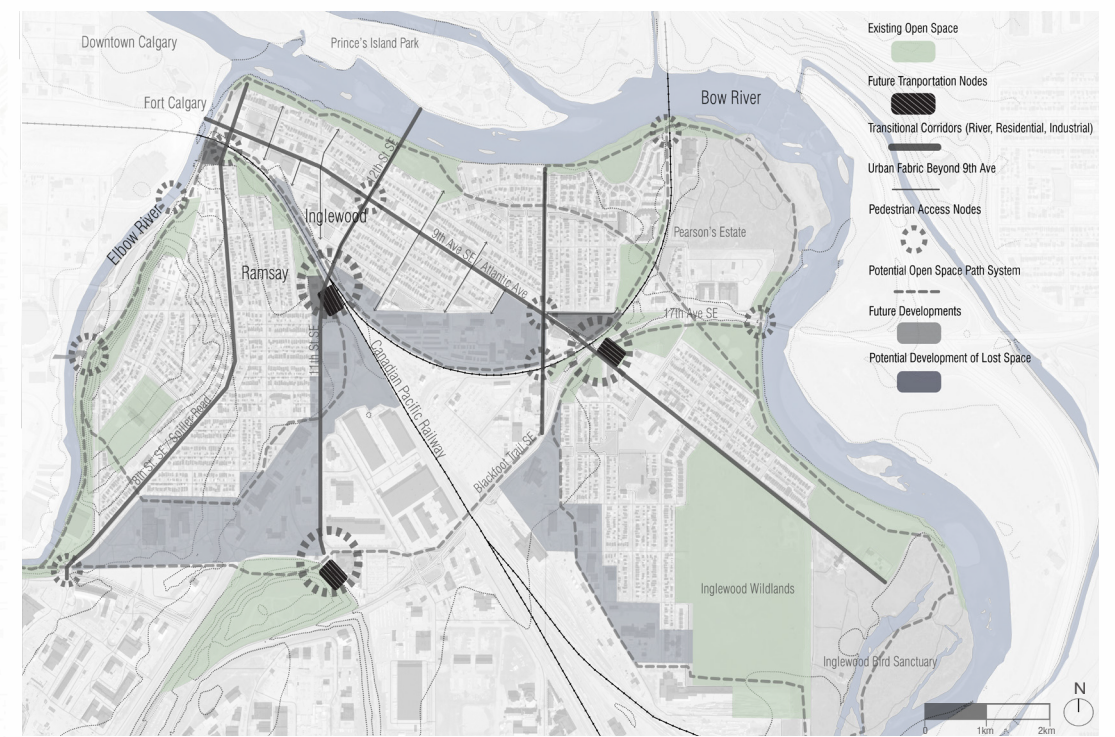

Design Strategies - Connecting Lost Spaces

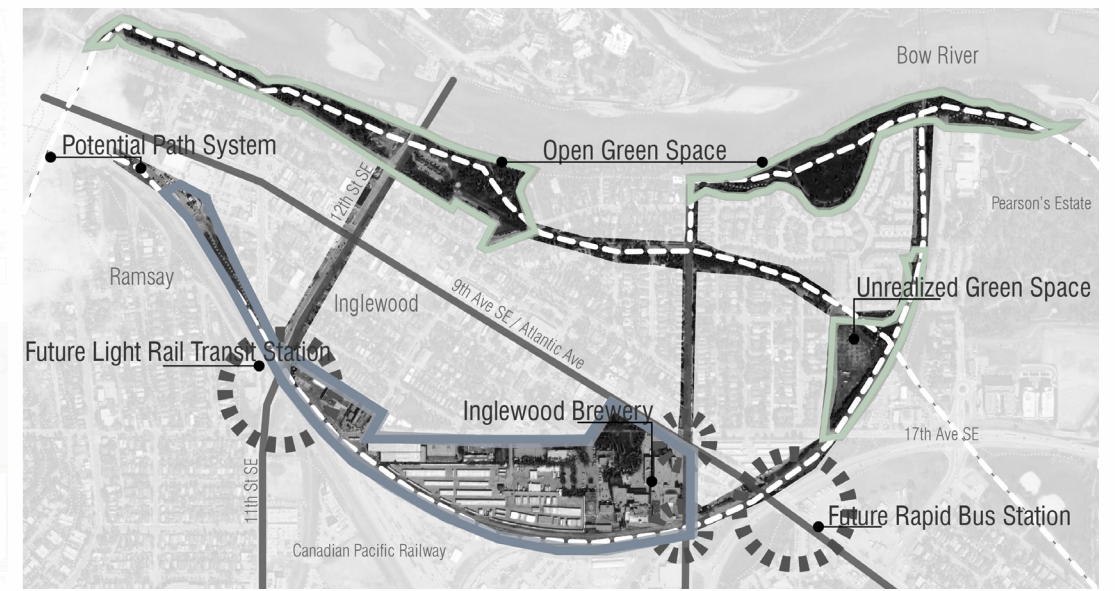

Design Synthesis - Open/Lost Space Corridors

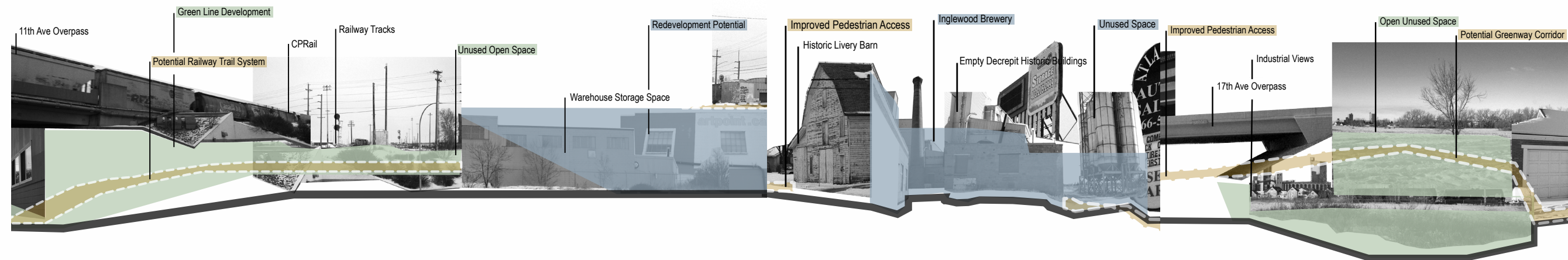

Canadian Pacific wRailway and 11th Street Intersection to the Bow River - Existing and Potential Functions



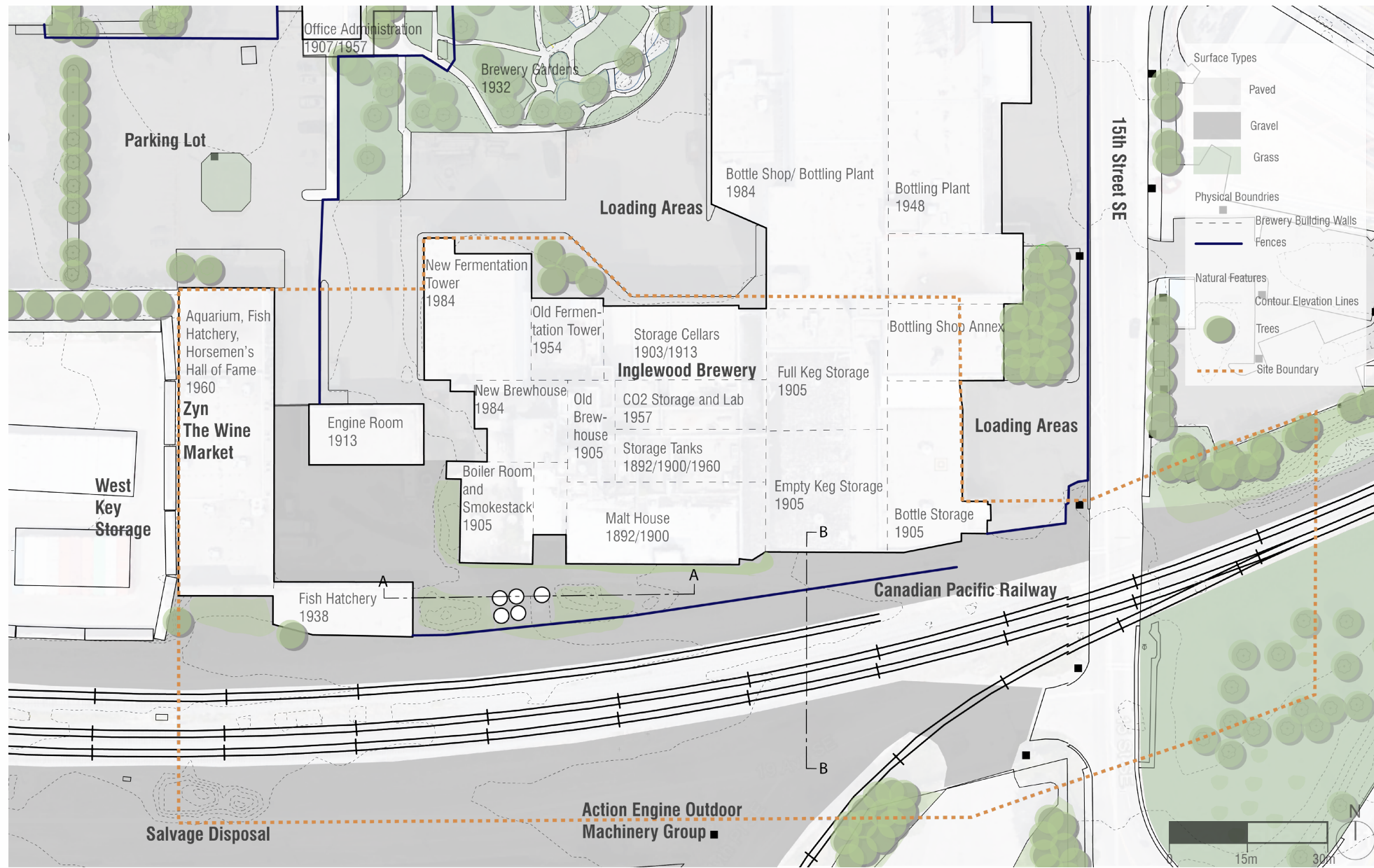

Existing Conditions and Historical Functions - Plan

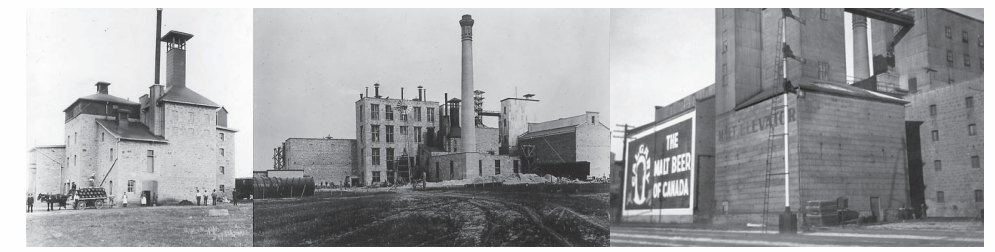

Historical Buildings - 1987, 1905, 1940

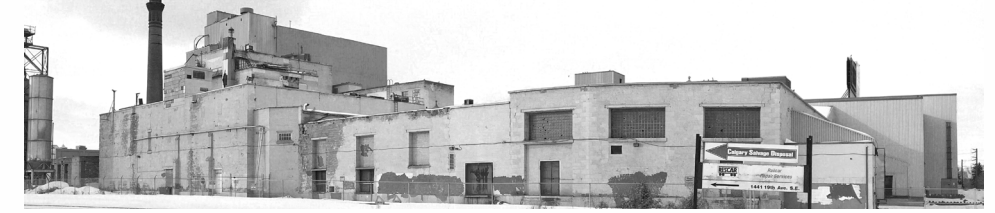

Existing Conditions - Looking North from across the Railway

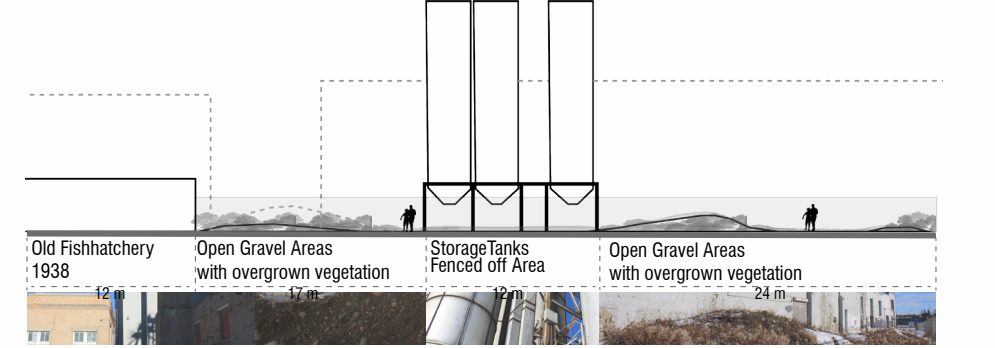

Existing Site Conditions - Section A

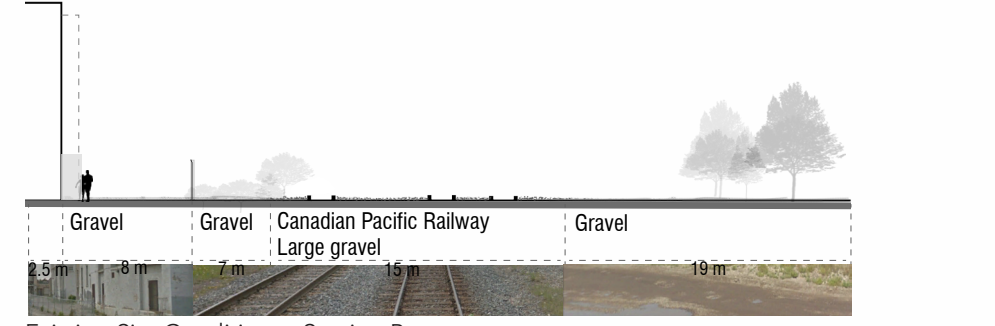

Existing Site Conditions - Section B

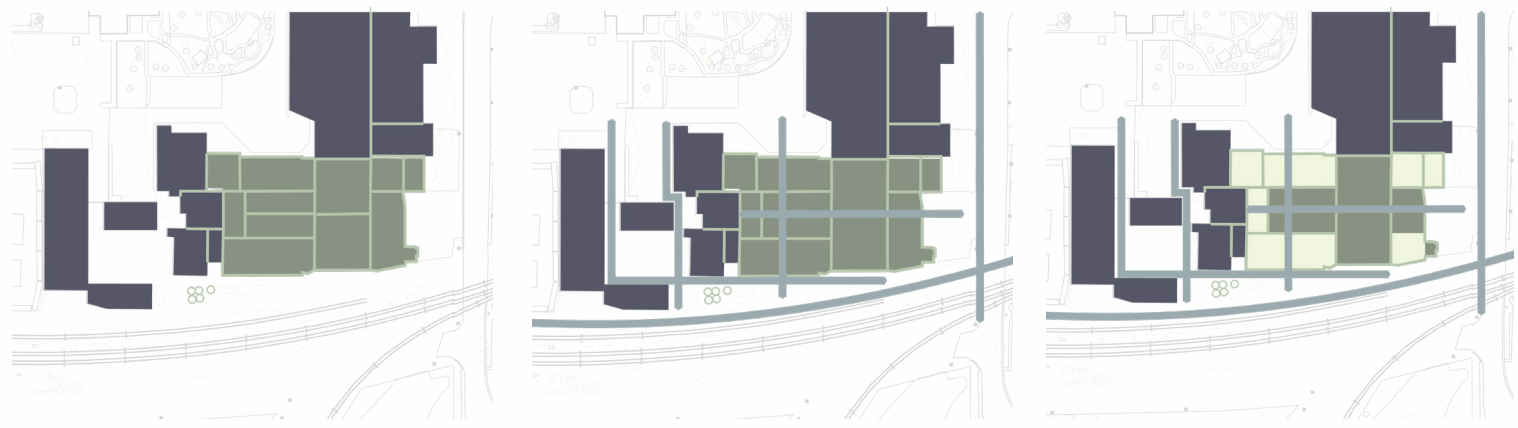

- Preserved Building
- Demolished Building (Programmed)
- Building Footprint
- Spatial Composition
- Row Gardens - New Plantings

Design Concept - Diagrams

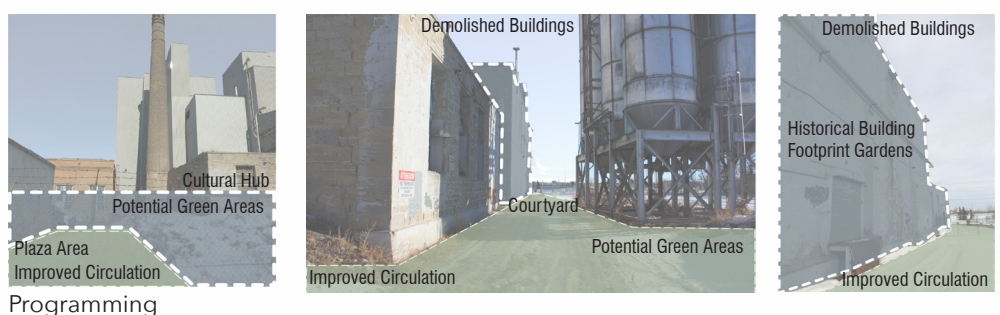

Programming

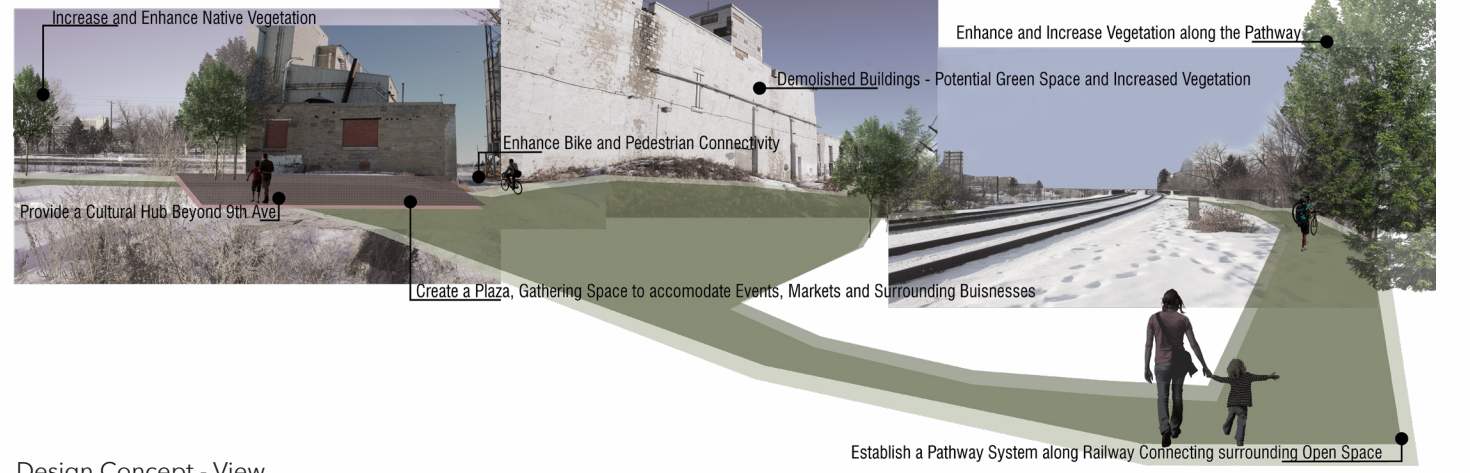

Design Concept - View



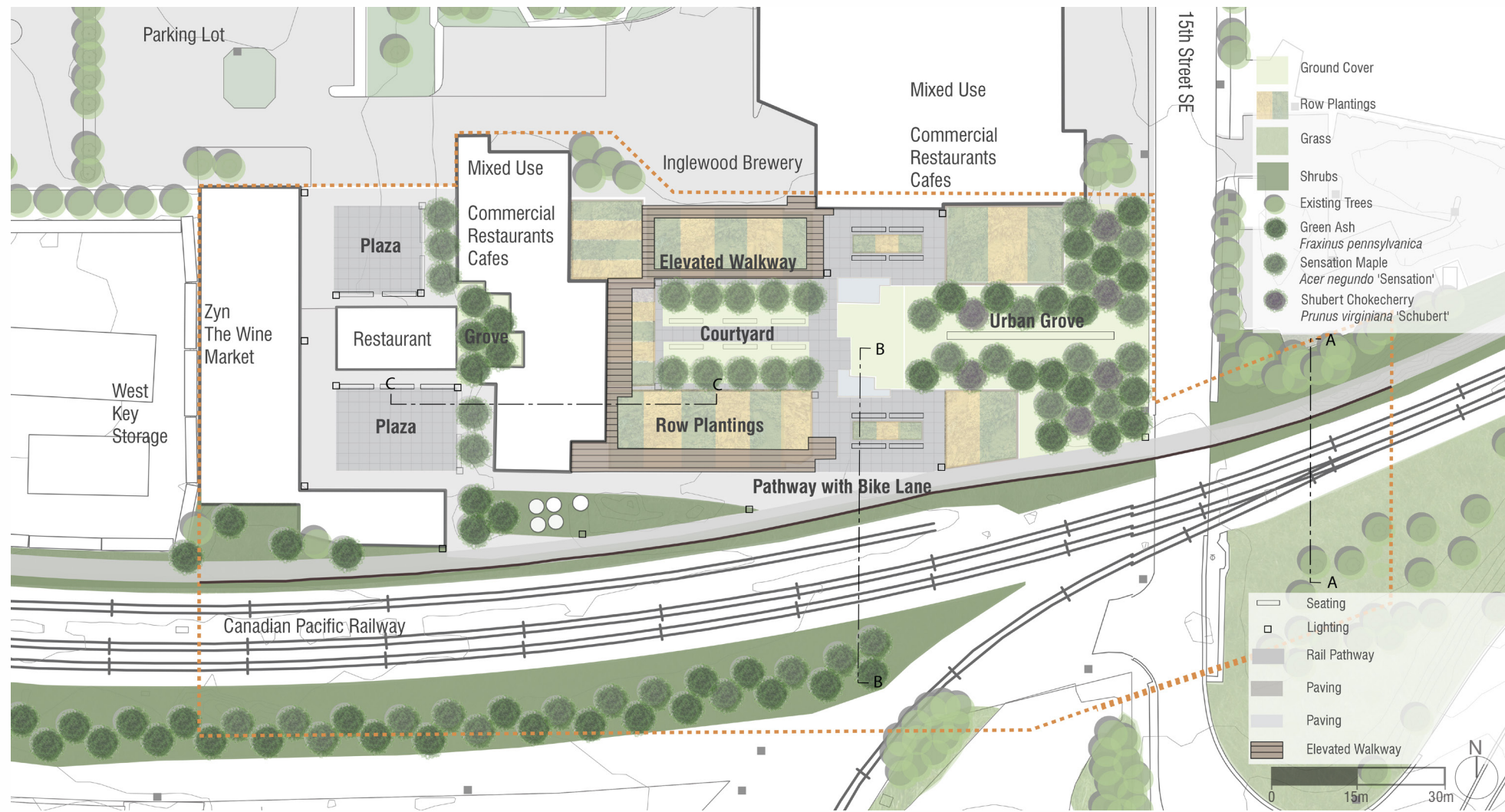

Project Plan

Vegetation Abacus

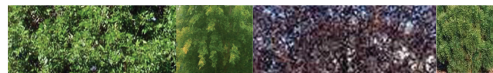

Trees
 Green Ash - *Fraxinus pennsylvanica*
 Shubert Chokecherry - *Prunus virginiana* 'Schubert'
 Sensation Maple - *Acer negundo* 'Sensation'
 Big Tune Mugo Pine - *Pinus mugo* 'Big Tuna'



Ground Cover
 Kinnikinnick - *Arctostaphylos uva-ursi*
 Sweet woodruff - *Gallium odoratum*
 Creeping thyme - *Thymus serpyllum*



Row Plantings
 Yellow Yarrow - *Eriophyllum confertiflorum*
 Pretty Belinda Yarrow - *Achillea millefolium* 'Pretty Belinda'
 Willows - *Salix*
 Reed Grass - *Calamagrostis x acutiflora*
 Ravenna Grass - *Saccharum ravennae*

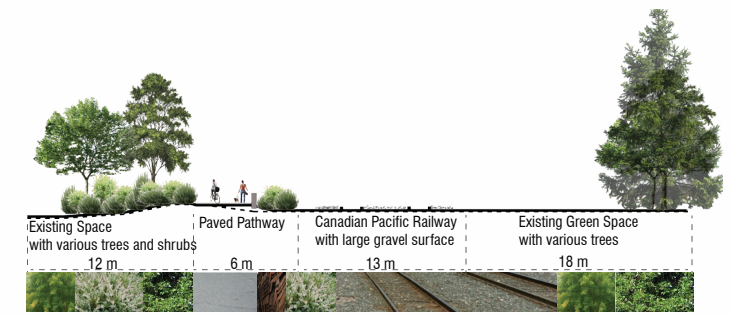

Pathway to Railway - Section A

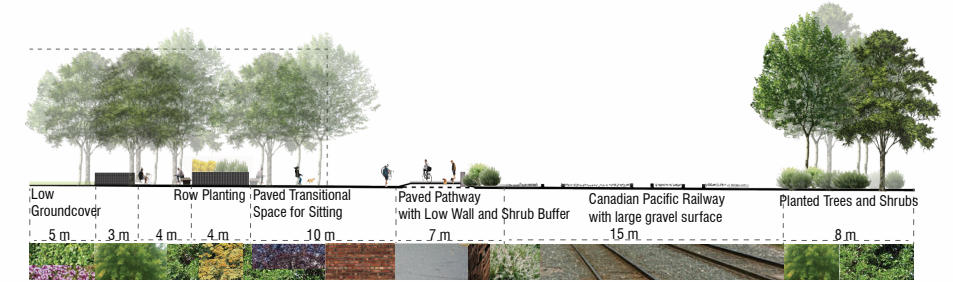

Urban Grove to Railway - Section B

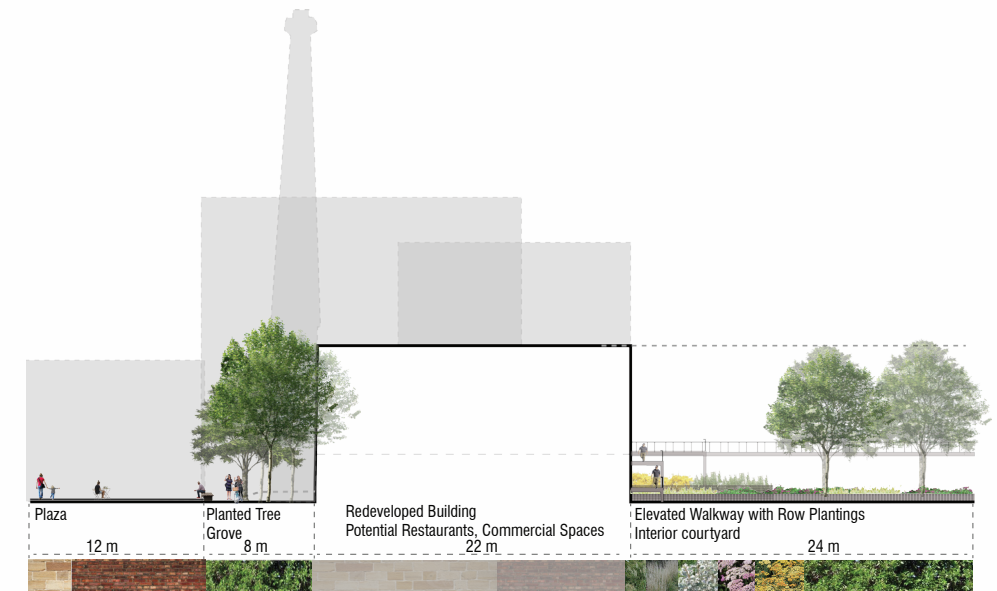

Plaza to Elevated walkway - Section C



Courtyard and Elevated Walkway - Looking West

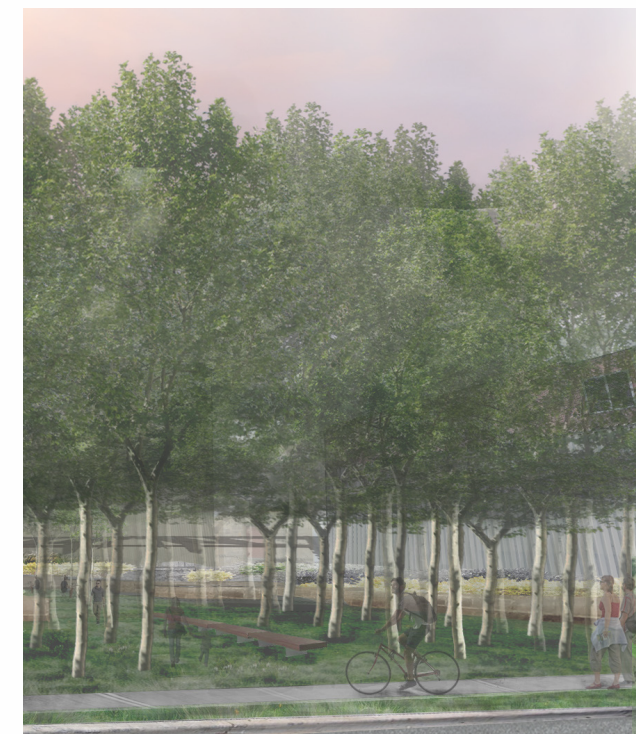

Urban Grove

