

HURUNUI O RANGI MARAE

Country / City Wellington, New Zealand
University / School Victoria University of Wellington - School of Architecture
Academic year 2016
Title of the project Hurunui-o-Rangi Marae
Authors Claudia Boyo





PERFORMATIVE NATURE

Barcelona International Landscape Architecture Biennial

September 2018 **Barcelona**

SCHOOL PRIZE

X International Landscape Architecture Biennial

Máster d'Arquitectura del Paisatge -DUOT - UPC

ETSAB- Escola Tècnica Superior

d'Arquitectura de Barcelona

Avenida Diagonal, 649 piso 5

08028 Barcelona-Spain

TECHNICAL DOSSIER

Title of the project	Hurunui-o-Rangi Marae
Authors	Claudia Boyo
Title of the course	LAND312 (Landscape Architecture Design Integration) and LAND321 (Landscape Architecture Construction)
Academic year	2016
Teaching Staff	Bruno Marques and Carles Martinez-Almoyna
Department/Section/Program of belonging	Landscape Architecture
University/School	Victoria University of Wellington - School of Architecture

Written statement, short description of the project in English, no more than 250 words

A partnership between the School of Architecture-VUW and the local Maori tribe *Ngāti Kahungunu ki Wairarapa* was established to design sustainable and cultural sensitive solutions, following a collaborative and interdisciplinary participatory approach. As a collective culture, Maori acknowledge the natural order of the universe where living and non-living things are connected through a long genealogy of creation myths and ancestral lineage. This project looks at the neglected Hurunui-o-Rangi marae, a communal place for the tribe, located in the Greater Wellington Region of Wairarapa, which is known for its abundance of land, water and soil fertility. The process of conceiving and developing the design proposal embraced the community in participatory techniques of understanding the place, relationship-building, respectful facilitation and empowered participation. The proposed design of Hurunui-o-Rangi marae includes a wide range of spaces that incorporate education through recreation, cultural awareness through traditional practices and implementation of sustainable solutions. The new exterior spaces comprise: the marae *atea* (big meeting house), *hangi* hill (traditional cooking), flax field, vegetable garden and orchard, *papakāinga* (social housing) field market and the *whai* playground.

The goals of the design are:

- create contemporary spaces that are multifunctional and related to the buildings.
- enhance people's experiences of outdoor spaces grounded in Maori traditional values and practices;
- establish community-driven spaces that are intergenerational in nature bringing everyone together, and;
- create learning opportunities that educate the local community about Maori traditions.

The proposed spaces are currently being implemented by the community as part of the redevelopment of the marae.

For further information

Máster d'Arquitectura del Paisatge -DUOT - UPC

T: + 34 93 401 64 11 / +34 93 552 0842

Contact via email at: biennial.paisatge@upc.edu

Consult the web page <http://landscape.coac.net/>

SITE ANALYSIS

EXPLORATION 1 | PEOPLE'S MOVEMENT

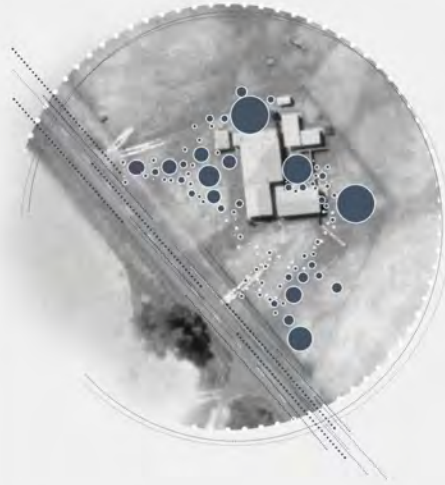

EXPLORATION 2 | SITE PROGRAMMES



EXPLORATION 3 | VEGETATION DENSITY



COMMUNITY ENGAGEMENT



BUILDINGS + FUNCTIONS

Weaknesses:
Buildings do not represent Maori culture

Buildings do not cater to the amount of people necessary for large events

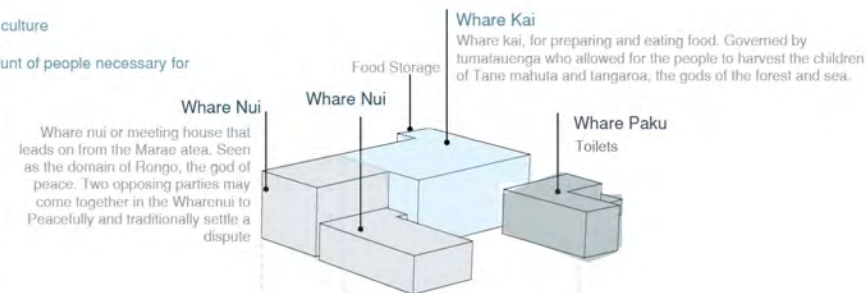

SITE COMPONENTS

Weaknesses:
No features that represent Maori culture
No features that educate people
No interventions that speak about the history of the people or site.
No variation in outdoor spaces
Minimal Barrier between the site and the road

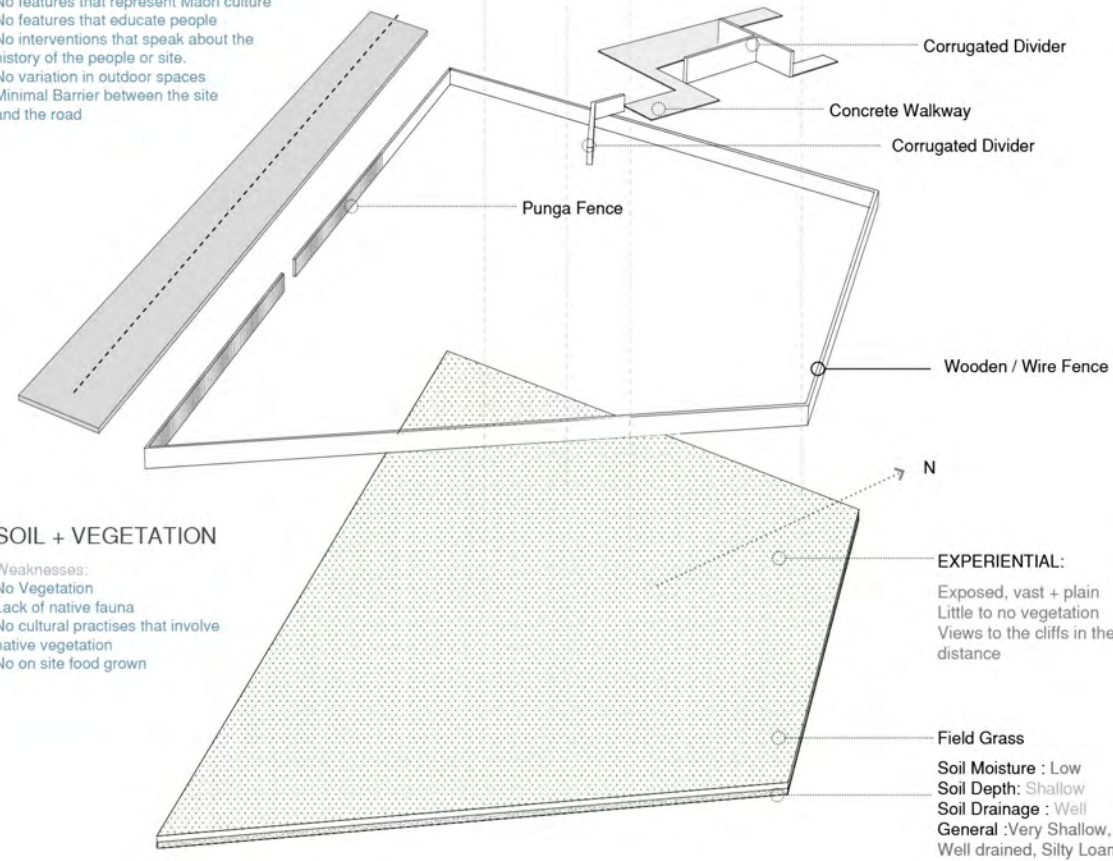

SOIL + VEGETATION

Weaknesses:
No Vegetation
Lack of native fauna
No cultural practises that involve native vegetation
No on site food grown

TARAWAINUKU MARAE | TARANAKI

Te Ika Uwhi Nui is a wananga (learning) which is a partnership between the marae, Coastal Taranaki School, and the local community.

The vision for our boys is to strengthen their identity, their te reo, their culture, tikanga through learning waiata, learning about the stories of the whenua, visiting the mountain, making haka fishing and so forth, so that they learn about who they are, where they come from, and they learn and become confident in being Maori.



MAORI PRACTISES + IDENTITY

CULTURAL LEARNING :
Maori Traditions
Waiata
Stories about their Ancestry

RESULTS IN SELF LEARNING :
About who they are
Where they come from
Becoming confident in being Maori

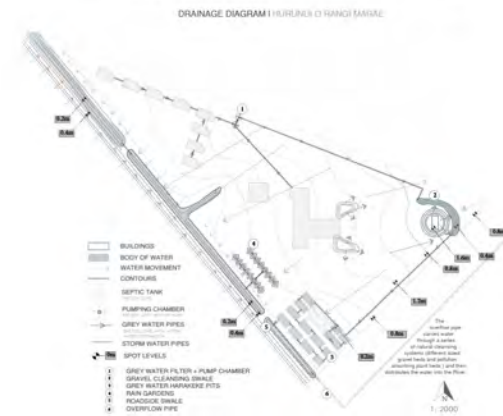

SITE SPACES



PAPAKINGA

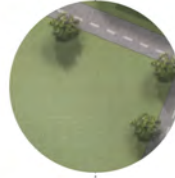

FIELD / MARKET

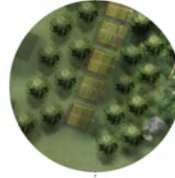

ORCHARD /
VEGETABLE GARDEN



WHAI PLAYGROUND



MARAE ATEA



COMPOST /
RECYCLING AREA

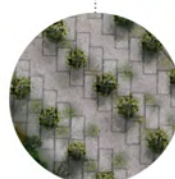

CAR PARK

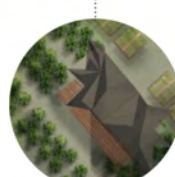

HARAKEKE HOUSE
RONGOTOA GARDEN
FLAX FIELD



HANGI MOUND





HANGI HILL

The Hangi Hill is an elevated mound with a Hangi embedded within it. The mound is surrounded by a purifying, grey water swale and clusters of lush native planting. The planting blocks the prevailing wind and the mound works to elevate and distance the Hangi away from anything to reduce the potential fire hazard. The Hangi can also be used as a social space for talking, eating and playing. It shares a visual relationship with the Marae Atea, which both work to communicate the traditional Maori practices that were undertaken by the residents ancestors.

PLANTING PALETTE: FIRE TOLERANT + LUSH

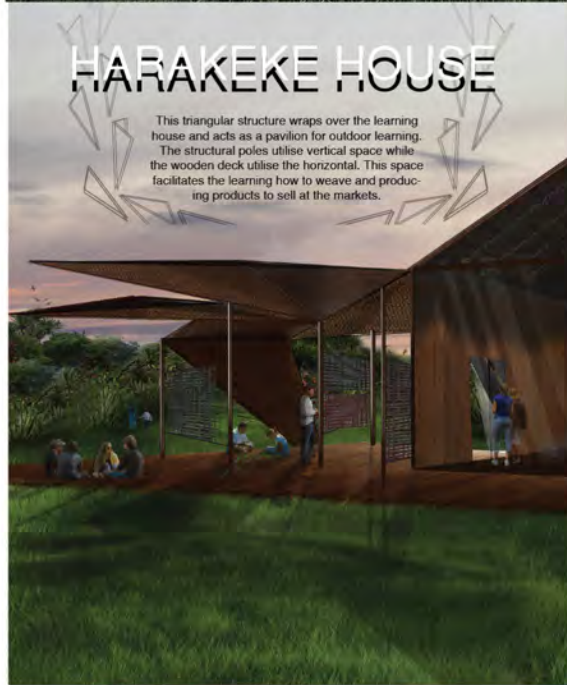
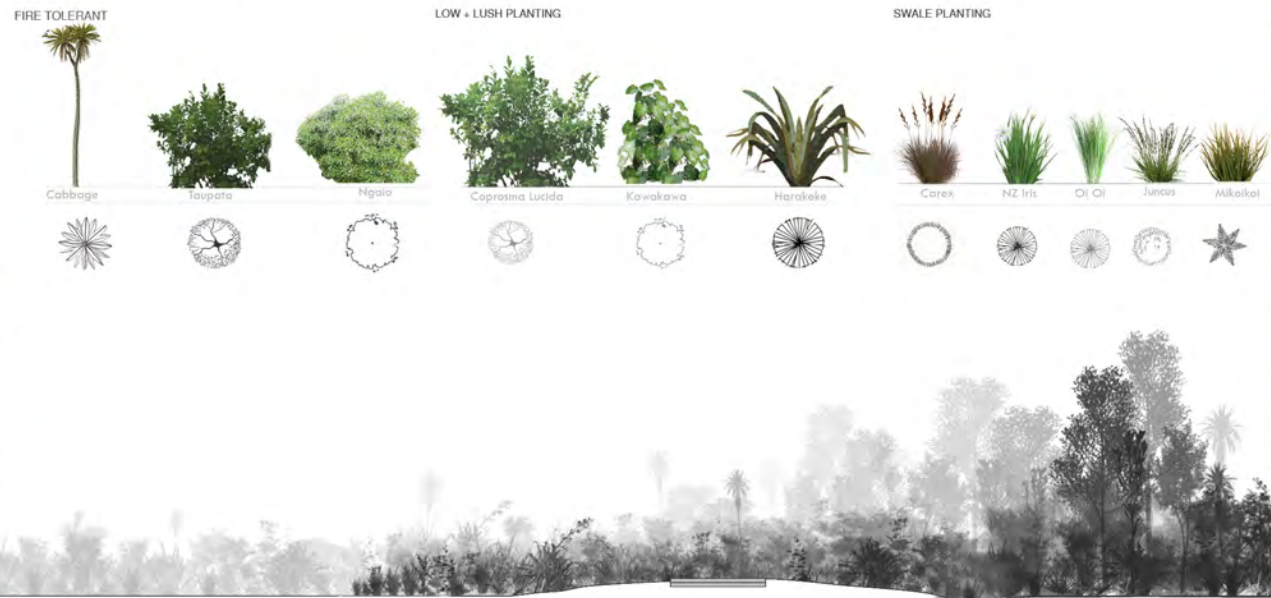

HARAKEKE HOUSE

This triangular structure wraps over the learning house and acts as a pavilion for outdoor learning. The structural poles utilise vertical space while the wooden deck utilise the horizontal. This space facilitates the learning how to weave and producing products to sell at the markets.

MATERIALS

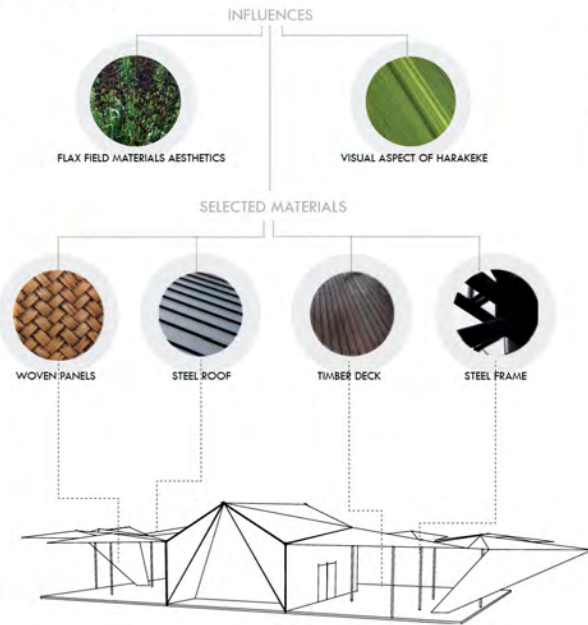

FORM EXPLORATION



FUNCTIONS

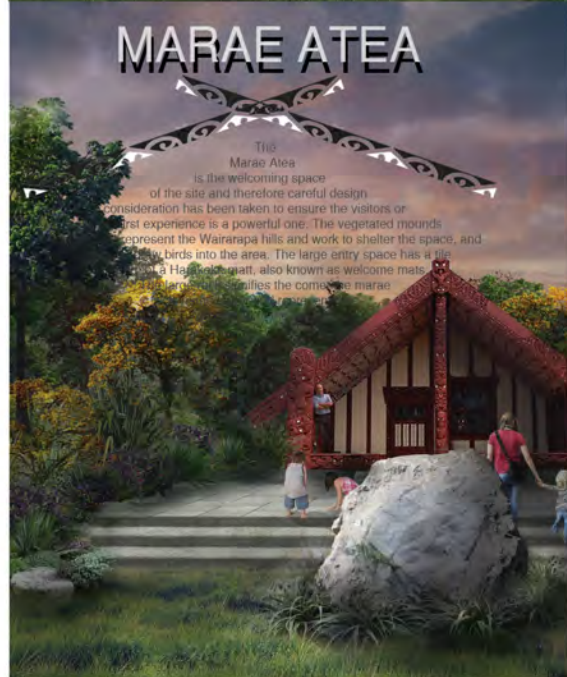
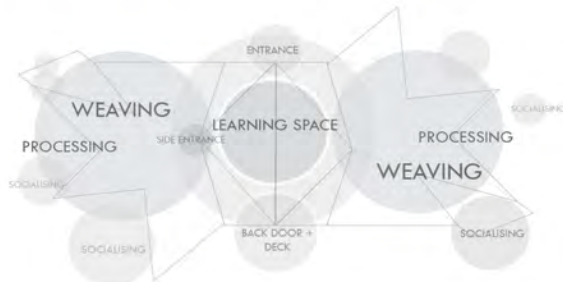

MARAE ATEA

This Marae Atea is the welcoming space of the site and therefore careful design consideration has been taken to ensure the visitors or first experience is a powerful one. The vegetated mounds represent the Wairarapa hills and work to shelter the space, and provide birds into the area. The large entry space has a large, carved wooden structure, also known as welcome mats, which is a traditional Maori practice that was undertaken by the residents ancestors.

THE COMET + HILLS : SYMBOLISM

COMPONENTS

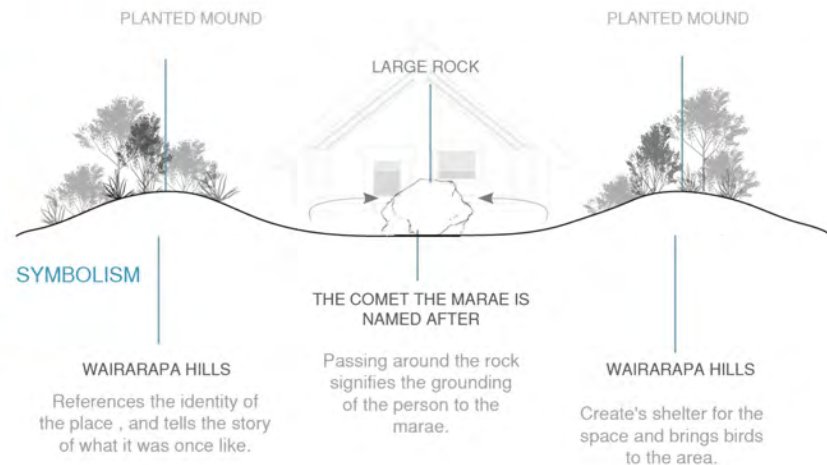

WHAI PLAYGROUND

The Whai Playground provides children with an informal play area where they can learn, explore and climb. The surrounding vegetation makes the winding structure feel like you are travelling through a forest. The Po Poles are carved with designs significant to the marae and the surrounding rocks provide a natural element for the kids to climb on.

FUNCTIONS



WHAI GAMES + MORE SWINGS

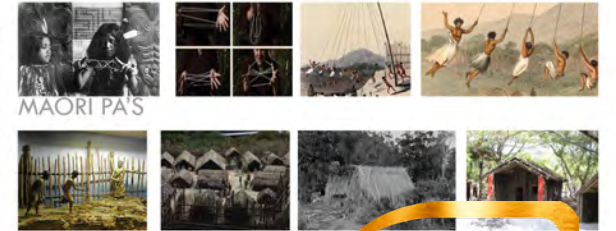

PLANT PALETTE

