

UNVEILING BIODIVERSE ANFEH

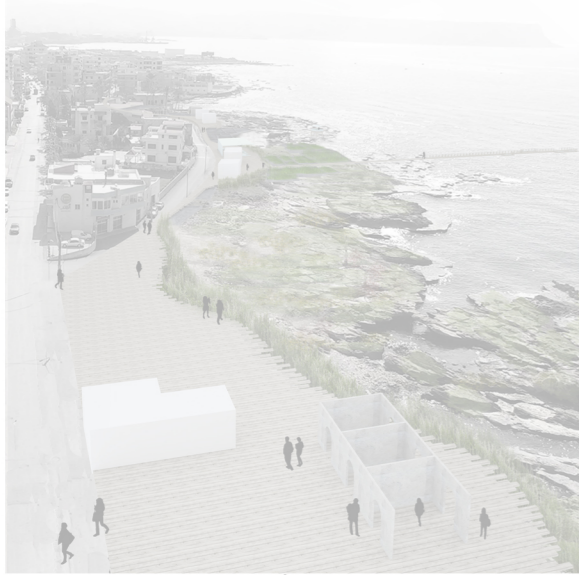

COASTAL WALKERS

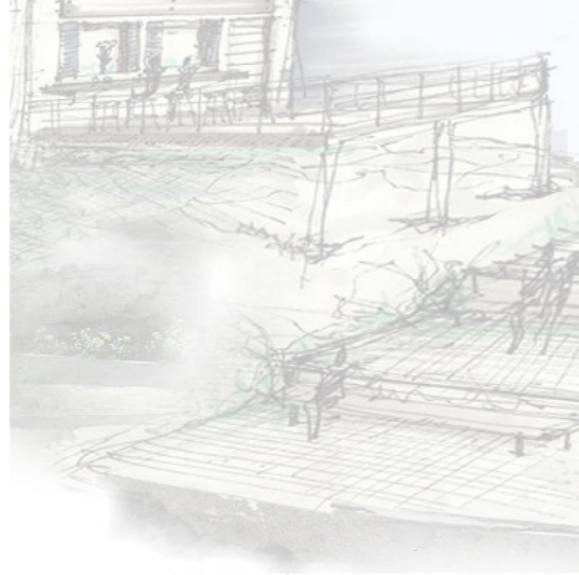

BEYOND THE SENSES: CONNECTING YOUR INNER AND OUTER LANDSCAPE

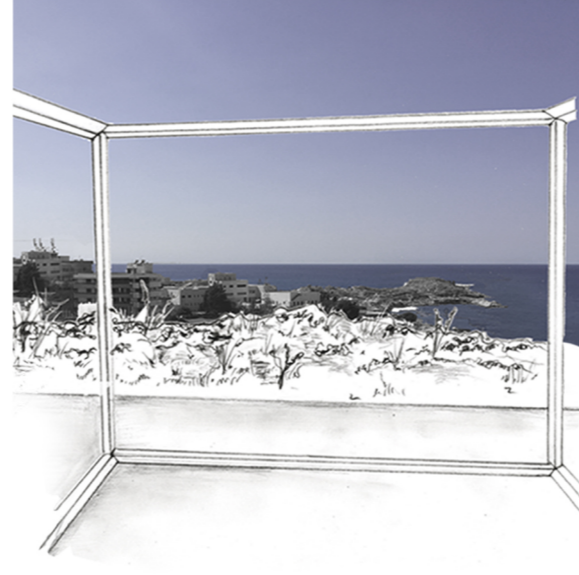

MEDITOSPHERE: TRANQUILITY, THERAPY, MEDITATION

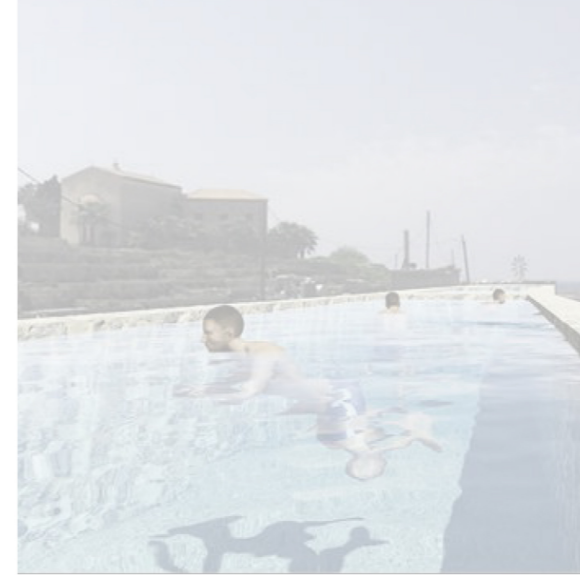

EVOLUTIONARY DEGRADATION

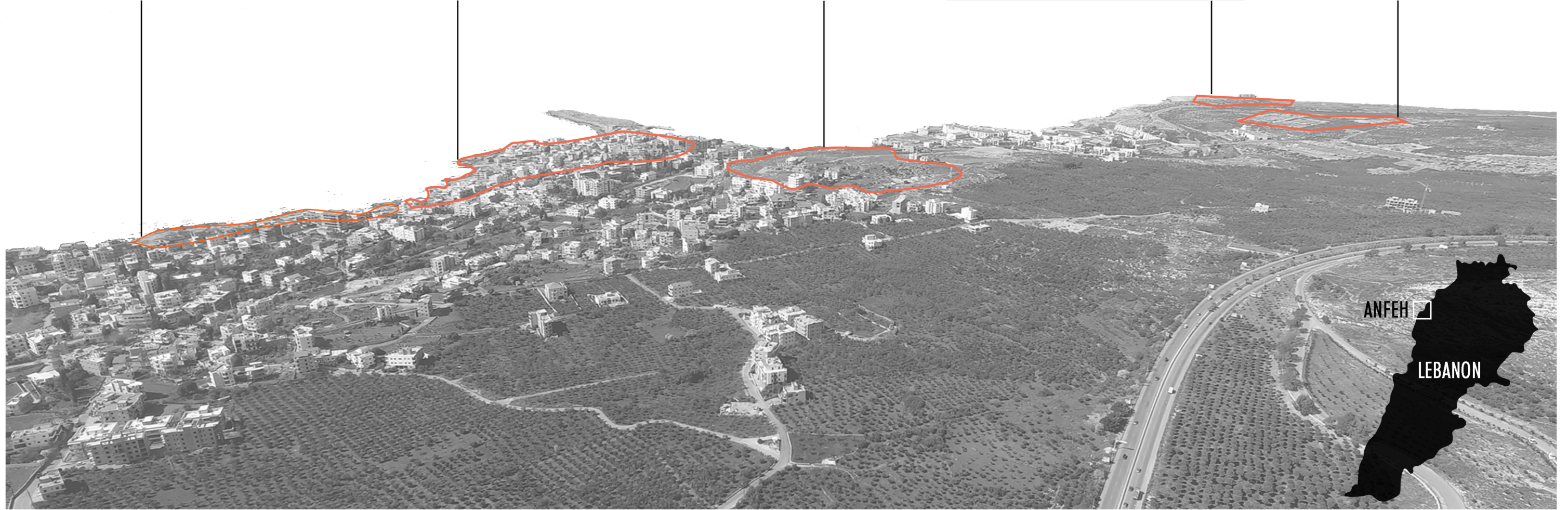

Country / City **LEBANON / BEIRUT**

University / School **AMERICAN UNIVERSITY OF BEIRUT**

Academic year **YEAR 3**

Title of the project **BEYOND THE SENSES: CONNECTING YOUR INNER AND OUTER LANDSCAPE**

Authors **THEA MARIA MAROUN**





PERFORMATIVE NATURE

Barcelona International Landscape Architecture Biennial

September 2018 **Barcelona**

SCHOOL PRIZE

X International Landscape Architecture Biennial

Máster d'Arquitectura del Paisatge -DUOT - UPC
ETSAB- Escola Tècnica Superior
d'Arquitectura de Barcelona
Avenida Diagonal, 649 piso 5
08028 Barcelona-Spain

TECHNICAL DOSSIER

Title of the project BEYOND THE SENSES: CONNECTING YOUR INNER AND OUTER LANDSCAPE
Authors THEA MARIA MAROUN
Title of the course CULTURAL LANDSCAPE DESIGN
Academic year YEAR 3
Teaching Staff DR. MARIA GABRIELLA TROVATO
Department/Section/Program of belonging LANDSCAPE DESIGN AND ECOSYSTEM MANAGEMENT
University/School AMERICAN UNIVERSITY OF BEIRUT

Written statement, short description of the project in English, no more than 250 words

THE SITE IS LOCATED IN A COASTAL VILLAGE IN NORTH LEBANON CALLED ANFEH. THE VILLAGE IS CHARACTERIZED BY ITS RICH CULTURAL HISTORY. IT IS THREATENED BY URBAN DEVELOPMENT PROJECTS THAT ARE ENDANGERING THE CULTURAL ELEMENTS THAT CONSTITUTE THE PRIDE OF THE VILLAGE SUCH AS THE SALT PANS. MOREOVER, THE SITE IS LOCATED ON A STEEP HILL, AND IT IS ONE OF THE FEW REMAINING IN LAND SALT PANS. IT IS CHARACTERIZED BY STRONG WINDS, CONTRASTS OF COLORS, TEXTURES AND SENSATIONS DUE TO THE DIFFERENT MICROCLIMATES WHILST MOVING THROUGH THE SITE. THE DESIGN PREMISE IS THEREFORE BASED ON THESE DIFFERENT SENSORY EXPERIENCES. SENSORY HOMOGENEITY IS BECOMING SYNONYMOUS OF OUR MODERN WORLD. THE FIRST OF THESE IS THE GROWING DOMINANCE OF VISION IN THE HIERARCHY OF THE SENSES. THE SENSE OF VISION IS DISTANCING, PLACING THE OBSERVER OUTSIDE OF THE SCENE WHEREAS THE OTHER SENSES PROVIDE A MORE INTERACTIVE IMMENSE EXPERIENCE WITH THE SURROUNDING ENVIRONMENT. THEREFORE THE AIM OF THE DESIGN IS TO PROVIDE A MULTISENSORY EXPERIENCE FOR THE VISITORS AND ENCOURAGE THE INTERACTION BETWEEN THE ENVIRONMENT AND THE INDIVIDUAL WHILST CREATING SPACES OF WARMTH, COLOR, LIGHT, SOUND, SMELLS AND TEXTURES. AND FINALLY TO PROVIDE AN ALTERNATIVE TOURISTIC ACTIVITY THAT WOULD BE UNIQUE TO ANFEH ALLOWING THE EXPLORATION OF PERSONAL AND CULTURAL SPACES THAT WOULD HIGHER THE VALUE OF THE TOWN IN THE EYE OF THE GOVERNMENT AND THE LEBANESE CITIZEN.

For further information
Máster d'Arquitectura del Paisatge -DUOT - UPC

T: + 34 93 401 64 11 / +34 93 552 0842
Contact via email at: biennal.paisatge@upc.edu
Consult the web page <http://landscape.coac.net/>



SENSORY ANALYSIS AND POTENTIALS

- 1** SOUND OF WATER MOVEMENT
During winter and storms
- 2** RAILWAY FOCAL POINT obligates viewer to move
- 3** FOCAL POINT: Mystery, energy, ascending topography
Triggers the users imagination, creates an element of mystery to draw the user in
- 4** CONTRAST between concrete salt pans and natural area around it
Allows color play during different seasons and different periods of the day
- 5** WIND ENERGY PERMANENTLY SHAPED THE LANDSCAPE
- 6** SPRING LUSH VEGETATION VS. SUMMER DULL COLORS
Seasonal advantages
- 7** VISUAL TEXTURAL AND COLOR DIFFERENCES:
Changes of the colors of the landscape
Allows for an alternative meditative experience
- 8** MAN MADE WALL RUINS: Archeological Potential
Educational points about the history of anfeh
- 9** CAVES: Seasonal treasures to discover
Moments of Darkness vs. Moments of light
Discovery potentials and land shaping to highlight certain aspects of anfeh's culture
- 10** ABRUPT CHANGES IN TOPOGRAPHY: Cliffs and meadows
-Spatial diversity
-Different micro-climates



EXISTING CONDITIONS

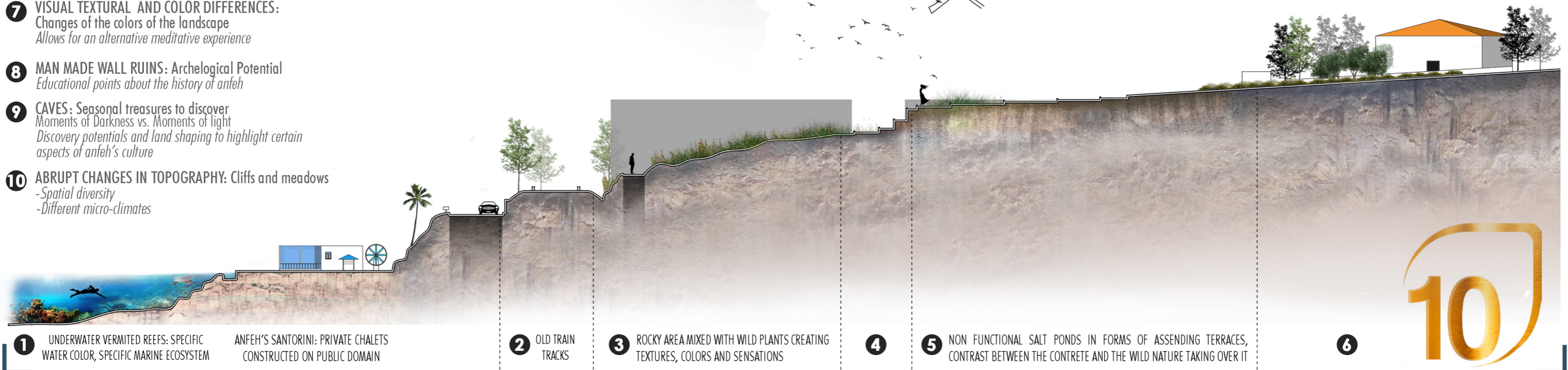

1 UNDERWATER VERMITED REEFS: SPECIFIC WATER COLOR, SPECIFIC MARINE ECOSYSTEM

ANFEH'S SANTORINI: PRIVATE CHALET'S CONSTRUCTED ON PUBLIC DOMAIN

2 OLD TRAIN TRACKS

3 ROCKY AREA MIXED WITH WILD PLANTS CREATING TEXTURES, COLORS AND SENSATIONS

4 **5** NON FUNCTIONAL SALT PONDS IN FORMS OF ASCENDING TERRACES, CONTRAST BETWEEN THE CONCRETE AND THE WILD NATURE TAKING OVER IT

6

10



1 OLIVE AND ORANGE PLANTATIONS: Natural wind chimes with aromatic potential



2 NATURAL GATHERING AREA: Rocky outcrops shaped to create a natural gathering area



3 SEMI GUIDED WALK: Wooden Rods Disposed along the site to facilitate the movement through the site: the visitor will still have the freedom to explore the site but will also be helped in knowing in which direction it is easier and safer to walk.

DESIGN INTERVENTIONS

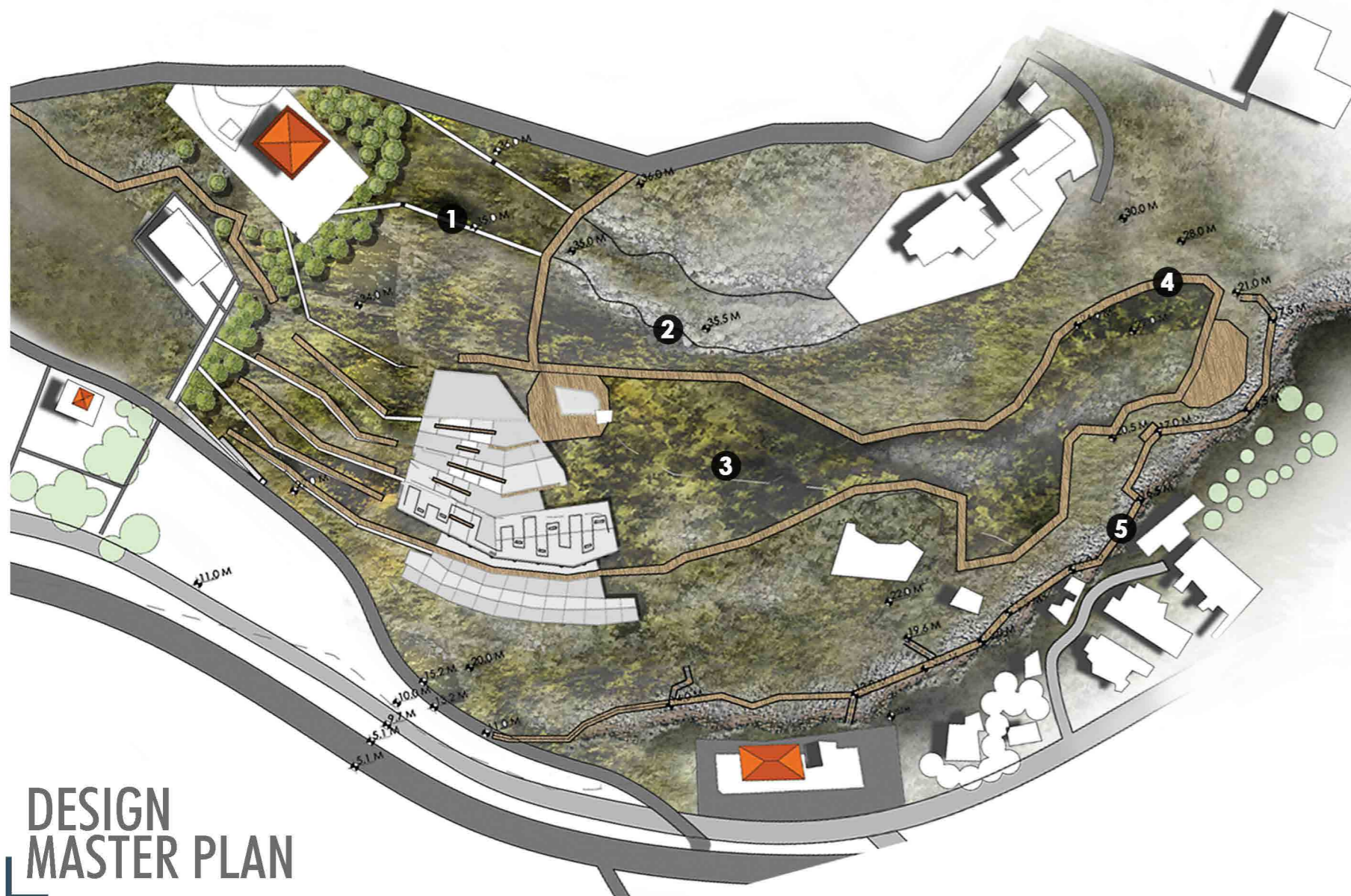

DESIGN
MASTER PLAN

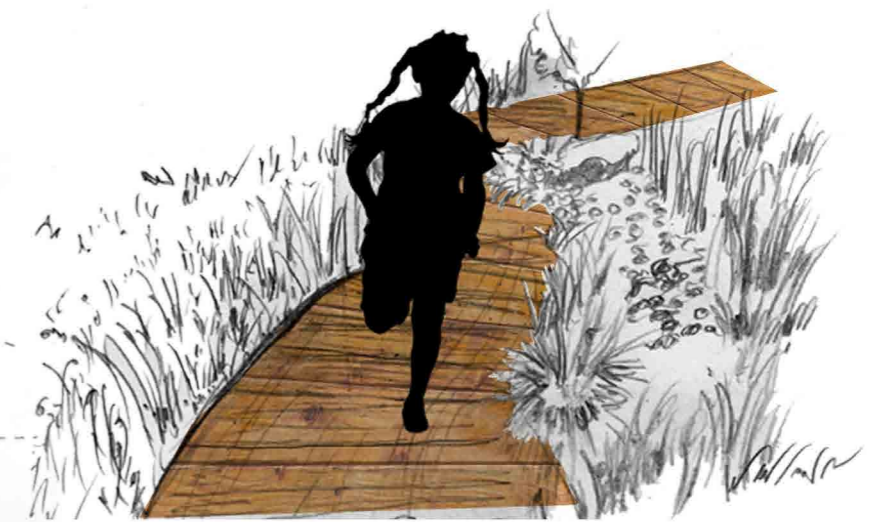

4 GUIDED WALKS: Going through the whole site and passing through the different micro-climates

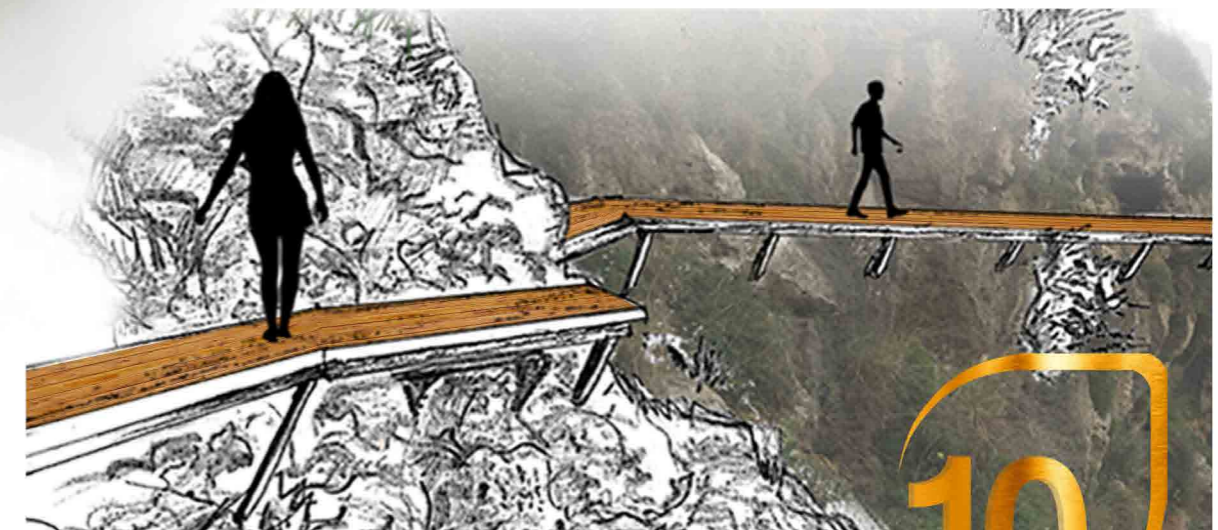

5 CLIFF WALKS: Walk on a suspended passerelle going through the caves

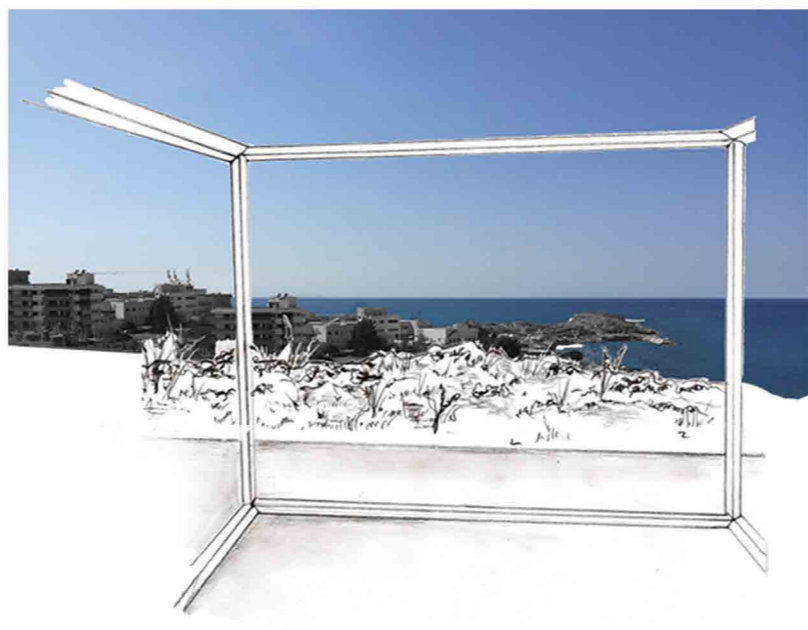
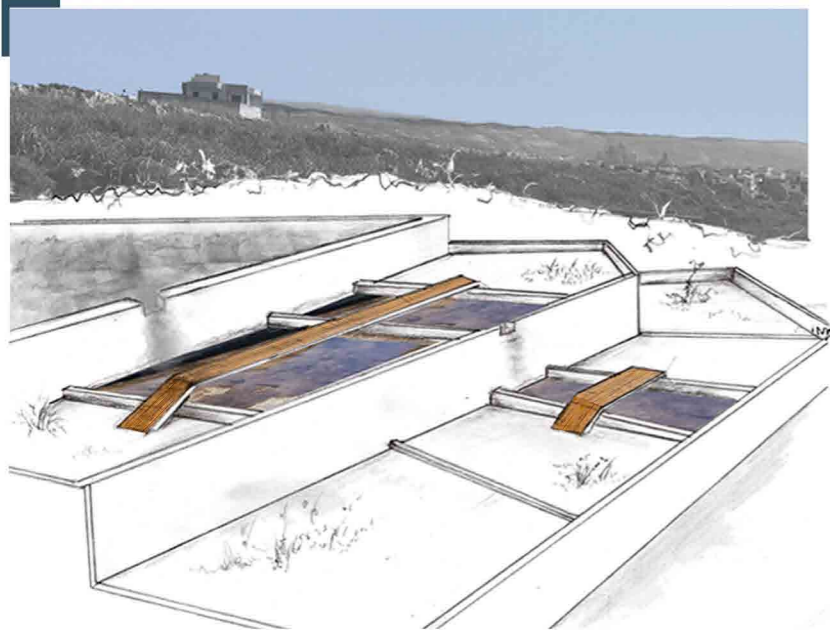

1 REACTIVATION of the existing water system to create a sea water cascade

2 FRAMING the historical and cultural elements of anfeh with info points explaining to the viewer what is he looking at at each frame

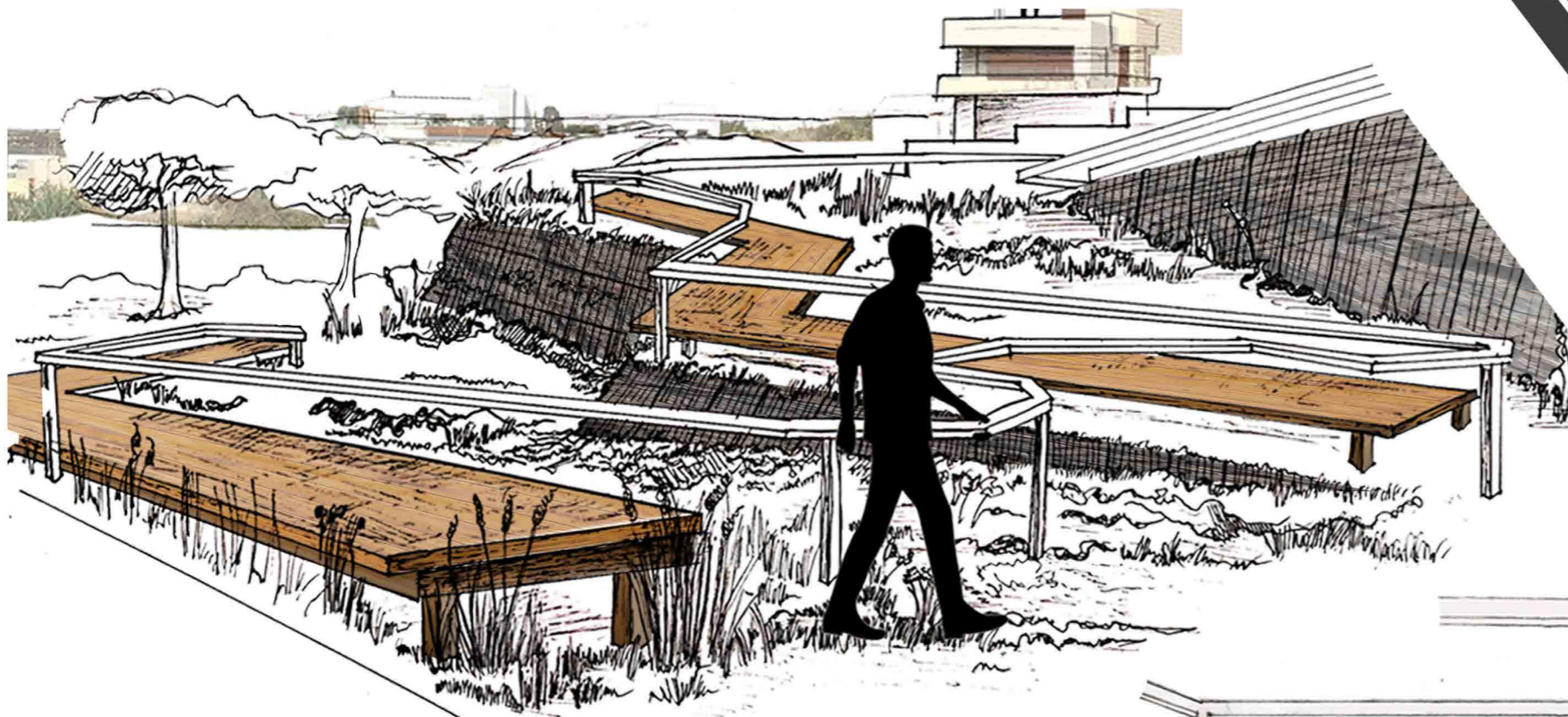
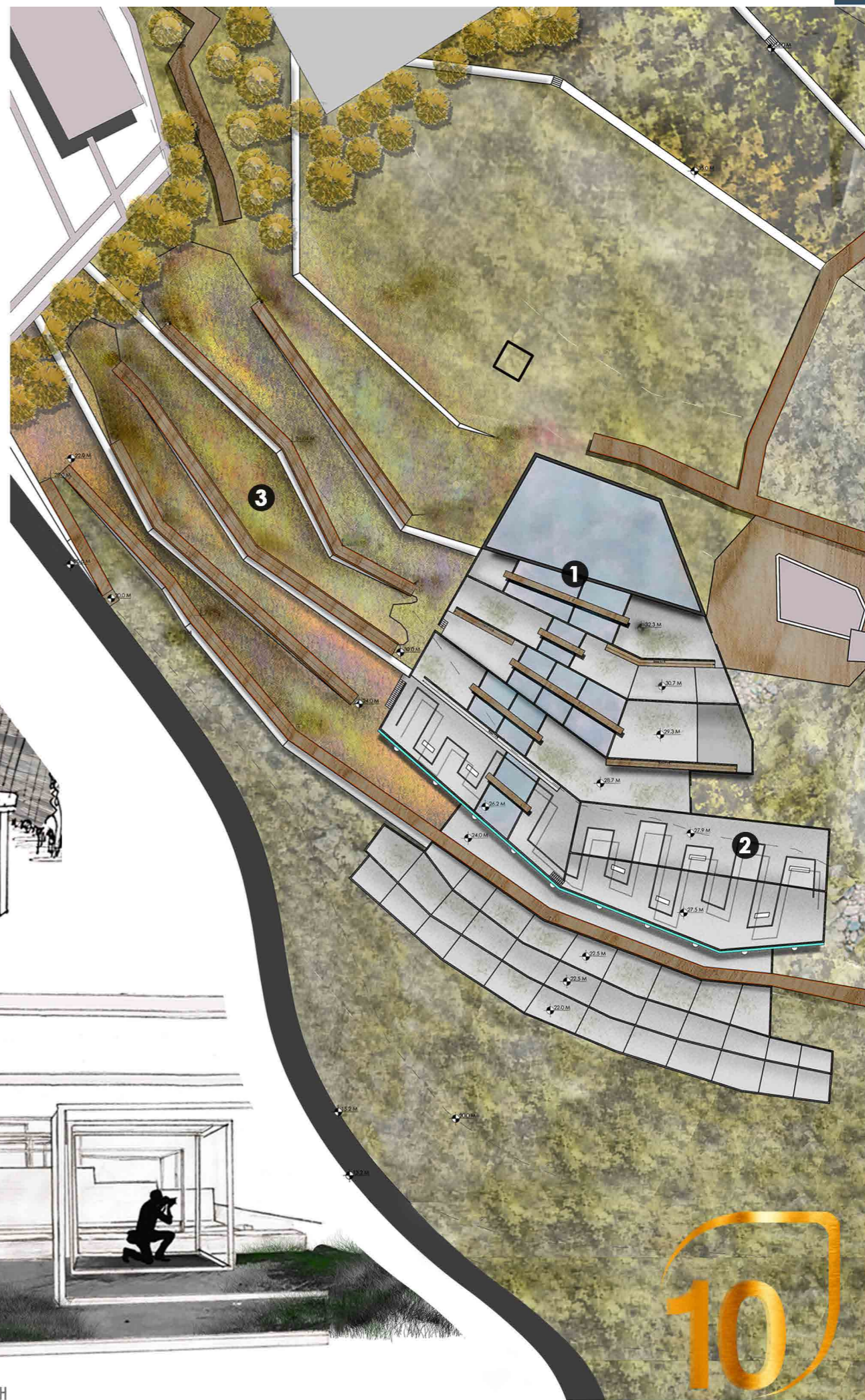

3 SENSORY PARK: Different terraces with gabion retaining walls, offering different sensory experiences.

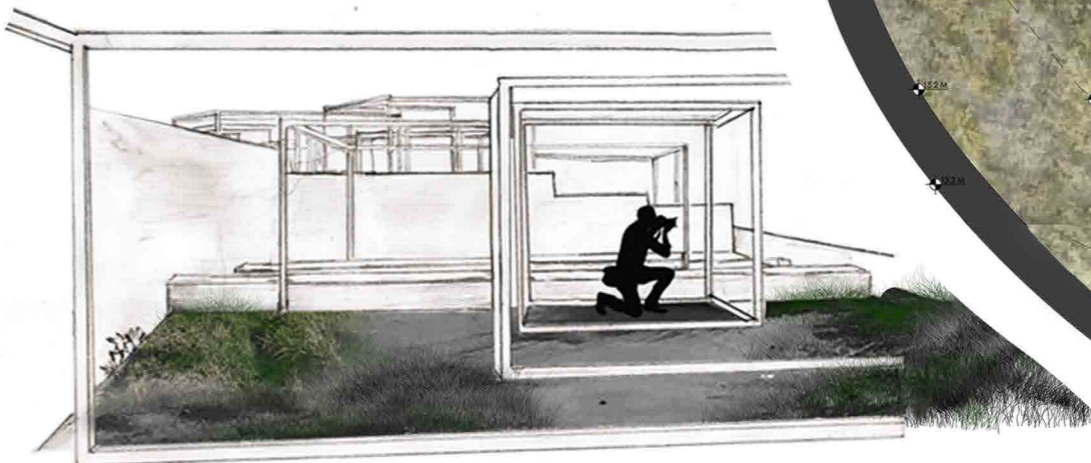

2 A WALK THROUGH THE HISTORY OF ANFEH

DETAILED AREA: THE SENSORY PARK

CREATE SPACES OF WARMTH, LIGHT, SOUND, SMELLS AND TEXTURES

The visitor can choose one of two experiences: The blinded experience where the visitors have to rely on their other senses to be able to guide themselves. This means that the visitor is blindfolded, he has to orient himself according to his senses. For each direction change, the texture of the hand rail will change, indicating to the visitor that he has to change direction. This vegetation also provides contrasts in colors, textures and aromas for the people that choose not to use the blindfolds.