



*growing tourists*

Country / City

SPAIN

University / School

LAS PALMAS DE GRAN CANARIA UNIVERSITY / ARCHITECTURE SCHOOL

Academic year

2017

Title of the project

GROWING TOURISTS

Authors

PATRICIA BERENQUER ANTEQUERA





# PERFORMATIVE NATURE

Barcelona International Landscape Architecture Biennial

September 2018 **Barcelona**

SCHOOL PRIZE

X International Landscape Architecture Biennial

Máster d'Arquitectura del Paisatge -DUOT - UPC

ETSAB- Escola Tècnica Superior

d'Arquitectura de Barcelona

Avenida Diagonal, 649 piso 5

08028 Barcelona-Spain

## TECHNICAL DOSSIER

Title of the project ..... GROWING TOURISTS  
Authors ..... PATRICIA BERENGUER  
Title of the course ..... PFC  
Academic year ..... 2017  
Teaching Staff ..... Ángela Ruiz (tutor), Juan A. González Pérez, Manuel Feo Ojeda, Juan Manuel Palerm, Pedro Romera.  
Department/Section/Programofbelonging ..... ARCHITECTURE AND LANDSCAPE RESEARCH GROUP  
University/School ..... LAS PALMAS DE GRAN CANARIA UNIVERSITY/ ARCHITECTURE SCHOOL

Written statement, short description of the project in English, no more than 250 words

.....  
Against a globalized society, where the natural landscape has lost its historical value, where traditional architecture has been relegated to the background, the idea is to promote an agricultural environment, by incorporating a different activity such as tourism.

.....  
This project is located on Tenerife island. It fuses the cultivation of banana plantations with sustainable tourism. It takes into account the elements that make up the existing landscape such as terraces, water ponds and traditional irrigation. Based on these structuring elements of the landscape, a hotel is integrated in order to fade into the landscape. In this way, two different activities are included in the same space, revaluing the agricultural landscape and maintaining the main source of income of the region.

.....  
For further information

**Máster d'Arquitectura del Paisatge -DUOT - UPC**

T: + 34 93 401 64 11 / +34 93 552 0842

Contact via email at: [biennial.paisatge@upc.edu](mailto:biennial.paisatge@upc.edu)

Consult the web page <http://landscape.coac.net/>



TERRITORIAL ELEMENTS THAT DEFINE THE LANDSCAPE

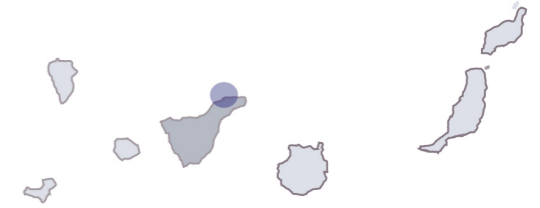
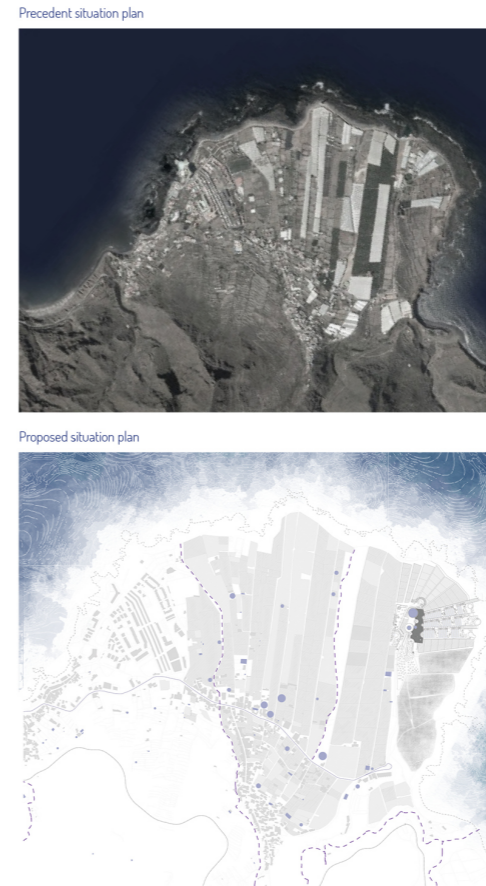
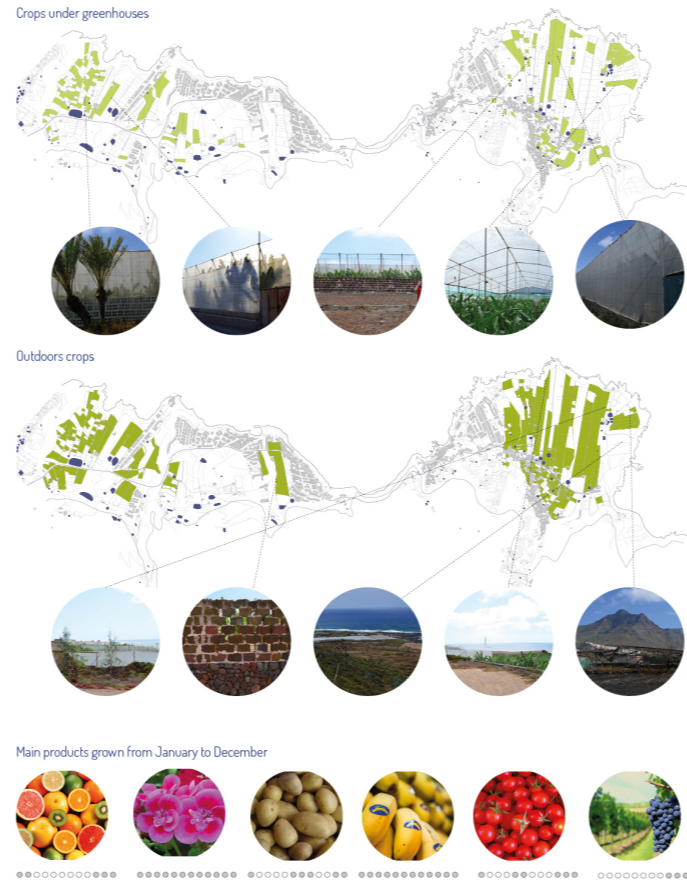
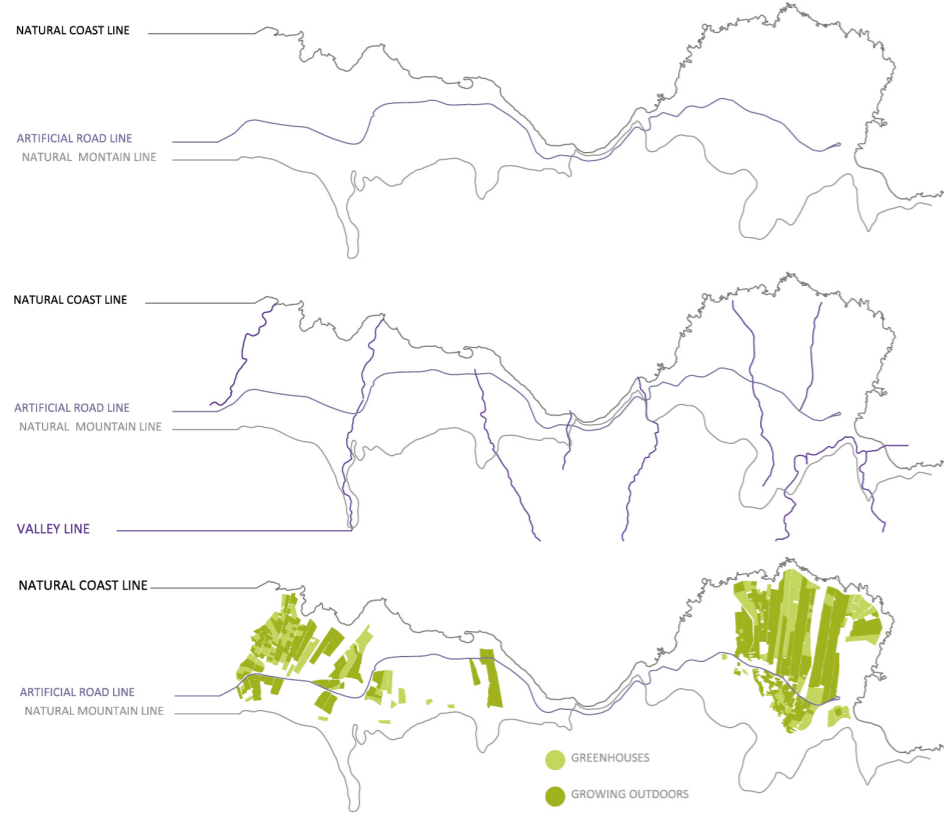

The project is located in the North of Tenerife Island. In Bajamar-Punta del Hidalgo's landscape exists three distinguish lines; two boundary natural lines (mountains and coast) and between them the artificial line of the main road. These three lines are perpendicularly crossed by the terraced crops (structuring element of the agricultural landscape). The landscape is mainly shaped by open air and green house banana plantations.

The crop lines are placed in parallel to the topography lines. New edifications are placed on the footprints created by the pre-existent crops, leaving a trace on the territory.

We decided to base in that pre-existence any action line for future developments.

Based on that premise, we chose the built elements without a direct relation to the landscape or the plantation lines, and we use them as a hinge element to connect the coast and the mountain line, creating a continuous landscape stripe.

The water element is crucial for the plantation system to work correctly, this is why we need to relate the reservoirs with other similar water container systems as the natural pools. Those are architectural elements that support the crops and at the same time confine and shape the landscape.

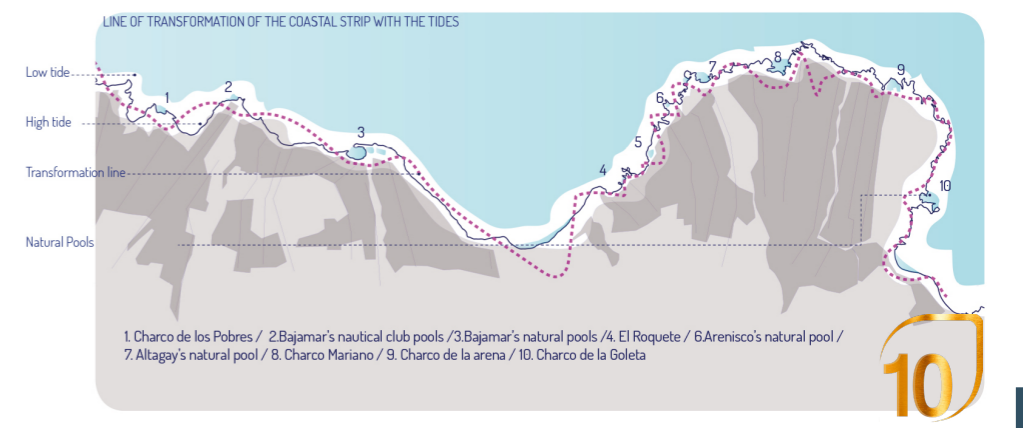
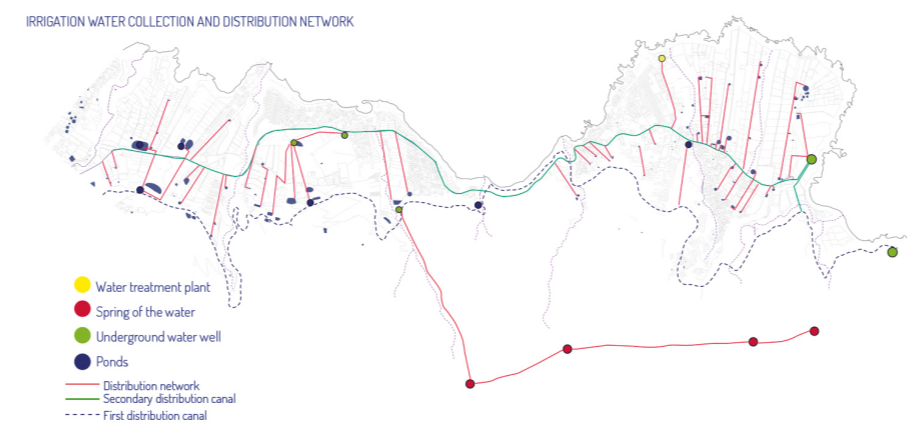
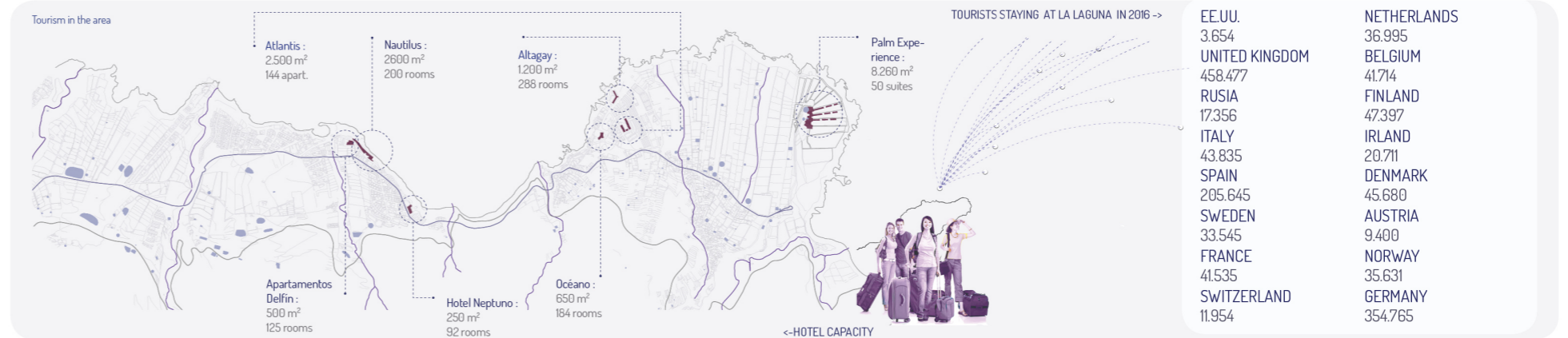
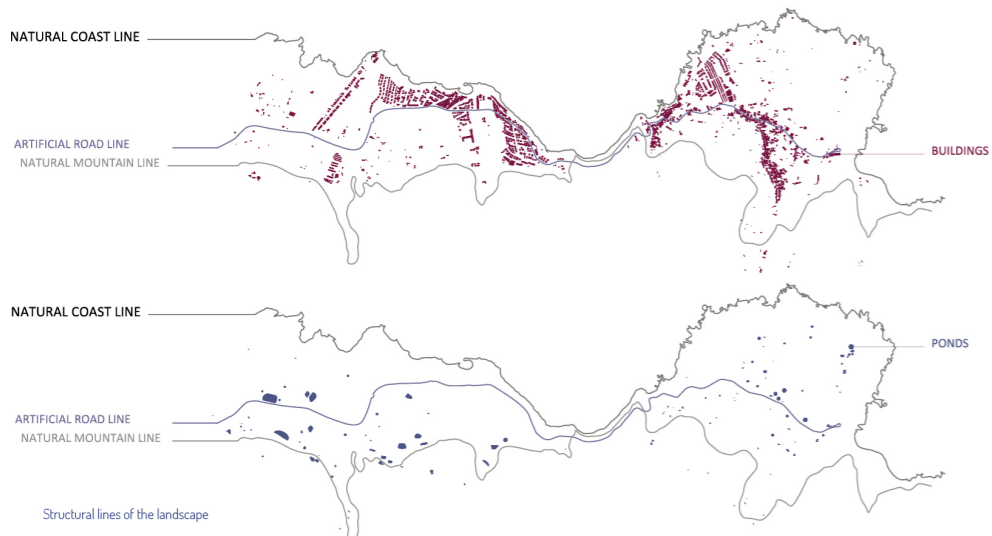
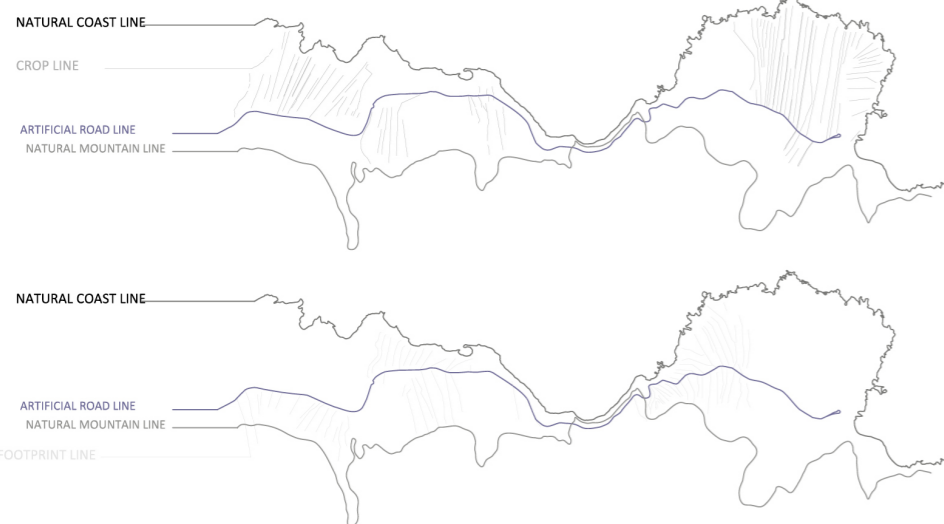



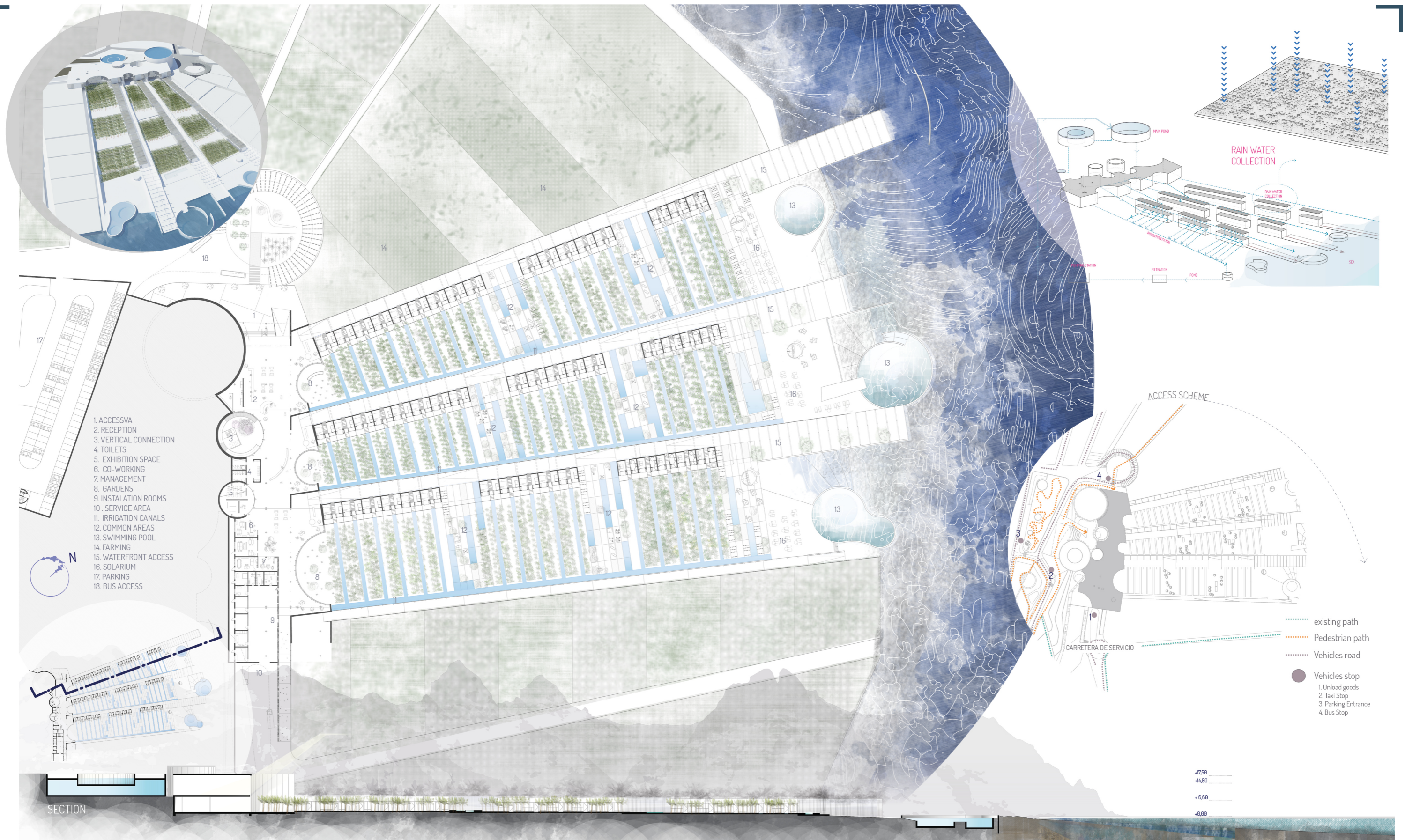

- 1. ACCESSVA
- 2. RECEPTION
- 3. VERTICAL CONNECTION
- 4. TOILETS
- 5. EXHIBITION SPACE
- 6. CO-WORKING
- 7. MANAGEMENT
- 8. GARDENS
- 9. INSTALATION ROOMS
- 10. SERVICE AREA
- 11. IRRIGATION CANALS
- 12. COMMON AREAS
- 13. SWIMMING POOL
- 14. FARMING
- 15. WATERFRONT ACCESS
- 16. SOLARIUM
- 17. PARKING
- 18. BUS ACCESS

ACCESS SCHEME

- existing path
- Pedestrian path
- Vehicles road
- Vehicles stop
  - 1. Unload goods
  - 2. Taxi Stop
  - 3. Parking Entrance
  - 4. Bus Stop

SECTION

- +7.50
- +4.50
- +6.60
- +0.00

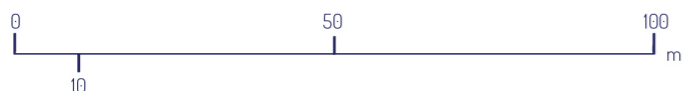



The hotel room is designed with the same concept as the rest of the hotel. The existing water ponds are used to create a row of irrigation canals that go through each and every one of the hotel rooms. This provides a sensorial tour and the possibility of having water available for the irrigation of the banana trees. A system of rain water collection is proposed in the roofs of the rooms.

Therefore we offer high quality tourism integrated into the agricultural landscape. Each room has its own banana plantation that gives privacy to the room in relation to the rest of the hotel. It also serves to immerse the visitor in the centuries-old customs of the islands.

Simply a new form of making tourism.



Outdoor area between rooms

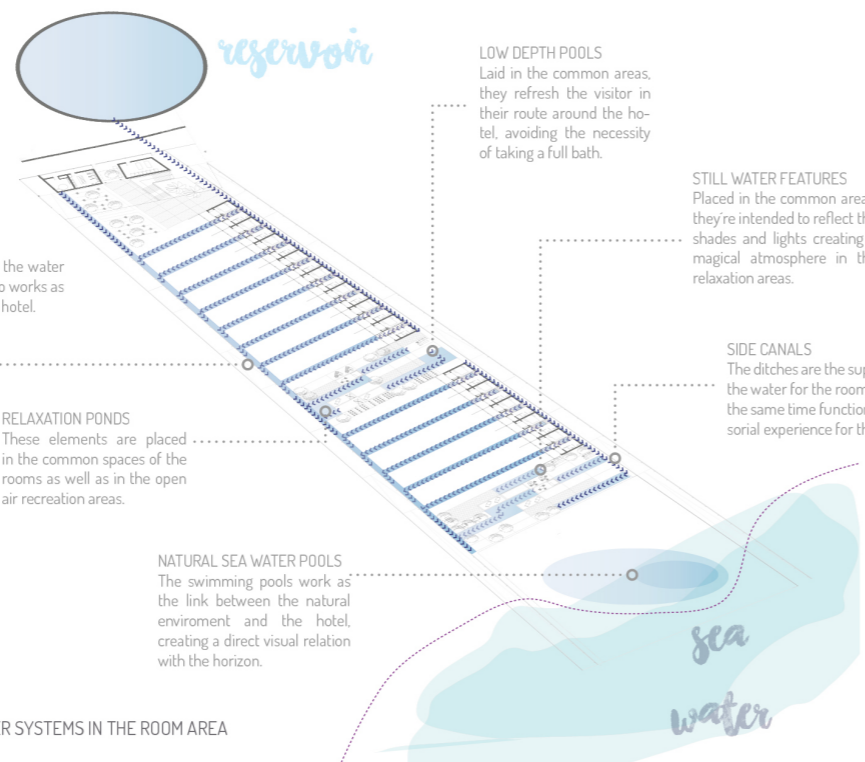
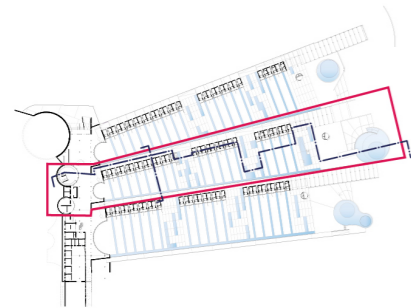

WATER SYSTEMS IN THE ROOM AREA

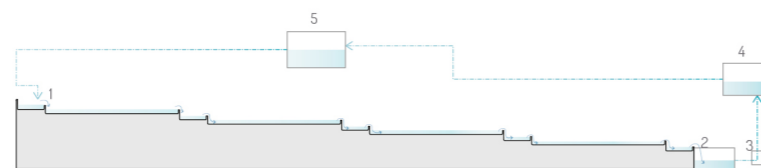

Itinerary of the water that go into the rooms

1. Decantation of water by gravity
2. Collection deposit
3. Filtration
4. Pumping station
5. Main pond



0 1 m

PRIVACY SCHEME OF THE ROOMS



FINGER DETAILED FLOORPLAN

