



Country / City Italy, Bari

University / School Polytechnic University of Bari

Academic year 2015/2016

Title of the project Recycle Barcelona. New Life Cycles for Drosscapes.

Authors Giuseppe Di Fede, Greta Girone, Nicola Lamanna, Beatrice Messa, Carla Pugliese, Antonella Santoro





PERFORMATIVE NATURE

Barcelona International Landscape Architecture Biennial

September 2018 **Barcelona**

SCHOOL PRIZE

X International Landscape Architecture Biennial

Máster d'Arquitectura del Paisatge -DUOT - UPC

ETSAB- Escola Tècnica Superior

d'Arquitectura de Barcelona

Avenida Diagonal, 649 piso 5

08028 Barcelona-Spain

TECHNICAL DOSSIER

Title of the project Recycle Barcelona. New Life Cycles for Drosscapes.
Authors Giuseppe Di Fede, Greta Girona, Nicola Lamanna, Beatrice Messa, Carla Pugliese, Antonella Santoro
Title of the course Master Degree in Architecture
Academic year 2015/2016
Teaching Staff Nicola Martinelli, Michele Montemurro, Imma Jansana, Anna Bruna Menghini
Department DICAR - DICATECh
University/School Polytechnic University of Bari, Italy

Written statement, short description of the project in English, no more than 250 words

The contemporary city is defined by processes of urban metabolism that generates wastes; a responsible proposal has to insert itself in the natural process of urban growth, being able to reduce refusals and creating new life cycles.

The proposed case-study is located between Sant'Adrià de Besòs and Badalona, naturally delimited by the river, the shore and the water channel made by the architect Solà-Morales and marked by the huge presence of the FECSA-Endesa Tres Xemeneies.

The aim is to develop a strategy of urban and landscape project which could be able to reactivate urban areas and big dismissed buildings, through processes of recycling based on the nature and culture value, understanding and respecting the natural and settlement characters of places.

The regeneration of the area starts from an unitary project of mixité, in which the landscape's structural elements build the connectors of the proposal, being able to ensure the presence of leisure places, of the bathing and sport, by guaranteeing to the cluster to be open and permeable towards the city.

We reactivate three life cycles: Industry Cycle, Knowledge Cycle, Landscape Cycle.

The Landscape cycle's strategy follows a kind of phasing that through constant processes allows the vegetation to take back naturally the polluted soil: the clean-up through phytoremediation and the following reintroduction of several native plants will allow the coastal park to recover its natural condition. The nature, through transversal ecocorridors, goes into the project, each of these is characterized by different identities (natural reserve, urban orchards, trigeneration parks).

For further information

Máster d'Arquitectura del Paisatge -DUOT - UPC

T: + 34 93 401 64 11 / +34 93 552 0842

Contact via email at: biennial.paisatge@upc.edu

Consult the web page <http://landscape.coac.net/>



Cycles reactivated



Area of project

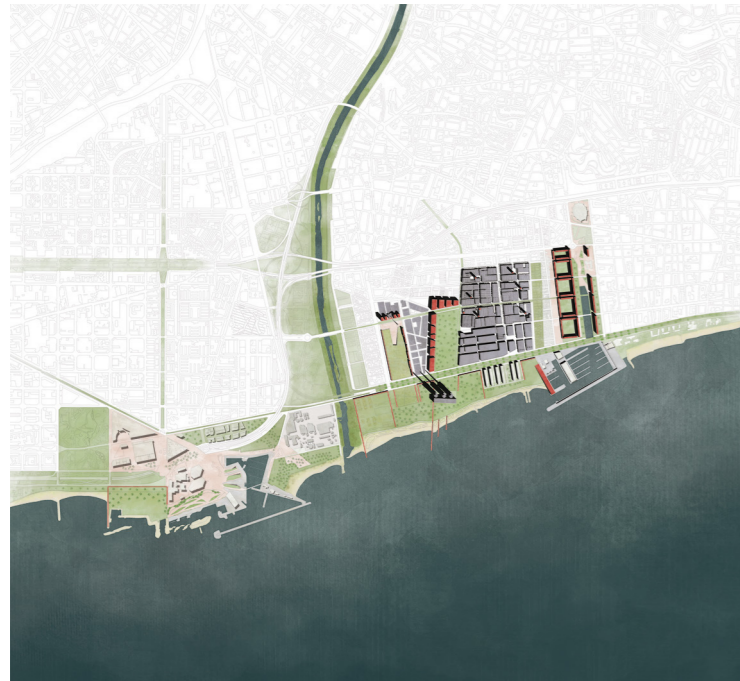

Masterplan



Plan +1,00



Axonometry

- 1. The Coastal Park
- 2. Phytoextraction
- 3. The Subcoastal Corridor
- 4. Mercado + Urban Orchards
- 5. The Cluster Park
- 6. The Recycle Hub
- 7. The Qasbah eco-district
- 8. Trigeration

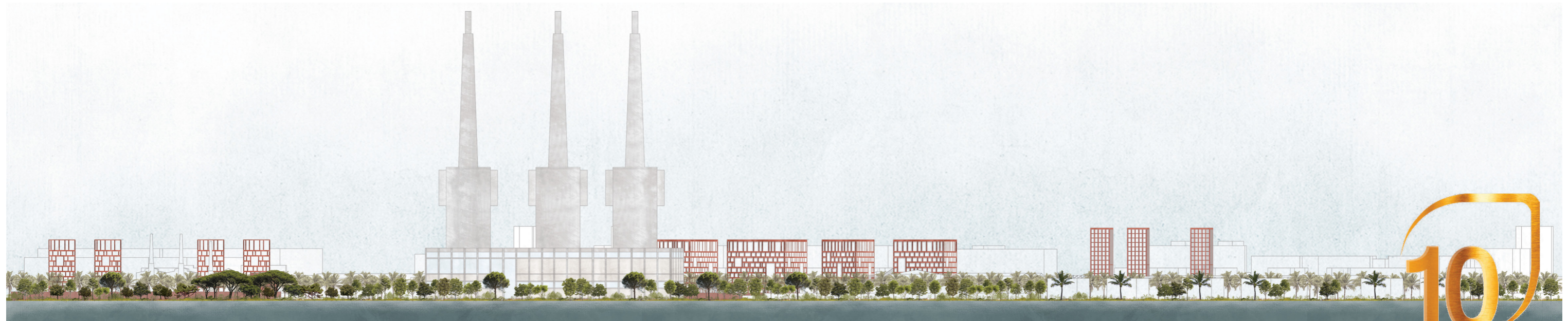

View from the sea



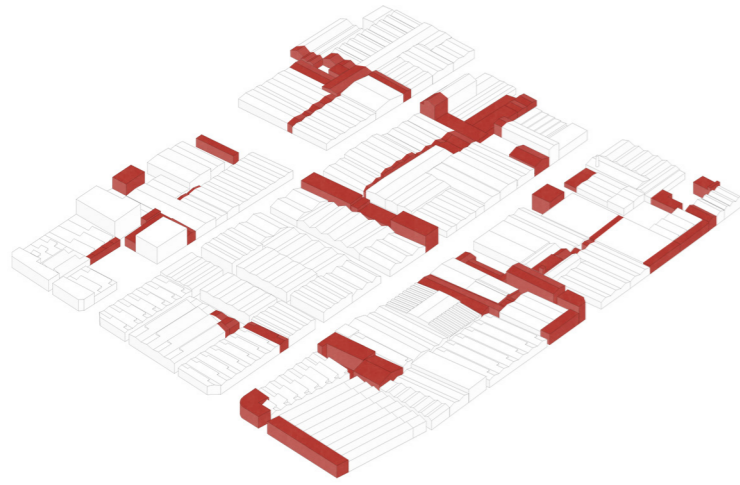

Step of the project: 1 - demolition



Step of the project: 2 - new buildings

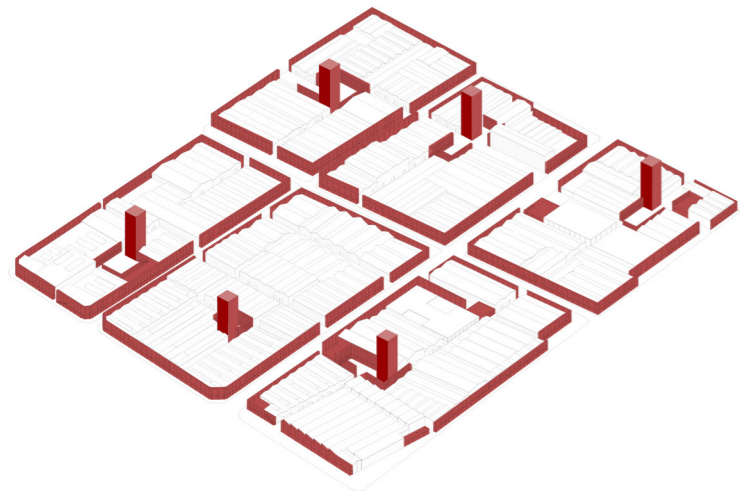

Step of the project: 3 - new fronts and towers

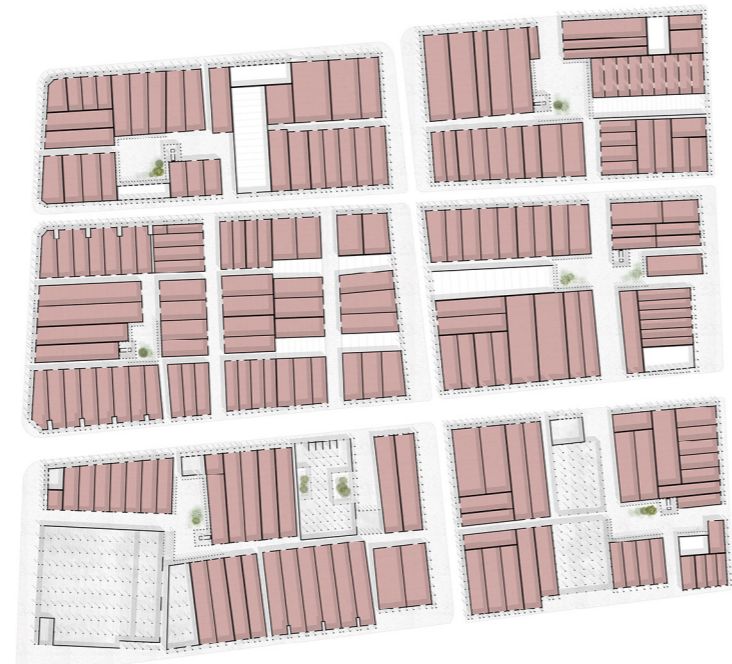

Plan +1,00



View inside the Qasbah

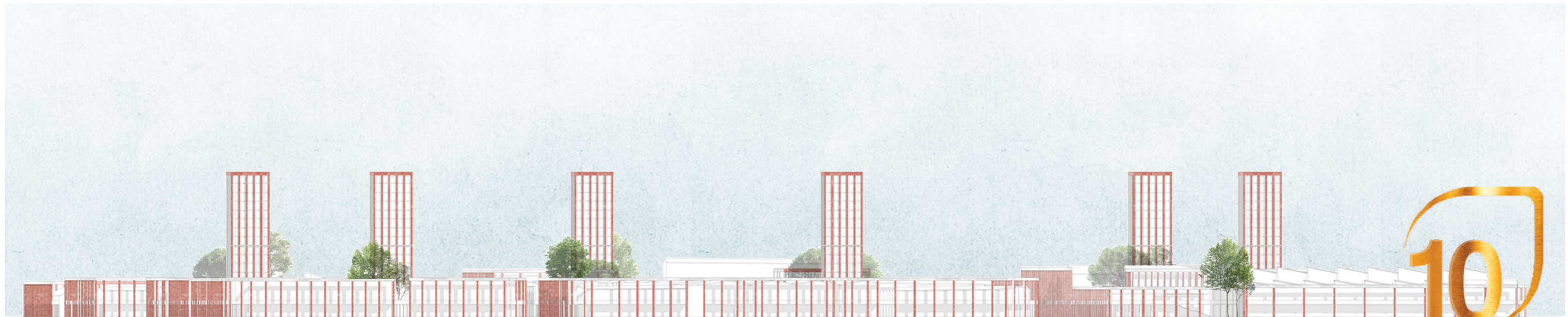

Elevation on Avenida del Maresme



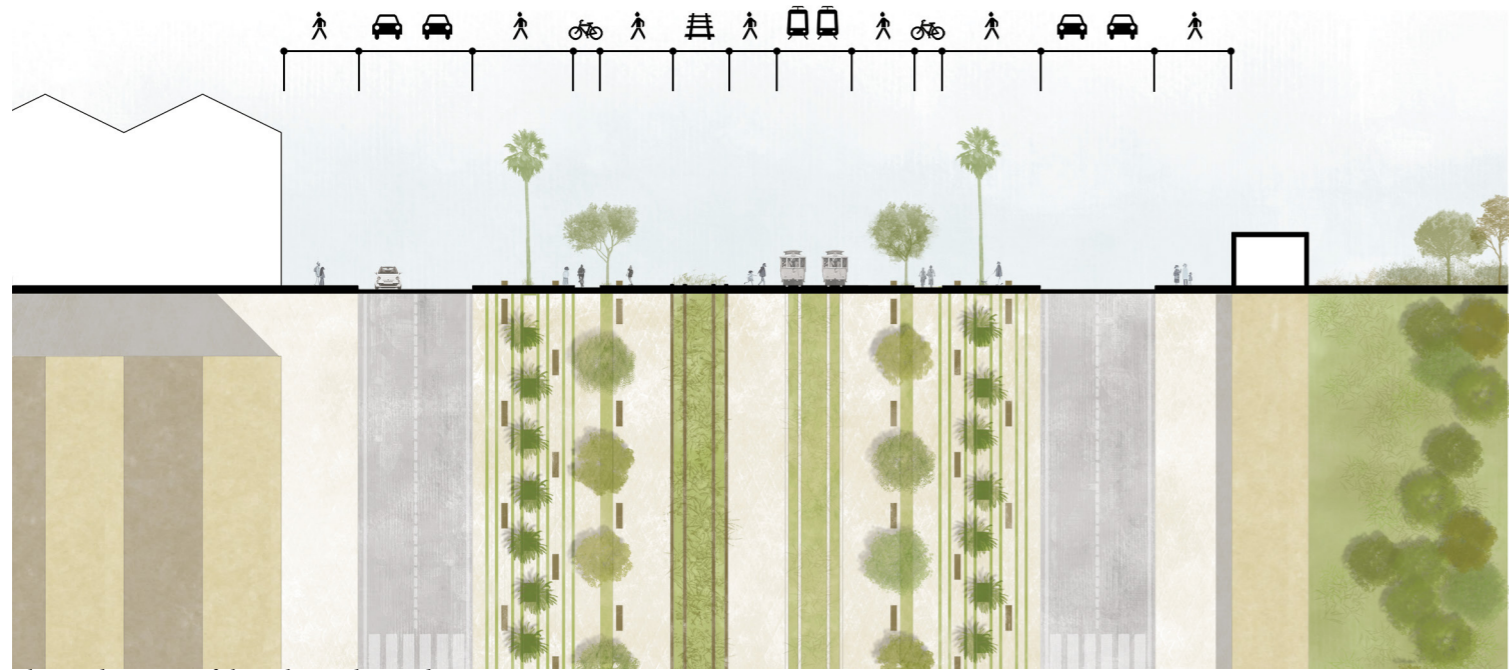

Plan and section of the subcostal corridor



PHASING PROCESS FOR RENATURALIZATION
From the polluted soil to a natural vegetation of the scrubland in the Costal Park

YEAR 0



Soil left to itself. Presence of some adventitia of crops.

YEARS FROM 1 TO 3



If the soil is of agricultural origin, it is formed directly a lawn, or you observe any pre-grass stadium in bryophytes (mosses), then a lawn.

YEARS FROM 3 TO 7



The lawn is interrupted from colonization mostly thorny shrubs. Uncultivated spiny herbaceous.

YEARS FROM 7 TO 14



The lawn surface decreases in favor of the shrubs. Among the thorny shrubs, protected from predators, they are born and develop future large trees.

YEARS FROM 14 TO 40



The trees cast a shadow that leads to decay of the shrubs that were initially protected them, but only develop if conditions are favorable. Elsewhere *friche* may hang at an earlier stage, because of poor soil. In all cases the vegetation corresponds to the *Climax*. (Cf. Gilles Clément)

ALCAMPO
MERCADO + URBAN ORCHARDS + SOCIAL HOUSING

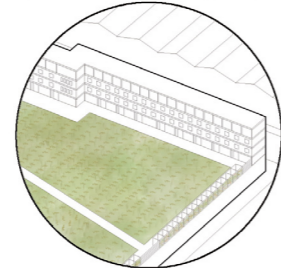

TRIGENERATION
THE ENERGY PARK

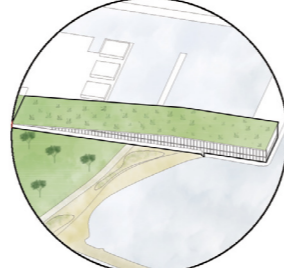

PHYTOEXTRACTION
THE RECONVERSION OF POLLUTED SOILS

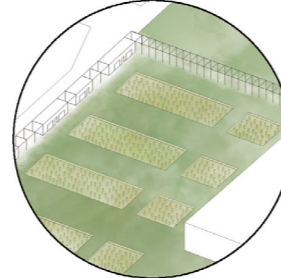

COAST
THE BEACH AND THE PIERS

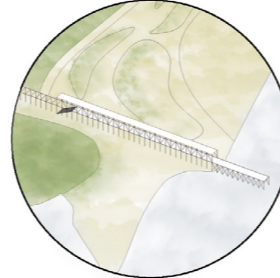

Views of the Cluster's park



Plan of the costal park

