



Country / City SPAIN

University / School UNIVERSITY OF CORUNNA - UNIVERSITY OF SANTIAGO DE COMPOSTELA- MASTER IN LANDSCAPE ARCHITECTURE JUANA DE VEGA- ETSAC

Academic year 2016/2017

Title of the project LANDSCAPE INTERVENTION IN THE VICINITY OF THE MONASTERY OF SAN BENITO DE LÉREZ

Authors JOSE BAIXAULI MUÑOZ







# PERFORMATIVE NATURE

Barcelona International Landscape Architecture Biennial

September 2018 **Barcelona**

## SCHOOL PRIZE

X International Landscape Architecture Biennial

Máster d'Arquitectura del Paisatge -DUOT - UPC

ETSAB- Escola Tècnica Superior

d'Arquitectura de Barcelona

Avenida Diagonal, 649 piso 5

08028 Barcelona-Spain

## TECHNICAL DOSSIER

Title of the project	LANDSCAPE INTERVENTION IN THE VICINITY OF THE MONASTERY OF SAN BENITO DE LÉREZ
Authors	JOSE BAIXAULI MUÑOZ
Title of the course	Master in Landscape Architecture Juana de Vega
Academic year	2016 / 2017
Teaching Staff	Cristina García Fontán / Inmaculada Romero
Department /Section	/Program of belonging SCHOOL OF ARCHITECTURE UDC- POLITECHNIC SCHOOL USC
University/School	Universidade da Coruña - Universidade de Santiago de Compostela / ETSAC

Written statement, short description of the project in English, no more than 250 words

The project focuses on the surroundings of the monastery of San Benito de Lérez located in the city of Pontevedra. The Lérez river is a structuring and generating element of the city. Near the old city there are religious buildings related to the Camino de Santiago. Within this set of buildings, we find the monastery of San Benito de Lérez, declared an Asset of Cultural Interest. The anthropic landscape has been changing over time according to human needs. River banks have been occupied to carry out agricultural activities that today, in many cases, have been abandoned. This situation has caused the spread of invasive plant species.

The main aim of the proposal is to dignify the monastery environment and to recover the agricultural activity. These new urban gardens are destined to neighbours and educational purposes. To do this, the layout of the masonry walls is rescued and the connection of the monastery with the river is strengthened through urban gardens. Finally, a new reception area is created in front of the jetty and at the beginning of the path.

The purpose of the project is to protect and recover the agricultural heritage landscape. The loss of a millenary tradition is a sufficient reason for society to understand, know, value, care for, enjoy and transmit this agricultural heritage to future generations.

For further information

Máster d'Arquitectura del Paisatge -DUOT - UPC

T: + 34 93 401 64 11 / +34 93 552 0842

Contact via email at: [biennial.paisatge@upc.edu](mailto:biennial.paisatge@upc.edu)

Consult the web page <http://landscape.coac.net/>



# 01 Se vas ó San Benitiño



Situation plan: Pontevedra



Heritage elements

## -WEAKNESSES:

- Fragile monastery and the Lérez river relationship.
- Absence of a parking area for visitors.
- Low quality of the monastery surrounding and abandonment of the cultivation terraces.

## -STRENGTHS:

- The agrarian landscape, in general, and the agricultural techniques applied to crops, in particular.
- Water architecture and infrastructure.
- The path that connect the Lérez river with the monastery.
- The abandoned fields and private paths allow to generate new connections.

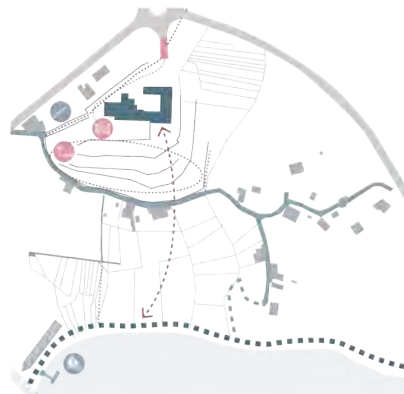

## - ACTIONS IN THE SURROUNDINGS OF THE MONASTERY OF SAN BENITO DE LÉREZ

- Eliminate the road traffic and the current parking area.
- Assign a parking space and condition the access path.
- Designate a new festival area that coexists and respects the cataloged monument as an Asset of Cultural Interest.
- Dignify the surroundings of the monument.

## - RECOVERY OF CULTIVATION TERRACES

- Recovery the layout of the masonry walls.
- Rehabilitate the recovered space to agricultural activities: new green gardens for neighbours and learning place for the children of the school.

## - STRENGTHEN THE MONASTERY-RIVER CONNECTION

- Improve and condition the staircase, the path and tconnection of the monastery with the river.
- Recover agricultural activity, valuing the architecture and water infrastructure.
- Enable a reception space in front of the jetty and the beginning of the path.

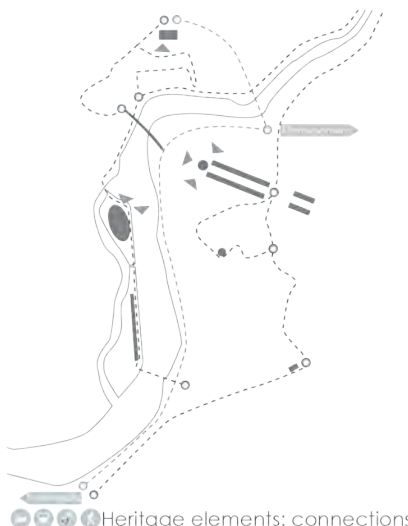

Heritage elements: connections

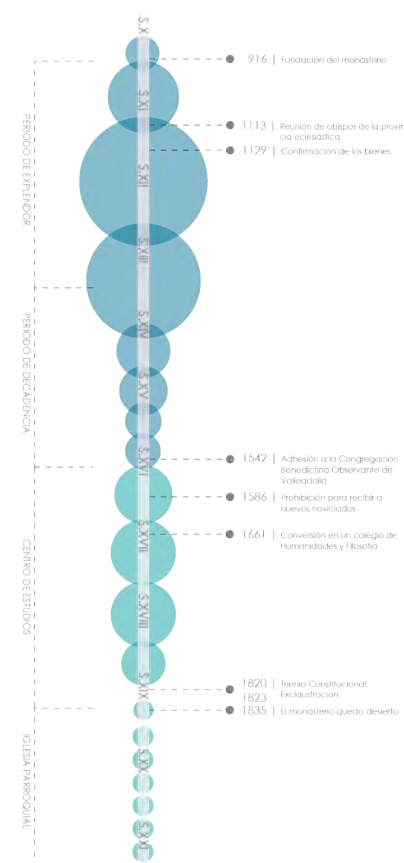
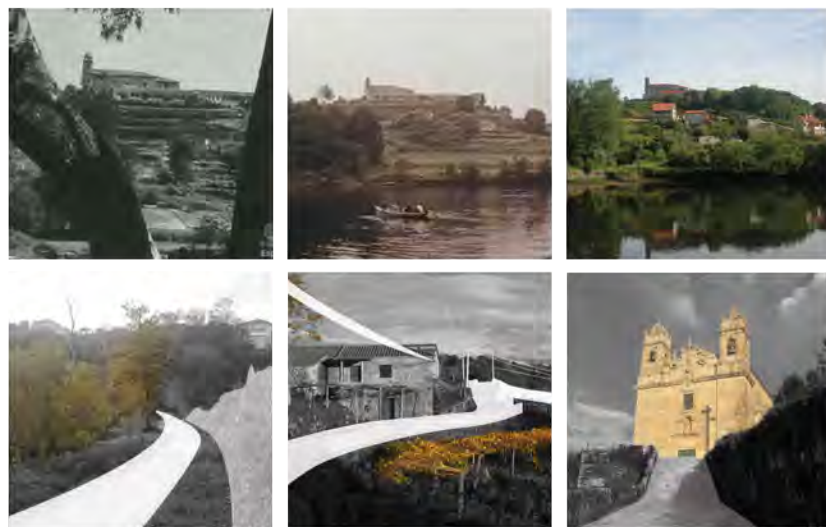

Section

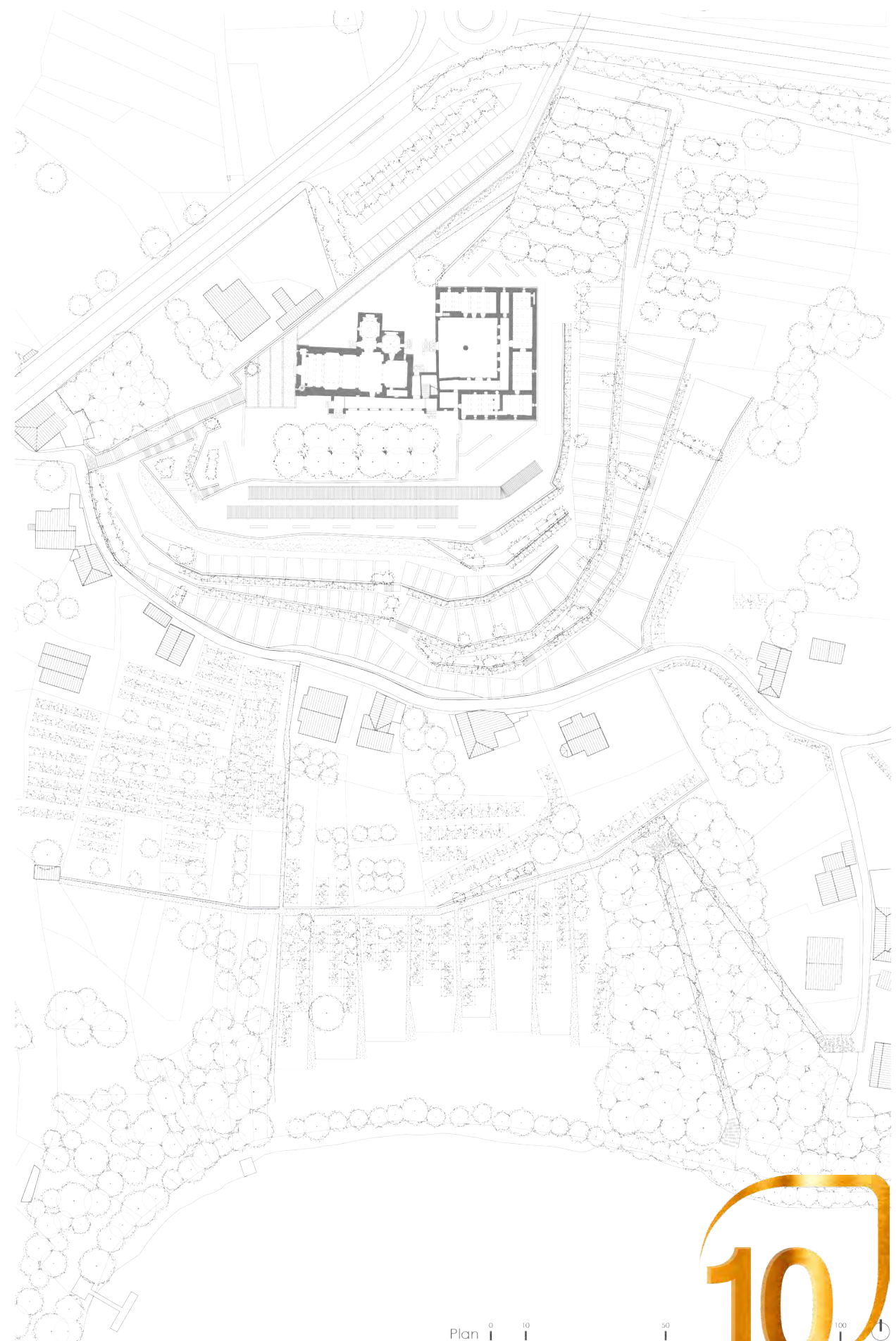

Plan 0 10 50 100



# 02 Se vas ó San Benitino

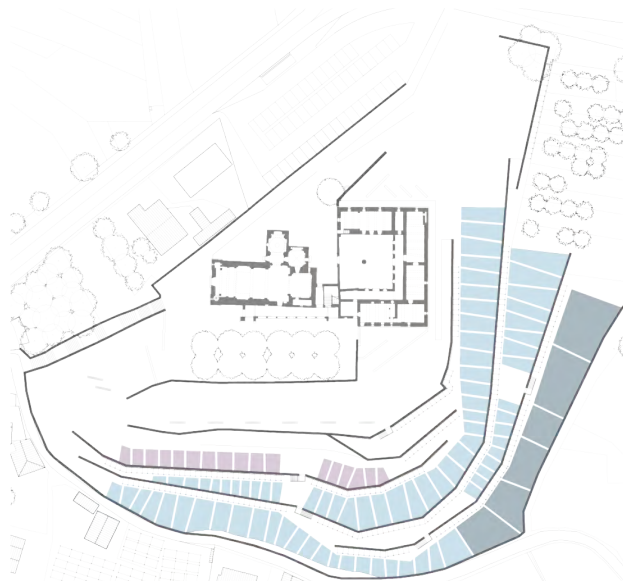

“Huertas, maizales y viñedos en parras se escalonan hasta los ríos alternando con arbolado -pinos, eucaliptos, fresnos y sauces- que cubren las orillas”

Sánchez Cantón





# 03 Se vas ó San Benitiño

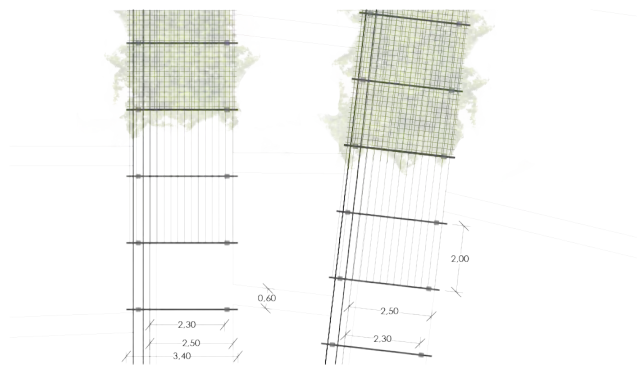
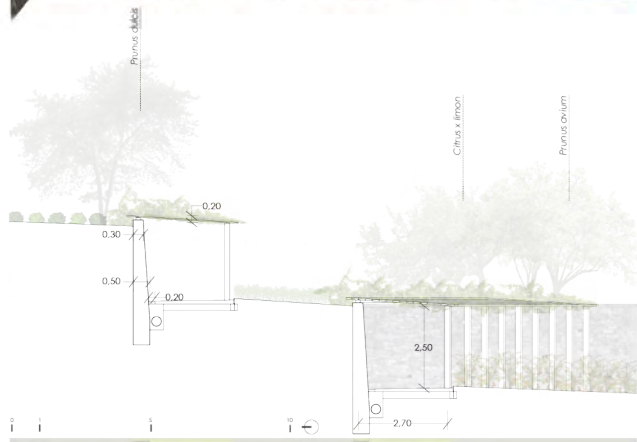
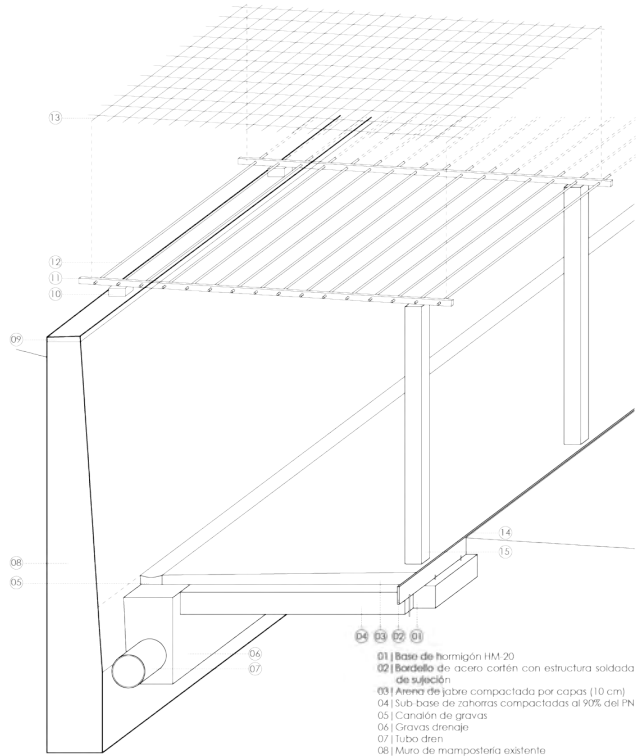

I GRUPO 1	II GRUPO 2	III GRUPO 3	IV GRUPO 4	V GRUPO 5	VI GRUPO 6	VII GRUPO 7	VIII GRUPO 8								
<i>Linum usitatissimum</i>	50%	<i>Festuca ovina glauca</i>	40%	<i>Koeleria glauca</i>	50%	<i>Thymus vulgaris</i>	60%	<i>Calluna vulgaris</i> "Firefly"	40%	<i>Erica vagans</i>	40%	<i>Erica vagans</i>	40%		
<i>Daucus carota</i>	25%	<i>Achillea millefolium</i>	30%	<i>Pimpinella anisum</i>	10%	<i>Daucus carota</i>	25%	<i>Plantago media</i>	15%	<i>Plantago major</i> "Rubrifolia"	30%	<i>Achillea millefolium</i> "Cesire queen"	30%	<i>Papaver rhoeas</i>	30%
<i>Cuminum cyminum</i>	25%	<i>Dipsacus fullonum</i>	30%	<i>Borago officinalis</i>	10%	<i>Achillea millefolium</i>	25%	<i>Papaver rhoeas</i>	15%	<i>Daucus carota</i> "Dara"	30%	<i>Achillea millefolium</i>	30%	<i>Plantago media</i>	30%

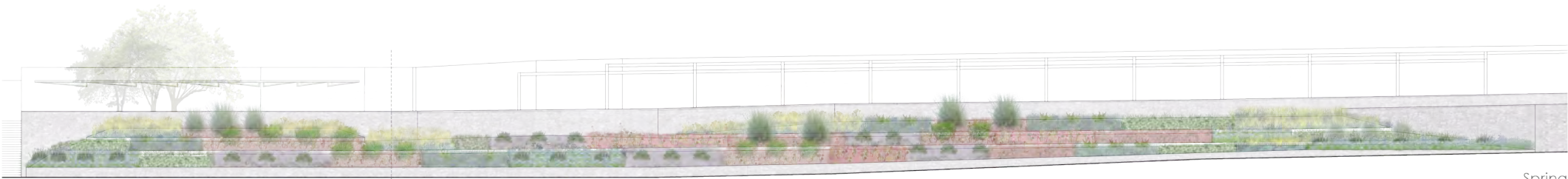

Spring

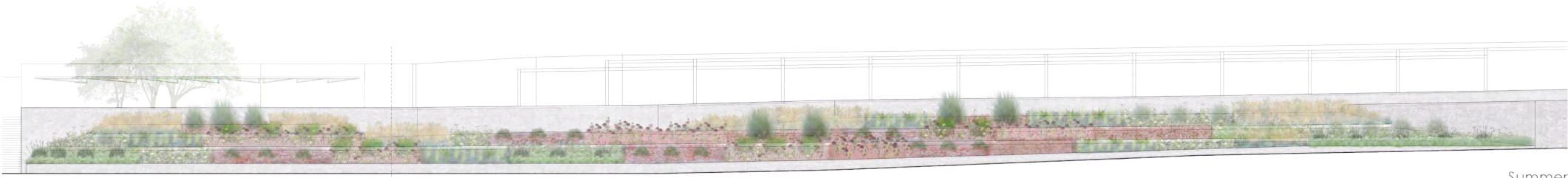

Summer

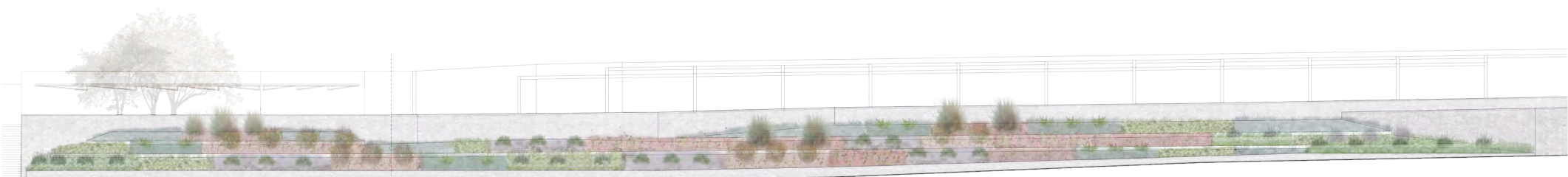

Autumn

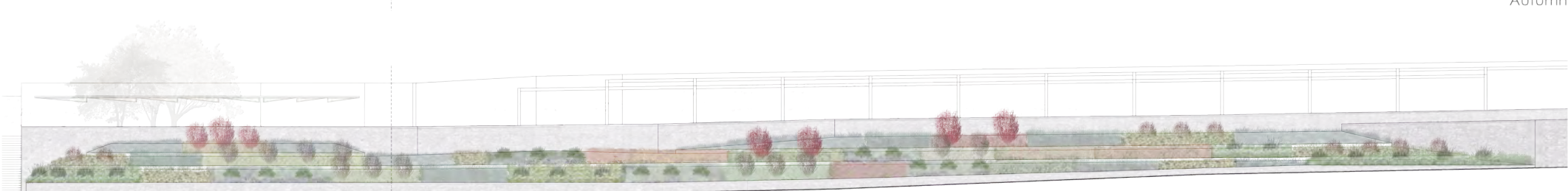

Winter

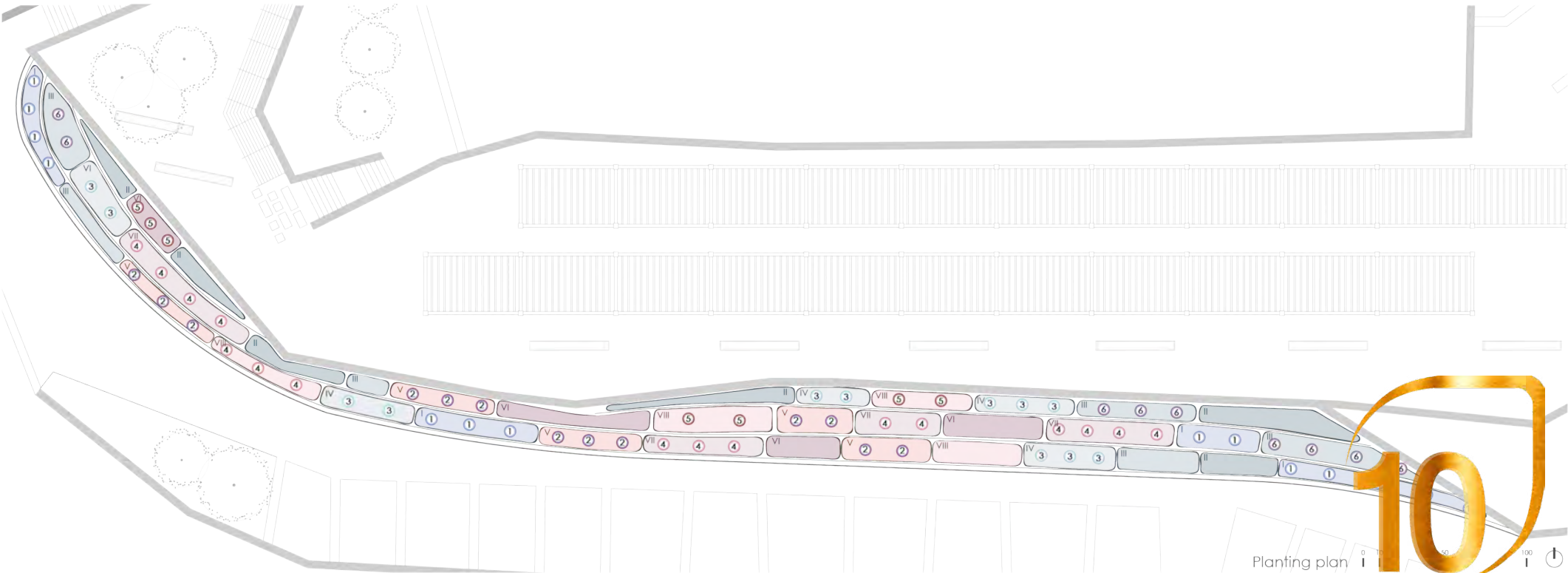

Planting plan

