



Central building and information Centre fulfills a number of functions

Country / City [New Zealand](#)
 University / School [Lincoln University / School of Landscape Architecture](#)
 Academic year [2017](#)
 Title of the project [The Legacy of Water](#)
 Authors [Jordan Derecourt](#)



The Legacy of Water

Revolutionizing farming and tourism in the Mackenzie.



Date: 21 January 2027

Time: 10am-12pm. Meet at Info Centre @ 9:45am. 2 hours or as long as you need.

Activity: 2nd Tier Riparian Planting. Bring scruffy clothes :) Gloves and Shovels provided. All ages welcome, children must be supervised around water and roads.

Location/Distance: Wairepo Arm/500m walk from meeting spot.

Value: 4 Nights in Tent site or Self contained vehicle. 2 Nights on Powered site. 1 Night in Cabin. Averaging 15-20pppp (Plants Planted Per Person)

- Please collect your plants from your site-specific tray-

Sign Up Board Below

Thanks :)

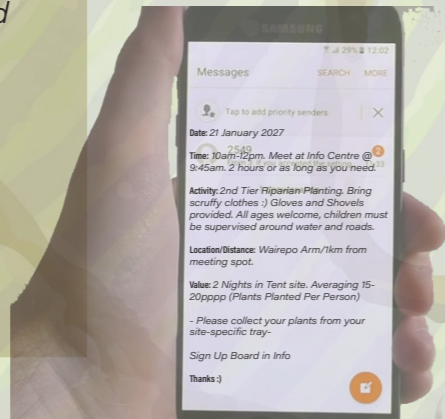

“For we so not as spectators but as participants, in the very performance of our tasks”

“The temporality of landscape is social, then, not because society provides an external frame against which particular tasks find independent measure, but because people, in the performance of their tasks, also attend to one another.”
Ingold, T. (2000).

Developing small unproductive spaces into biodiversity source patches. These will be fenced off from predators and people (aside from trapping) in order to create new habitats for species to disperse to, and consequently, from.



Purepods and self contained parking sites. Facing north/north west in an open area allows for full appreciation of the unique morning and evening light that gives Omarama "Place of Light" its name.



The wheels for the pivots are able to pass through gaps in the out wash planting. The Exotic planting mimicking the patterns of the irrigation on the landscape is set three meters out from the wheels path to ensure no damage is caused to either system, yet communicate the relationship between the two.

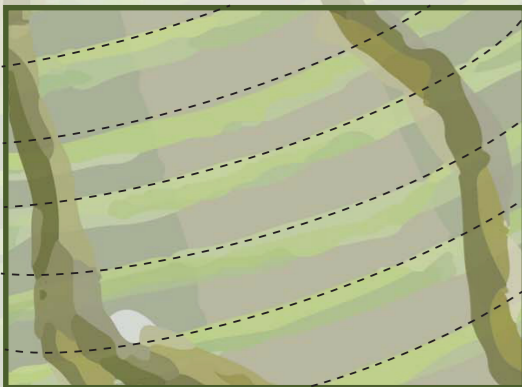

Canal Diverted

Nodes & Experience

Each building through the site has varying levels of facilities provided, corresponding with the accommodation type. With the least being at the exit, and the most at the entrance.

Circulation

A key circulation pattern change is the introduction of a "Scenic Route/ Taste trail" through the wider site. This is to encourage savoring of the landscape, not just transecting down to omarama. There is also a loose one-way system around the edge of the pond

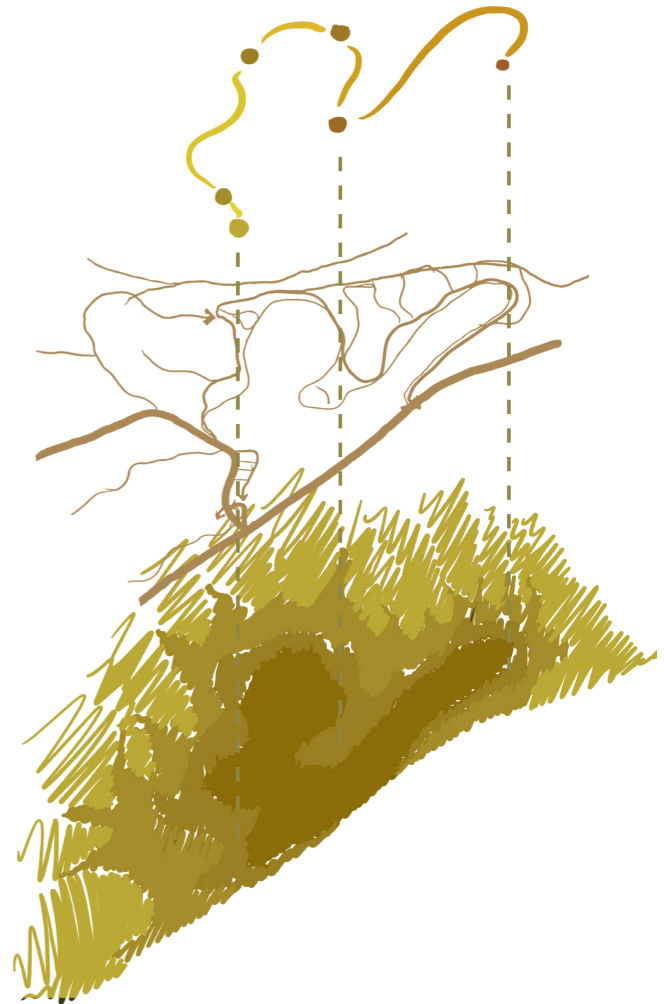

Spatial intimacy

The scale and sizes of the spaces within the site change as the user moves away from the water. This is both for climatic reasons (Shade and Wind Shelter) and to contrast the intimate spaces with the extreme "Big Sky" of the Mackenzie

Summer: Harvest and Pruning

One of the most popular tourism times of the year is the Stonefruit season, when visitors stay on the site, and simply spend one day a week, or one hour a day picking the fruit that is then either processed locally or sold fresh at the info centre.



Spring: Biodiversity management

Birdwatching in spring is also the time when there is some of the most aggressive trapping occurring. Participants are escorted with a guide the initially, after which they can check and reset traps themselves. There is also educational events run



The Legacy of Water

Catalyzing a resilient, community driven, sustainable, and productive landscape change.

Creating an entry experience that epitomizes the experiences available through the landscape and leaves emphasis upon the expansive sky and distinctive landscape.

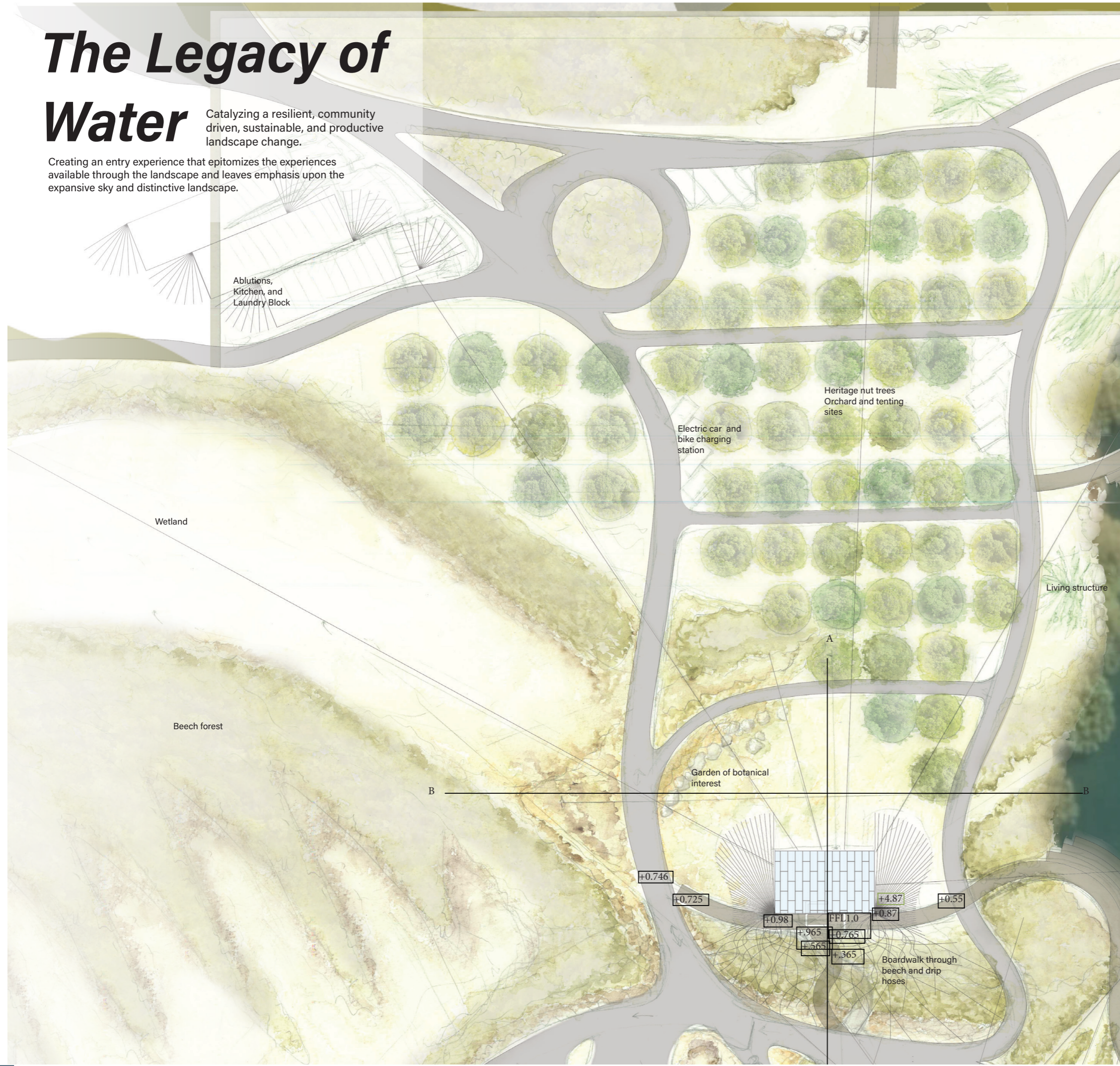

Suitable for a range of users



Immersing users in the landscape



Creating a variety of holiday experiences



VIEWLINES AS PEOPLE MOVE

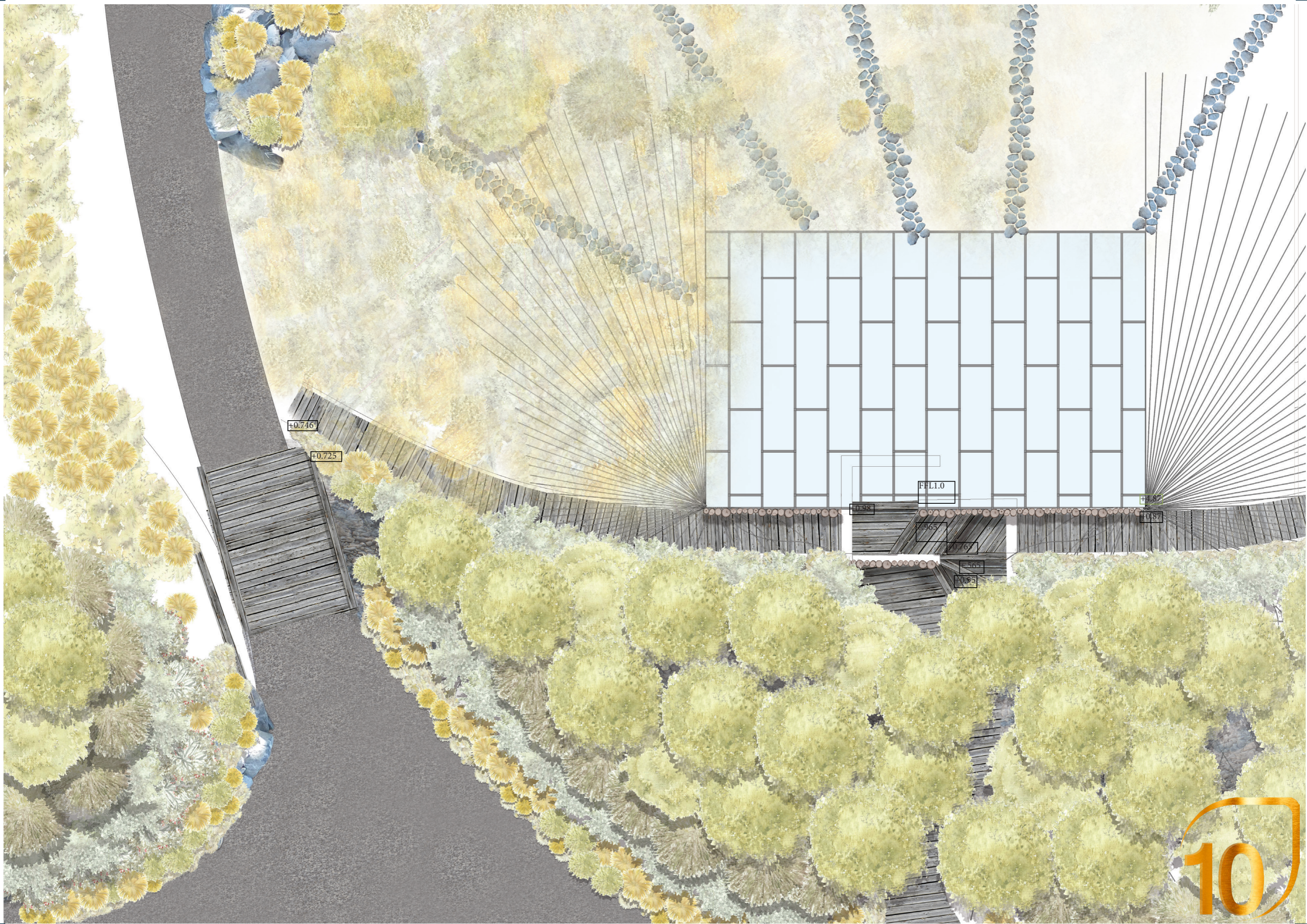



PERFORMATIVE NATURE

Barcelona International Landscape Architecture Biennial

September 2018 **Barcelona**

SCHOOL PRIZE

X International Landscape Architecture Biennial

Máster d'Arquitectura del Paisatge -DUOT - UPC

ETSAB- Escola Tècnica Superior

d'Arquitectura de Barcelona

Avenida Diagonal, 649 piso 5

08028 Barcelona-Spain

TECHNICAL DOSSIER

Title of the project The Legacy of Water
Authors Jorden Derecourt
Title of the course LASC 409: Major Design
Academic year 2017
Teaching Staff Mick Abbott
Department/Section/Program of belonging School of Landscape Architecture
University/School Lincoln University, New Zealand

Revolutionizing farming and tourism in the Mackenzie.

The vision is one that seeks to become a catalyst for a resilient, community driven, sustainable, and productive landscape change. It will foster a symbiotic relationship between the community and the iconic Mackenzie landscape. The proposal will create a new and engaging type of interaction with the landscape, where an increase of humans in the landscape is of benefit to the Biodiversity, Production and aesthetic values of the landscape. This is achieved by the catalytic intervention of a Campsite around Kellands Pond, South of Lake Ruataniwha, along SH8. This camping experience has one key difference, the exchange is not of NZD: it is of time, energy, and investment in the landscape. For every night spent in the site, an individual must plant, or mulch, or otherwise contribute to the management of this landscape. Through this the visitor forms a more tangible connection to the landscape. This blurred the definition between someone who is visiting, and someone to whom the site holds a deeper connection, causing them in turn to value it. The scale and sizes of the spaces within the site change as the user moves away from the water. This is both for climatic reasons (Shade and Wind Shelter) and to contrast the intimate spaces with the extreme "Big Sky" of the Mackenzie. Another feature is the creation of an entry experience that epitomizes the experiences available through the landscape and leaves emphasis upon the expansive sky and distinctive landscape.

For further information

Máster d'Arquitectura del Paisatge -DUOT - UPC

T: + 34 93 401 64 11 / +34 93 552 0842

Contact via email at: biennial.paisatge@upc.edu

Consult the web page <http://landscape.coac.net/>