



Country / City Medellín - Colombia
University / School National University of Colombia
Academic year 2017
Title of the project La Presidenta Linear botanical park
Authors Manuela Cañas Valencia, Cristian David Perez Jaraba, Laura Villegas Restrepo





PERFORMATIVE NATURE

Barcelona International Landscape Architecture Biennial

September 2018 **Barcelona**

SCHOOL PRIZE

X International Landscape Architecture Biennial

Máster d'Arquitectura del Paisatge -DUOT - UPC

ETSAB- Escola Tècnica Superior

d'Arquitectura de Barcelona

Avenida Diagonal, 649 piso 5

08028 Barcelona-Spain

TECHNICAL DOSSIER

Title of the project	La Presidenta Linear botanical park
Authors	Manuela Cañas Valencia, Cristian David Perez Jaraba, Laura Villegas Restrepo
Title of the course	Enfasis II en paisaje y espacios verdes urbanos
Academic year	2017
Teaching Staff	Luis Aníbal Vélez Restrepo
Department/Section/Program of belonging	Architecture faculty / Architecture
University/School	National University of Colombia

Written statement, short description of the project in English, no more than 250 words

La Presidenta linear park is located in El Poblado's commune of Medellín, Colombia. This park is settled around both sides of it, taking part of the ecological network made through of the city hydric tributaries. The streams, unlike the rivers, are bodies of water featured by their shallowness and weak streamflow. They are, indeed, quite remarkable in environmental and landscape fields, and in this city, being born in mountainsides and flowing into the Medellín river, have helped to set the urban growing through history. Our city, has started recovery processes of the Medellín river and some streams.

The park was conceived as a meeting place to the community and its importance is on this is just a few of the parks of the city designed to create a value on the hydric structures. This design is under the key premise to value the landscape and biodiversity protection, improving accessibility and connection conditions inside of it, and understanding the ecological relevance of bodies of water, improve the security perception, and substitution and introduction of new vegetable species, in order to refining existing activities and converting the park in a node, not just for its neighbors but to the city as a whole, and replicate this strategy as revitalization of the Medellín stream system.

For further information

Máster d'Arquitectura del Paisatge -DUOT - UPC

T: + 34 93 401 64 11 / +34 93 552 0842

Contact via email at: biennial.paisatge@upc.edu

Consult the web page <http://landscape.coac.net/>

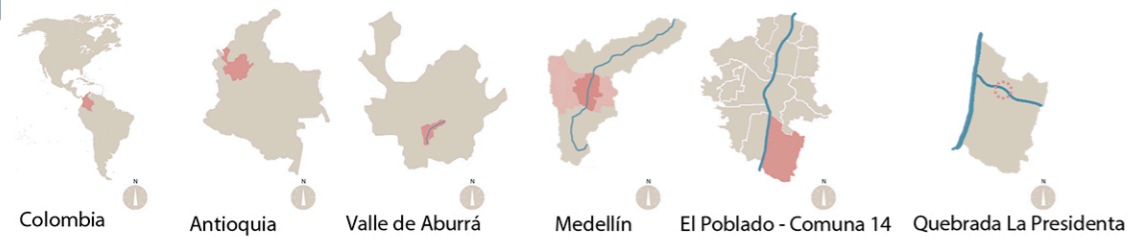

WATER RESOURCES AS ENVIRONMENTAL SYSTEM OF ABURRÁ VALLEY

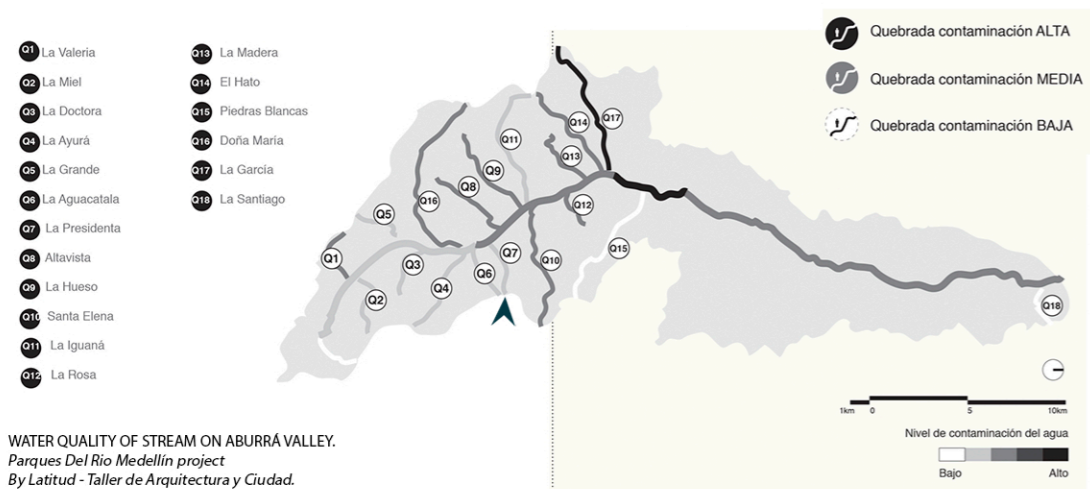
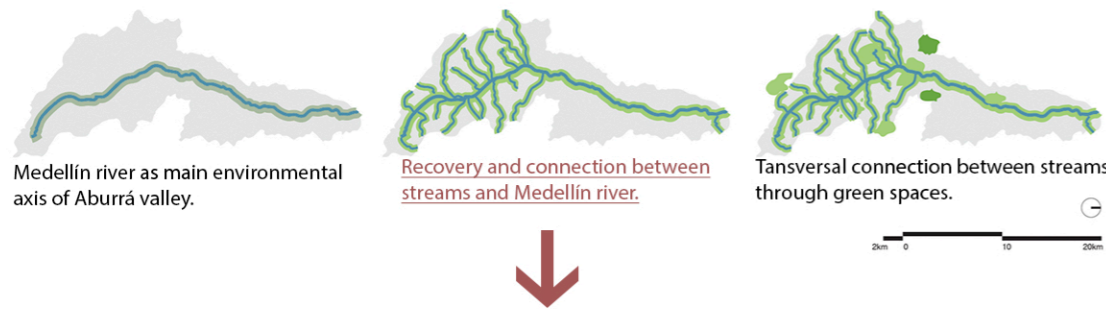

WATER QUALITY OF STREAM ON ABURRÁ VALLEY. Parques Del Rio Medellín project. By Latitud - Taller de Arquitectura y Ciudad.

LA PRESIDENTA GENERAL INFORMATION

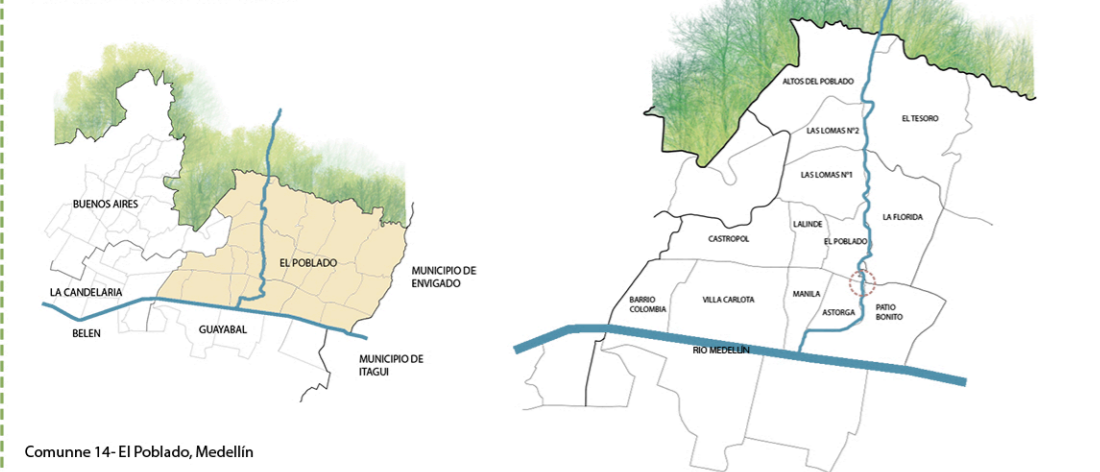

- The most important stream on El Poblado area.
- From the rural zone, it is born to 2,600 msnm on El alto de Moná.
- Length: 6 km. Area: 9.02 Km². Rural area: 5.92 Km². Urban area: 3.1 Km²
- In the lower part of its route it is channeled, this reduces and deviates its natural cause, generating flooding in some areas.
- Throughout the stream, it is located La Presidenta linear park, one of the bigger of Medellín with an area of 2.15 Ha.



- There is a wide variety of species in the park, mostly cataloged
- It is a refuge for different species of birds, insects and flora
- It plays a very important role as a biological corridor, decreasing the CO2 concentrations of the El Poblado avenue.



LA PRESIDENTA LINEAR BOTANICAL PARK RECOVERY AND CONNECTION OF LA PRESIDENTA STREAM



The activities in this park focus on passive recreation and the encounter with nature. It is also a place of passage and stay during the day. In the evening only on weekends.

The trade that is located on the edges generate a stay in the park

Hard trails and deck bridges guarantee continuity and connection between both sides of the park.



It is located in an area of high social and economic conditions. It is located in a central point near offices, medical centers, hotels and commerce.

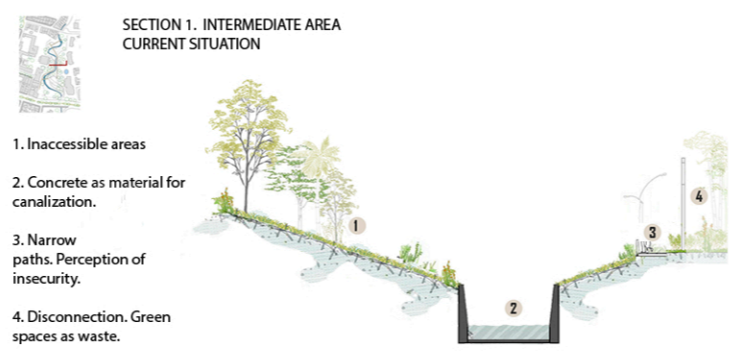

1. Inaccessible areas
2. Concrete as material for canalization.
3. Narrow paths. Perception of insecurity.
4. Disconnection. Green spaces as waste.



1. Entry from El Poblado avenue. Low accessibility.
2. Area before entry. Low activity.
3. Avenue does not allow wildlife crossing.
4. Disconnection. Green spaces as waste.



PROBLEMS AND ENVIRONMENTAL CHARACTERISTICS

1. Inactive areas: Although it has areas of stay most are only used in passing.
2. It has only two accesses, which causes a longitudinal route, the eastern side is less active.
3. It is accessible by bicycle, but does not have good bike paths.
4. Dangerous materiality: Areas of wooden bridges are in poor condition. On rainy days the floor is slippery, which puts pedestrians in danger.
5. Inaccessible areas: Not all the zones of the park are accessible pedestrianly since they present very steep slopes or non-passable vegetation.
6. Interruption crossing wildlife
7. Disconnection on avenue El Poblado
8. Trees at risk at the edge of the creek, have exposed roots and this can cause overturning.
9. Ravine's canalization in concrete
10. Unidirectional and narrow trails
11. Tree with limited growth and in its crown



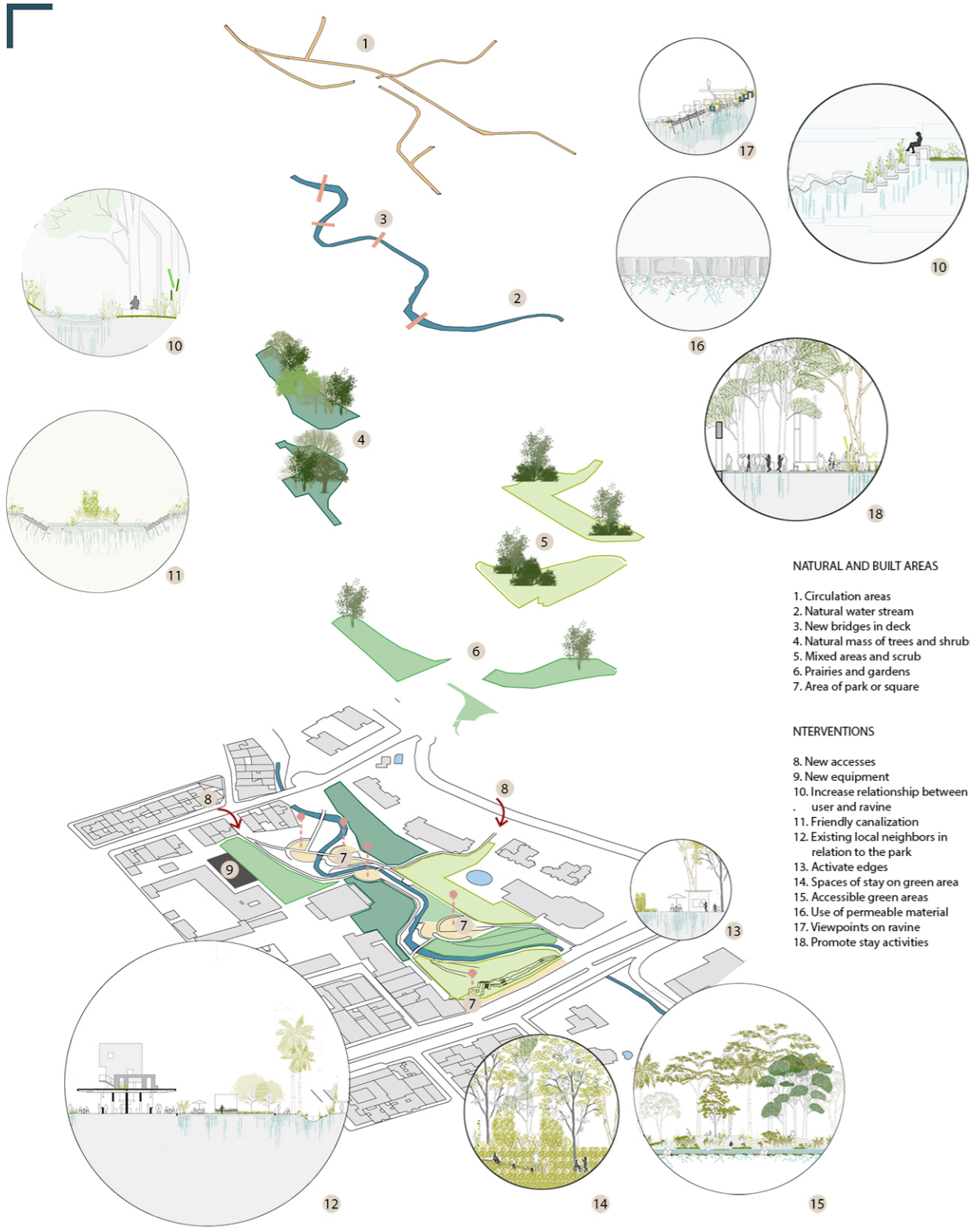

- NATURAL AND BUILT AREAS**
1. Circulation areas
 2. Natural water stream
 3. New bridges in deck
 4. Natural mass of trees and shrubs
 5. Mixed areas and scrub
 6. Prairies and gardens
 7. Area of park or square
- INTERVENTIONS**
8. New accesses
 9. New equipment
 10. Increase relationship between user and ravine
 11. Friendly canalization
 12. Existing local neighbors in relation to the park
 13. Activate edges
 14. Spaces of stay on green area
 15. Accessible green areas
 16. Use of permeable material
 17. Viewpoints on ravine
 18. Promote stay activities

PROPOSED ECOSYSTEMS
New vegetable species

Shrub - Herbaceous plants

- Pyrostegia venusta
- Sansevieria trifasciata
- Calathea picturata
- Calathea zebrina
- Brownea grandiceps
- Callistemon speciosus

Trees

- Jacaranda mimosifolia
- Bauhinia picta
- Lagerstroemia speciosa
- Bucida buceras
- Caesalpinia pluviosa
- Garcinia madruno

PROPOSED ECOSYSTEMS
Birds

- Perico
- Mielero
- Siriri bueyero
- Lora
- Azulejo
- Cucarachero
- Tortolita común
- Garcita bueyera
- Bichofué

METROPOLITAN ENVIRONMENTAL CONECTIVITY
MACRO SCALE - VALLE DE ABURRÁ
Parques Del Rio Medellín project
By Latitud - Taller de Arquitectura y Ciudad



BIOTIC CORRIDOR
NODE - CONNECTION - FRAGMENTS

The green spaces found in the area of influence of the Medellín River and its tributaries are categorized into three typologies, so that they can reconnect with each other and generate a metropolitan environmental network that will guarantee ecological-social balance over the territory.



SECTION 1. INTERMEDIATE AREA
PROPOSED DESIGN



1. Extension of trails.
2. Protection of natural ecological systems.
3. New paths and observation points.
4. Green connection. New usable green spaces.

SECTION 2. EL POBLADO AVENUE
PROPOSED DESIGN



1. Staircase as new entry.
2. New uses like bazaar area.
3. New wildlife crossing on El Poblado Avenue.
4. Connection with existing green spaces.





1 La Presidenta botanical linear park
 2 Proposed wildlife passages



1 La Presidenta botanical linear park
 2 Lleras Park
 3 El Poblado Park
 4 La Ballarina Park
 Connection between parks



1 La Presidenta botanical linear park
 2 Lleras Park
 3 El Poblado Park
 4 La Ballarina Park
 Green connection

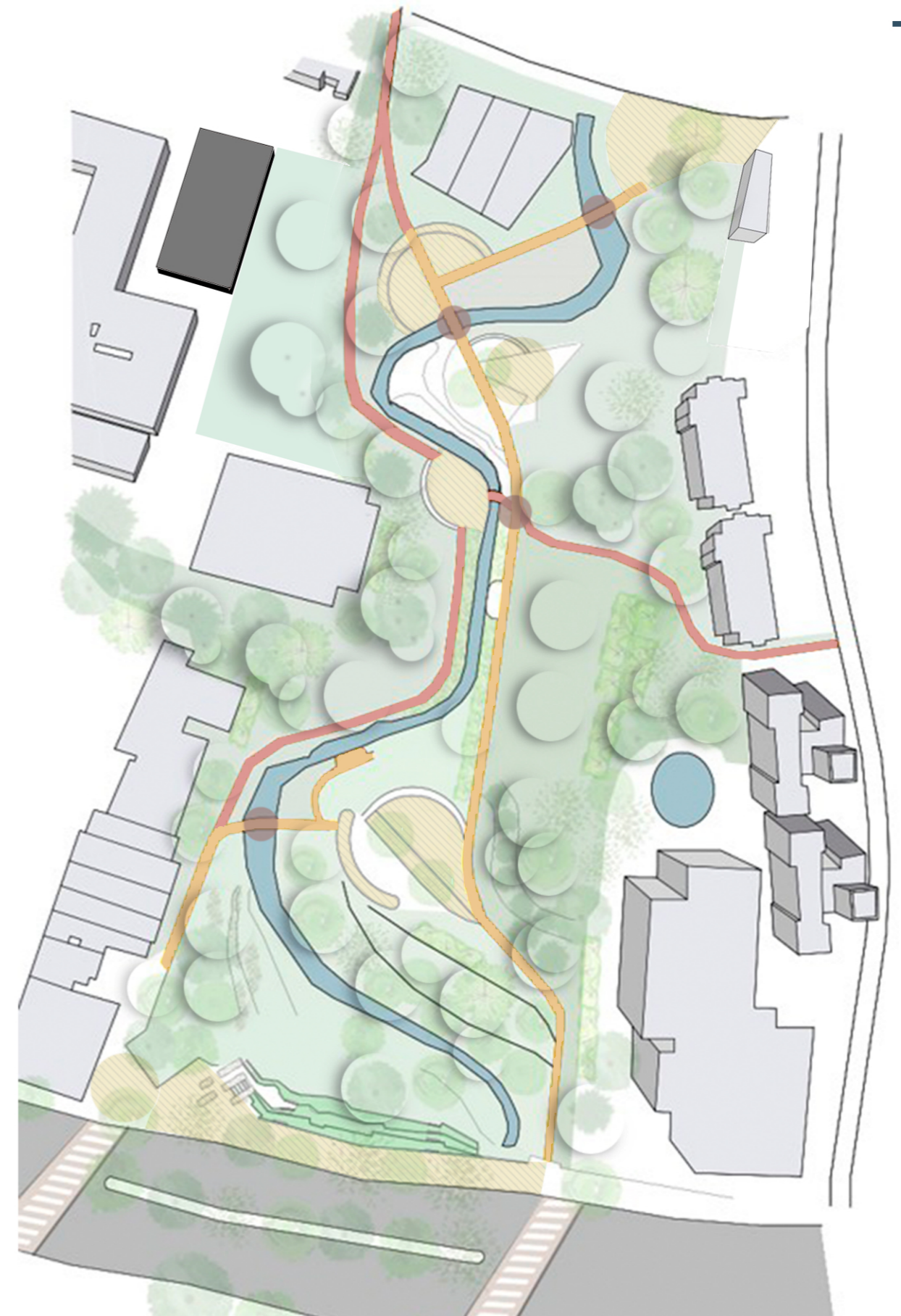

FLOOR PLAN

- La Presidenta stream
- Current trail
- New trails
- New Equipment
- Green spaces
- New deck bridges
- Recreation areas

