



Country / City

University / School

Academic year

Title of the project

Authors

Spain / Sallent de Llobregat

Universitat Politècnica de Catalunya - UPC

2017 - 2018

REGAINNING THE RIVERSIDE

ANDREA CALDAS - ANA VIDAL - DAVID CASTILLO - IRATI LUKAS - ITZEL MONCLÚS - JOSEP OLIVER - MARC MELGAREJO - MARINA PINA - NÚRIA ALBADALEJO - SARA GARIN





PERFORMATIVE NATURE

Barcelona International Landscape Architecture Biennial

September 2018 **Barcelona**

SCHOOL PRIZE

X International Landscape Architecture Biennial

Máster d'Arquitectura del Paisatge -DUOT - UPC

ETSAB- Escola Tècnica Superior

d'Arquitectura de Barcelona

Avenida Diagonal, 649 piso 5

08028 Barcelona-Spain

TECHNICAL DOSSIER

Title of the project REGAINING THE RIVERSIDE
Authors ANDREA CALDAS - ANA VIDAL - DAVID CASTILLO - IRATI LUKAS - ITZEL MONCLÚS - JOSEP OLIVER - MARC MELGAREJO - MARINA PINA - NÚRIA ALBADALEJO - SARA GARIN
Title of the course Master's degree in Architecture Vallès School of Architecture Vallès School of Architecture
Academic year 2017 - 2018
Teaching Staff Roger Sauquet and Claudi Aguiló
Department/Section/Program of belonging Escola Tècnica Superior d'Arquitectura del Vallès - ETSAB
University/School Universitat Politècnica de Catalunya - UPC

Written statement, short description of the project in English, no more than 250 words

Sallent is a village in the Bages region, Catalonia. Sallent's name means waterfall due to several natural dams located in the tram where the Llobregat River crosses from north to south. But besides this tight relation between the city and the nature, the reality is a deep physical and social disconnection.
The project started with the assignment of the "Plan de Barris", which involves a real client, the City Council. Twelve students of the master's degree are in charge of improving the riverbeds solving the problems of the site.
This project is specifically located on the left side of the river. Strategic areas where the disconnection between Sallent and Llobregat can be treated in order to give a solution to both, the urban boundaries and its urban landscape.
It is a unique project based on three important interventions: The Wall's Park, The House and The Wall Walkaway. Each of them sort out common and specific issues determined by their specific spot while generating a global and unique project.
The whole intervention attempts to settle a social issue, mainly caused by its physical barriers, in an organic way. The goals are to relate people and river while naturalizing the riverside. Two new accesses are open and the existing ones are renovated providing more accessibility. Moreover, these interventions try to be as less invasive as possible, as they are constructed with low-cost elements.
Not only is an architectural intervention, it is also looking forward to emphasize the importance of unattended riverside within the village.

For further information

Máster d'Arquitectura del Paisatge -DUOT - UPC

T: + 34 93 401 64 11 / +34 93 552 0842

Contact via email at: biennial.paisatge@upc.edu

Consult the web page <http://landscape.coac.net/>

INTERVENTION AT THE LEFT RIVERSIDE OF THE RIVER LLOBREGAT - SALLENT

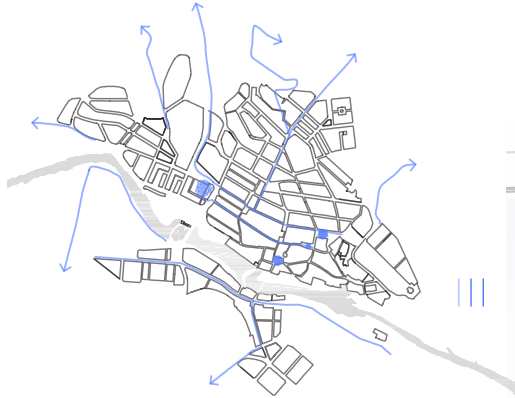
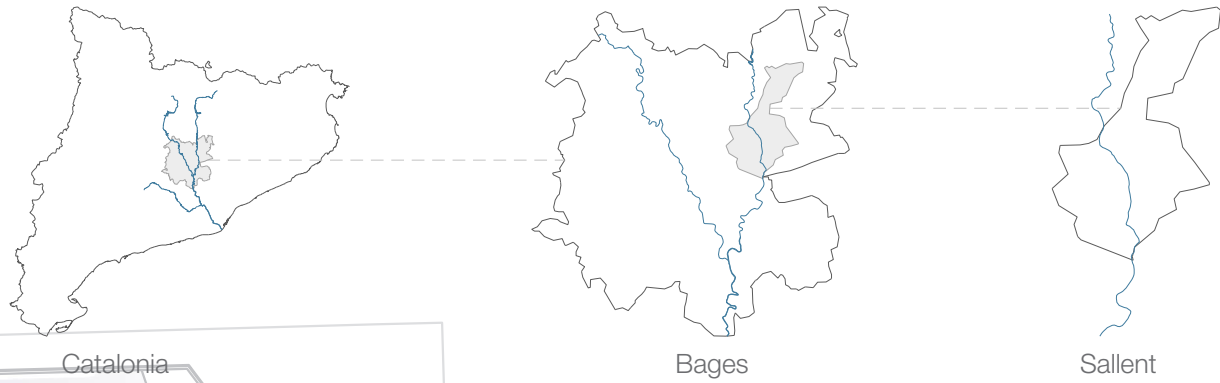

URBAN DISCONNECTION

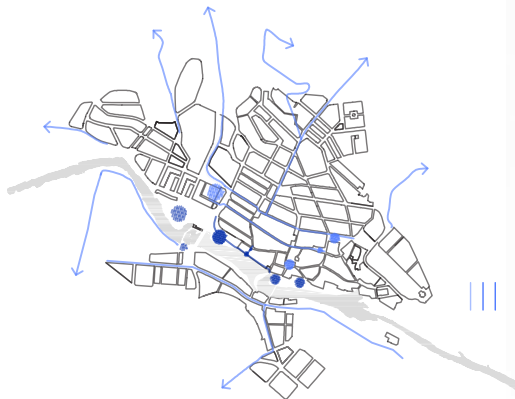

PATHS AND REST AREAS

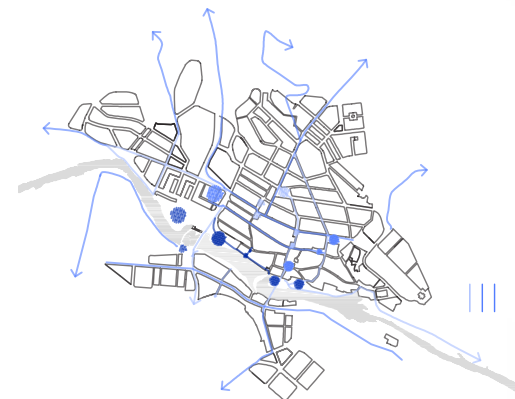

FINAL RESULT



SECT.1

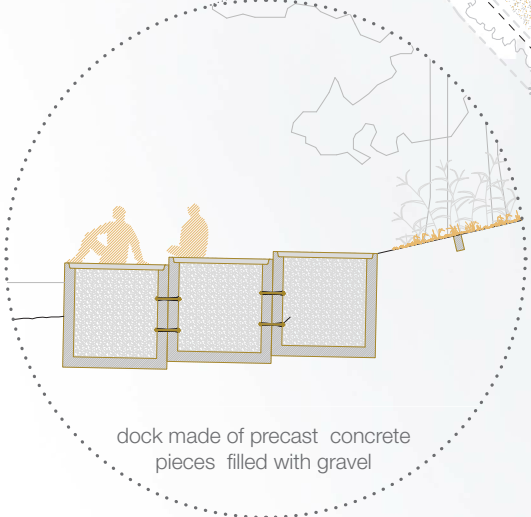

dock made of precast concrete pieces filled with gravel

DIRECT CONTACT WITH THE RIVER



EXISTING PARK VIEW

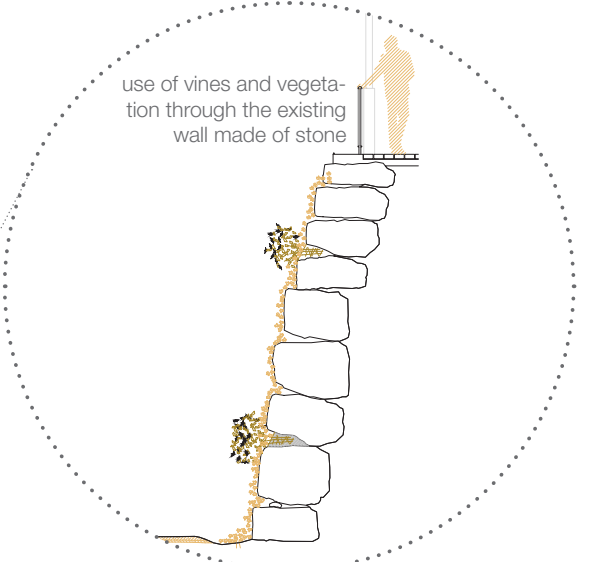

use of vines and vegetation through the existing wall made of stone

REDUCING THE IMPACT ON THE LANDSCAPE SCENE

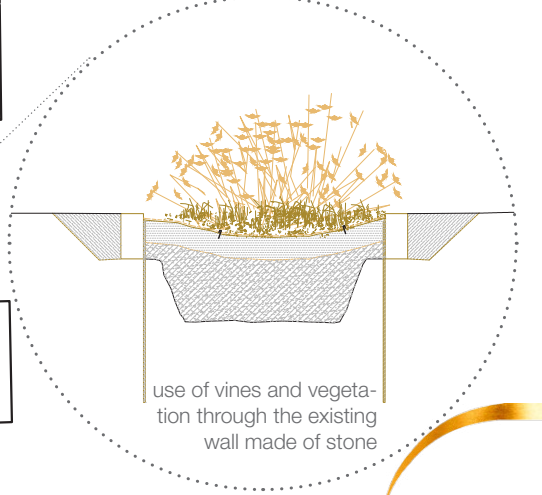

use of vines and vegetation through the existing wall made of stone

BIODIVERSITY + DRY CONSTRUCTION



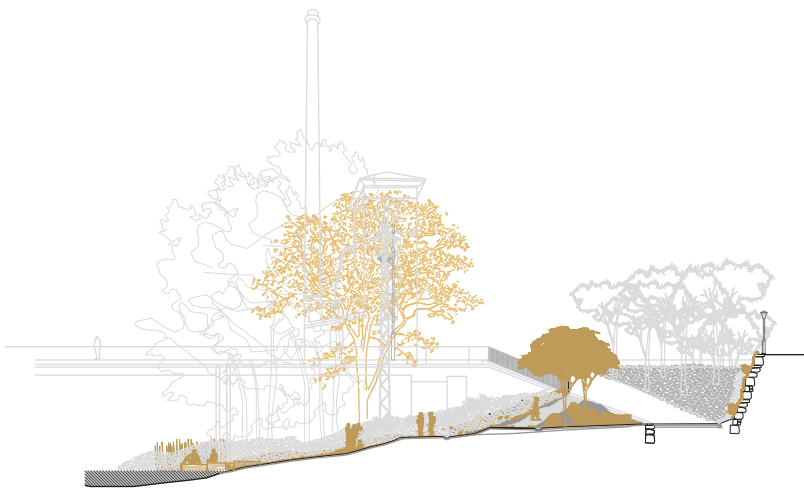

PARK SECTION 1 e 1:250

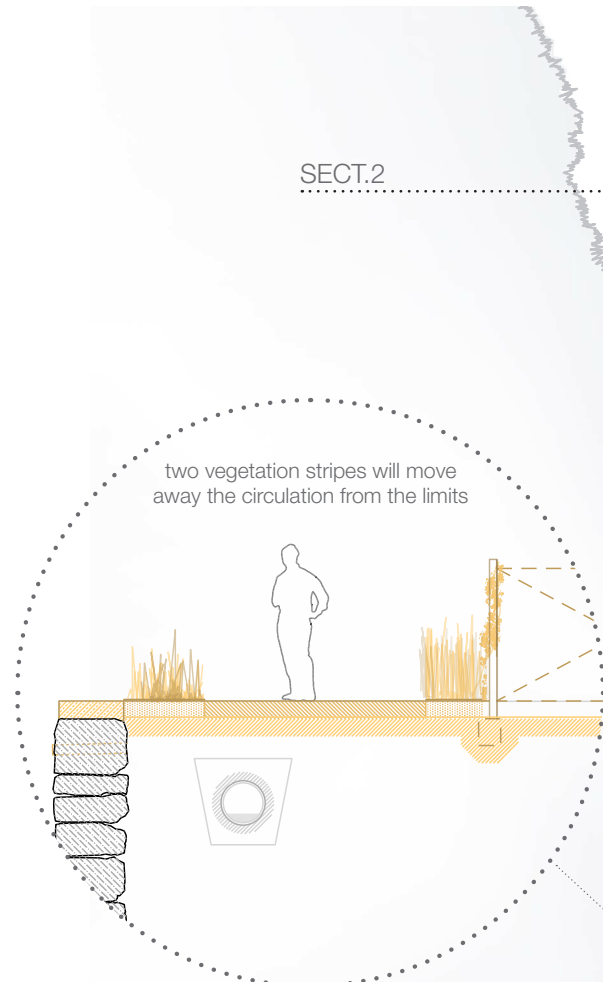

two vegetation stripes will move away the circulation from the limits

NATURAL DIVISIONS



PARK SECTION 2 e 1:250



SECT.2

SECT.3



ACTUAL UNATTENDED PATH

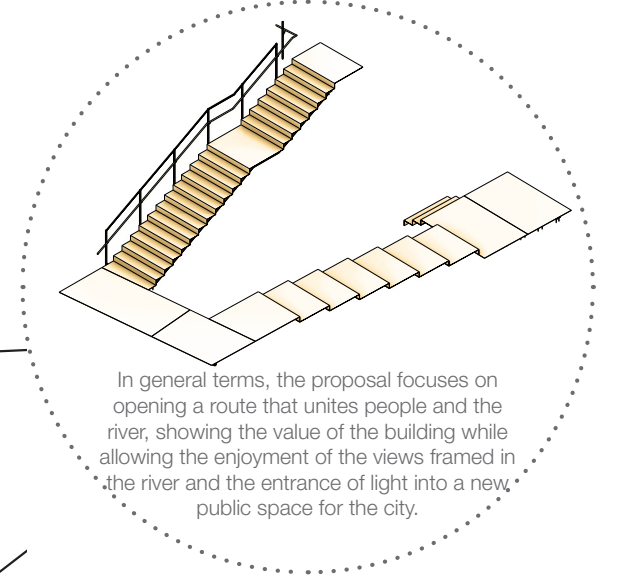

In general terms, the proposal focuses on opening a route that unites people and the river, showing the value of the building while allowing the enjoyment of the views framed in the river and the entrance of light into a new public space for the city.

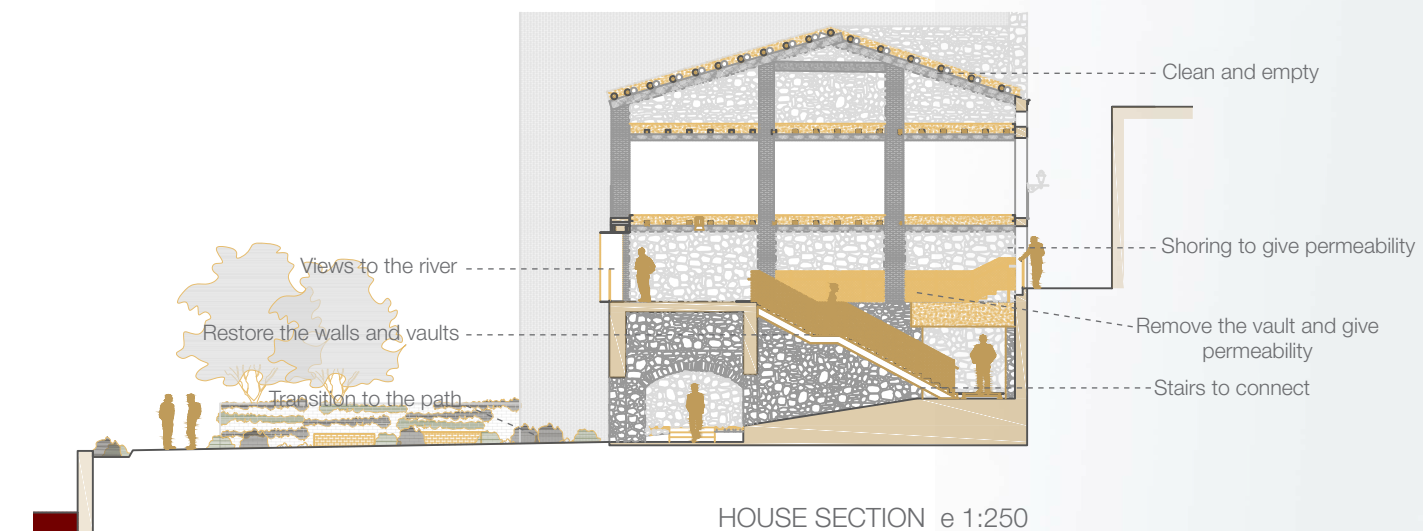

HOUSE SECTION e 1:250

Clean and empty

Shoring to give permeability

Remove the vault and give permeability

Stairs to connect

Views to the river

Restore the walls and vaults

Transition to the path

autochthonous and aromatic plants to guide the pedestrians

CONNECTING WITH NATURE



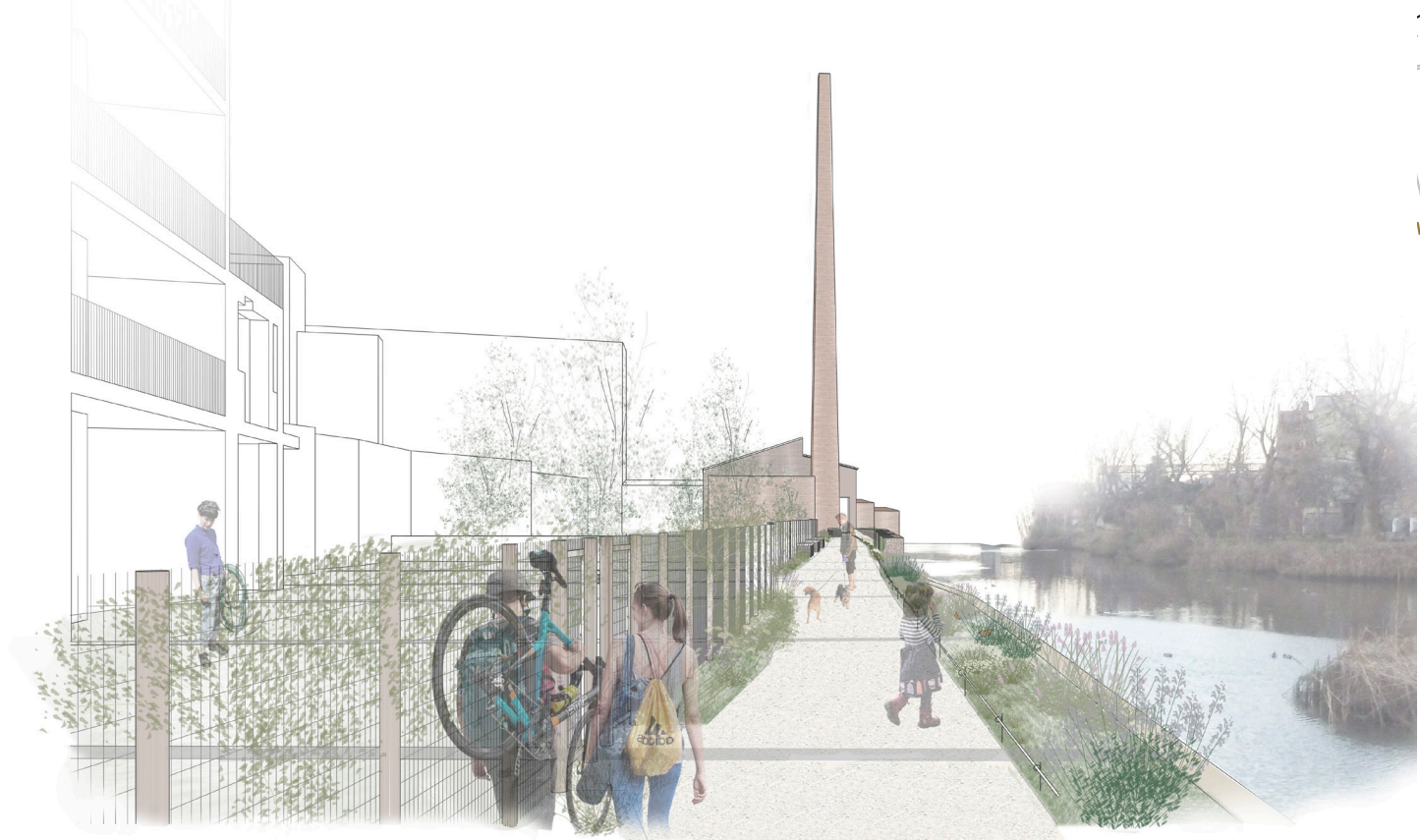

PATH'S VIEW



PARK'S VIEW

