



Country / City	Spain / Reus
University / School	Universitat Rovira i Virgili / Escola Tècnica Superior d'Arquitectura de Reus
Academic year	2016-2017
Title of the project	Coal Tainted Landscapes
Authors	Jaume Fabregat González i Anna Royo Bareng





# PERFORMATIVE NATURE

Barcelona International Landscape Architecture Biennial

September 2018 **Barcelona**

SCHOOL PRIZE

X International Landscape Architecture Biennial

Máster d'Arquitectura del Paisatge -DUOT - UPC

ETSAB- Escola Tècnica Superior

d'Arquitectura de Barcelona

Avenida Diagonal, 649 piso 5

08028 Barcelona-Spain

## TECHNICAL DOSSIER

Title of the project Coal Tainted Landscape  
Authors Jaume Fabregat González i Anna Royo Bareng  
Title of the course Final Project - PFC  
Academic year 2016-2017  
Teaching Staff Jordi Sardà Ferran, Arturo Frediani Sarfati i Josep LLuís i Ginovart  
Department/Section/Program of belonging Architecture  
University/School Universitat Rovira i Virgili / Escola Tècnica Superior d'Arquitectura de Reus

### Written statement, short description of the project in English, no more than 250 words

..The Final Project searches a way to face the complex territory of Alt Berguedà, in the north of Barcelona, reaching the Pyrenees..  
..This environment has undergone many transformations throughout the last century. It is a world that has modified its  
..physiognomy (reservoir), its mobility (train, roads, funiculars, cable cars) and has lost its economic driving force: mining.  
..No evident signs of this convulsive and immediate past are found, only some graffiti try to make us recall, as written voices  
..beside the main roads: "Since the loos of coal mining as the main activity in the early nineties, we find a landscape dwelling  
..between the present and the past, never again reaching its direction. Ghosts searched these days in the old coal mining  
..installations may be a reflection of the bewildered state of the place."  
..The project highlights a key point of overwhelming intensity in the territory: Figols les Mines. Now forgotten, it claims for attention..  
..We work in a limit scenario, in which architecture seeks a new opportunity to intervene in a lost dialogue between man and  
..nature. This tangible - intangible setup makes us wonder about which should be the degree of the intervention, what should be  
..its intensity, or on the contrary, should we just consider letting it fade..  
..a stairway and a lift, a memorial, ecovering old trails through the lush vegetation, small actions may rescue scattered pieces of  
..our recent history architecture as a way of recomposing imagination disengaged by nowadays constant overlay of speeds...

For further information

Máster d'Arquitectura del Paisatge -DUOT - UPC

T: + 34 93 401 64 11 / +34 93 552 0842

Contact via email at: [biennial.paisatge@upc.edu](mailto:biennial.paisatge@upc.edu)

Consult the web page <http://landscape.coac.net/>



# tainted coal landscape

**Figols-les Mines**  
**Re-Think: Alt Berguedà, postminery landscape**

mine galleries  
under the ground

not infrequently, when  
wandering around, we  
may easily overlook  
signs. nowadays world,  
tends to overlay different  
speeds, blurring local  
and translocal sinergies

activity  
on the surface

no longer extractive  
industries in the place,  
a bewildered landscape  
that still can't find its  
direction

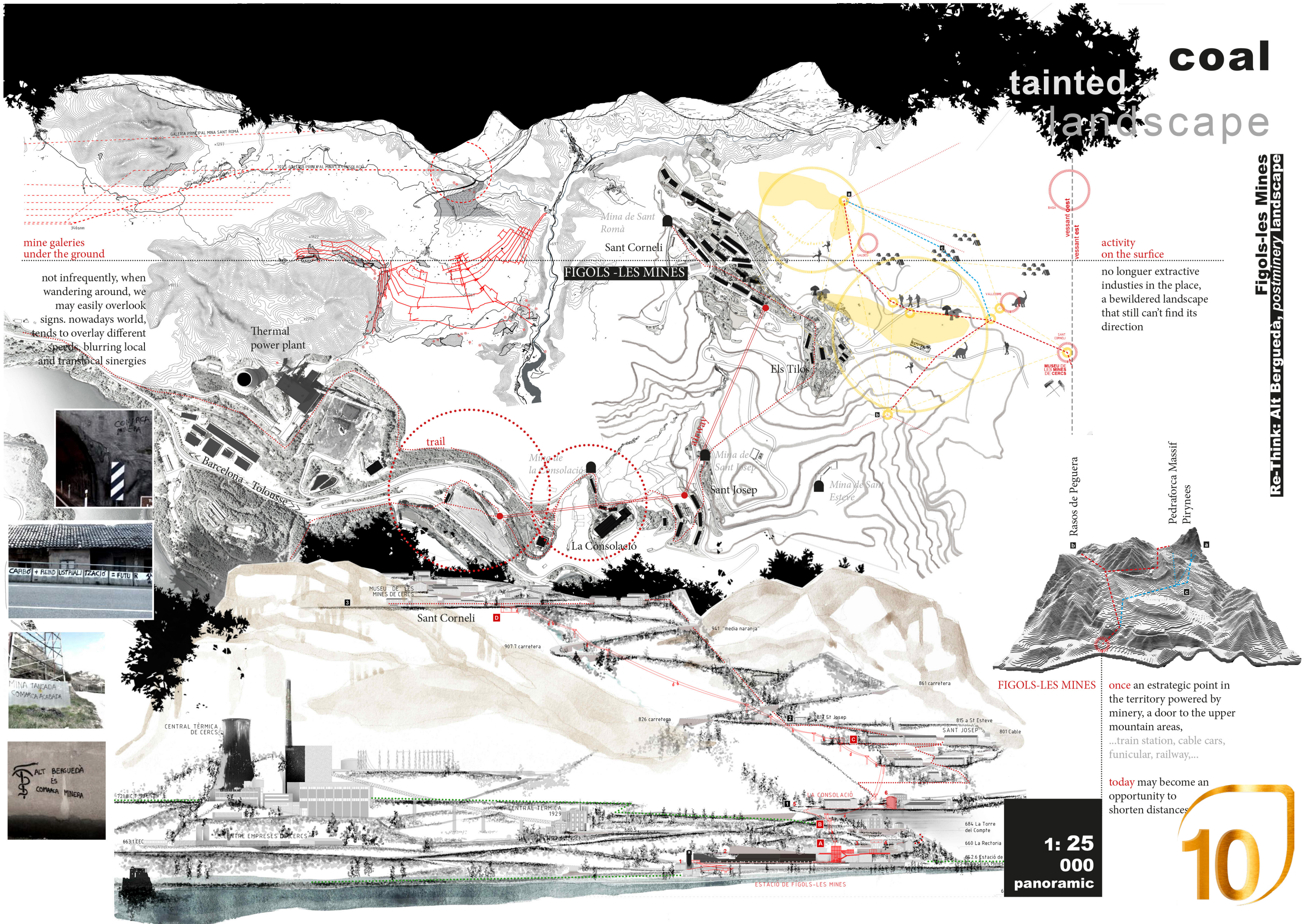

FIGOLS-LES MINES

once an strategic point in  
the territory powered by  
minery, a door to the upper  
mountain areas,  
...train station, cable cars,  
funicular, railway,...

today may become an  
opportunity to  
shorten distances

**1: 25  
000  
panoramic**

**10**



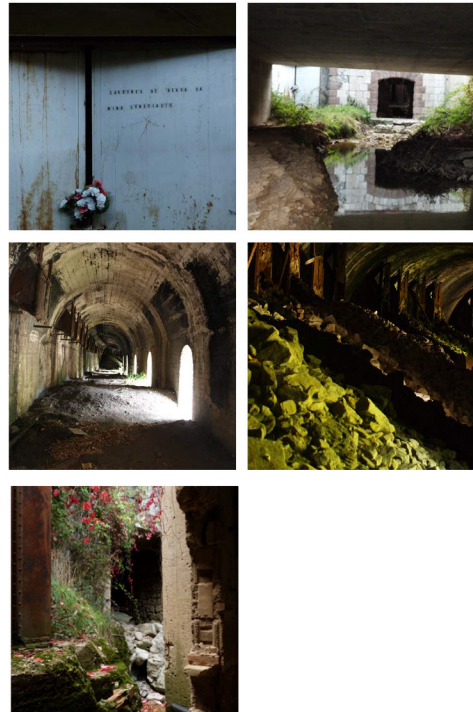

**COLLECTING SPACES**  
with new eyes  
in a landscape  
dwelling between  
the present  
and the past

**1:0  
to feel**

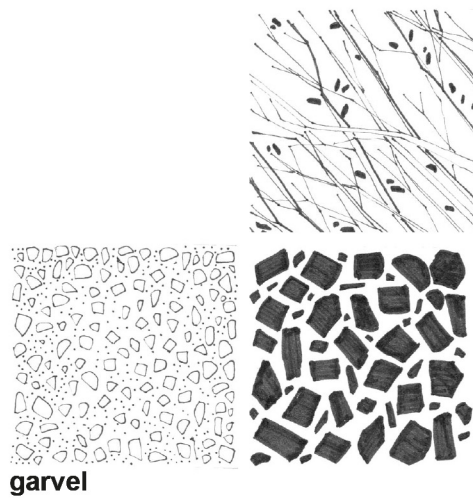

brushwood

coal

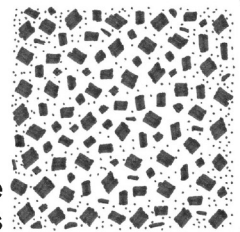

meteorized mine  
tailings

**MATERIALITY**  
built with its own

a constant work in progress

**1:1  
to touch**

## SCENARIOS

isolated historical scenarios  
an unreadable story

filling the gaps to  
recompose a track

## PREEXISTENCES

lost and found  
scattered pieces

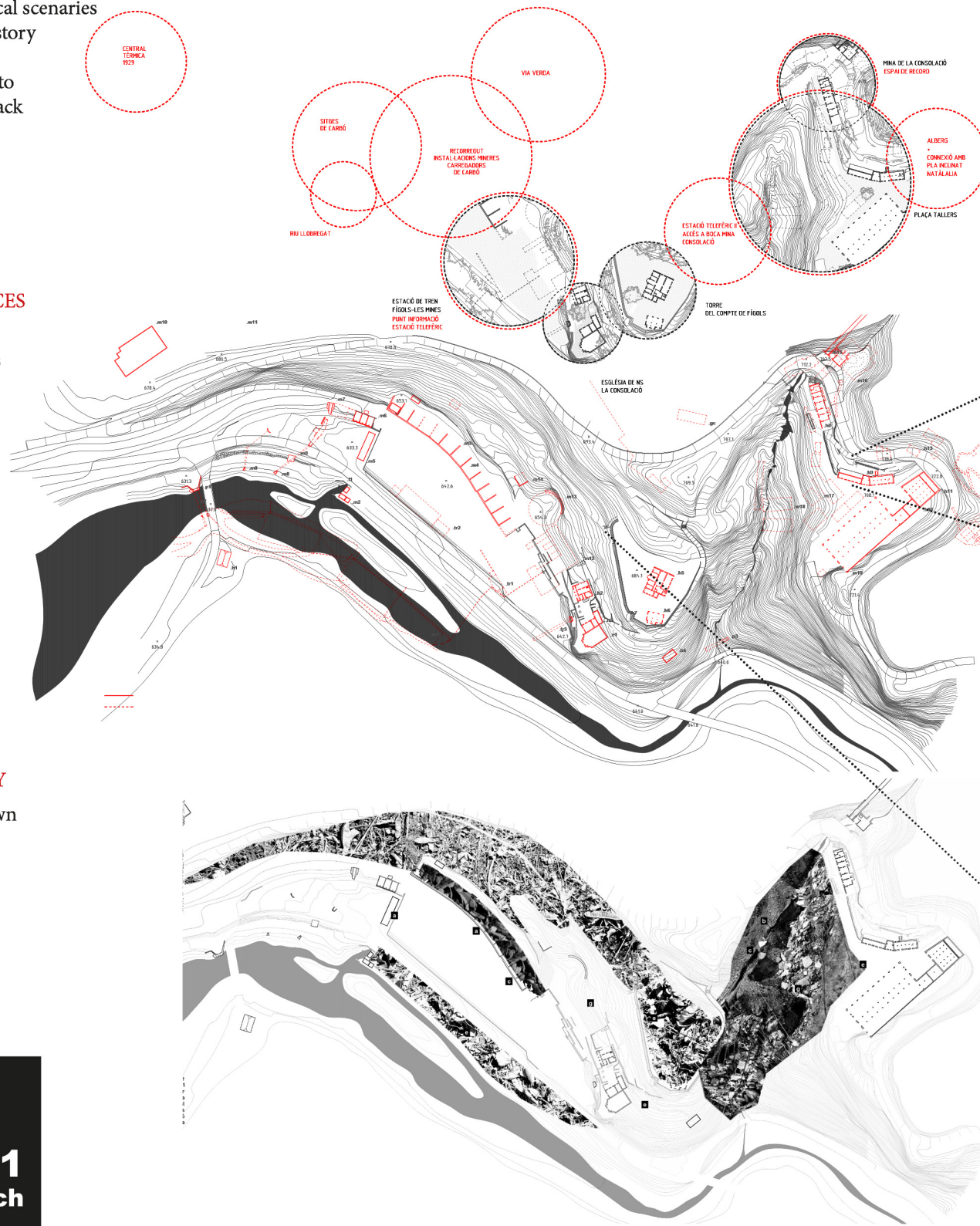

# coal tainted landscape

**Figols-les Mines**  
**Re-Think: Alt Berguedà, postminery landscape**

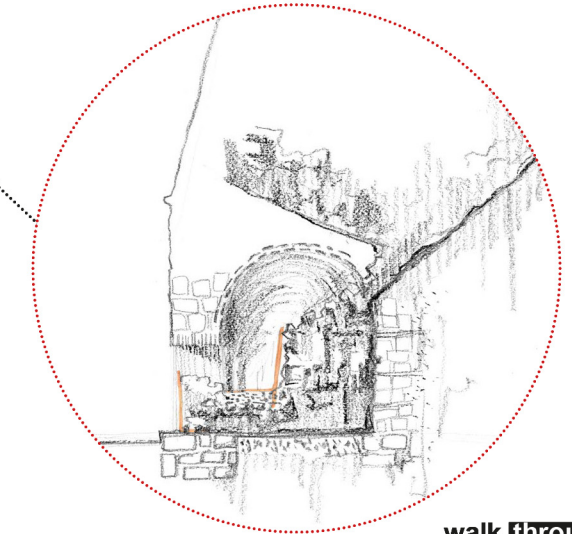
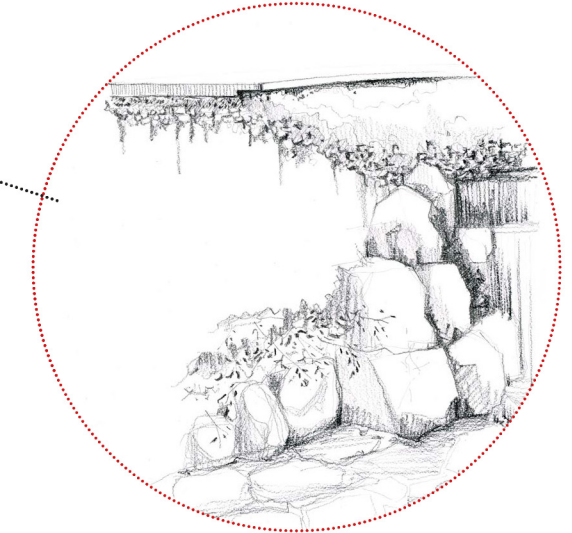

walk through

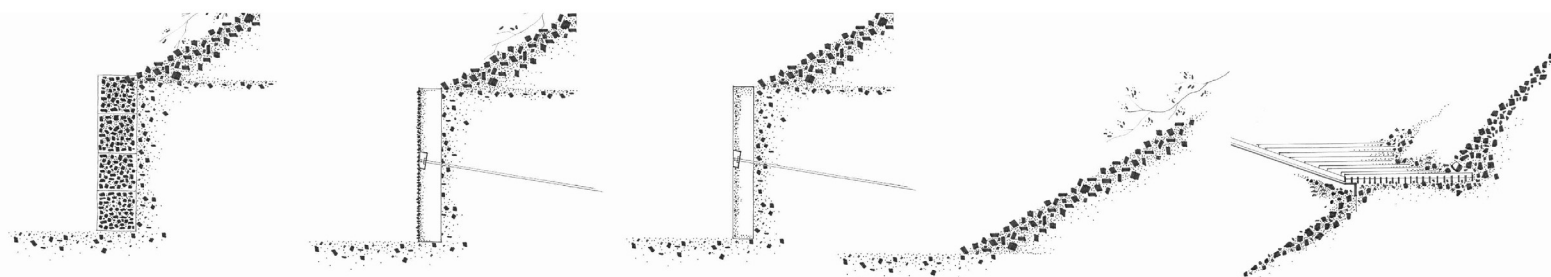

walk by

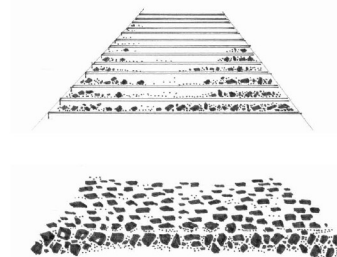

walk on

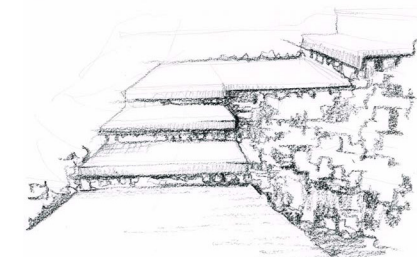

**10**





**1:500  
to redraw**

...a stairway and a lift,  
a memorial,  
recovering old trails through the lush vegetation,  
small actions may rescue scattered pieces of our recent history  
architecture as a way of recomposing imagination  
disengaged by nowadays constant overlay of speeds...

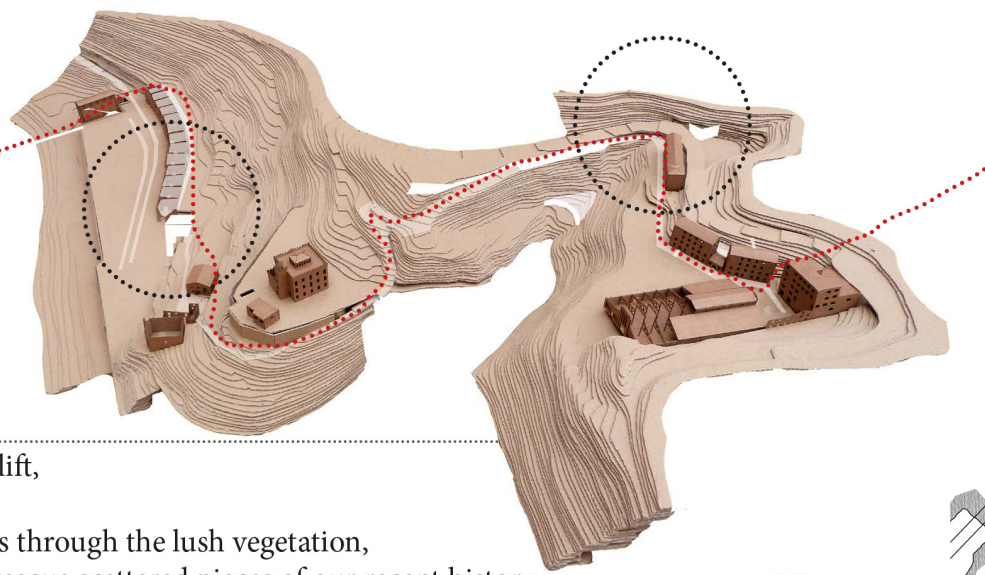

**to Re-Inhabit & to Remember**  
Coal Mining Complex,  
La Consolació

**Infrastructure & Landscape**

The old train station of Figols-les Mines

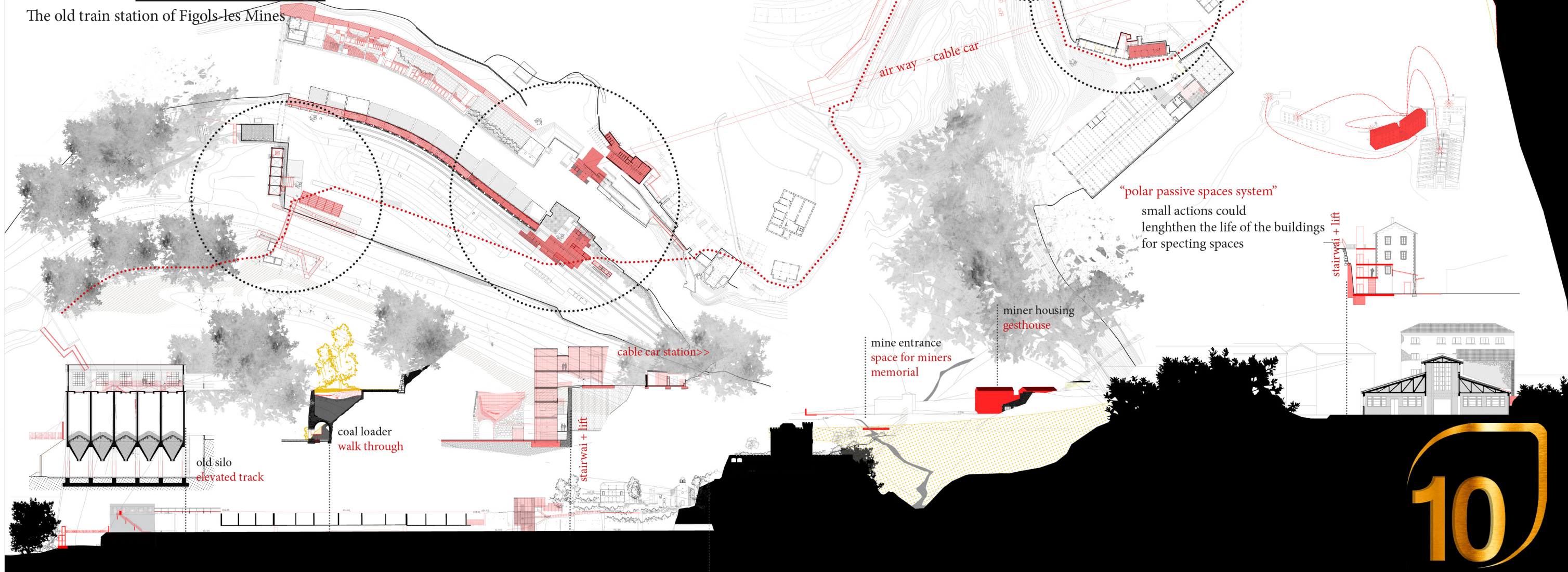

**"polar passive spaces system"**  
small actions could  
lengthen the life of the buildings  
for specting spaces

stairwai + lift

miner housing  
gesthouse

mine entrance  
space for miners  
memorial

cable car station>>

stairwai + lift

coal loader  
walk through

old silo  
elevated track