

Country / City

University / School

Academic year

Title of the project

Authors

Poland

Cracow University of Technology

2017-2018

Cracow Greenway East. The concept of a greenery system integrating the parks of Nowa Huta

Marcelina Smolarczyk

TECHNICAL DOSSIER

Title of the project Cracow Greenway East. The concept of a greenery system integrating the parks of Nowa Huta.
Authors Marcelina Smolarczyk
Title of the course master degree
Academic year 2017-2018
Teaching Staff Prof., DSc Eng Arch. Zbigniew Myczkowski; DSc Eng Arch. Urszula Forczek-Brataniec
Department/Section/Program of belonging Institute of Landscape Architecture of the Cracow University
of Technology, Department of Open Landscape and Engineering Buildings
University/School Cracow University of Technology



Written statement, short description of the project in English, no more than 250 words

The aim of the project is to develop a green area system concept that would integrate linear green spaces into selected parks in Nowa Huta. Currently these parks are isolated from each other by various barriers which disturb communication and natural continuity. It is therefore necessary to ensure the continuity of the greenery system between all selected Nowa Huta parks. The project is a refinement of the strategic document which is the Directions of development and management of green areas in Cracow for 2017-2030. It undertakes an attempt to implement the recommendations and guidelines contained in the strategy regarding the development and cultivation of green corridors in the eastern part of Cracow. The project identifies problem areas and barriers that exist within them, as well as eliminates them by delineating the boundaries of green corridors in a precise way, and as a result develops a coherent, comprehensive concept of a green corridor - Cracow Greenway East - a system of public green spaces on a local scale that can be moved between green areas open to the eastern part of Cracow. The concept of a green corridor assumes the creation of a tourist route which the main purpose is to introduce the potential recipient to the natural and cultural heritage of Nowa Huta. As a detail, one selected problem area was designed in at length, i.e. a green link between the Polish Park Lotników and the embankments on the Vistula. The solutions adopted in the project extract precious values of the area as well as expose its specific genius loci.

For further information
Máster d'Arquitectura del Paisatge -DUOT - UPC

T: + 34 93 401 64 11 / +34 93 552 0842
Contact via email at: biennal.paisatge@upc.edu

Máster d'Arquitectura del Paisatge -DUOT - UPC
ETSAB- Escola Tècnica Superior
d'Arquitectura de Barcelona
Avenida Diagonal, 649 piso 5
08028 Barcelona-Spain



CLIMATE CHANGE AGAIN

11th International Biennial Landscape Barcelona

Barcelona September 2020
SCHOOL PRIZE



transformations of green infrastructure in the city landscape

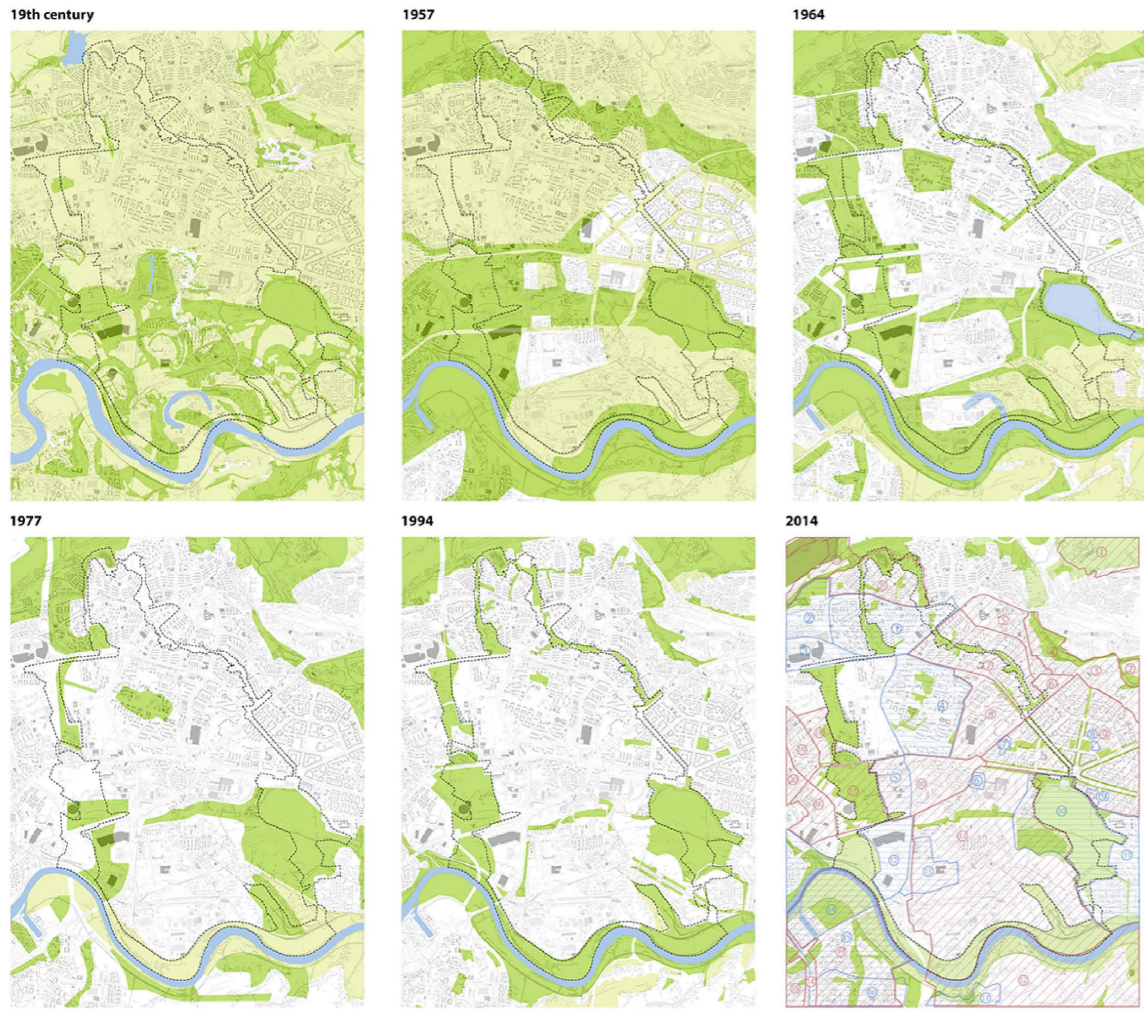

identification of problem areas



analysis and elimination of problem areas



summary map of transformation processes of green areas

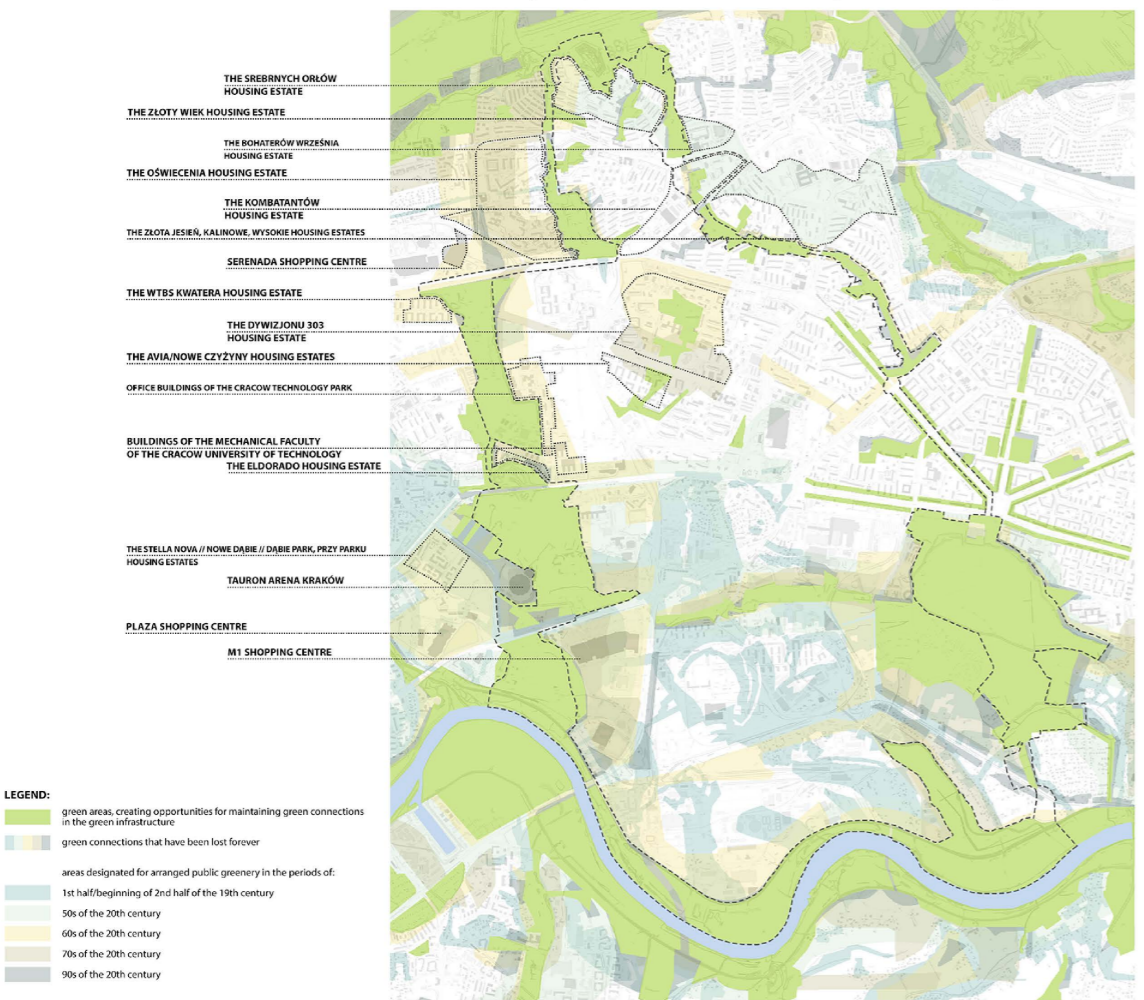



LEGEND:

CONNECTIONS WITH GREEN INFRASTRUCTURE

- direct connections with adjoining public green areas

CONNECTIONS WITH CYCLING INFRASTRUCTURE

- direct connections with city bike routes
- existing bike paths

THEMATIC SECTIONS OF GREENWAY

5/SKIES OF NOWA HUTA/ 2 KM / P4
// THE AVIATION HERITAGE OF NOWA HUTA //

NUMBER / NAME / DISTANCE / SYMBOL OF NOWA HUTA PARK LOCATED WITHIN SECTION

MARKING OF DOMINANT CHARACTER OF THEMATIC SECTIONS OF GREENWAY

- ● ● nature / observative / historical function
- ○ ○ domination of the function (predominant / significant / insignificant)
- iconographic characteristics of the thematic section in respect to:
 - resource (existing condition)
 - proposed changes in the resource (functions / elements requiring reinforcement)
 - introducing new functions / elements

fragment of the thematic sections of greenway

10 // CITY IN GREEN //

7/OLD NEW NOWA HUTA/
// HERITAGE OF ARCHITECTURE AND URBAN PLANNING // 1 KM

1/MEADOW OF HUTA/ 2 KM / P1
// NATURAL AND LANDSCAPE TREASURES OF NOWA HUTA //

2/FIELDS OF NOWA HUTA/
// LITTLE KNOWN ROOTS OF NOWA HUTA // 1 KM

project of green corridor

6/SENTIMENTS OF PRL / 6 KM / P5 - P6 - P7 - P8
// THE HOUSING ESTATES OF NOWA HUTA //

5/SKIES OF NOWA HUTA / 2 KM / P4
// THE AVIATION HERITAGE OF NOWA HUTA //

4/BEND OF CULTURE AND LEISURE / 2 KM / P1
// DISCOVERING TRACKS OF THE PAST //

3/GREEN RIVERINE FOREST 2.5 KM / P2
// NATURAL RESOURCES OF THE INDUSTRIAL PART OF CRACOW //

2/FIELDS OF NOWA HUTA/
// LITTLE KNOWN ROOTS OF NOWA HUTA // 1 KM

1/MEADOW OF HUTA/ 2 KM / P1
// NATURAL AND LANDSCAPE TREASURES OF NOWA HUTA //

7/OLD NEW NOWA HUTA/
// HERITAGE OF ARCHITECTURE AND URBAN PLANNING // 1 KM

10 // CITY IN GREEN //

11



detention basin in the green belt along the roadway

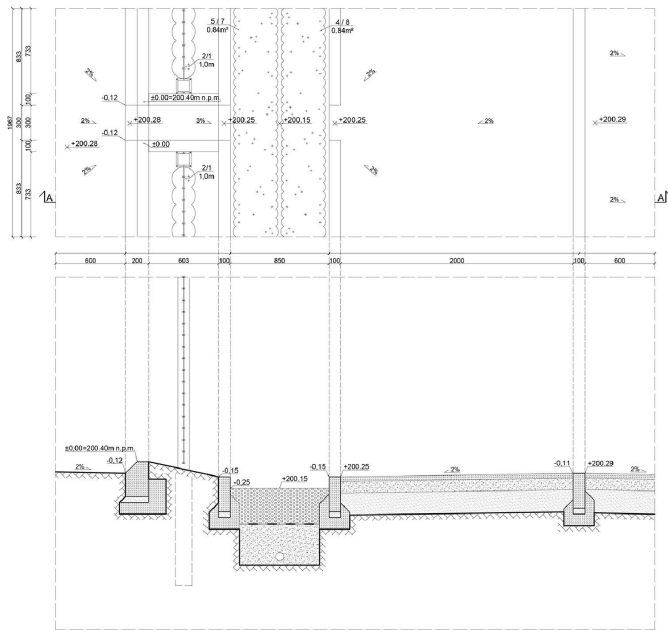

- PLANTS USED IN THE PROJECT:**
- | BUSHES | CLIMBING PLANTS | PERENNIALS | ORNAMENTAL GRASSES | GRASS / MEADOW SURFACES |
|---|-------------------------------|--------------------------------|------------------------------|--|
| 1 // <i>Viburnum opulus</i> 'Compactum' | 2 // <i>Lonicera arvensis</i> | 3 // <i>Echinacea purpurea</i> | 4 // <i>Igtham salicaria</i> | 6 // <i>Grass seed mix</i>
(Calcium permeable -20%,
Festuca rubra -75%,
Poa pratensis -10%) |



project of the fragment of green corridor | PLANT MEANDER |



infiltration ditch in the green belt along the tram tracks

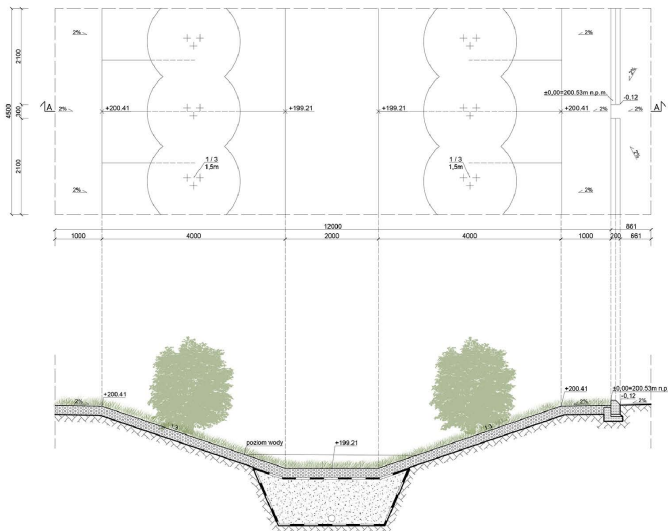

detention basin on recreational lawn

