

# Landscape as House

Anna Maria Fink

Country / City	Netherlands/Amsterdam
University / School	Academy of Architecture Amsterdam
Academic year	2018
Title of the project	Landscape as House - In Search of a New Form of Topographic Living in the Alps
Authors	Anna Maria Fink



TECHNICAL DOSSIER

Title of the project	Landscape as House - In Search of a New Form of Topographic Living in the Alps
Authors	Anna Maria Fink
Title of the course	Graduation Project
Academic year	2018
Teaching Staff	Marieke Timmermanns, Anouk Vogel, Bruno Vermeersch
Department/Section/Program of belonging	Landscape Architecture
University/School	Academy of Architecture Amsterdam



Written statement, short description of the project in English, no more than 250 words

'Landscape as House' is about animating the alpine landscape of the authors family by means of a new form of topographic living: a fragmented house integrated into the forests, meadows and the village. Scattered rooms lead to an ongoing movement through the landscape and creates a new form of living that inhabits the topography. The routines and rituals of daily life become rooted in the changing weather and the dynamics of the seasons, strengthening the relationship and connection between person and place. The spatial interventions revive existing buildings and landscape features to create new reciprocal relationships between domestic activities and the environment that they inhabit. Gradually the former small scale farmers land transforms towards a space of personal engagement that revives the cultural heritage of the transhumance landscape of the Bregenzerwald region. The aim of this project is to renew the authors connection with the rural landscape of her family and give new meaning to this seemingly ordinary heritage exemplary for many places in the European countryside. 'Landscape as House' shows how a modern personal space and a newly rooted way of living can contribute to a landscapes biodiversity, habitat diversification, water retention, climate resilience and social engagement.

For further information  
Máster d'Arquitectura del Paisatge -DUOT - UPC

T: + 34 93 401 64 11 / +34 93 552 0842  
Contact via email at: biennal.paisatge@upc.edu

Máster d'Arquitectura del Paisatge -DUOT - UPC  
ETSAB- Escola Tècnica Superior  
d'Arquitectura de Barcelona  
Avenida Diagonal, 649 piso 5  
08028 Barcelona-Spain



CLIMATE CHANGE AGAIN

11th International Biennial Landscape Barcelona

Barcelona September 2020  
SCHOOL PRIZE



# Experiencing 'Landscape as House' as a walk from room to room, through one day and through all seasons

*"getting up, washing myself,  
drinking tea, working, cooking,  
eating, bathing, being together.*

*routines and rituals as acts of  
inhabiting landscape.  
my domestic actions gradually  
transform the landscape around  
me. like a meadow wetted by  
an overflowing bath. a constant  
stream of water reviving old  
topography.*

*domestic functions give elements  
of landscape a new meaning. like  
a new deciduous forest becoming  
a curtain. a space of transition.  
between awake and asleep,  
consciousness and dream,  
enclosed and open, darkness and  
light.  
a revived water stream becoming  
a place to wash yourself. a re-  
opened family well becoming a  
warm bath for us and them.*

*walking in and into i encounter  
many others, human and non-  
human. together we flourish and  
entangle our beings.*

*up there on the mountain,  
the others, the house and i,  
become one as landscape."*

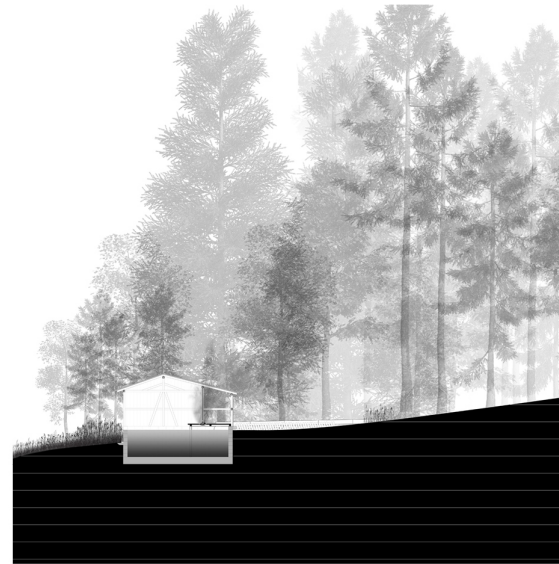
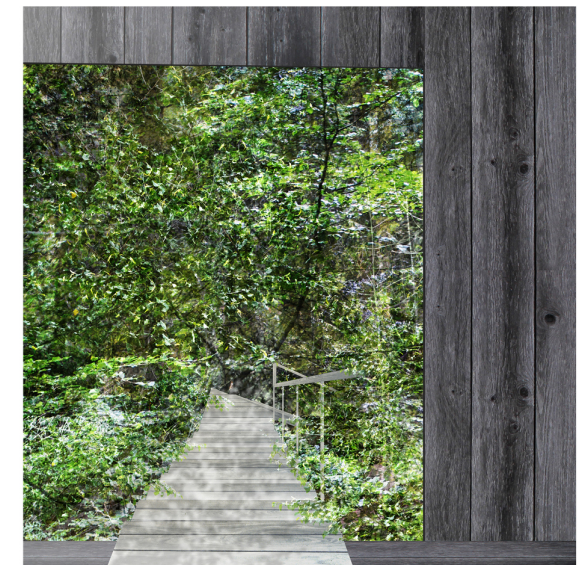
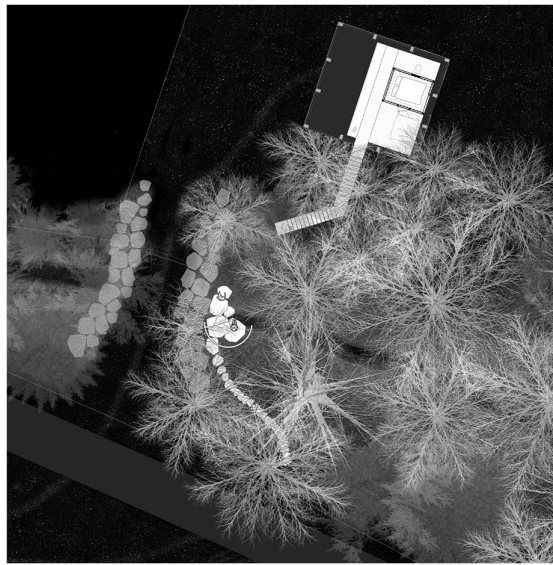



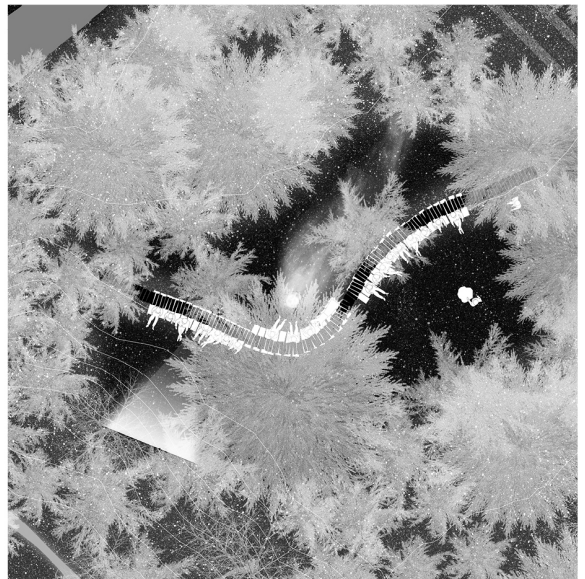
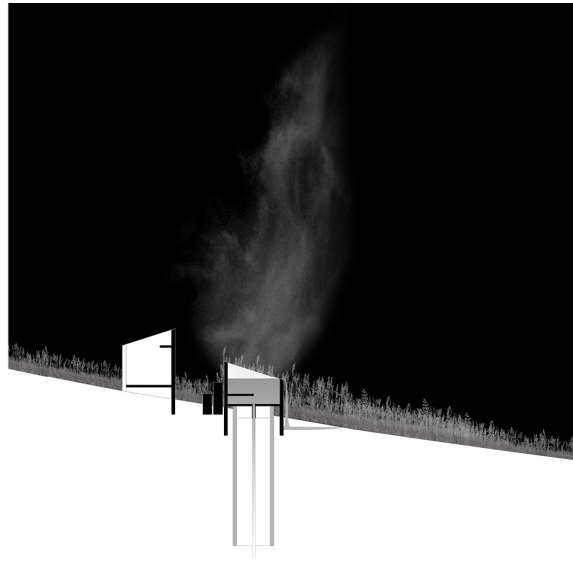
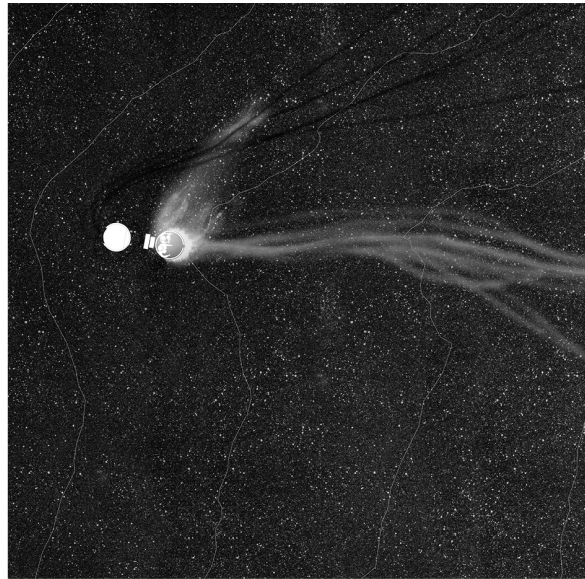
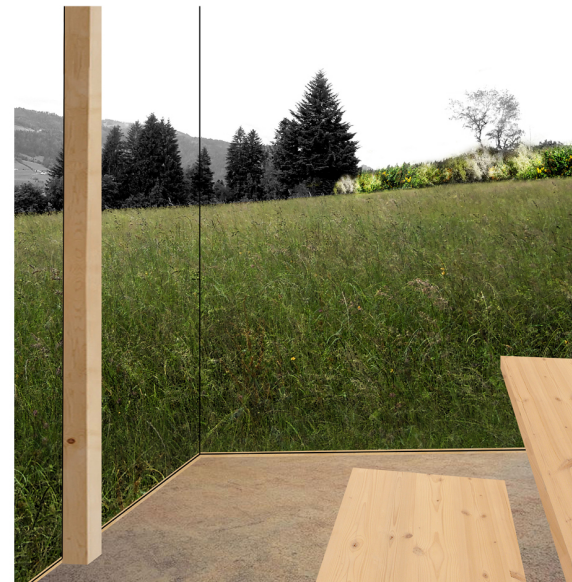
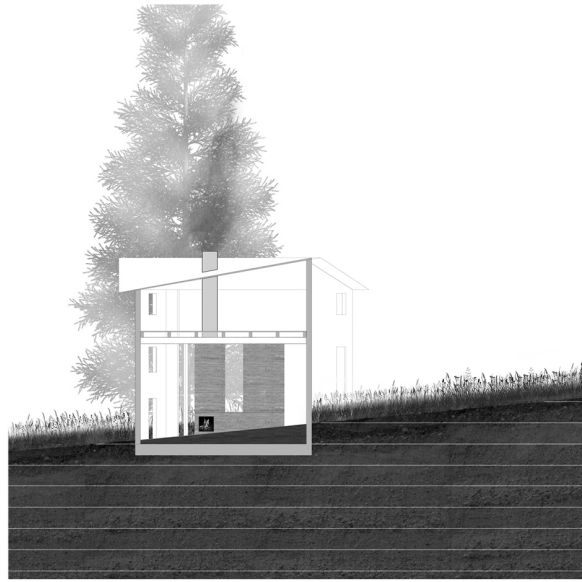
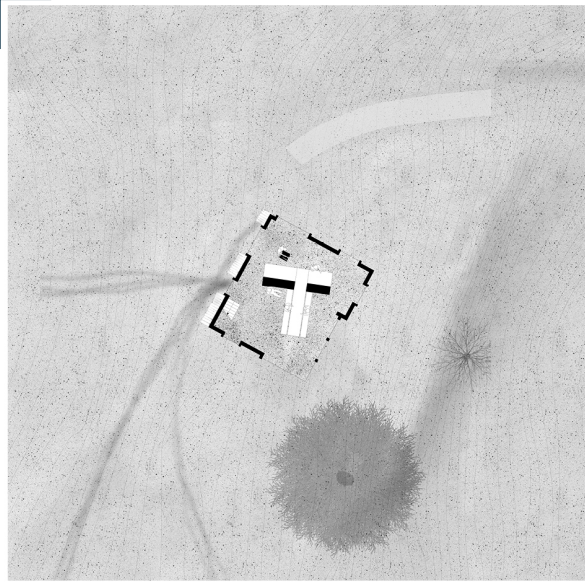

transforming a forgotten  
small scale farmers land  
into a personal landscape  
of constant interaction  
between oneself and one's  
environment

daily life as a cycle of  
care for the land, dwelling  
as a driving force for the  
diversification of the  
cultural landscape



Short film and book  
expanding the ideas  
and concepts towards  
an ongoing research on  
the meaning of **living in  
place, family heritage  
and personal agency**  
within the context of  
landscape

[www.annafink.eu](http://www.annafink.eu)



film 'Landscape as  
House', 8:26 min.  
Elf Godefroy i.s.m.  
Anna Fink

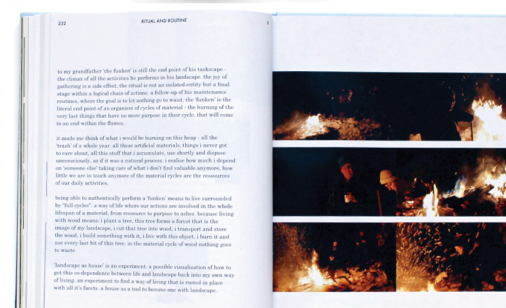
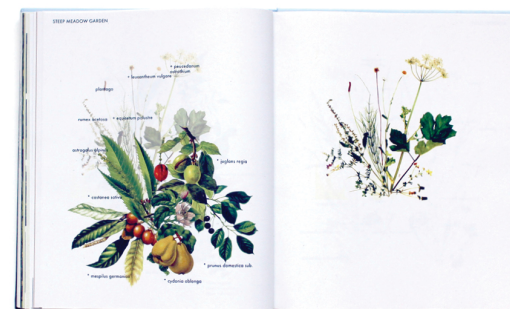
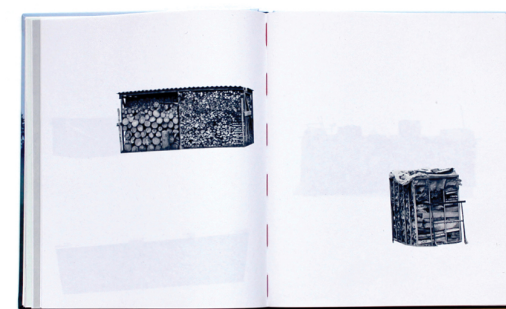
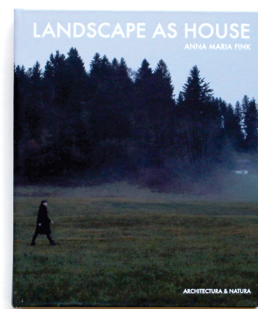

book 'Landscape  
as House'  
(published by  
Architectura  
& Natura,  
Amsterdam, 2018)