

Country / City Norway / Oslo
University / School Oslo School of Architecture and Design
Academic year 2020
Title of the project The Moongrove Garden
Authors Ahmed Faisal

TECHNICAL DOSSIER

Title of the project	The Moongrove Garden
Authors	Ahmed Faisal
Title of the course	Master Diploma Project
Academic year	2020
Teaching Staff	Luis Callejas
Department/Section/Program of belonging	Institute of Urbanism and Landscape
University/School	Oslo School of Architecture and Design



Written statement, short description of the project in English, no more than 250 words

The coastal human - forest interface of the Bengal delta is locally called 'The Country of Tides', where an inhospitable saline land of mangrove meets manmade freshwater landscapes in the fractal matrix of countless rivers and channels that are fed by brackish moon tides. To ensure a flood and saline free inland environment, people had to control this landscape, and as a result, today the interface is divided into polders and forests. How should dwellers meet the Mangroves in this hotspot of ecological, geomorphic, and cultural diversities? People stopped capturing new forest lands long ago and locked themselves inside the polders, but the rivers still continue to erode and deposit at the polder's outsides. New lands without a clear property status are created between forests and polders. Mangrove tries to migrate into these parts by sending over floating germinated seeds; while farmers try to take control by creating saltwater shrimp ponds. People of this area believe in a "temple-less" guardian goddess. The goddess 'Bonobi-bi' was sent to this tide country from Mecca to maintain the harmony between humans and nature. The myth exceeds the borders of polders; extends towards the forests and has been surprisingly successful in creating a strong communal existence. The project is a garden for the community in a 'land without an owner', where humans meets the mangroves and the goddess without a temple, tries to create balance by sending over the moon tides. The tides enter the site through a breached embankment, create a mudflat and go to a tidal pond through a sluice gate. From the tidal pond brackish water and fresh water finds their own destinations between spaces with different degree of control. Seen from a strategic point of view, the project will belong to the community, opposing the expansion of the shrimp industries.

For further information
Máster d'Arquitectura del Paisatge -DUOT - UPC

T: + 34 93 401 64 11 / +34 93 552 0842
Contact via email at: biennal.paisatge@upc.edu

Máster d'Arquitectura del Paisatge -DUOT - UPC
ETSAB- Escola Tècnica Superior
d'Arquitectura de Barcelona
Avenida Diagonal, 649 piso 5
08028 Barcelona-Spain



CLIMATE CHANGE AGAIN

11th International Biennial Landscape Barcelona

Barcelona September 2020
SCHOOL PRIZE

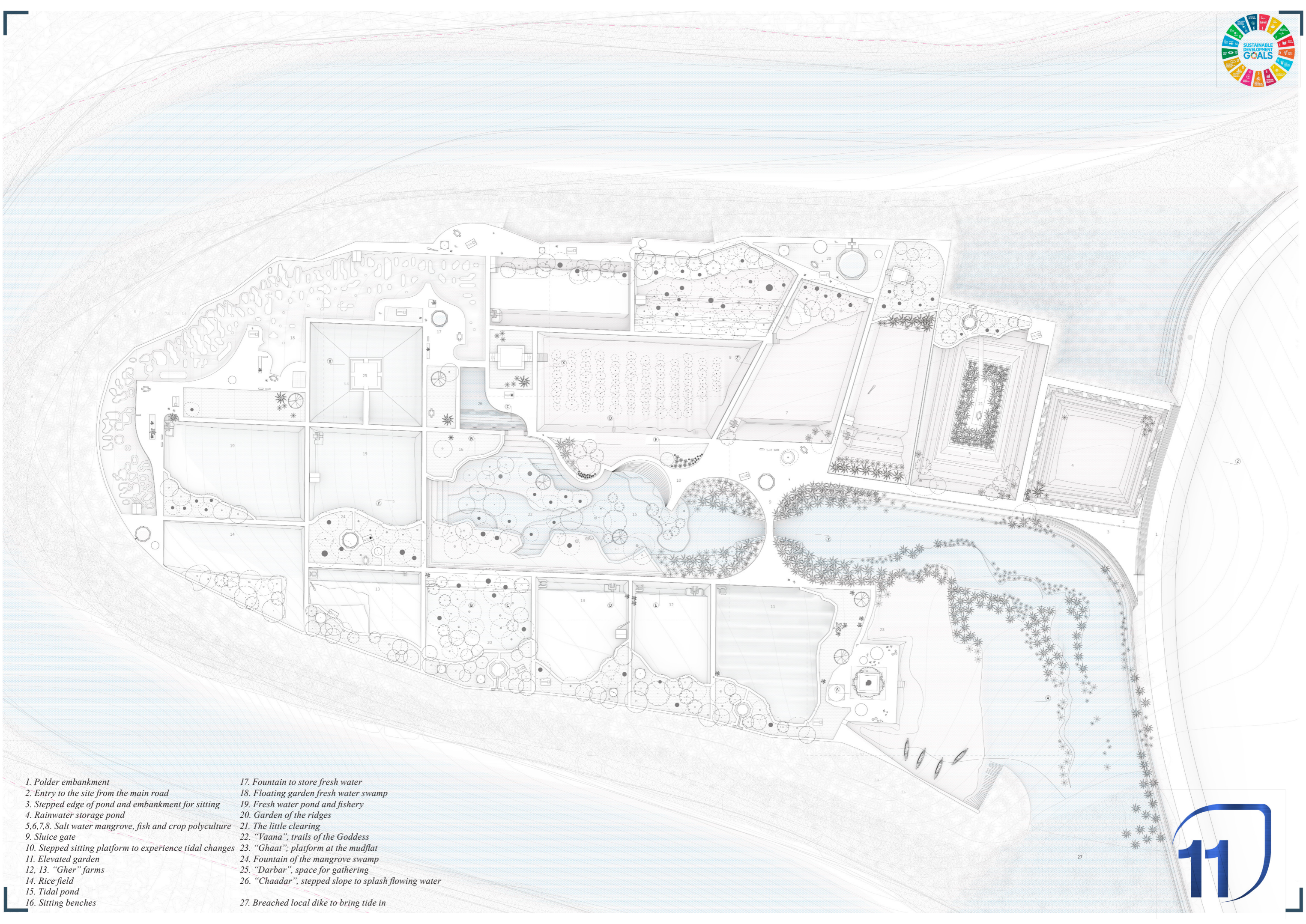

- 1. Polder embankment
- 2. Entry to the site from the main road
- 3. Stepped edge of pond and embankment for sitting
- 4. Rainwater storage pond
- 5,6,7,8. Salt water mangrove, fish and crop polyculture
- 9. Sluice gate
- 10. Stepped sitting platform to experience tidal changes
- 11. Elevated garden
- 12, 13. "Gher" farms
- 14. Rice field
- 15. Tidal pond
- 16. Sitting benches
- 17. Fountain to store fresh water
- 18. Floating garden fresh water swamp
- 19. Fresh water pond and fishery
- 20. Garden of the ridges
- 21. The little clearing
- 22. "Vaana", trails of the Goddess
- 23. "Ghaat"; platform at the mudflat
- 24. Fountain of the mangrove swamp
- 25. "Darbar", space for gathering
- 26. "Chaadar", stepped slope to splash flowing water
- 27. Breached local dike to bring tide in

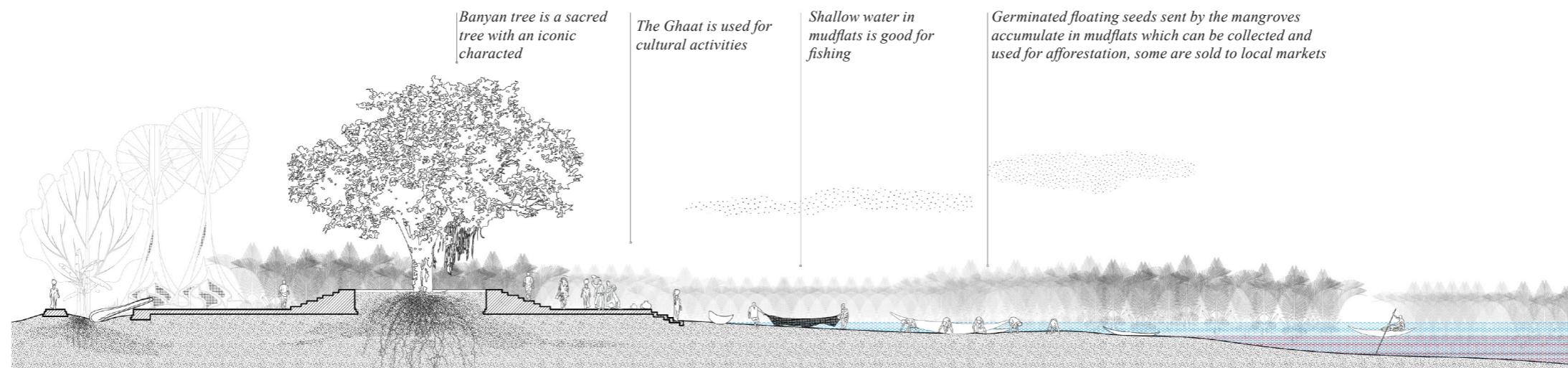
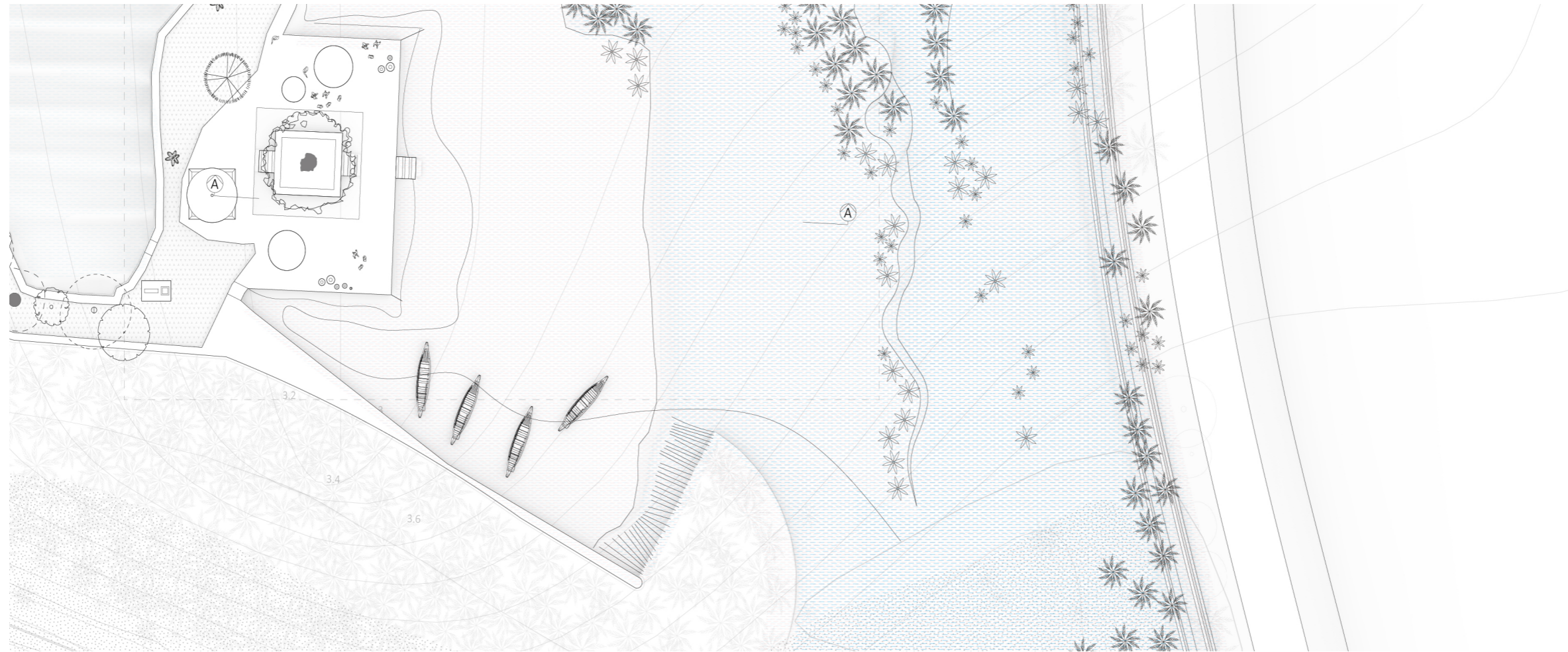

1. Walkway to sluice gate
2. Walkway on bund
3. Elevated platform for sitting
4. Stack for Nypa Palm
5. Elevated platform for Banyan tree
6. Raised step
7. Sediment and germinated mangrove seed accumulation on the mudflat

8. Fine sediment accumulation on the palm roots
9. Deep area with year round tides
10. Grassland suitable for vegetable plantation
11. Water discharge area from adjacent field
12. Raised bed farmland

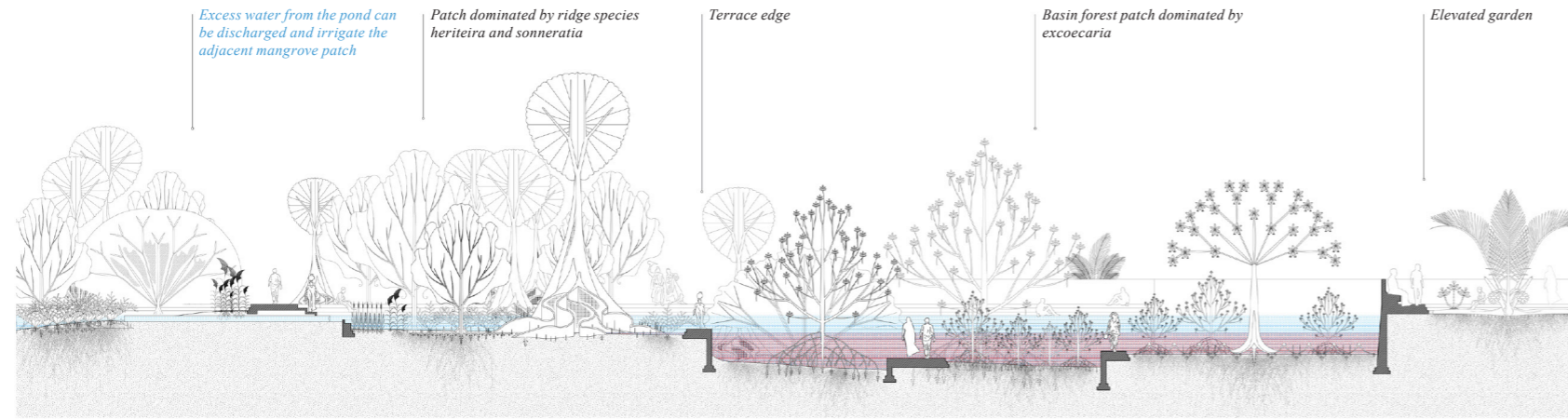

Section A

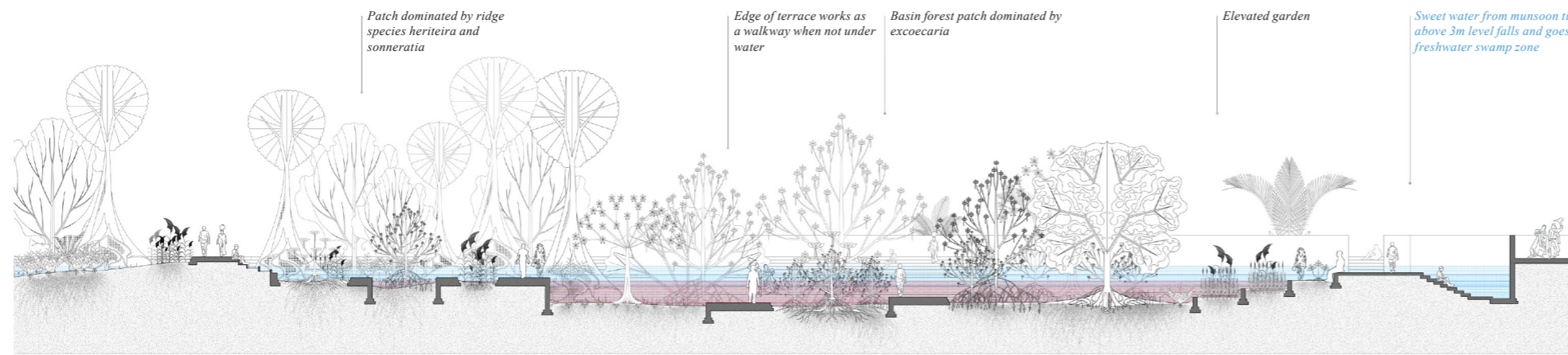

Section B

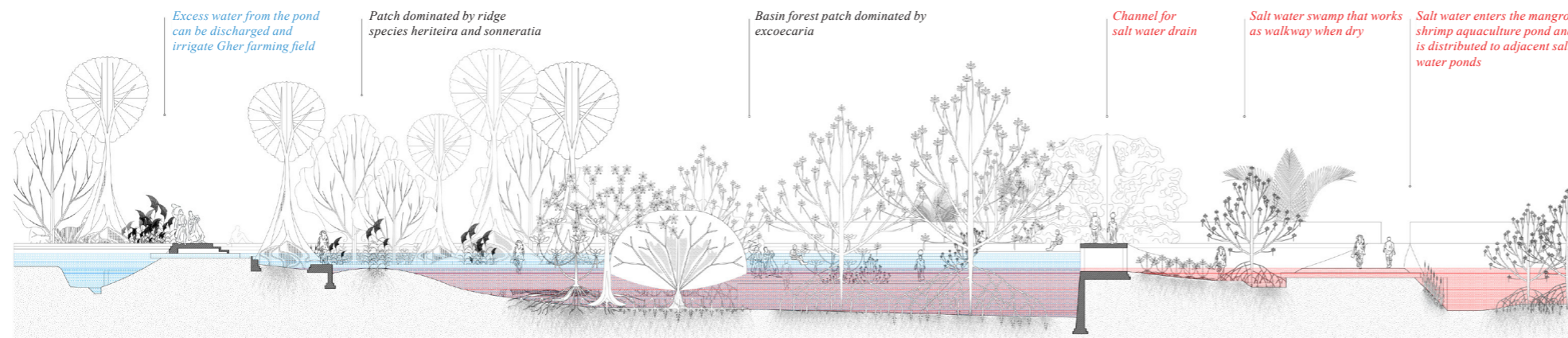

Section C

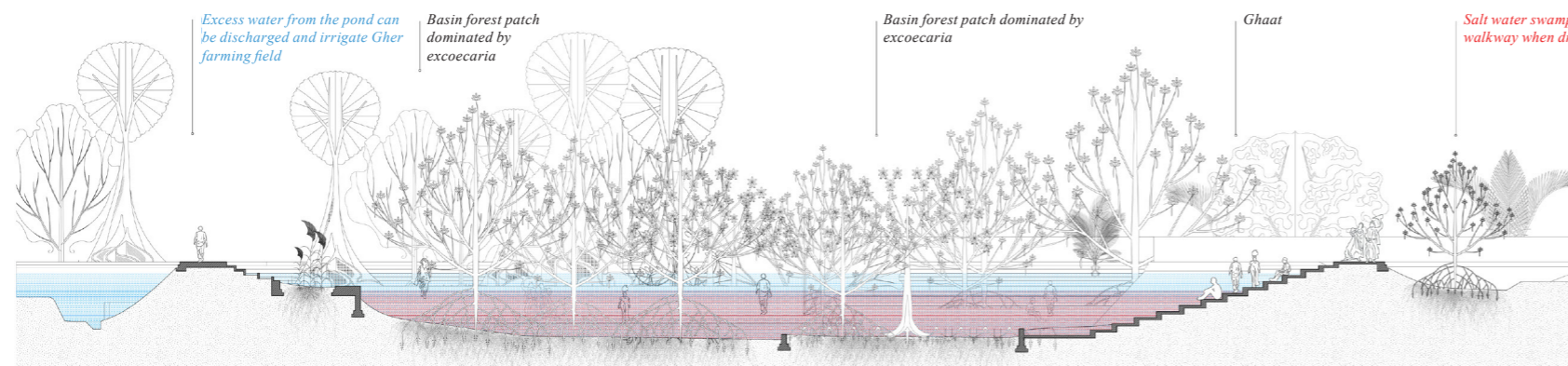

Section D

