

Country / City SPAIN

University / School UNIVERSITY OF VALLADOLID / SCHOOL OF ARCHITECTURE

Academic year 2019 / 2020

Title of the project THE RAILWAY LANDSCAPE IN VALLADOLID

Authors ANA DOYAGUE GONZÁLEZ - MAR FERNANDEZ MARTINEZ - MIGUEL ORTEGA ENCINAS

TECHNICAL DOSSIER

Title of the project	THE RAILWAY LANDSCAPE IN VALLADOLID
Authors	ANA DOYAGUE GONZALEZ - MAR FERNÁNDEZ MARTÍNEZ- MIGUEL ORTEGA ENCINAS
Title of the course	ARCHITECTURAL COMPOSITION V: CONTEMPORARY GARDEN AND LANDSCAPE
Academic year	2019 / 2020
Teaching Staff	DARÍO ÁLVAREZ (Coord.) - SAGRARIO F. RAGA - CARLOS RODRÍGUEZ - LAURA LÁZARO
Department/Section/Program of belonging	
Theory of Architecture and Architectural Design / Architectural Composition / Degree in Architecture	
University/School	UNIVERSITY OF VALLADOLID / SCHOOL OF ARCHITECTURE



Written statement, short description of the project in English, no more than 250 words

Valladolid is a city located in the north central of Spain, within the region of Castilla y Leon. The work area is about abandoned train mechanical workshops.

After analysing one of the urban problems, the division of the city caused by railway lines, we project a landscape idea that tries to alleviate this problem.

The train brings with it many elements that condition the aesthetics of the city. One of them is the wall that protects it and creates a visual and communicational barrier between the two parts of the city.

For this, the following compositional strategies will be carried out, all with the purpose of tying, linking the city and allowing connections. Through an overlapping of plots, chosen not per case, but following pre-existing and historical criteria.

The superimposition of plots tries to represent the imprint of the passage of time throughout the different eras that have transformed the city. The different historical periods, which have favoured the growth of Valladolid, have each done so in a different way, and this is what we have wanted to transfer to the project, in such a way that each plot represents a period of history linked to each representative aspect of the project.

The whole complex, in turn, will obtain an industrial character due to its historical past as railway workshops.

For further information
Máster d'Arquitectura del Paisatge -DUOT - UPC

T: + 34 93 401 64 11 / +34 93 552 0842
Contact via email at: biennal.paisatge@upc.edu

Máster d'Arquitectura del Paisatge -DUOT - UPC
ETSAB- Escola Tècnica Superior
d'Arquitectura de Barcelona
Avenida Diagonal, 649 piso 5
08028 Barcelona-Spain



CLIMATE CHANGE AGAIN

11th International Biennial Landscape Barcelona

Barcelona September 2020
SCHOOL PRIZE



valladolid
grouth



stamp

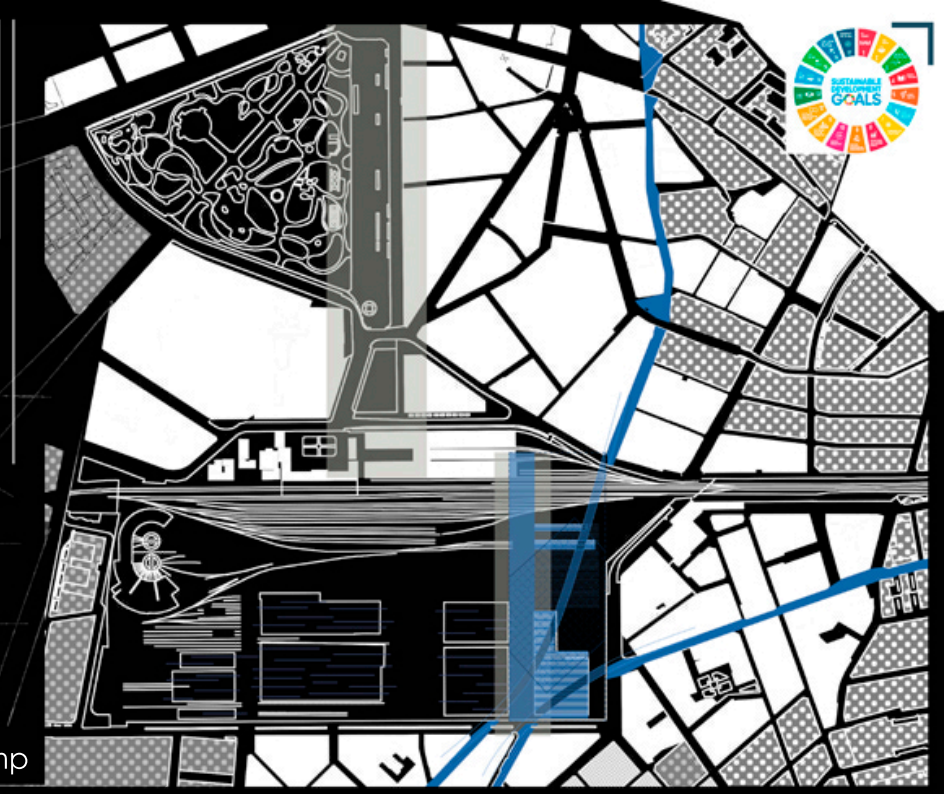

frame
overlay

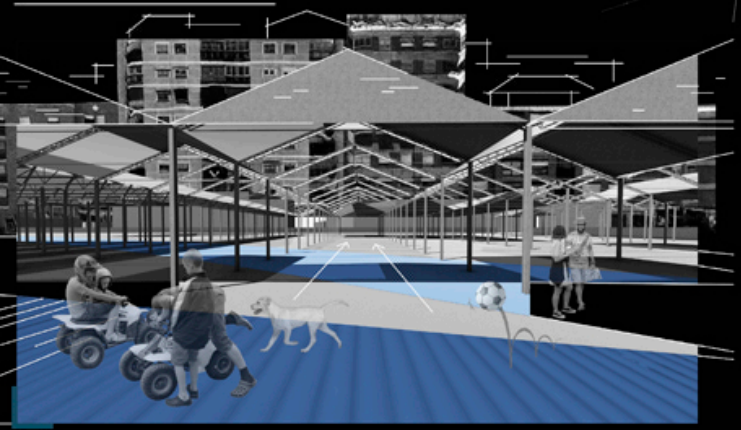

continuity of existing routes

relocation of the industrial modulation

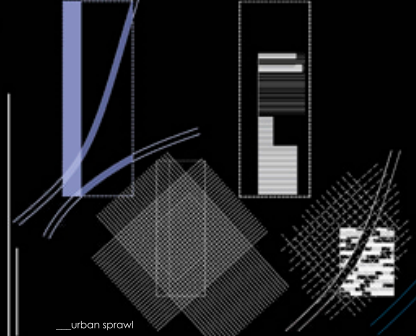

urban sprawl

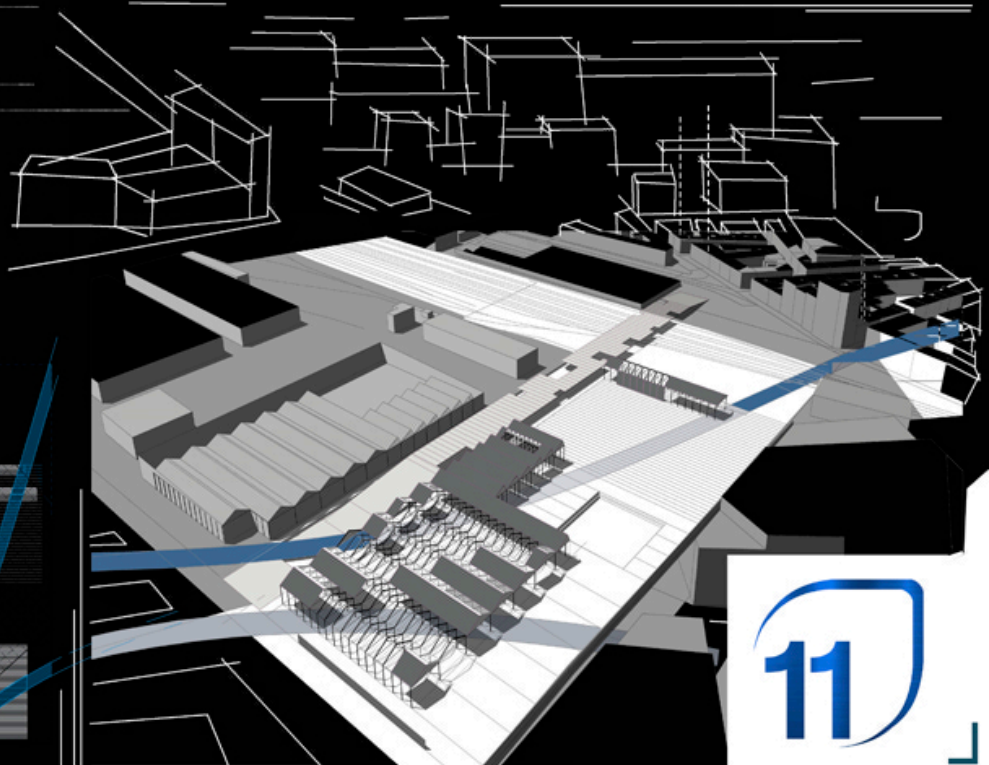



CONNECTION BETWEEN ZONES

THE SUPERIMPOSITION OF PLOTS

_Temporary Market

_Foodtrucks

_Energy square

_Shortcut

_Shunken phat

_Bar

_Columns and trunks forest

_Various

_Kindergarden

_Gateway

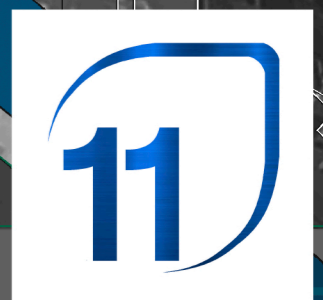

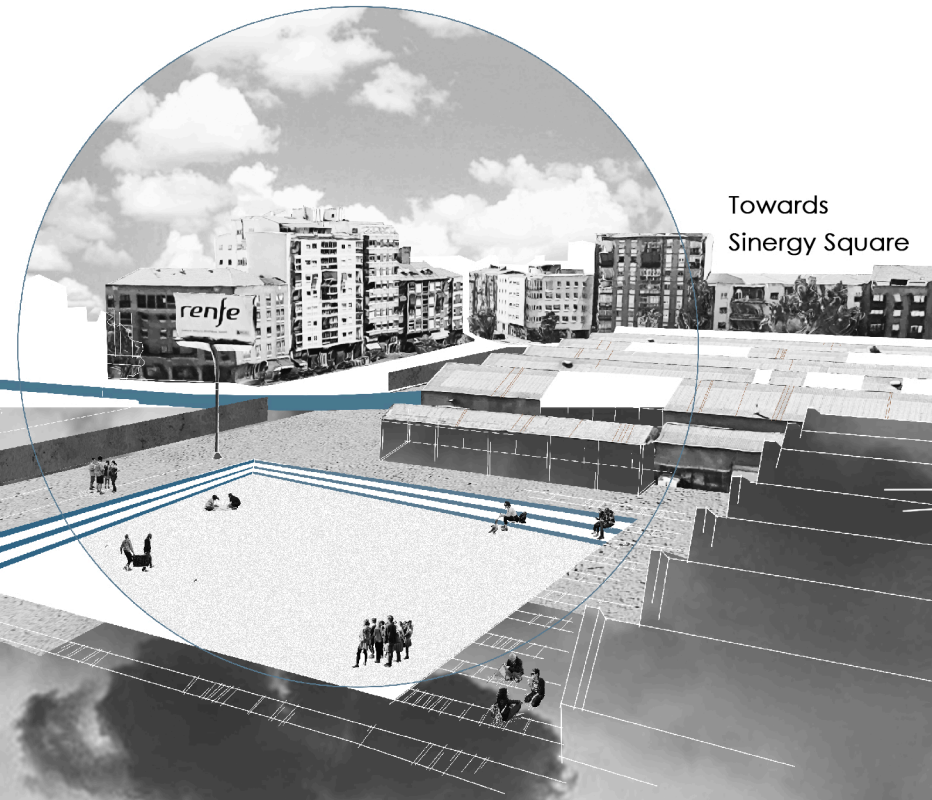

Towards Sinergy Square

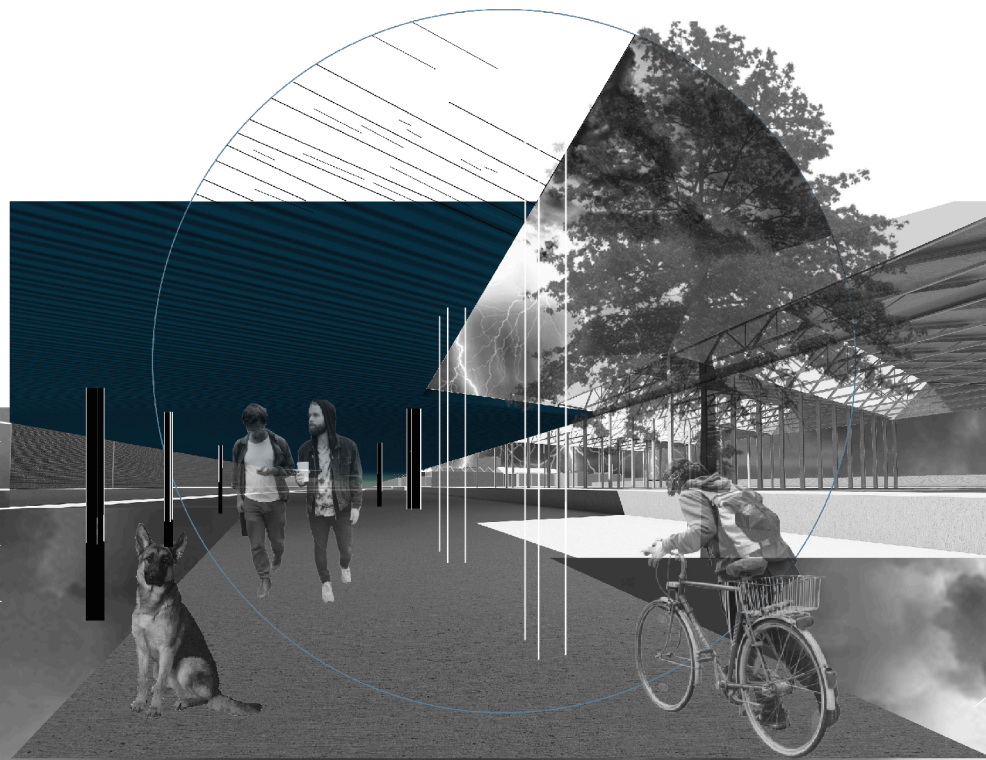

Under the gateway



On the gateway

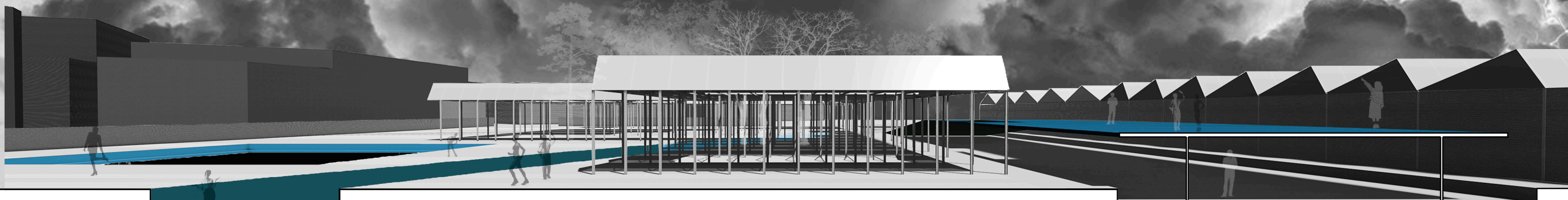

Transversal Section

