



Country / City
University / School
Academic year
Title of the project
Authors

Chile / Valparaíso
Universidad de Valparaíso
Taller de Título 2 / 6th year / 2019
Industrial Ruin Park, "El Sauce" Basin
Macarena Monsalve Cáceres



TECHNICAL DOSSIER

Title of the project	Parque de Ruina Industrial, Cuenca "El Sauce" / Industrial Ruin Park, "El Sauce" Basin
Authors	Macarena Monsalve Cáceres
Title of the course	Taller de Título 2
Academic year	6th year / 2019
Teaching Staff	Cristian Rojas Cabezas
Department/Section/Program of belonging	Escuela de Arquitectura / Facultad de Arquitectura
University/School	Universidad de Valparaíso



The economic growth of Valparaíso at the beginning of the 20th century, led to its integration into the electric modernity. The high demand for this new energy required the creation of substations to supply elevators, trams and homes. The Hydroelectric "El Sauce". Submerged between the depths of the "Back of Valparaíso" (El Sauce Basin), this landscape rises as the antithesis of a controlled and trivialized city; her insides hide waterfalls and diaphanous mirrors of water, together with Silent Giants of a glorious past, today titanic works industrial ruins. Ponds, aqueducts, dams and turbines rest among the murmur from the forest: The Other Valparaíso, "The Other Landscape". Enigmatic Industrial objects in amalgam with nature, generate an intense experience sensory in the individual with infinity of textures, aromas and forms present there, such as Tim Edensor would manifest in his exploration of industrial ruin. The ambiguity of his languages, the exaggerated contrast of elements, the incompleteness of their figure, are brought to one extreme, composing scenarios typical of surrealism and the dreamlike. The Park longitudinally comprises 3 territorial elements: Plateau, (Dam Intervention), Hill Summit (Pond Intervention), Valley Depth (Hydroelectric Intervention). The project surrounds the ruin, building a story between THE SLIGHT AND THE HEAVY, THE ROUGH AND THE CLEAR. Nature is inserted, the water flows, the randomness allows the unfolding of its own perception and intuition above space, releasing the unconscious into the "real" world.

For further information
Máster d'Arquitectura del Paisatge -DUOT - UPC

T: + 34 93 401 64 11 / +34 93 552 0842
Contact via email at: biennal.paisatge@upc.edu

Máster d'Arquitectura del Paisatge -DUOT - UPC
ETSAB- Escola Tècnica Superior
d'Arquitectura de Barcelona
Avenida Diagonal, 649 piso 5
08028 Barcelona-Spain



CLIMATE CHANGE AGAIN

11th International Biennial Landscape Barcelona

Barcelona September 2020
SCHOOL PRIZE

"...the encounter between steel and water reflections. Between heavy and light..."

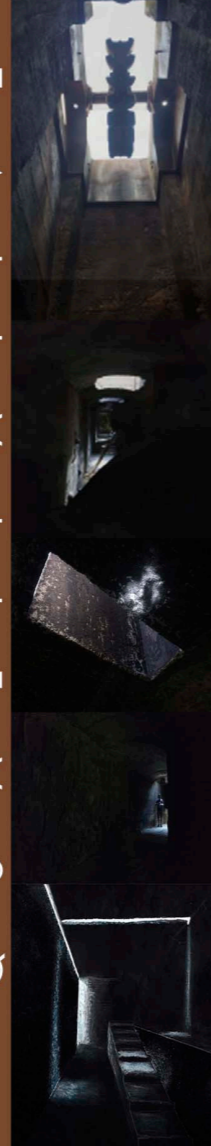
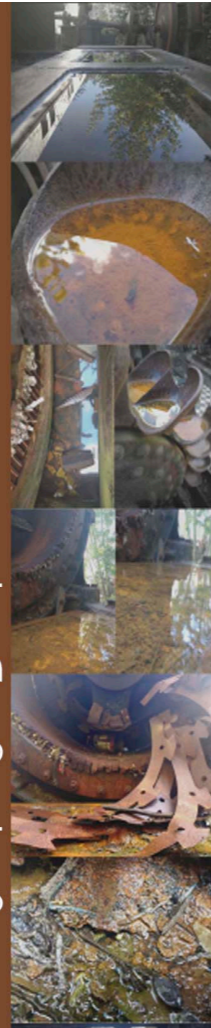
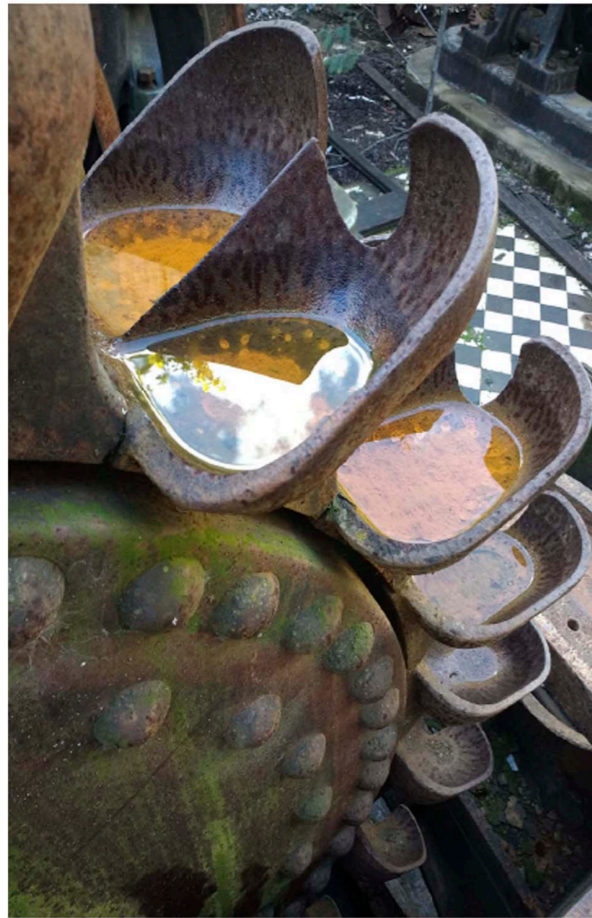

Constituent Elements of the Territory

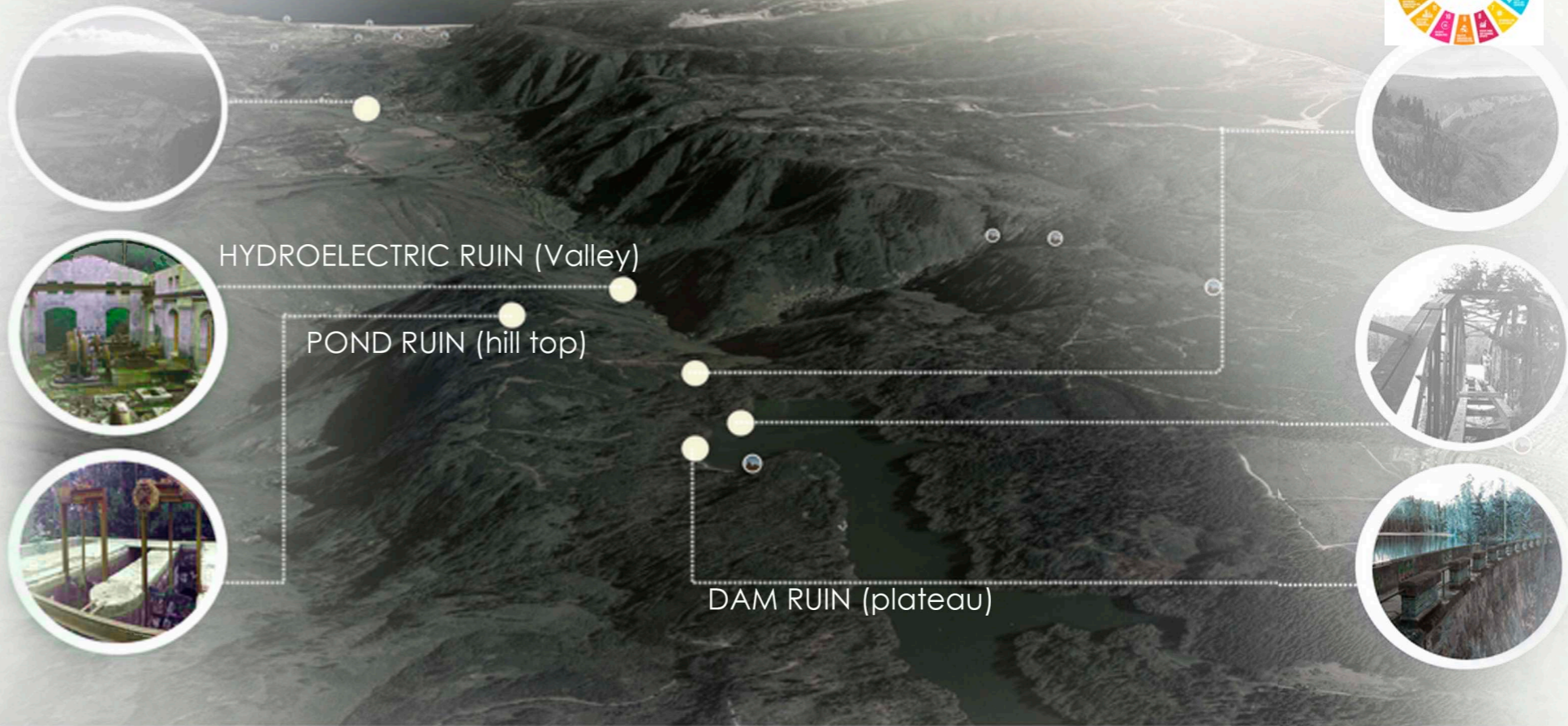

Hydrographic - Geographic Scope

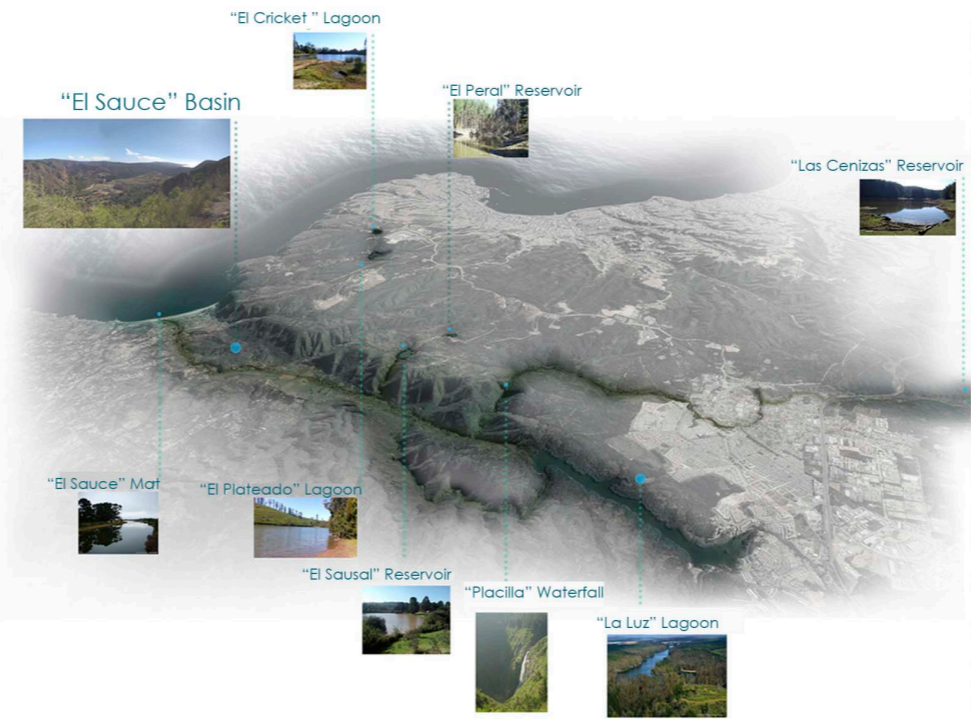

Connections - Ruins Landmark Scope

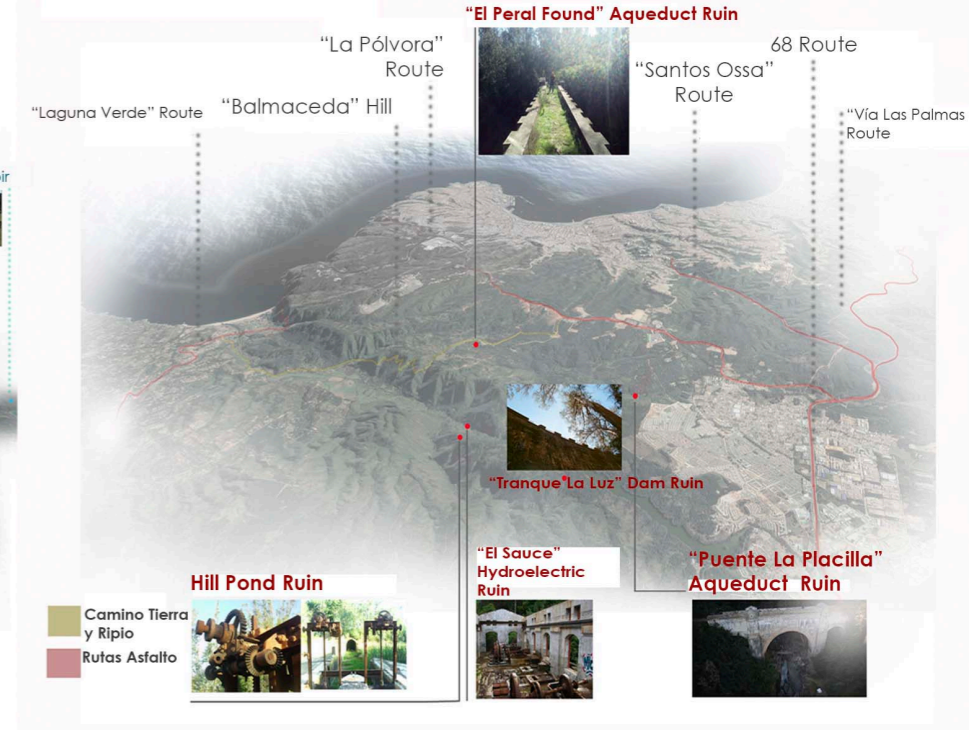

REFERENCES





SUBMERGED MUSEUM

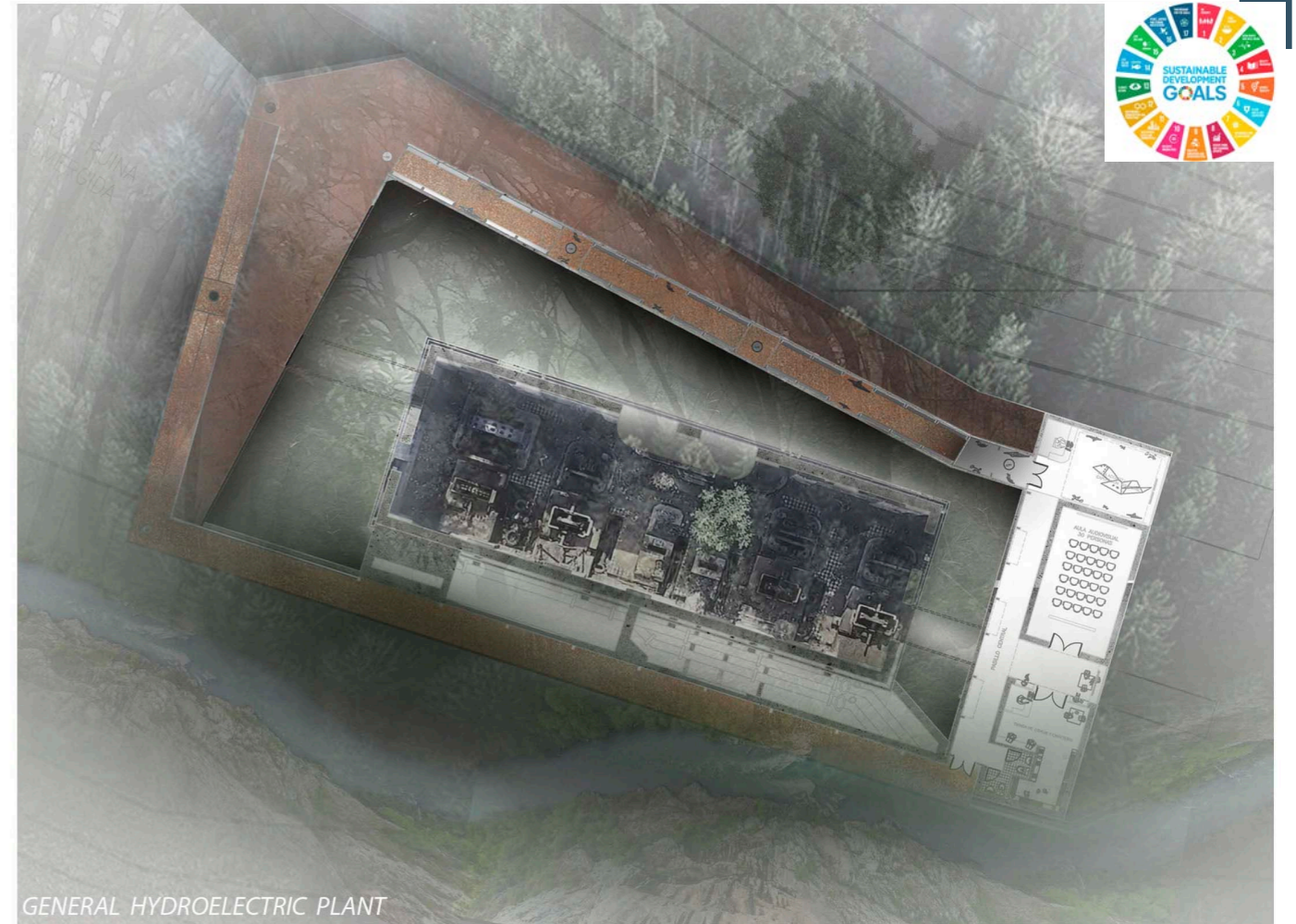

GENERAL HYDROELECTRIC PLANT

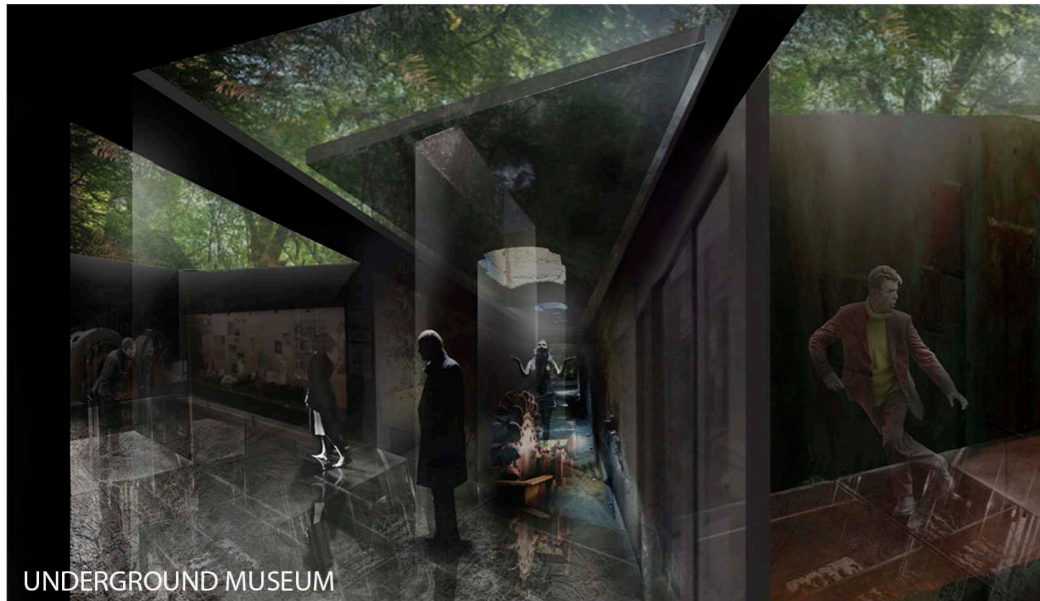

UNDERGROUND MUSEUM

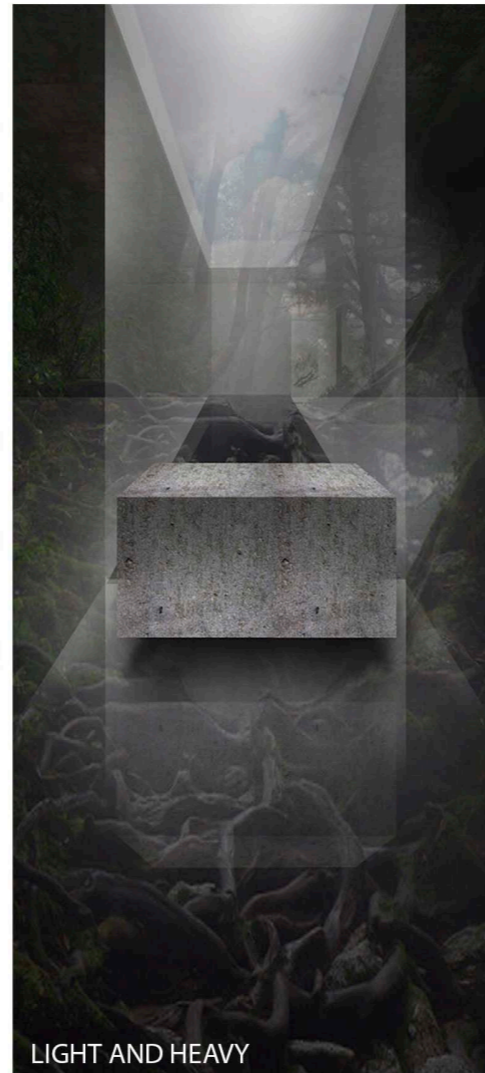

LIGHT AND HEAVY



CROSS - SECTION



DIALOGUE BETWEEN VAPOROUS AND ROUGH

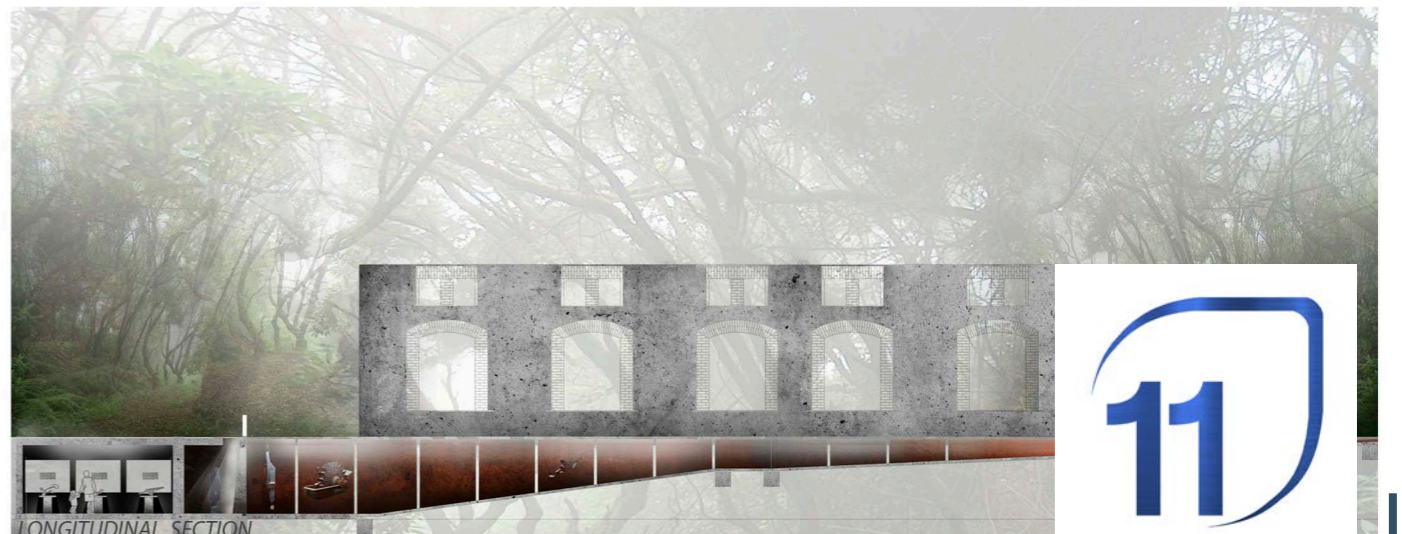

LONGITUDINAL SECTION





REST AREA AND DINING ROOMS



ADMINISTRATION AND EDUCATIONAL AREA



GENERAL PLANT POND

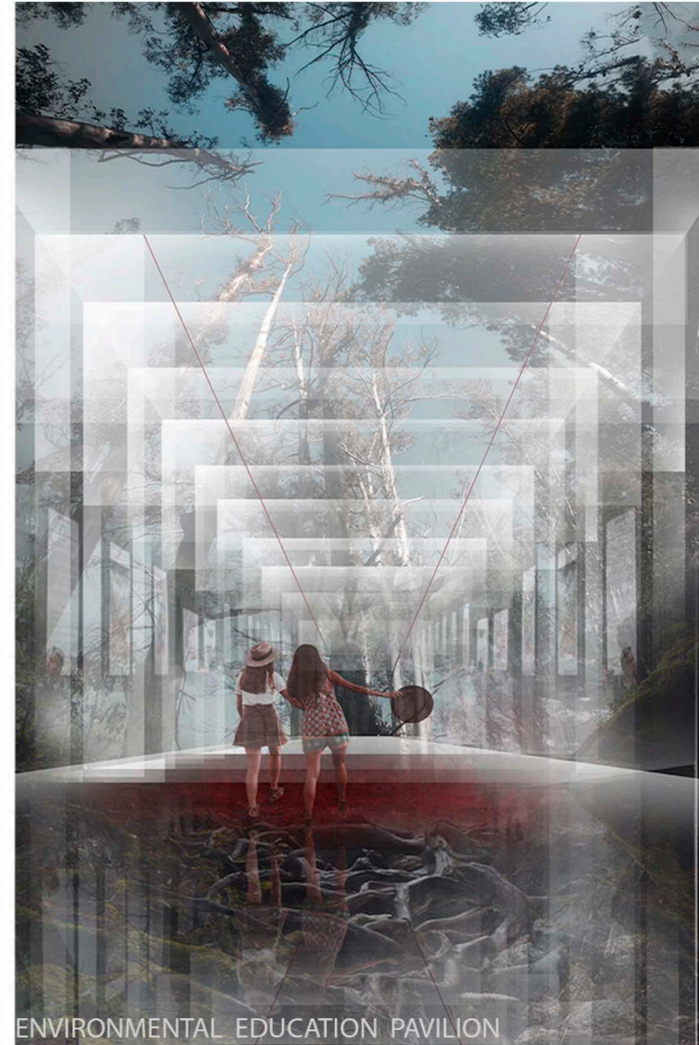

ENVIRONMENTAL EDUCATION PAVILION

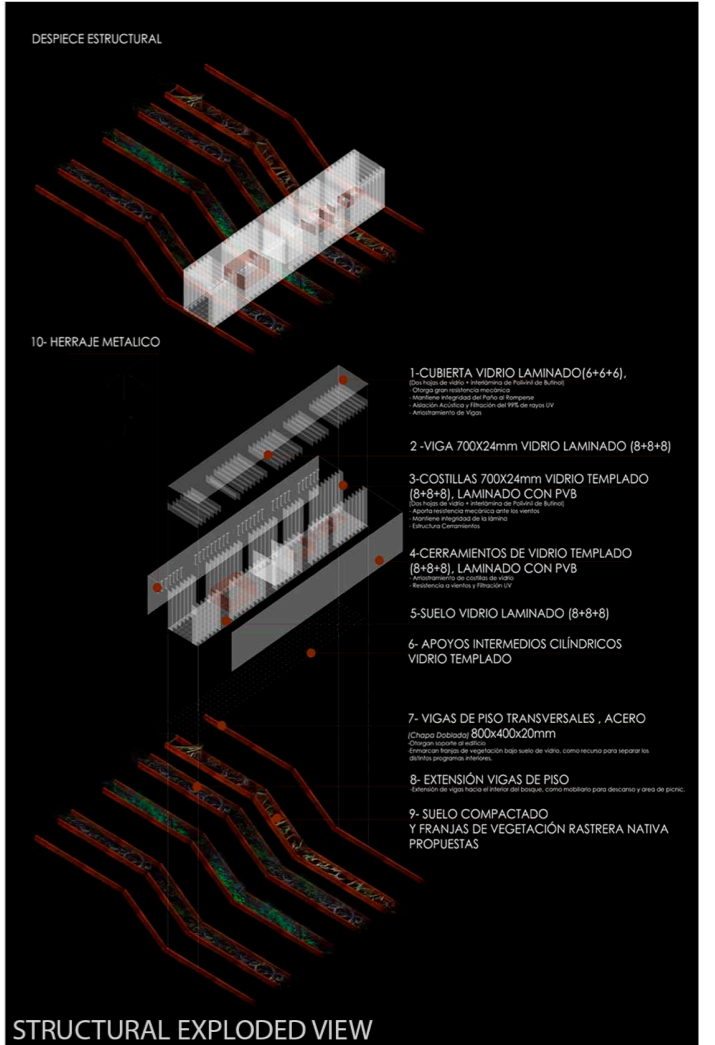

STRUCTURAL EXPLODED VIEW

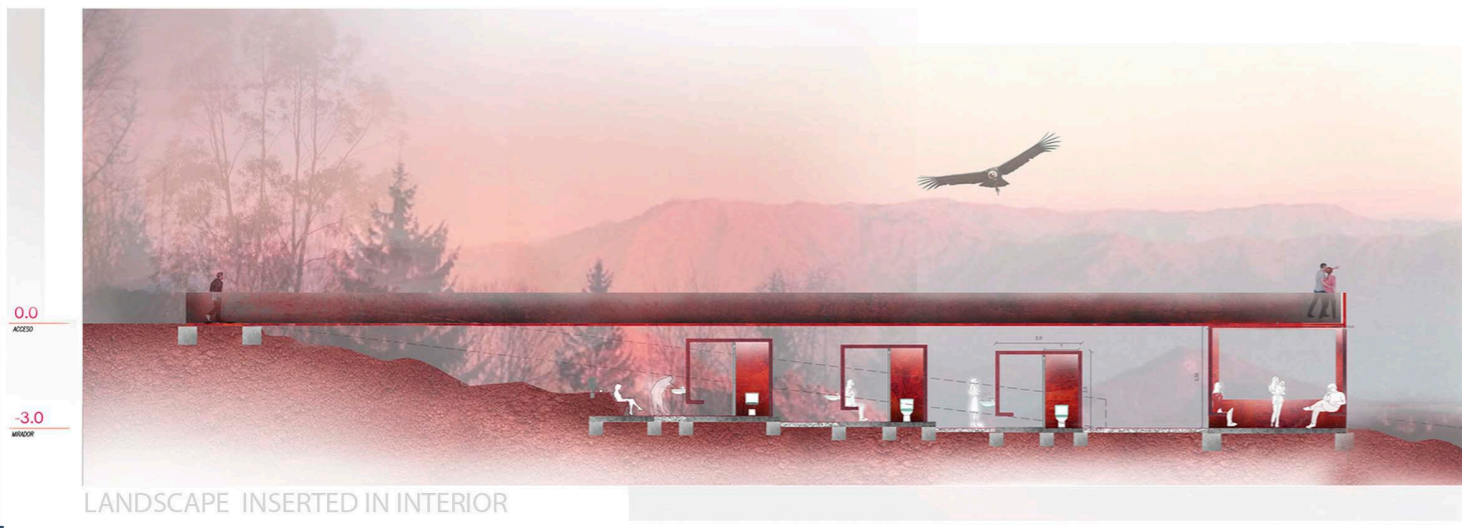

LANDSCAPE INSERTED IN INTERIOR

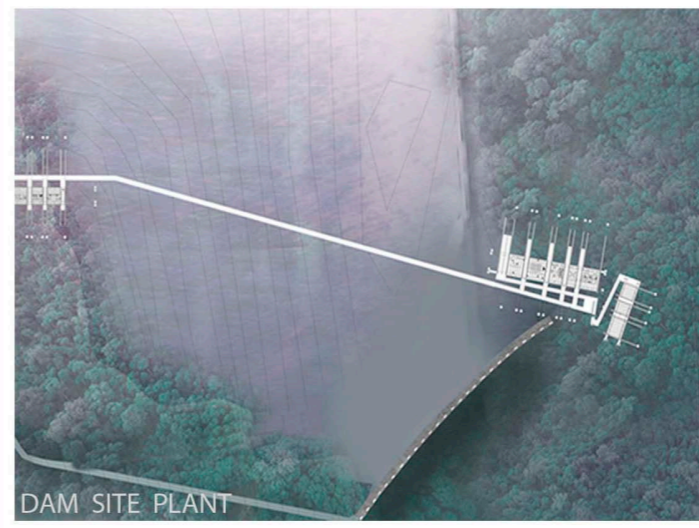

DAM SITE PLAN



DAM SECTION

