



Country / City Thessaloniki, Greece

University / School Aristotle University of Thessaloniki

Academic year 2019-2020

Title of the project Alice in natureland

Authors Chatzikonstantinou Efi, Nikolaou Kalypso, Remma Maria

TECHNICAL DOSSIER

Title of the project Alice in natureland
Authors Chatzikonstantinou Efi, Nikolaou Kalypso, Remma Maria
Title of the course Landscape Design of Urban Space
Academic year 2019 - 2020
Teaching Staff Athanasiadou E., Vitopoulou A., Gementzi G., Zabraka D., Tratsela M., Gabrhilidou e., Grimba E., Mouratidou g.
Department/Section/Program of belonging School of Architecture / Faculty of Engineering
University/School Aristotle University of Thessaloniki



Written statement, short description of the project in English, no more than 250 words

The project is a stream - 'entrance' to Seikh Su forest, a 'natural lung' of Thessaloniki that invites visitors to discover nature, get closer to the flora and fauna of the area, and change the way they think and act, for the benefit of the planet.

Alice (in Wonderland) is a girl outraged by the real world who is suddenly transferred to a fantastic universe. Similarly in our project, the visitor, entering the stream feels like a child, escaping from reality. Through the 'Rabbit holes' (restriction of entrances at specific key points) he discovers a distorting green dimension away from the city noises. A 'breath of clean air' in a densely populated area of Thessaloniki that improves its microclimate.

Narrative routes, constantly changing scenery and scales, lost and found passages and the 'palace of Alice' overlooking the whole project are some of the determining keys of the design process.

An important element of the project is its special materiality, mixture of many materials from ruins and rubble of demolished buildings in the surrounding area that through a recycling process are reused as a 'mosaic' for our interventions in the landscape. This material transition could remind people of the damage that we have caused to our land and expose new values for material waste to protect future life.

Our goal is to strengthen the existing natural landscape and create a strong interrelationship between the schoolyard and the stream with primary concern the development of consciousness on the issue of the protection of the natural environment.



CLIMATE CHANGE AGAIN

11th International Biennial Landscape Barcelona

For further information
Máster d'Arquitectura del Paisatge -DUOT - UPC

T: + 34 93 401 64 11 / +34 93 552 0842
Contact via email at: biennial.paisatge@upc.edu

Máster d'Arquitectura del Paisatge -DUOT - UPC
ETSAB- Escola Tècnica Superior
d'Arquitectura de Barcelona
Avenida Diagonal, 649 piso 5
08028 Barcelona-Spain

Barcelona September 2020
SCHOOL PRIZE

Polygnotou stream - Thessaloniki, Greece



points of interest



Seikh Su forest

- schools <12min walking
- Elaiorema - recreation Park
- rest home
- entrance-exit of the circumferential road (<4min)
- green zone / public square
- sport facilities
- cultural centre of Touba

Notes:

- lack of green zones/parks/public squares
- big number of schools and sport facilities
- need for decompression zones in the densely populated area

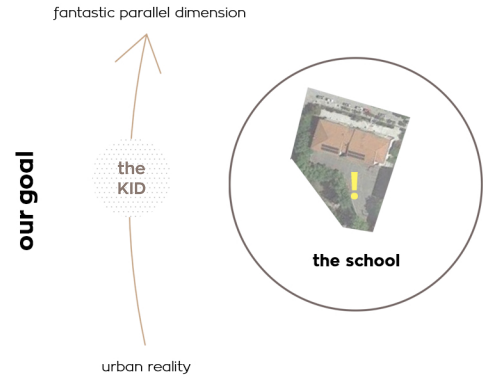

Alice's Story site render

- the palace
 - wandering exploration
 - scale change illusion
 - the Rabbit Hole
-

general plan

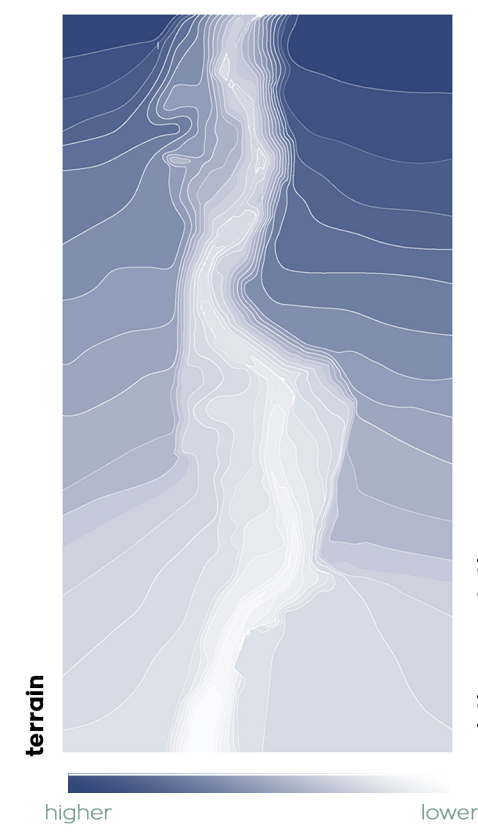
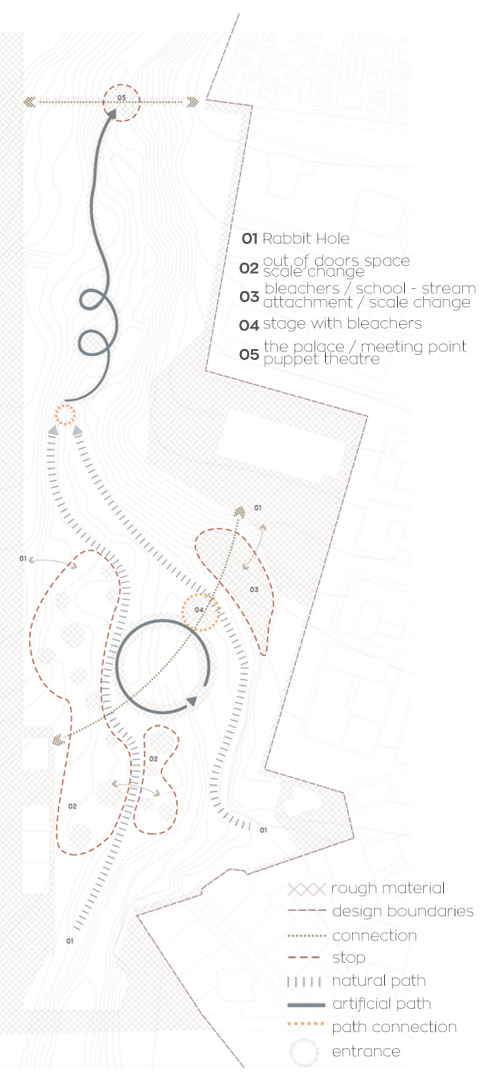

existing vegetation



traffic

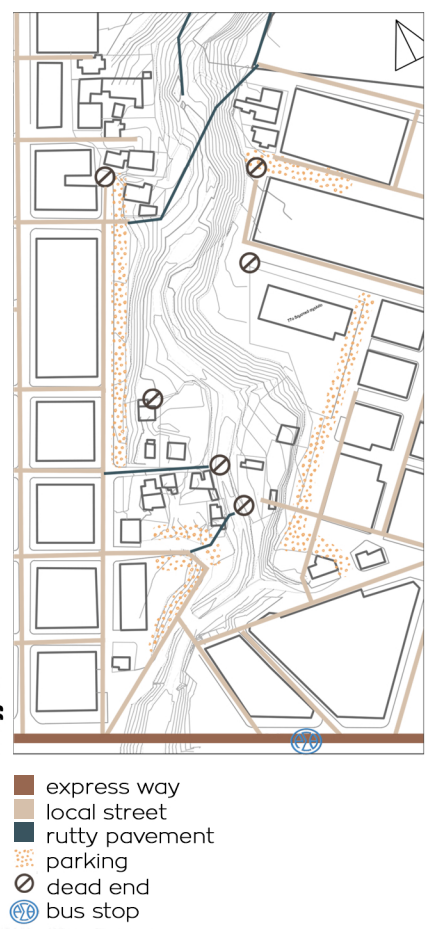

vegetation species



suggested activities

- 02 Reading point
 - 03 Sport area
 - 03 concerts
 - 06 meeting points
 - 03 theatre
 - observatory
-

main problems

possible user's needs

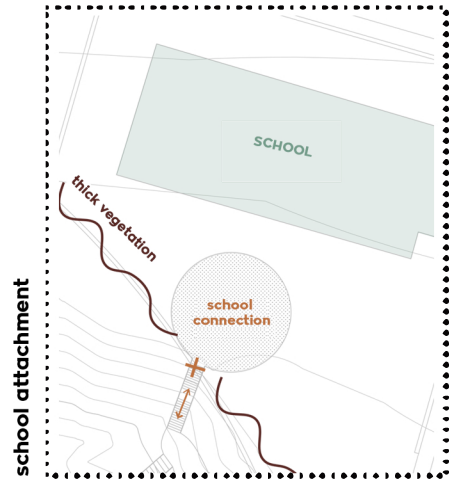

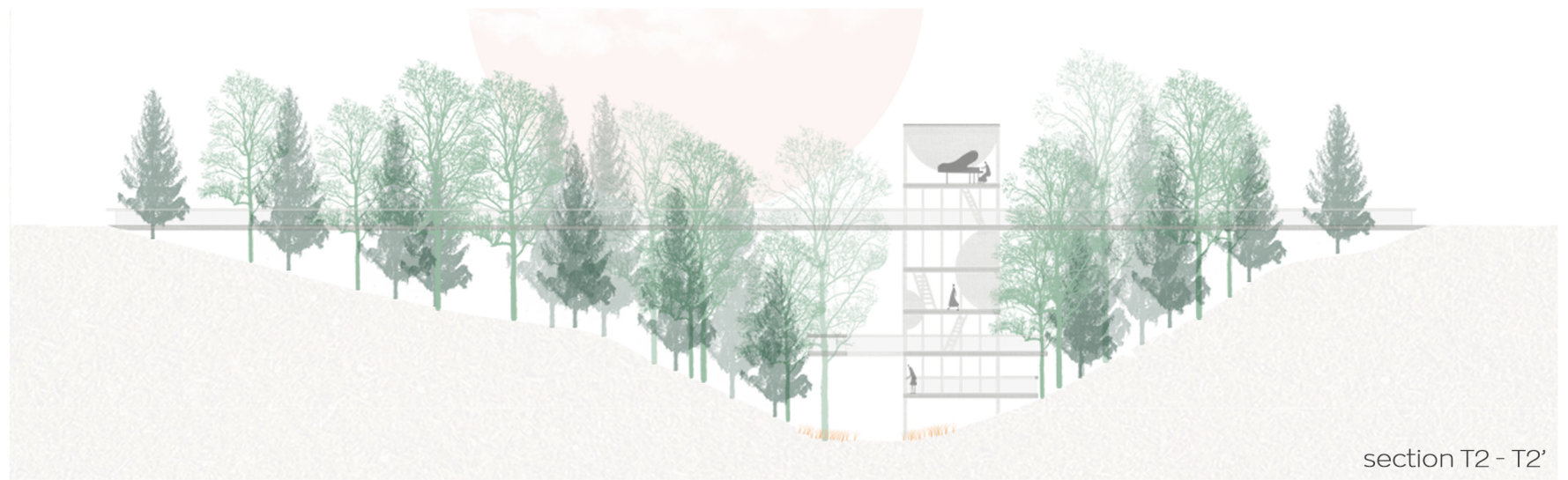

Demolition waste recycling

A mixture/blending of many materials from old ruins and rubble of demolished buildings in the stream area that through a recycling process are reused to create a 'mosaic' for our interventions in the landscape

demolish → process → reuse

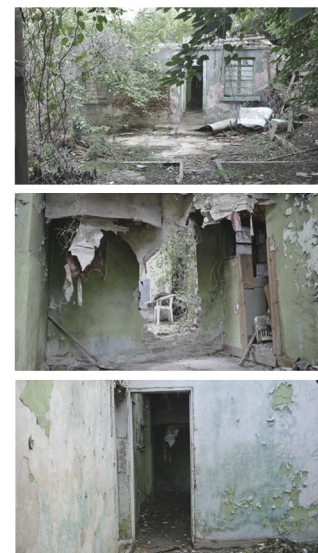

Material waste found in the stream area



The 'mosaic' possibilities

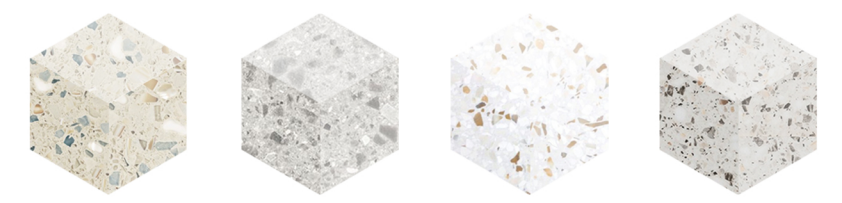

Application on paving, routes, sitting equipment

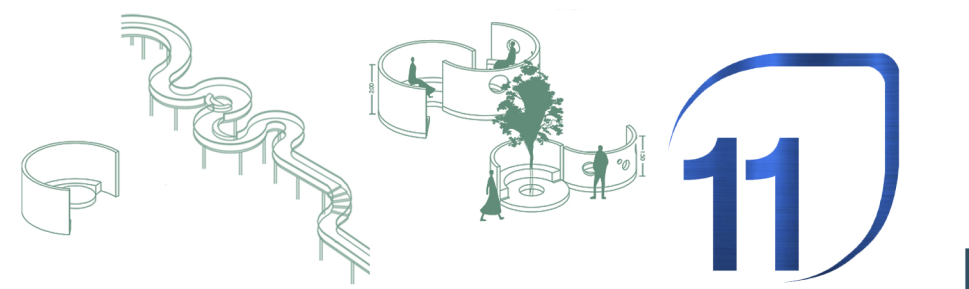



①

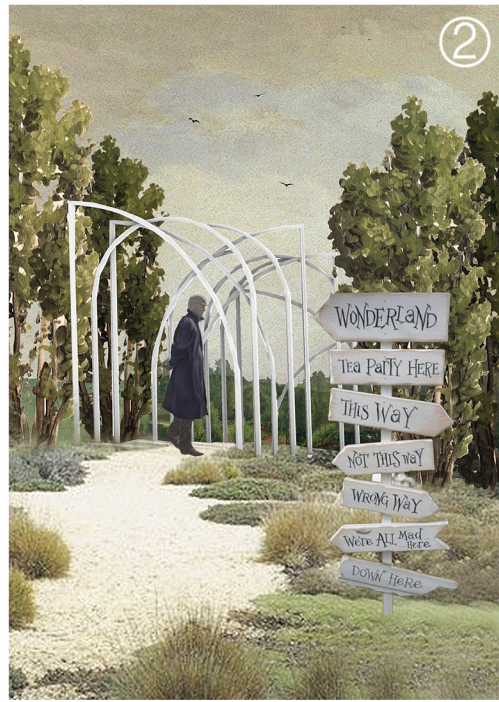

②

◀ metallic structure

The 'mosaic'
A materiality composed
by the recycling process



③



④



⑤

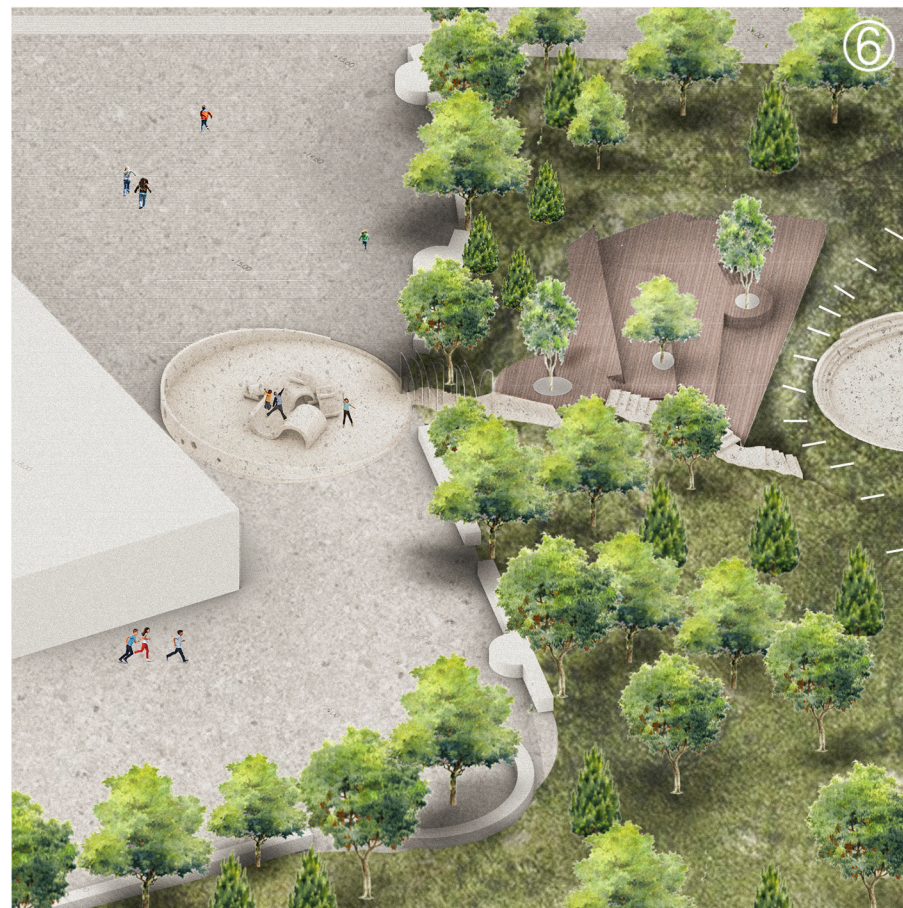

⑥

