



Country / City

Chile , Valparaiso

University / School

Escuela de Arquitectura , Universidad de Valparaiso

Academic year

2019

Title of the project

Plateaux of the bridge, theater and wetland observatory

Authors

Danilo Reyes, Alejandro Olivares, Paulina Duarte, Pablo Cantillana



## TECHNICAL DOSSIER

Title of the project ..... Plateaux of the bridge, theater and wetland observatory  
Authors ..... Danilo Reyes, Alejandro Olivares, Paulina Duarte, Pablo Cantillana  
Title of the course ..... Integrated Workshop: City and public space  
Academic year ..... 2019  
Teaching Staff ..... Osvalvo Bizama, Romina Araya, Nicolas Araya  
Department/Section/Program of belonging .....  
University/School ..... Escuela de Arquitectura, Universidad de Valparaíso



The Observatory Theater is conceived as an elevated platform, inspired by the morphology of the wetland contained between high plateaus that give it its height of contemplation.

The disused railway bridge provides a coordinate to approach from the town, extending parallel to the beach and recognizing a portion of the landscape between the river and the sea. This bridge is strategically used as the access to the theater, in this way the construction rises as a frame that embraces the existing structure, and perches slightly on the wetland.

The project is developed structurally as a grid pattern, which supports a main platform and a surrounding route that connects the different levels of the building from the bridge. The weft is made up of pieces of wood configured to distribute the efforts to perch only in four basal points.

As an installation in the landscape, an open and flexible use is proposed, giving rise to artistic and social activities, as well as an observatory instance, leading to a safe approach to the wetland. Reconciling the urban landscape and the natural landscape.



# CLIMATE CHANGE AGAIN

11th International Biennial Landscape Barcelona

For further information  
Máster d'Arquitectura del Paisatge -DUOT - UPC

T: + 34 93 401 64 11 / +34 93 552 0842  
Contact via email at: [biennal.paisatge@upc.edu](mailto:biennal.paisatge@upc.edu)

Máster d'Arquitectura del Paisatge -DUOT - UPC  
ETSAB- Escola Tècnica Superior  
d'Arquitectura de Barcelona  
Avenida Diagonal, 649 piso 5  
08028 Barcelona-Spain

Barcelona September 2020  
SCHOOL PRIZE

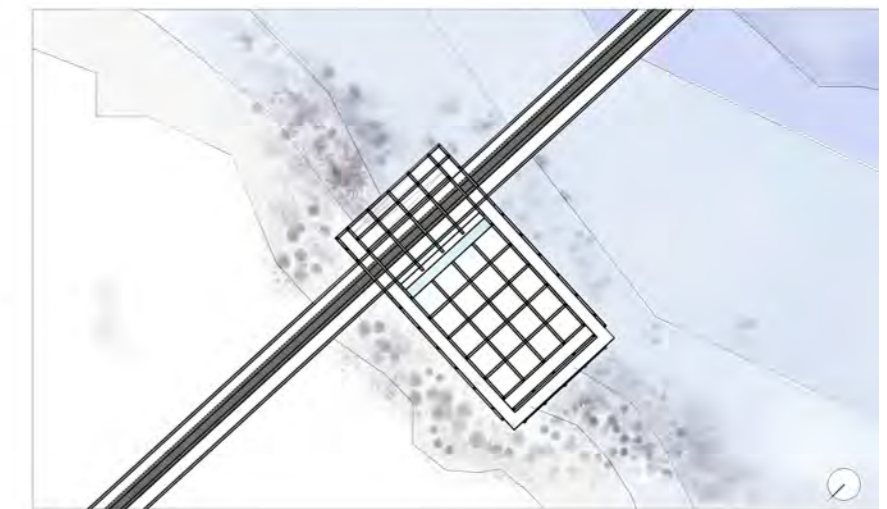
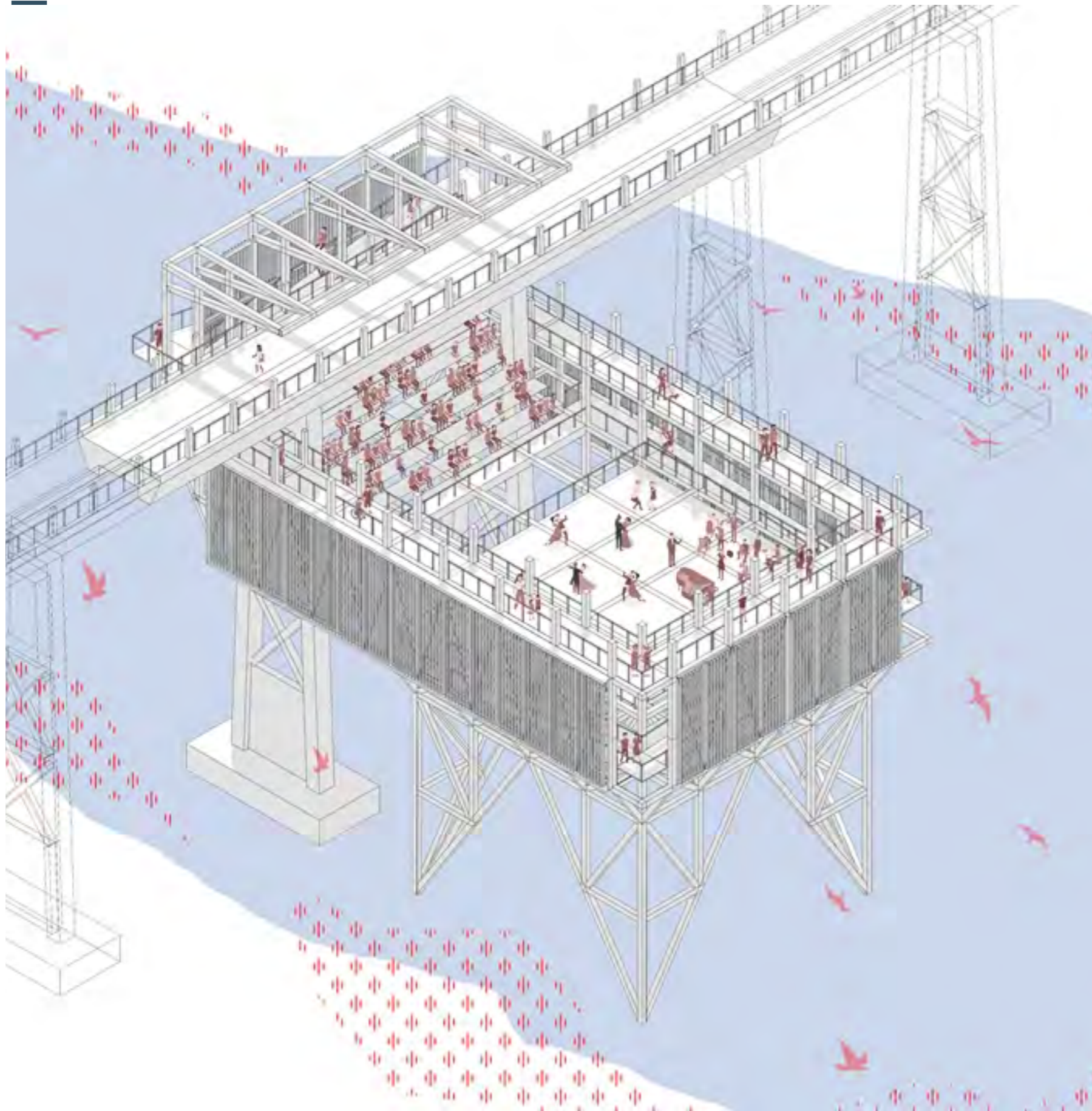

Located in the town of Pichidangui, at the mouth of the Quilimarí river, the project is conceived as an open theater, an installation in the landscape that highlights the natural virtues and the existing urban and historical elements, creating an instance of contemplation that poses on the river and faces the sea.

Its form is born, in the first instance, from a reflection on the essential character of the theater, which we understand as: the place to contemplate the play. Idea that in our project extends as: place of contemplation of the work in the landscape. Secondly, an exercise in observing the place ends up shaping the image of the theater, which is why it is presented as a raised platform like a plateau, inspired by the morphology of the wetland, which is presented encased by high plateaus and which they endow the project with its scale and height of contemplation.

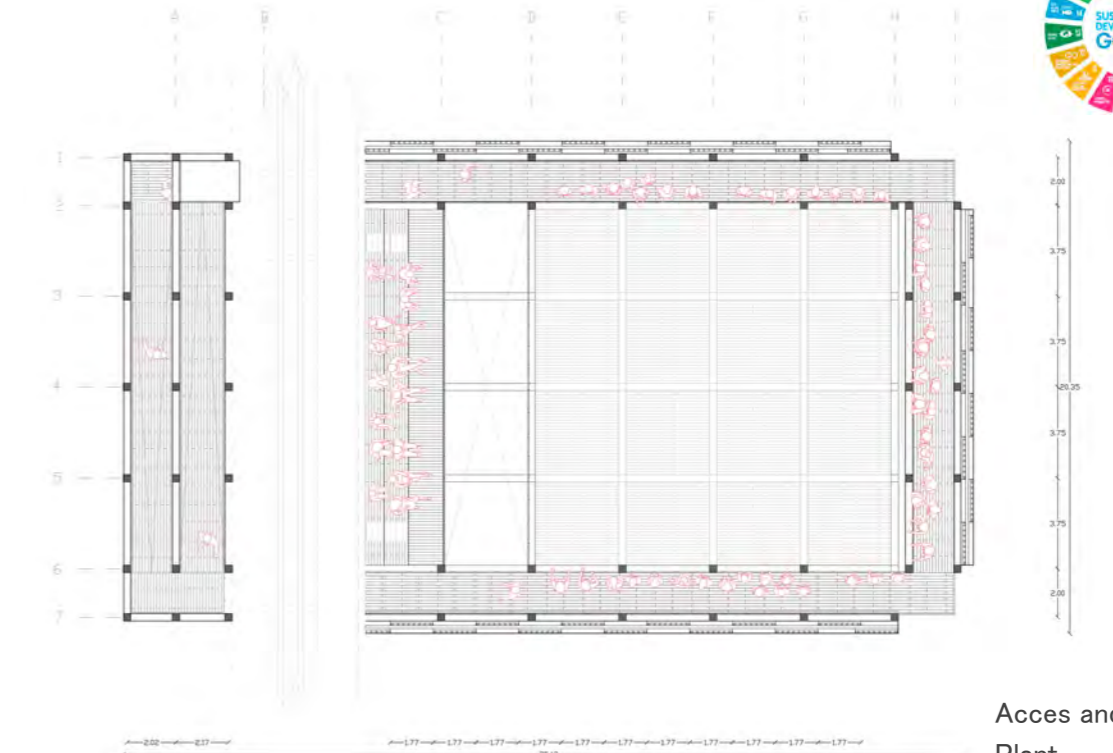
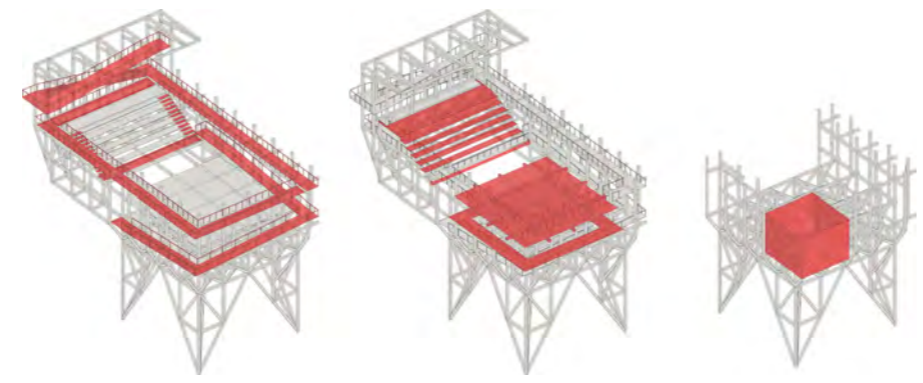
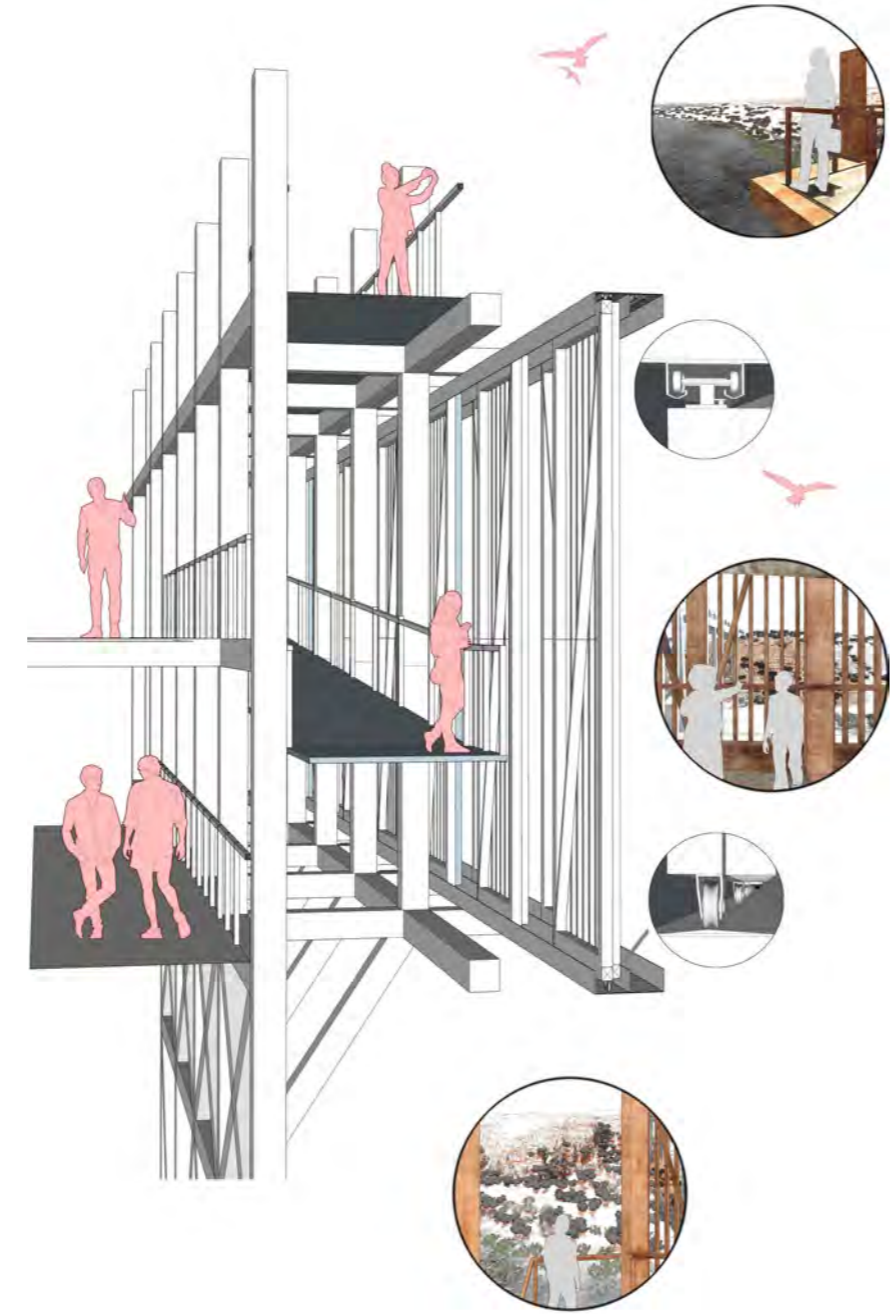
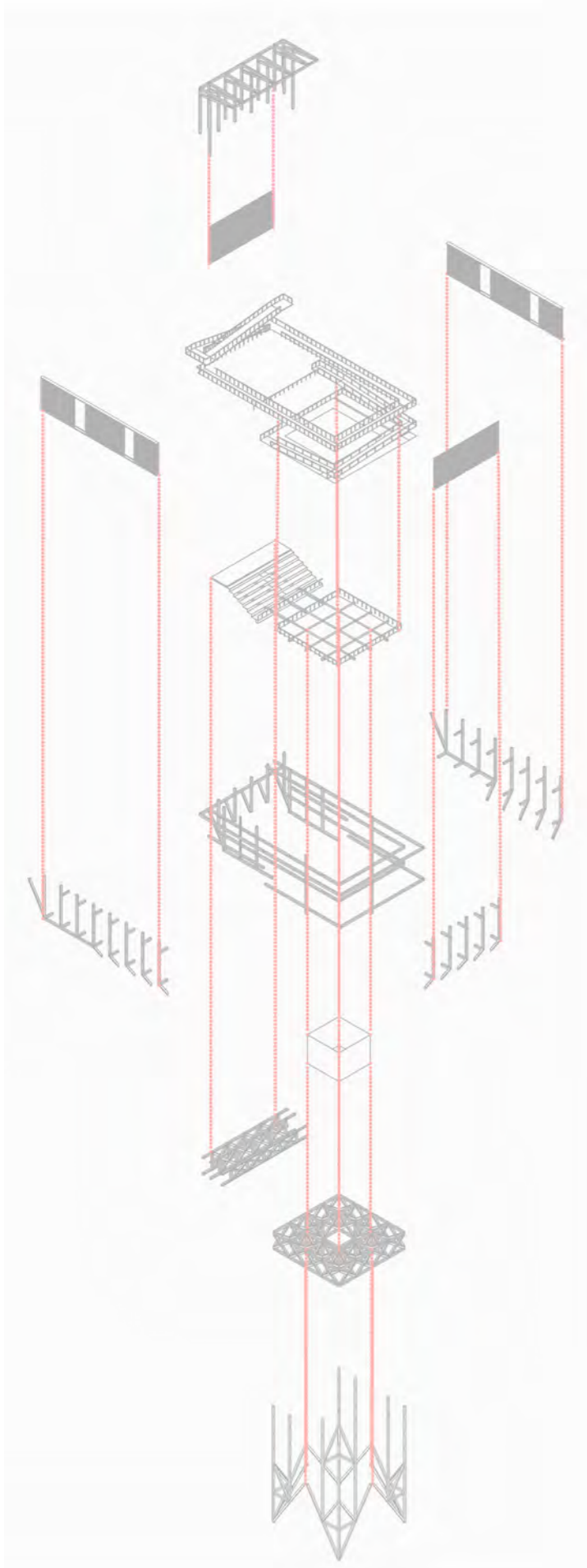

Access and grandstand Plant

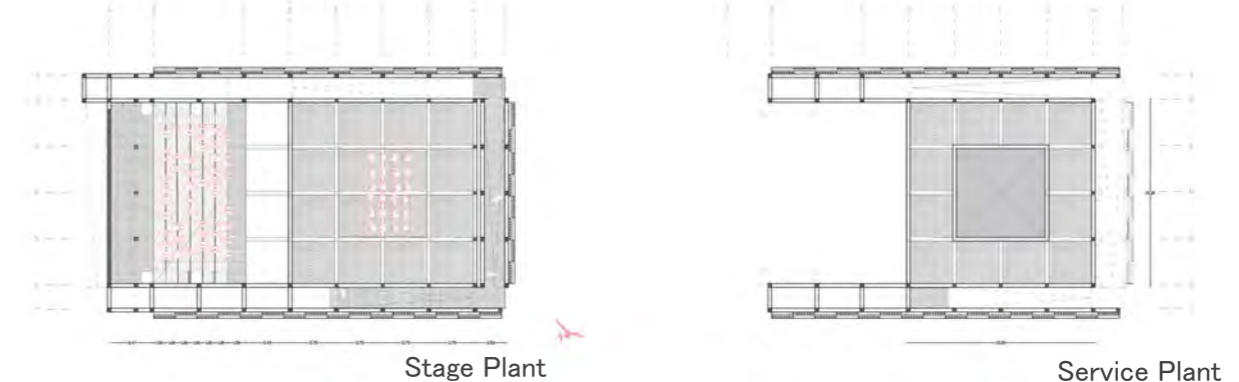

Stage Plant

Service Plant

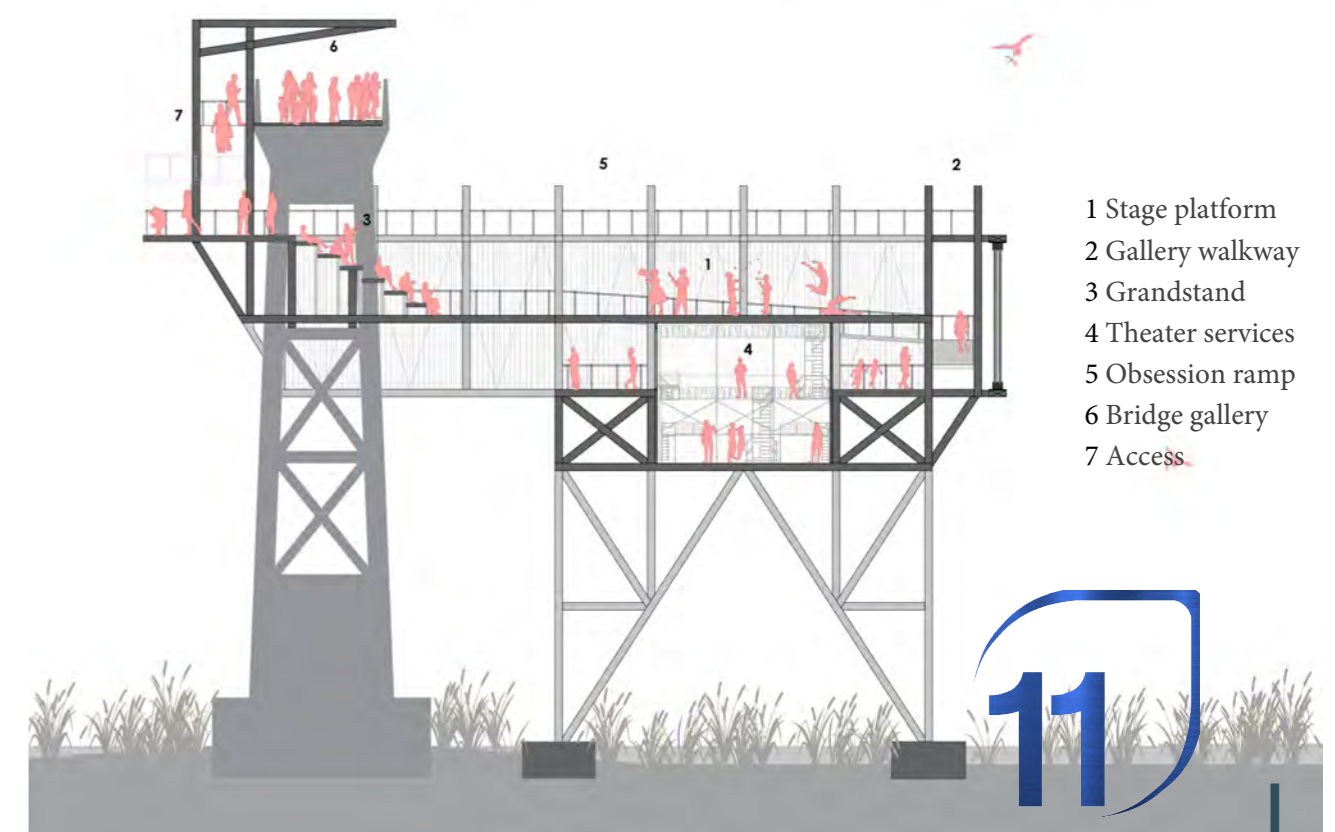

- 1 Stage platform
- 2 Gallery walkway
- 3 Grandstand
- 4 Theater services
- 5 Obsession ramp
- 6 Bridge gallery
- 7 Access

