

AMALGAM. A NEW STORY AMALGAMI. FOR THE BORDER

CROSS BORDER LANDSCAPE AT SLOVAKIA, AUSTRIA AND HUNGARY



CONTEXT



- legend
- Danube river
 - Iron curtain trail
 - Atlantic black sea trail
 - Carpathian Mountains
 - future european green belt
 - major cities

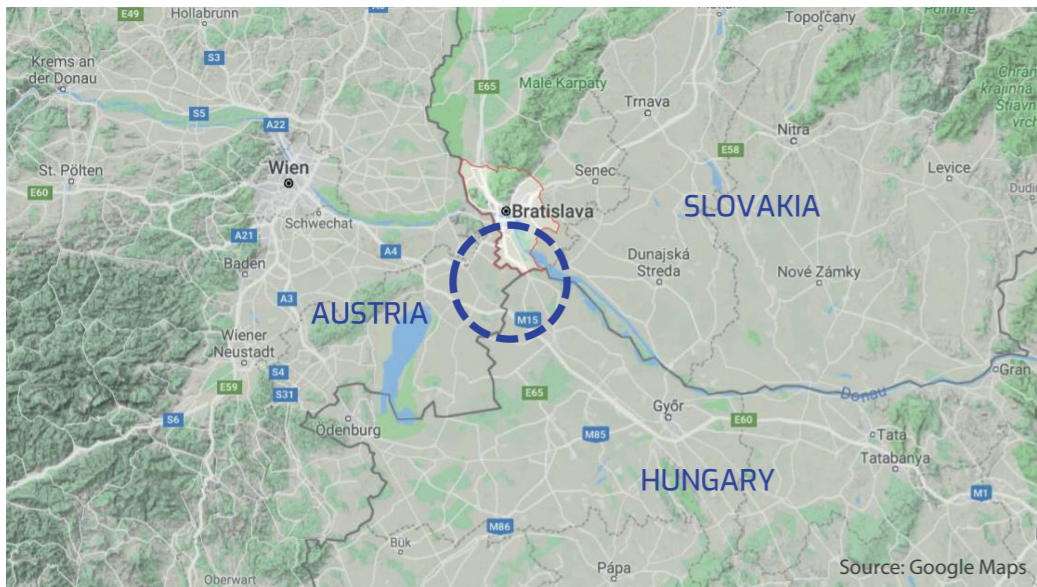

Country / City Germany / Freising-Weihenstephan
 University / School Weihenstephan.Triesdorf University of Applied Sciences / Department of Landscape Architecture
 Academic year 2019/2020 (winter term)
 Title of the project Cross-Border Landscapes between Slovakia, Austria and Hungary (LE:NOTRE Student Competition)
 Authors Chiara Loffredi, Foyal Md. Karim, Ho Ching Leung, Shaurav Paul

TECHNICAL DOSSIER

Title of the project	Cross-Border Landscapes between Slovakia, Austria and Hungary (LE:NOTRE Student Competition)
Authors	Chiara Loffredi, Foysal Md. Karim, Ho Ching Leung, Shaurav Paul
Title of the course	Main Project II (the Cross Border Landscapes project was one of two possible tasks students could choose between)
Academic year	2019/2020 (winter term)
Teaching Staff	Prof. Ingrid Schegk, Prof. Birgit Schmidt, Prof. Karl-Heinz Einberger, Stefanie Gruber
Departm./Program	Department of Landscape Architecture / Master programme 'IMLA' (International Master of Landscape Architecture)
University/School	Weihenstephan.Triesdorf University of Applied Sciences, in cooperation with Nürtingen-Geislingen University of Applied Sciences



The project dealt with the task of the International Student Competition of the LE:NOTRE Institute in advance to the Landscape Forum Bratislava 2020. Students were asked to develop new visions and ideas for the future development of the trinational urban landscape of Bratislava covering Slovak, Hungarian and Austrian territories. A particular focus was on the Bratislava metropolitan area on the Slovak side of the border, small rural settlements on the Austrian side of the border and the Three Countries Point where the borderlines between Slovakia, Austria and Hungary intersect.

The existing landscape along the former Iron Curtain represents problems and challenges of the specific periurban landscape situation, where the dynamics of urban development of the growing Slovak capital Bratislava meet the international border and affect the surrounding rural municipalities and rural agricultural landscapes.

Based on a detailed analysis the authors of the project 'AMALGAM: A new Story for the Border' developed a concept which includes the main driving forces in this border landscape: urban growth, tourism, history, culture, agriculture and ecology. The landscape was interpreted as a kind of mosaic and used to develop a new pattern which connects people, places and identities - of course crossing the border.

The idea of 'Amalgam' functions as a glue: a new system of paths reconnects the mosaic patches and tells a new story of the historical landscape.

This approach is not only applied in the Masterplan but in the two focus areas as well: with a green landscape corridor between Petrzalka (Slovakia) and Kittsee (Austria)' and a cultural plaza which represents the concept also formally at the Three Countries Point.

For further information
Máster d'Arquitectura del Paisatge -DUOT - UPC

T: + 34 93 401 64 11 / +34 93 552 0842
Contact via email at: biennal.paisatge@upc.edu

Máster d'Arquitectura del Paisatge -DUOT - UPC
ETSAB- Escola Tècnica Superior
d'Arquitectura de Barcelona
Avenida Diagonal, 649 piso 5
08028 Barcelona-Spain



CLIMATE CHANGE AGAIN

11th International Biennial Landscape Barcelona

Barcelona September 2020
SCHOOL PRIZE

URBAN GROWTH AND CONNECTIVITY

urban sprawl and population pressure

Petržalka and its surrounding towns expanded in relation to population growth. In particular, Kittsee population almost doubled in the past 20 years. This poses pressure to urban expansion and the proposed expansion of Petržalka further to the south is mapped based on the future zoning plan of Bratislava.

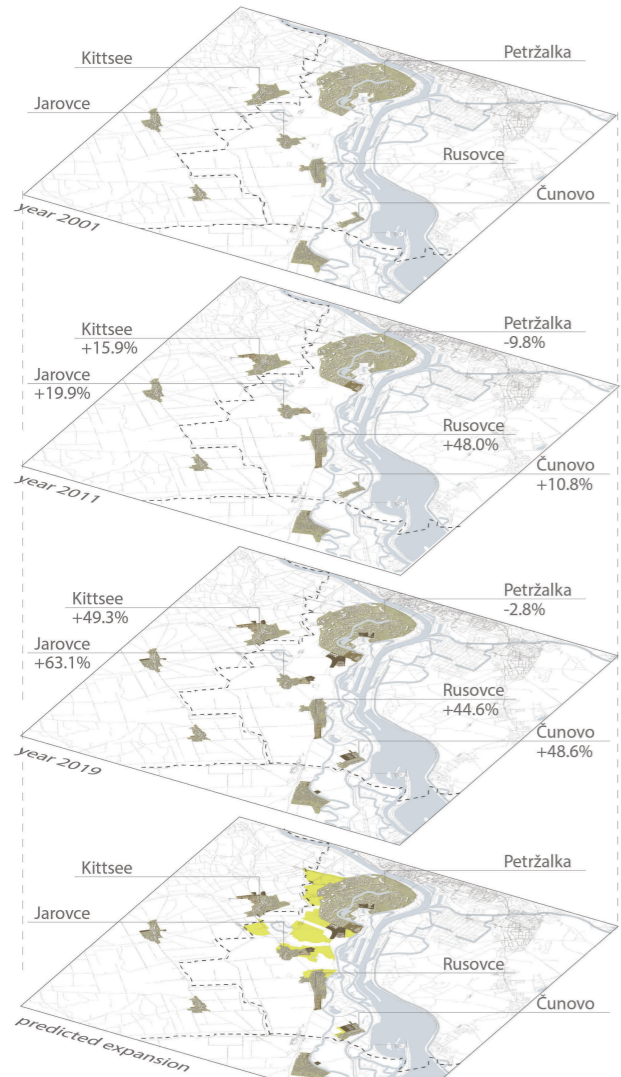

INSIGHT FROM SITE ANALYSIS

Difference in perception of landscape

The border plays an important role in the landscape. The fall of Iron Curtain symbolises the demolition of physical border between the three countries. But interestingly, the border still functions emotionally and invisibly, segregating the landscapes and different communities and identities.



From the eyes of local communities:
Border as a routine

Communities nearby the border commute daily across the border to work and back home. Travelling across the border becomes a routine, regardless of their identities defined by the border.



From the eyes of tourists and visitors:
Border as a limit

Despite of the abundant attractions in Austria across the border, Bratislava and its surrounding landscapes remains to dominate the majority of visitors, and that the border is a physical limit to tourists' destinations.



From the eyes of ecological & protected species:
Border as an opportunity

With the favourable environmental and geographical conditions of the border area, the border functions as an important habitat for the migration and breeding of protected species.

CONCEPT DEVELOPMENT

Connecting people and landscape

Considering each town and attraction as a single and isolated patch, the idea of 'amalgam' functions as glue to fill in the gap between each patch. Through establishment of both visual, emotional and physical connections, the aim of the masterplan is to connect people, place and identity.

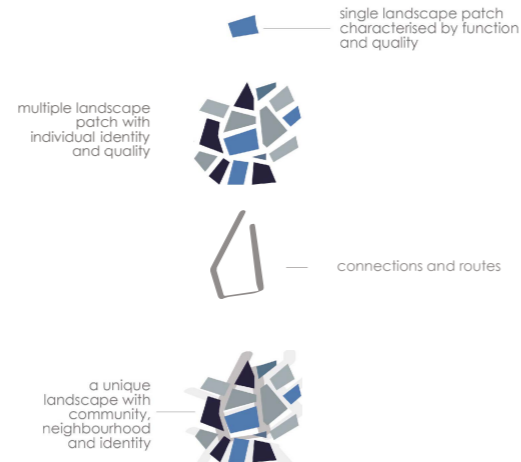

ECOLOGY AND AGRICULTURE

Protected areas and agricultural significance

Areas adjacent to the border functions as important bird area with favourable factors for breeding and migration of rare bird species. In terms of agriculture, the long history and culturally significant agricultural orchard also takes up an important role in the development of Kittsee.

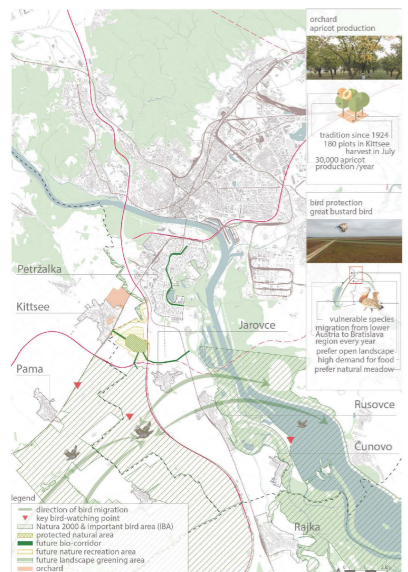

HISTORY AND CULTURE

A journey through time - mapping the historical nodes

Important historical nodes along the border reflected a change in history and context of the area in both socio-cultural and natural aspects. The border history along the border serves a significant role in shaping the identity of the landscape.

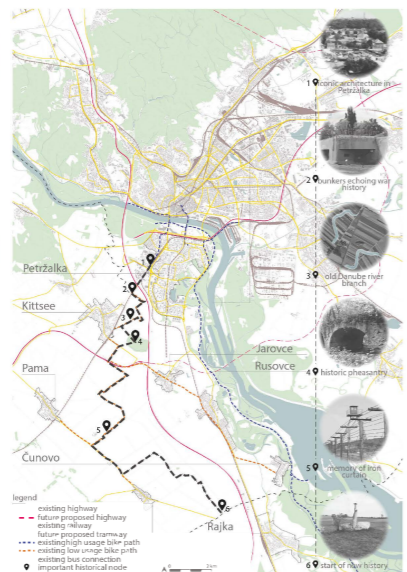

TOURISM

Point of interests and connectivity

Historic, cultural and leisure attractions are mapped, along with existing connection and transportation network. While majority of tourists concentrate in Bratislava and Danube riverfront, there is high potential to connect attractions in border area and create a new tourist sightseeing routes.

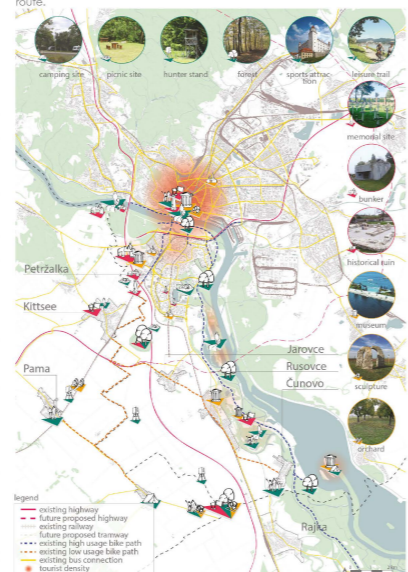



A WALK THROUGH HISTORY

FOCUS AREA 1: KITTSEE-PETRŽALKA LANDSCAPE CORRIDOR

CREATION OF THE LANDSCAPE CORRIDOR

The functional landscape

- 1 **Memorial park**
To integrate tranquility of landscape with strong emotional and historical ruins of bunkers
- 2 **Wetland zone**
Creation of narrow and subtle natural channel for rain water collection in old river branch of Danube, as a way to echo the symbolism of historical change in landscape and to enhance ecological value of site area
- 3 **Agriculture zone**
Preserve and advocate organic farming, with areas designated as farmers' markets
- 4 **Community zone**
Mix of open and shaded seating and communal space with view overlooking agricultural fields
- 5 **Fitness zone**
Designated for community and fitness space with view overlooking agricultural fields
- 6 **Open park**
Creation of paths in existing orchard area, also function as communal space and orchard experiencing area



Goals of the landscape corridor development include:

1. remembrance of history and celebrate culture - development of memorial park to protect and promote historical ruins, and agriculture zone to promote iconic orchard production in Kittsee.
2. improvement in quality of open space for better community health - development of community zone, open park and fitness zone to create high quality open space for communal use.
3. restriction of unnecessary or ambitious residential expansion - parts of the future residential development areas are proposed to be shifted from Petržalka to Kittsee in reference to the population growth statistics.
4. development of green axis to enhance biodiversity and ecological qualities - green axis in Petržalka will be linked by the proposed landscape corridor, and further down to south of Petržalka with the recreation of subtle wetland.

7 **Remembering iron curtain : memorial park in bunker area**
Landscape design of the memorial park inspired by rigidity of Slovak. With proposed memorial museum and existing bunkers integrated into the geometrically shaped landscape, one can experience the tranquility and historical sentiment in the memorial park.

8 **Magnifying culture : incorporation of leisure and relaxation to orchard fields**
Apricot orchard cultivation has been a long history in Kittsee. The design of the area aims to create paths in existing orchard fields for better experience of the culture, together with the incorporation of open seating space to experience the distinct quality of landscape.

9 **Reactivating history : recreating subtle streams in old Danube river branch**
The old Danube river branch which now functions as agricultural fields is a demonstration of history in the border area. The recreation of streams not only brings back the history to the community, but also functions as ecological hub in the site area.

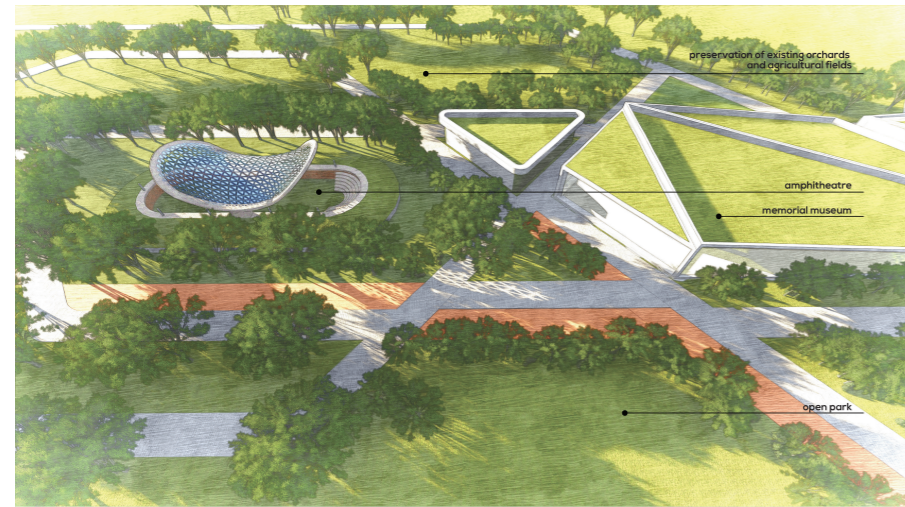

CHAPTER OF CULTURAL AMALGAM

FOCUS AREA 2: THREE COUNTRIES POINT

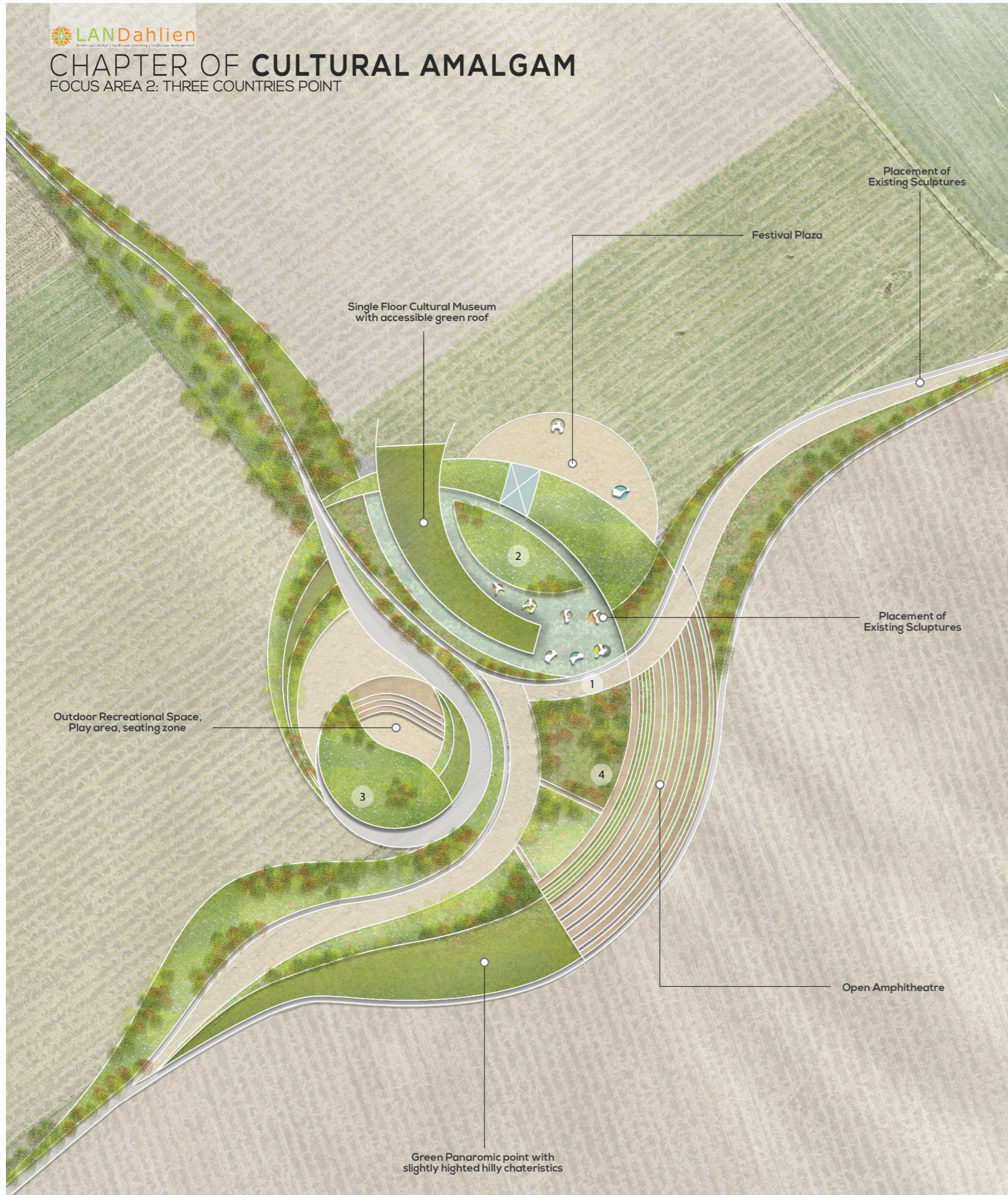

The primary idea about the 3 countries point was making an amalgam of three countries culture and heritage. The bike path & pedestrian coming from 3 borders will pass into the 3 countries point. The mixing and union of 3 different cultural patterns will mix in a single point. The fluid graphics of the 3 country point came from the fluidity of nature and landscape. The whole area will consist of a cultural museum, festival plaza, sculpture point for existing respected sculptures, recreational plaza and open amphitheatre. People can come here by public bus, private car or by cycling. The proposed bus route will have a stoppage there, where people can get on or off from the bus, the car holder can park their car and the cyclist can park their bike or rent a new one.

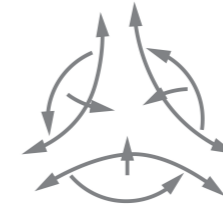

Free-flowing pathway along the 3 borders point and integrating surroundings into the site

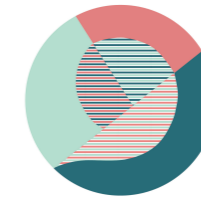

The intermix of 3 types of culture and pattern. Holding the pattern of other 2 types to uphold the intercultural heritage and diversity

Respecting the Existence: Cultural Museum with Sculpture Plaza

1 Preserving the existing sculptures to keep the memory of 3 countries point and a semi-open cultural museum, which will have an accessible green roof. The museum will create an elevation of accessibility, not any obstacle or utopian object.



2 Festival Plaza: Shared space for multicultural festival and activity
The festival plaza, containing the cultural museum, existing sculptures and a huge open green pavilion, which will hold a different kind of festival from the border sharing three countries.

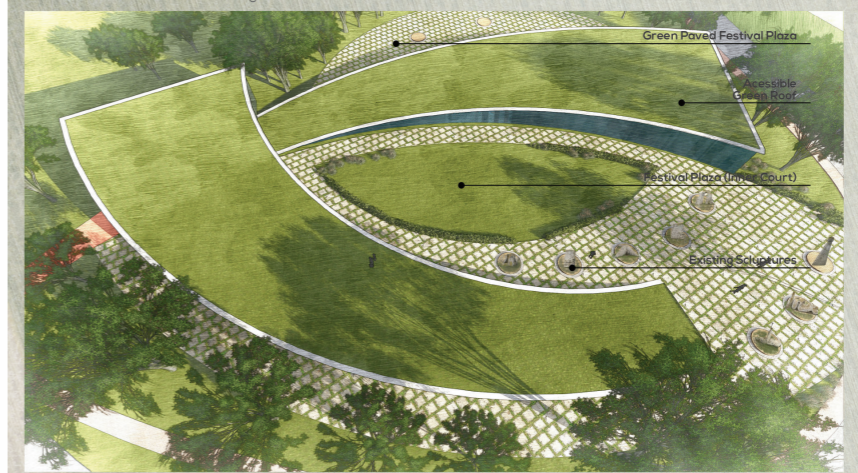

3 Recreational Deck: A place to breathe, play and talk
An open play area for children and also all aged of people, where people can sit, do a small family picnic, talk with each other and pass their leisure time with a view of 3 different landscape pattern.

