

Country / City

University / School

Academic year

Title of the project

Authors

Canada / Calgary

University of Calgary / School of Architecture, Planning and Landscape

2018-2019

Transitioning. Streetcar Reminiscence Plaza

Thu Ngo



TECHNICAL DOSSIER

Title of the project	Transitioning. Streetcar Reminiscence Plaza
Authors	Thu Ngo
Title of the course	Landscape Architecture Studio II
Academic year	2018-2019
Teaching Staff	Enrica Dall'Ara
Department/Section/Program of belonging	Master in Landscape Architecture
University/School	University of Calgary / School of Architecture, Planning and Landscape



Written statement, short description of the project in English, no more than 250 words

It was a big day in Calgary on July 5, 1909 when the first streetcars rolled along the city's thoroughfares. For the next thirty-seven years, streetcars snaked across Calgary, linked neighbourhoods and connected citizens. After their retirement in 1946, the tracks they left behind have still been parts of the urban systems as pieces of residual lands. And since they have no name, no custodian, they are left to waste or eliminated in endless cycles of urban renewal. What if we could revitalize these voids in the urban fabric? How might many small spaces, functioning as discrete elements but acting together, trigger a systemic change for a more livable community?

Inglewood is a neighbourhood in central Calgary since 1911 and this historical neighbourhood has managed to keep its charms for over a century. The streetcars running along its main street was the recipe for creating this vibrant community with appeal. A strategic site is a residual space adjacent to Inglewood's main street, where the streetcars crossed by. Complex flows and intersections have caused this space less spatially defined. For a long time, it has functioned or dysfunctioned informally with no assistance or attention. The space is now poised for a transition to reinforce the continuity of the regional pathway system. This project finds a way to evoke memories of this derelict space by celebrating the flows of people, energy, and connectivity, reminiscing strong and continuous movements as once the streetcars used to carry people across Calgary's cherished Inglewood.

For further information

Máster d'Arquitectura del Paisatge -DUOT - UPC

T: + 34 93 401 64 11 / +34 93 552 0842

Contact via email at: biennal.paisatge@upc.edu

Máster d'Arquitectura del Paisatge -DUOT - UPC

ETSAB- Escola Tècnica Superior
d'Arquitectura de Barcelona

Avenida Diagonal, 649 piso 5
08028 Barcelona-Spain



CLIMATE CHANGE AGAIN

11th International Biennial Landscape Barcelona

Barcelona September 2020

SCHOOL PRIZE

Historical Background of Calgary Streetcar Network



On July 5, 1909, passengers boarded public streetcar for the first time in Calgary's history.

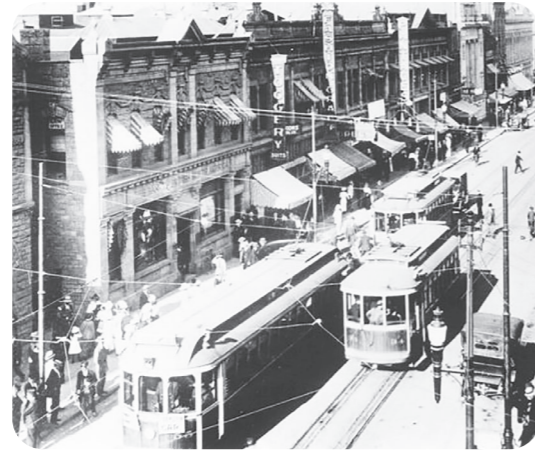

Streetcars dominated busy 8th Avenue in early Calgary.

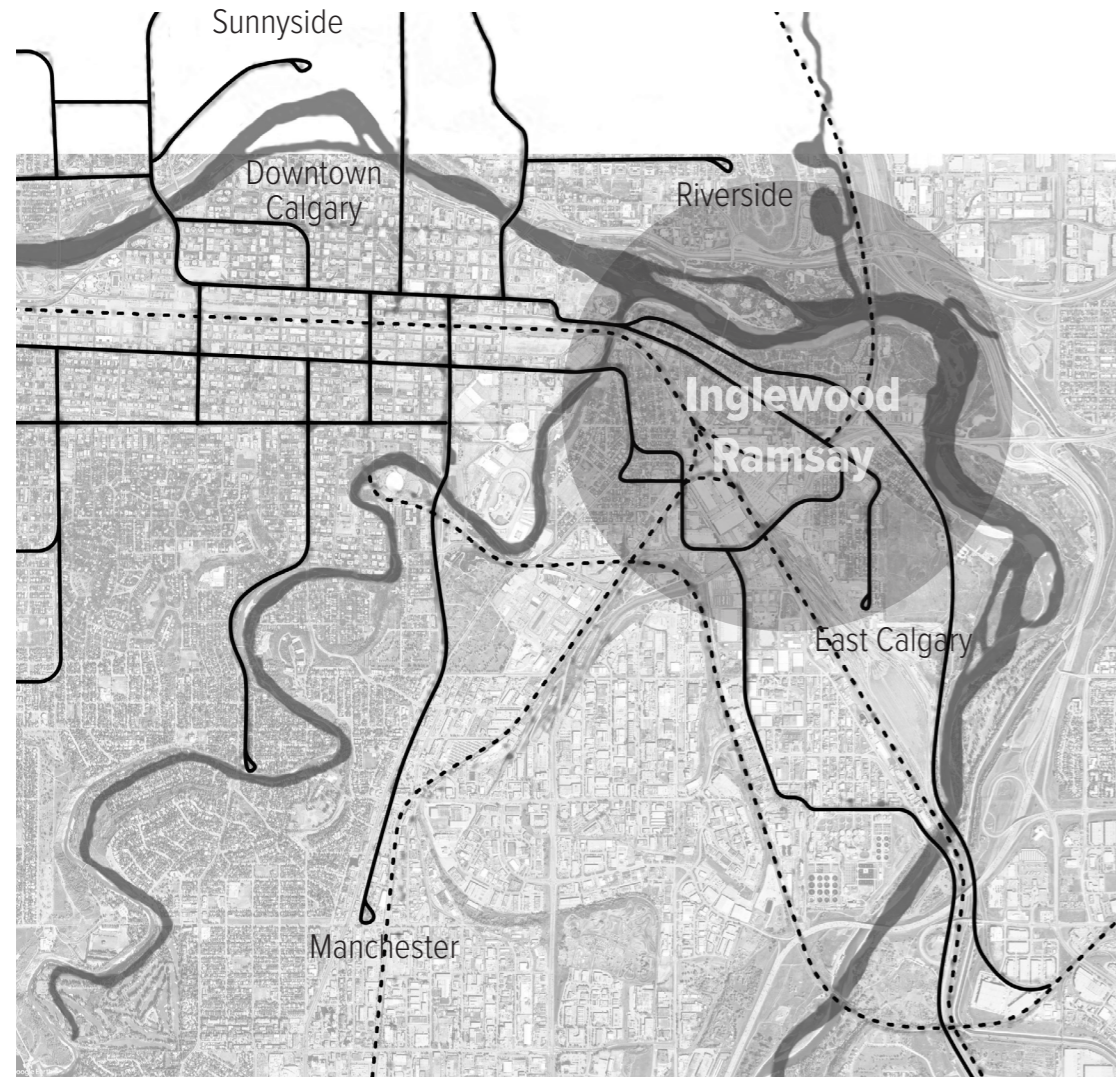

Calgary Historical Municipal Railway Network 1909 - 1946
 — Old streetcar tracks - - - - - Old and current railways

Objectives and Key Strategies



1 | Conjunctive natural environment: reactivating residual greenspaces with active uses.

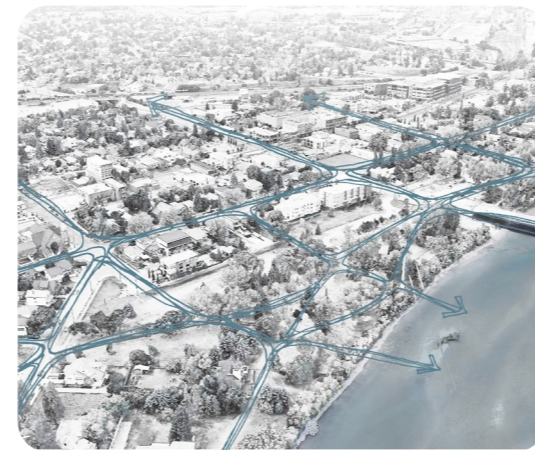

2 | Interactive waterfront: enhancing both visual and physical connections to the Bow River.



3 | Reinforced cultural identity: connecting and highlighting historical resources throughout the community.



View from riverside greenspace looking towards Inglewood historical neighbourhood in Calgary's iconic winterscape.

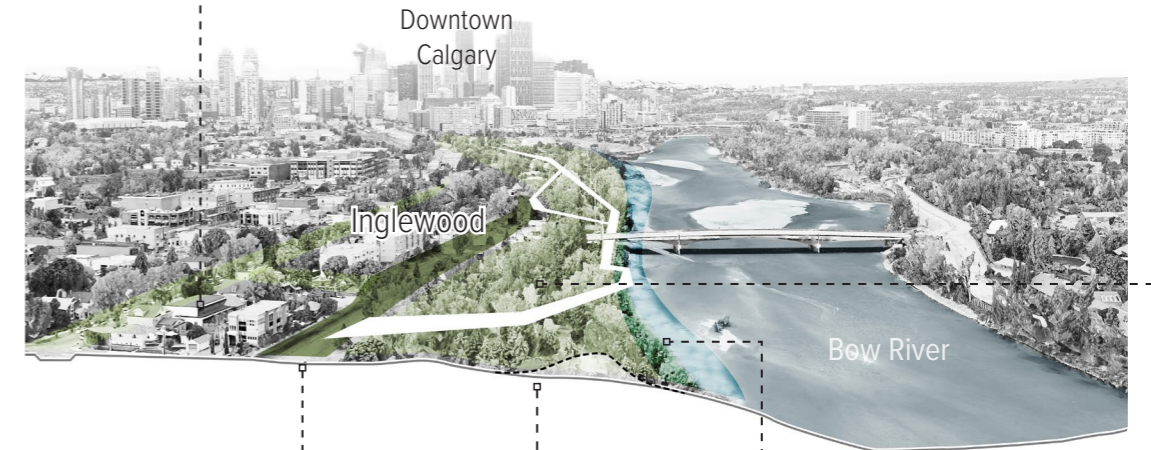

transforming underused spaces into active public greenspaces

restoring the riparian

waterfront interactive zone

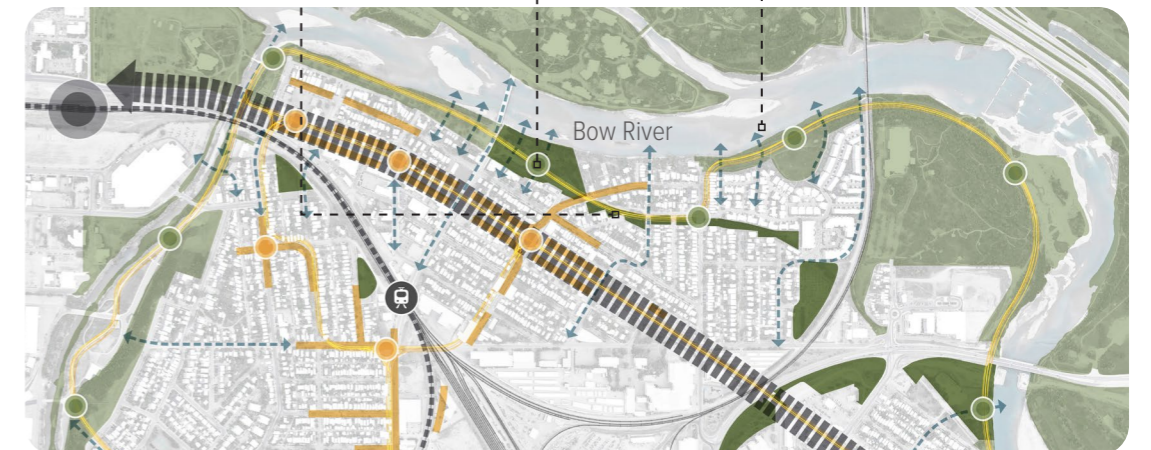

Strategic interventions

- Enhanced connection
- New gateway
- New waterfront link
- Activated greenspace
- Historical component
- Heritage loop

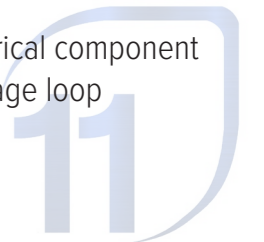

Strategic Site Selection



The trace of old streetcar track is now a part of Bow River pathway system. Most of it has become underused greenspaces. Some has been changed into different land uses like Nellie Breen playground.

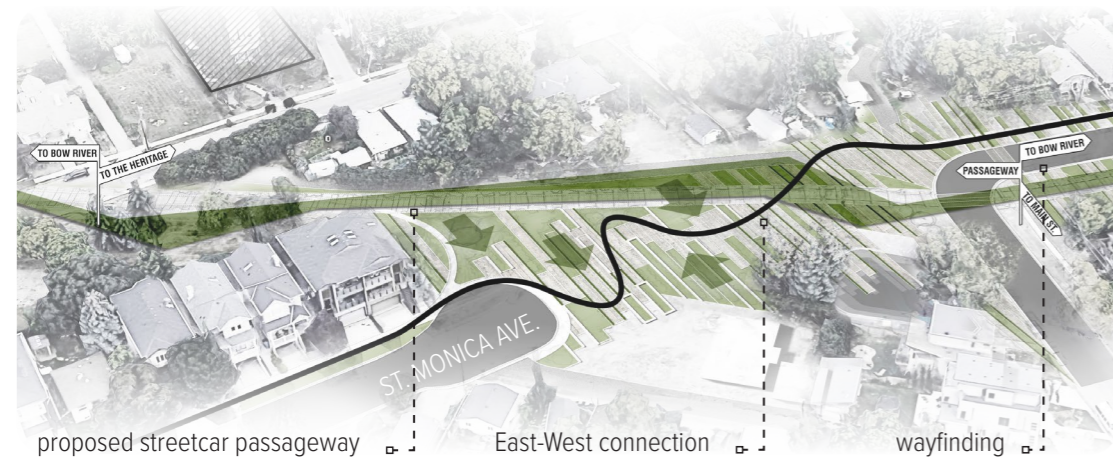

Strategic site is a land section of the residual strip of land intersecting with St. Monica Ave. The transformation of this space would reinforce the continuity of Bow River pathway.

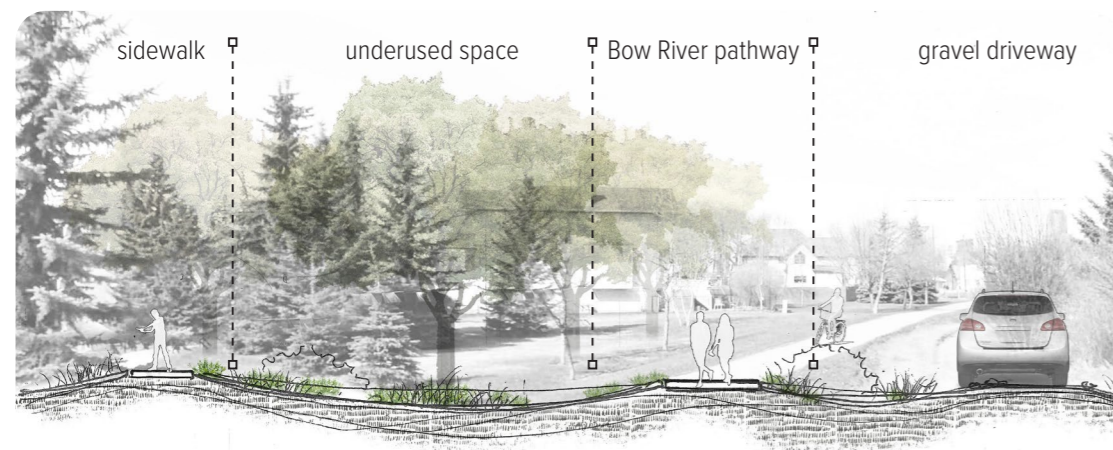

Section AA' - Underused spaces along Bow River pathway where it crosses the site

Site Current Condition



Poor spatial layout because of complex circulation.

- ▬ Catch basin
- Fence
- (A) Bench
- (B) Playground
- (C) Pathway
- (D) Large canopy

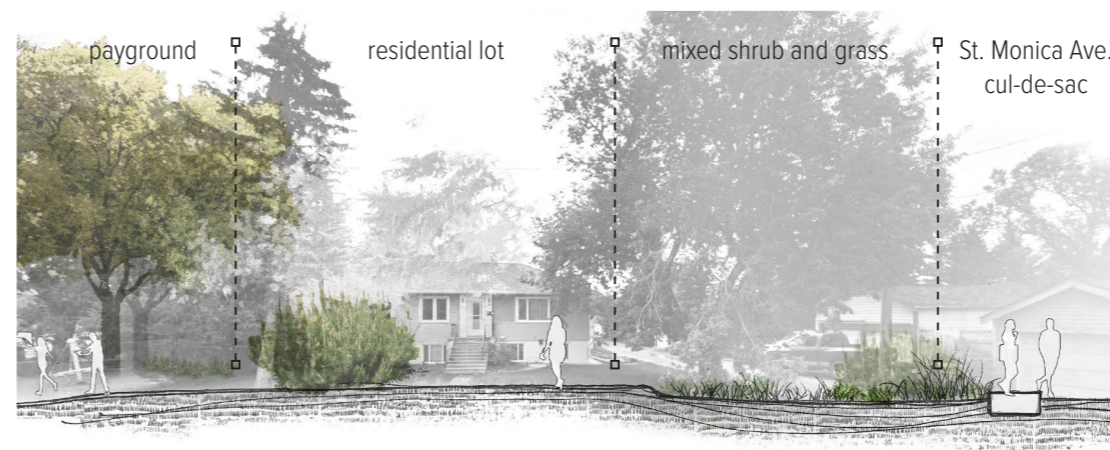

Section BB' - Uninviting East-side entrance to Nellie Breen playground

Conceptual Development

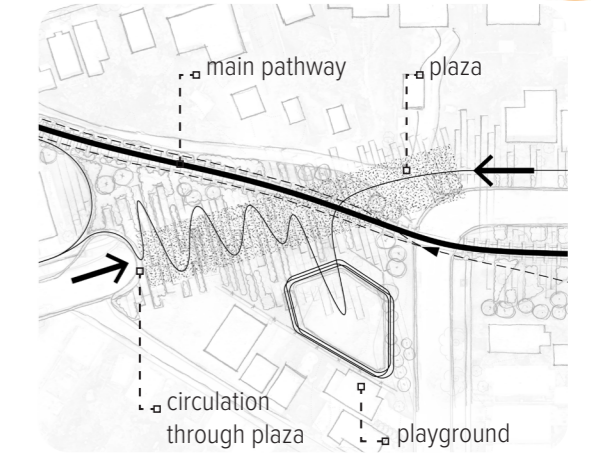

Circulation and programming: a continuous movement across the space

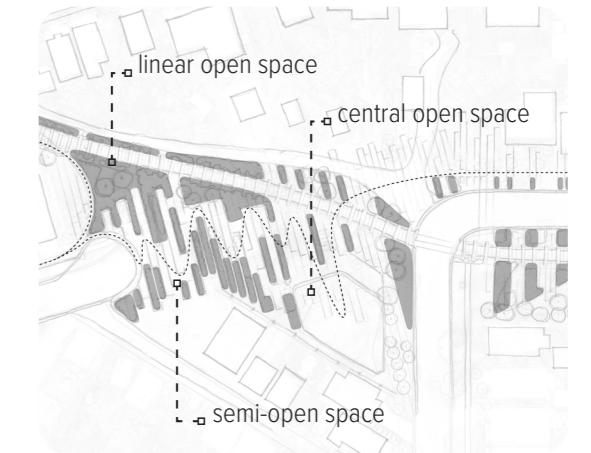

Spatial compositions



Mass and linear planting is used to create physical enclosure and direct the flows.

Design Development: Streetcar Reminiscence Plaza



Project scenerio 1: Sitting space in plaza



Project scenerio 2: Main pathway



New planting and paving material palette would enhance aesthetics and sense of place.

- ☐ Catch basin
- ☐ Bench
- Ⓐ Rain garden
- Ⓒ Playground
- ⊙ Stormwater pipeline
- Lighting
- Ⓑ Bio-swale
- Ⓓ Pathway

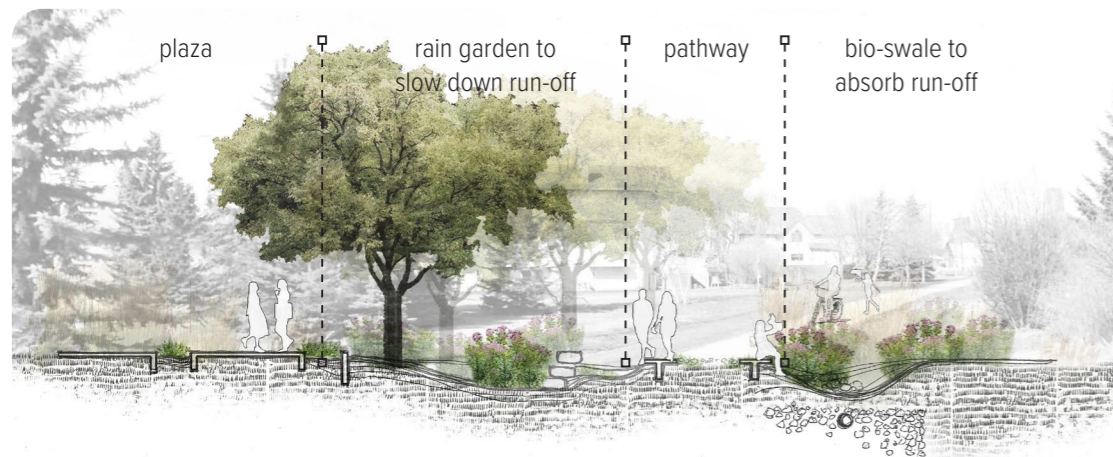

Section AA' - Proposed transformation:
Reinforcing the main pathway and re-defining edge condition



Section BB' - Proposed transformation:
Transforming empty spaces into planting terraces for ecological and aesthetic purposes

