

Country / City	United States / Cambridge
University / School	Harvard University Graduate School of Design
Academic year	Fall 2019 / Spring 2020
Title of the project	Rewilding Riverbeds
Authors	Jonathon Koewler

## TECHNICAL DOSSIER

Title of the project	Rewilding Riverbeds
Authors	Jonathon Koewler
Title of the course	Rewilding Seoul
Academic year	Spring 2020
Teaching Staff	Jungyoon Kim + Yoon-Jin Park
Department/Section/Program of belonging	Department of Landscape Architecture / MLA
University/School	Harvard University Graduate School of Design



Written statement, short description of the project in English, no more than 250 words

Ecological destruction is nothing new to the history of urbanization. Cities have always removed wilds that were considered undesirable, unproductive, or dangerous. In Seoul and Boston, urban development came at the expense of their river ecologies. In each context, expansive landscapes of sandbars and mudflats were dredged and diked to enforce a more acceptable presentation of water.

This project seeks to return these ecologies in the form of newly constructed wilds. Although they cannot return by simply removing the active measures against them, they can be reintroduced through landforming and engineering. They will not mimic their original states, rather they will become new landscapes of cultural and ecological presence. The growing impacts of climate change on these cities further complicates the motivation to 'rewild' these sites. To allow these forms to persist sustainably without constant intervention, their functions must be adapted to the more extreme contemporary conditions we face.

Although the ecologies differ between Boston and Seoul, they share similar constraints to be overcome around water-control, sediment-morphology, and the maintenance of critical organisms. Shared training structures are meant to accomplish this spectrum of goals, and then to be edited and used appropriately in each city. The training structures, along with designs to the edges of the shores, are combined to formulate the appropriate balance of defense and natural degradation that keeps these ecologies at an optimal moderation of performance. These constructions also add a new component in these rewilded-conditions: the human perception and interaction with them as valued landscapes.

For further information  
**Máster d'Arquitectura del Paisatge -DUOT - UPC**

T: + 34 93 401 64 11 / +34 93 552 0842  
Contact via email at: [biennal.paisatge@upc.edu](mailto:biennal.paisatge@upc.edu)

**Máster d'Arquitectura del Paisatge -DUOT - UPC**  
ETSAB- Escola Tècnica Superior  
d'Arquitectura de Barcelona  
Avenida Diagonal, 649 piso 5  
08028 Barcelona-Spain



# CLIMATE CHANGE AGAIN

11th International Biennial Landscape Barcelona

Barcelona September 2020  
SCHOOL PRIZE



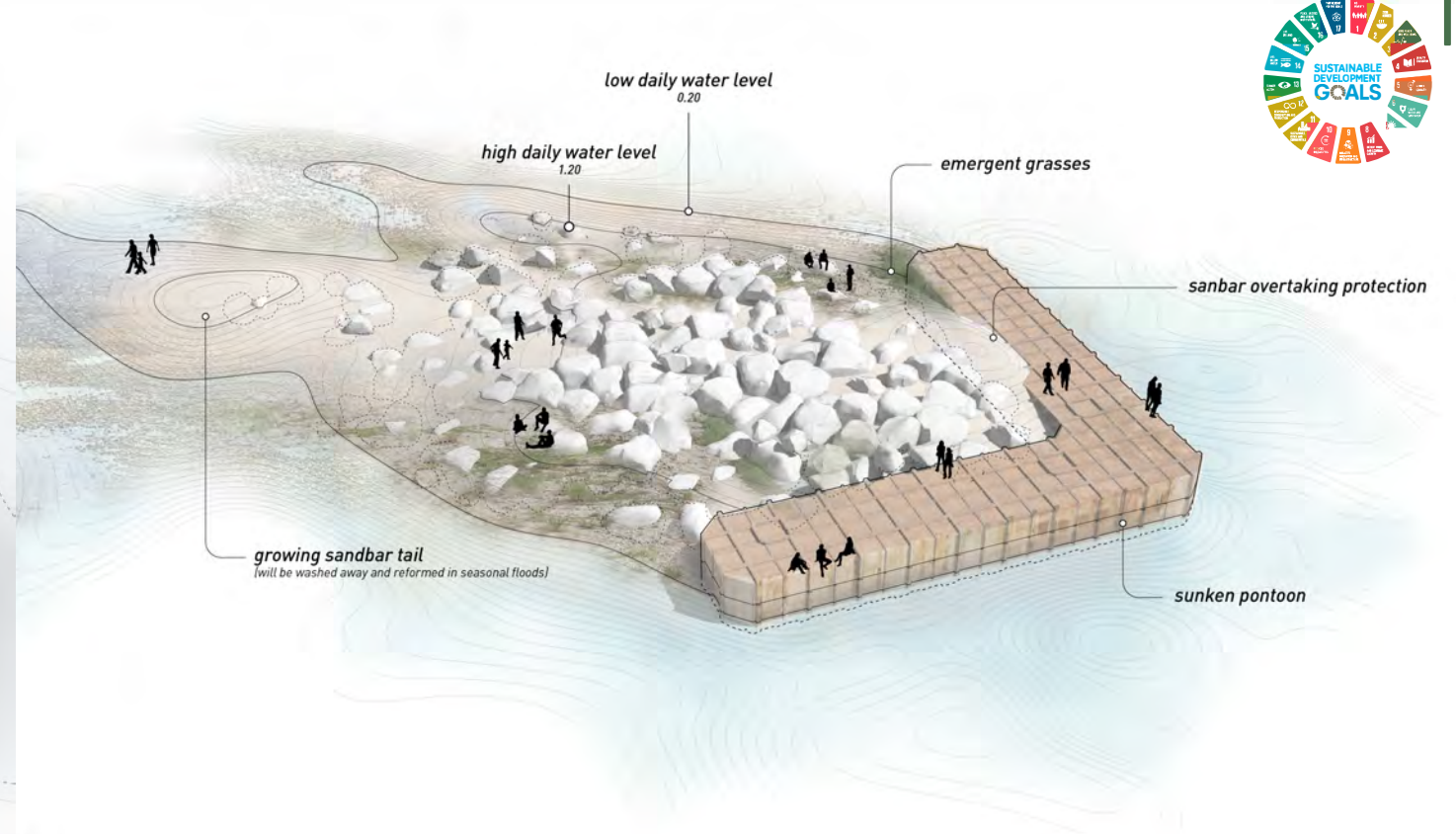
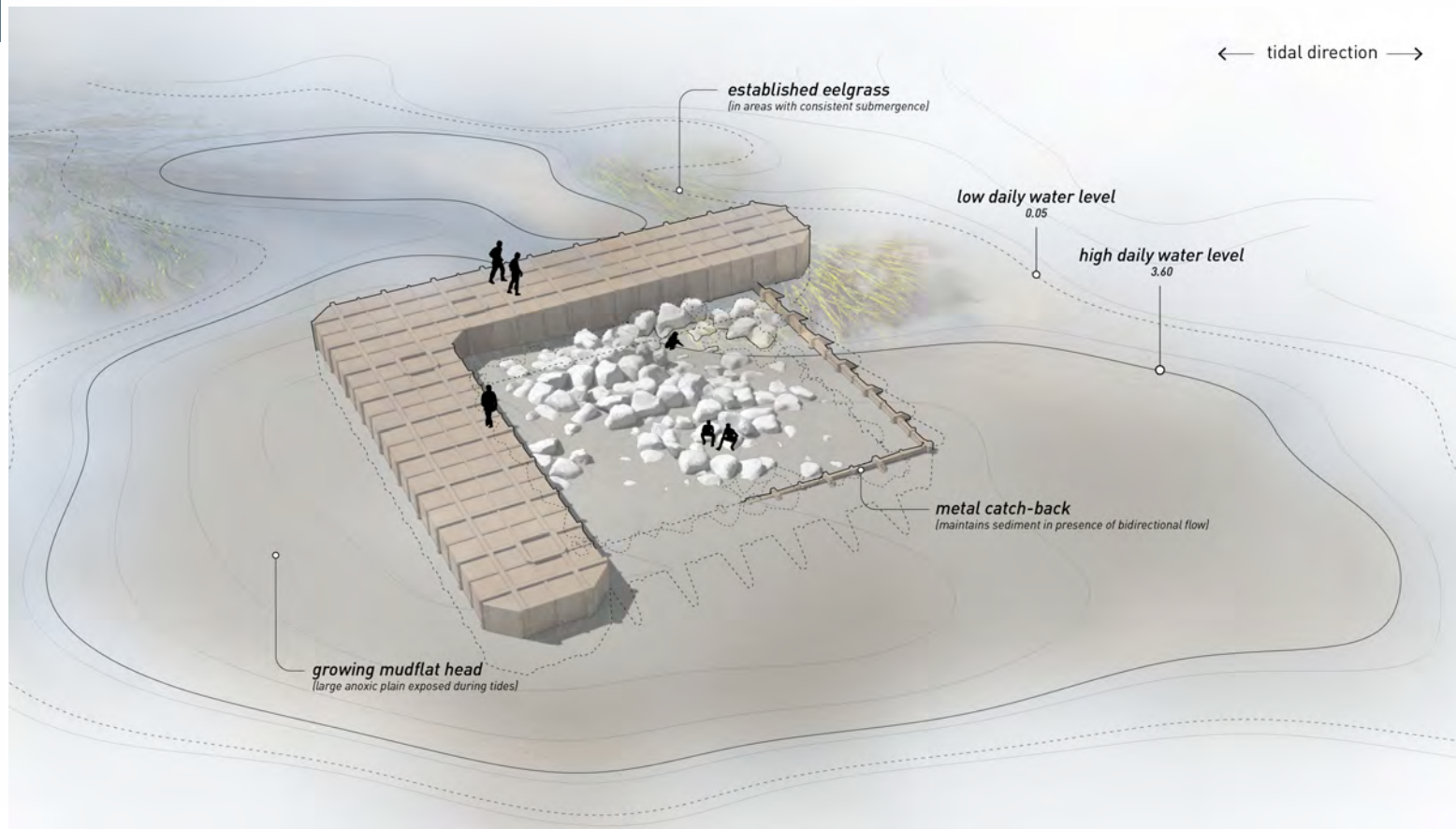

BOSTON

← tidal fluctuations - bidirectional →

← river direction

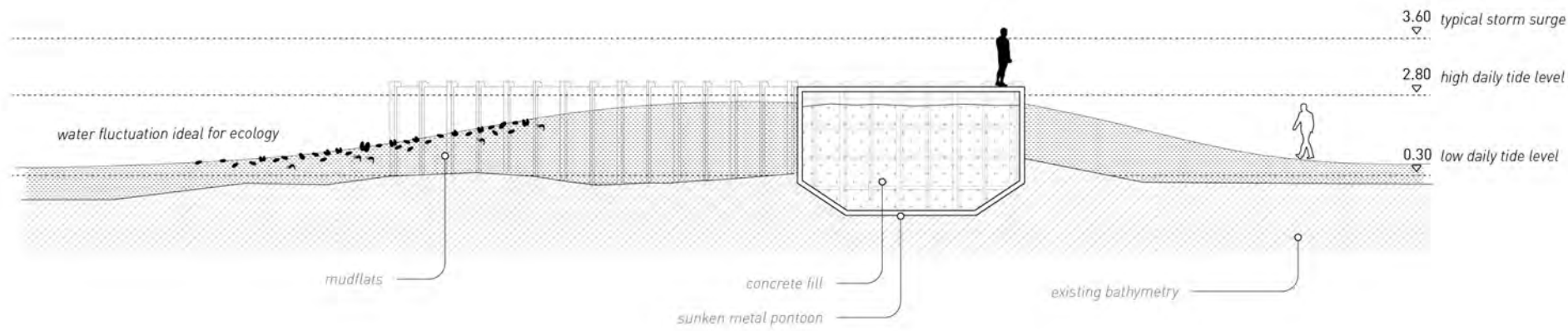

← river flow - unidirectional

SEOUL

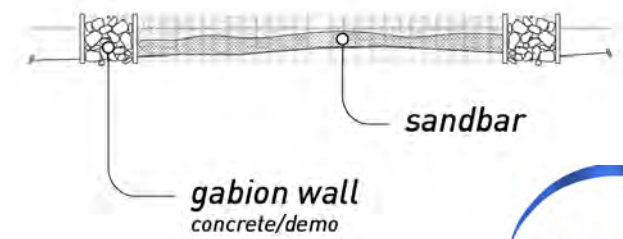
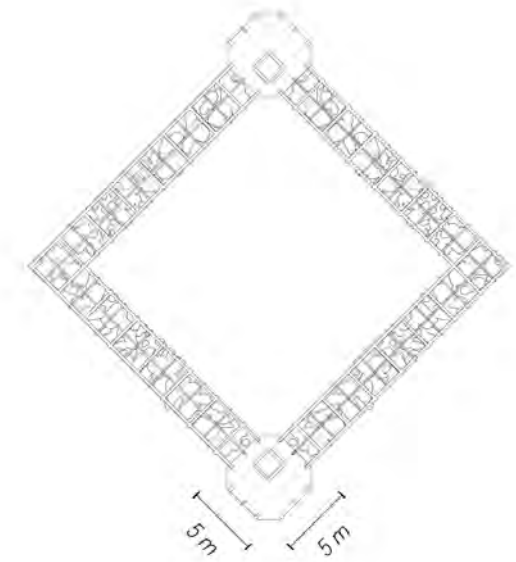
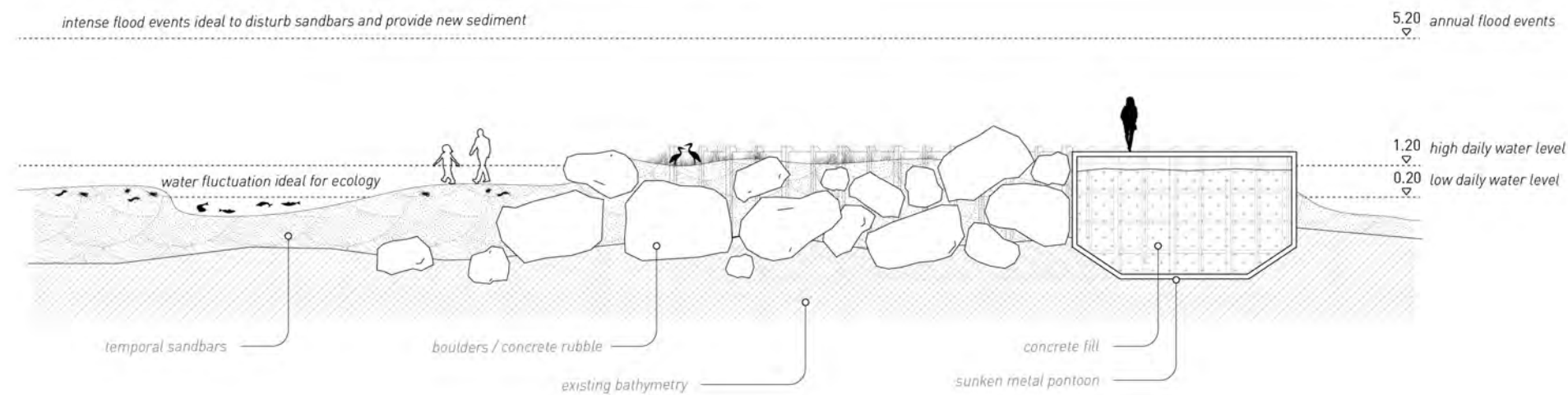



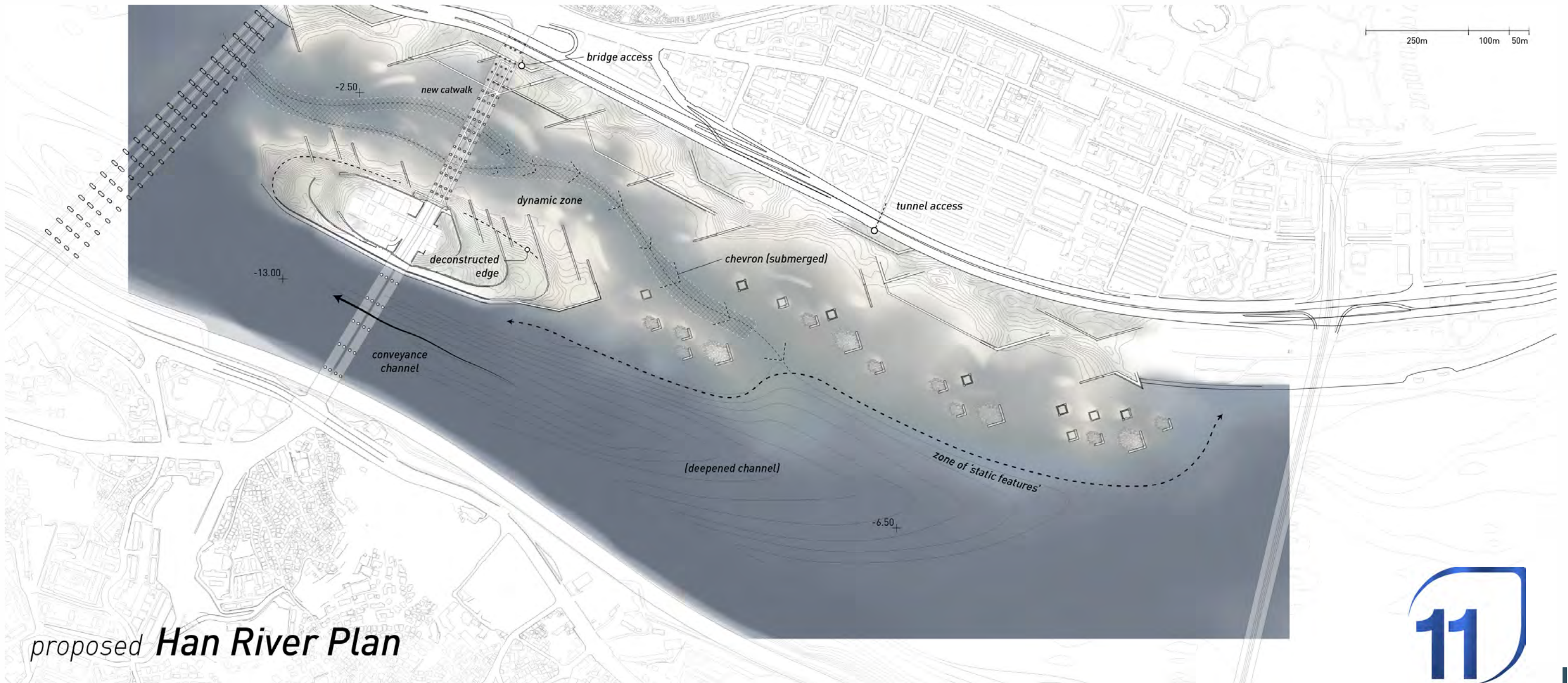
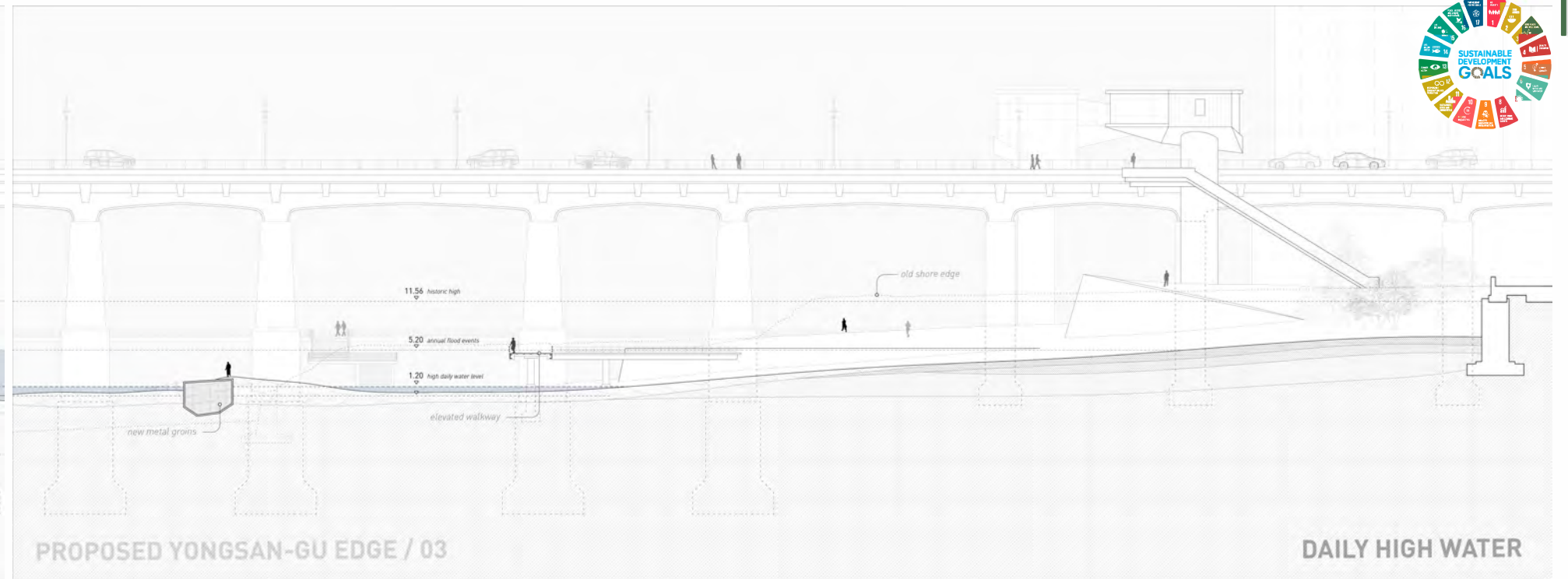
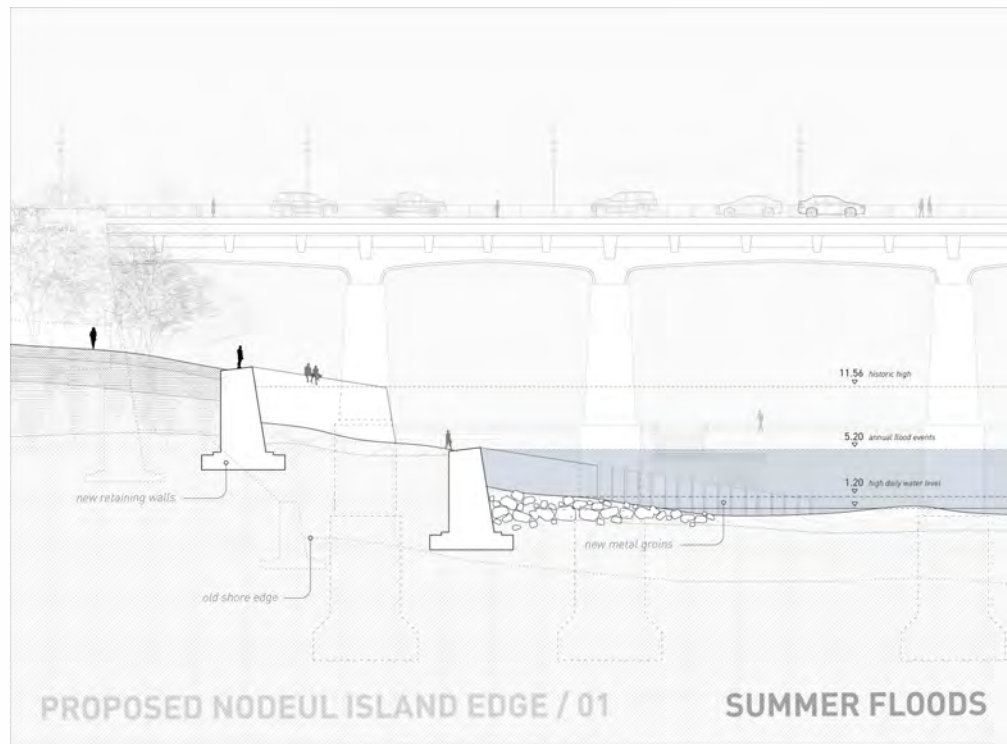



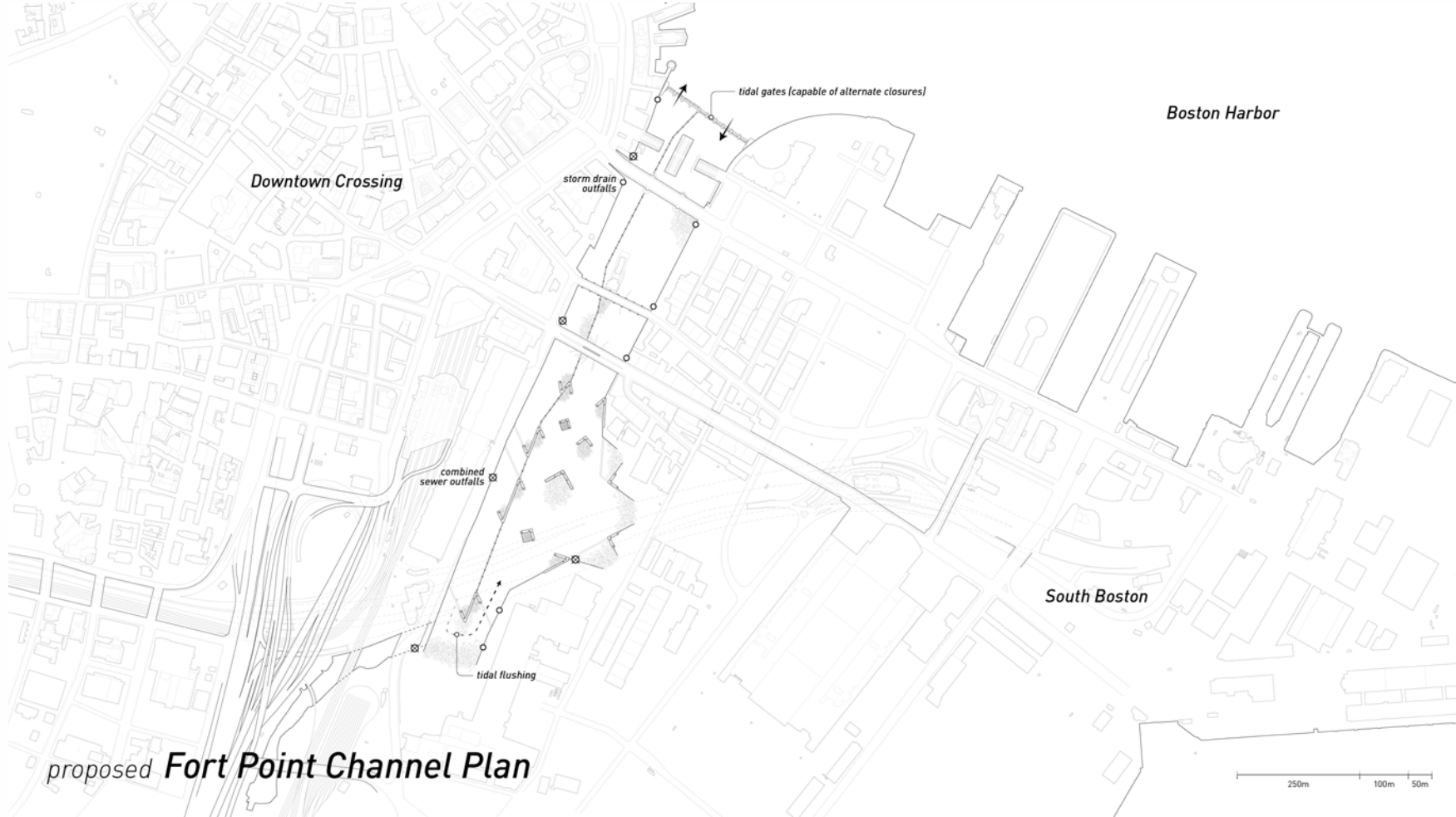
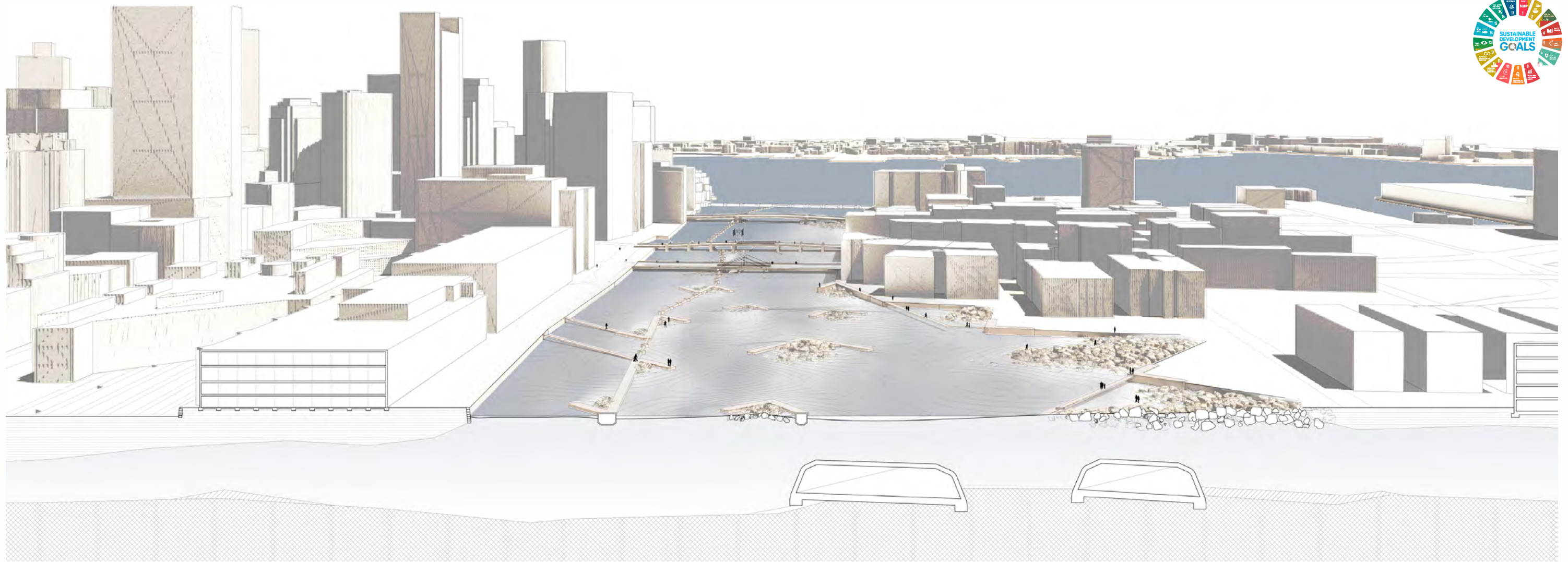

← tidal direction →

