

# The Persistence of Memory



—Landscape Planning of Ecological Health Care Based on Community Pension



Country / City	China / Taian
University / School	Shandong Agricultural University / College of Forestry
Academic year	2019-2020
Title of the project	The Persistence of Memory—Landscape Planning of Ecological Health Care Based on Community Pension
Authors	Yifei Xie;Yating Liu;Yue Qu

## TECHNICAL DOSSIER

Title of the project	The Persistence of Memory—Landscape Planning of Ecological Health Care Based on Community Pension
Authors	Yifei Xie;Yating Liu;Yue Qu
Title of the course	Health care landscape design
Academic year	2019-2020
Teaching Staff	Supervisor: Professor Hongtao Wang; Associate professor:Wei Liu
Department/Section/Program of belonging	Department of Landscape Architecture
University/School	Shandong Agricultural University / College of Forestry



Written statement, short description of the project in English, no more than 250 words

Under the background of social aging, global climate change and rapid urbanization, the physical and psychological problems of the the elderly in China have become increasingly prominent. Due to the particularity of the elderly, they urgently need an environment that can regulate their physical and mental health and have a healing effect. It is one of the important issues for landscape architecture specialty to deal with climate change in the context of community pension to influence the state of the elderly through landscape microclimate and make design strategies in line with the impact mechanism. The project fully considers the special needs of the elderly and the adaptability of microclimate. Based on the analysis of the needs of the urban elderly, the physical environment elements of the urban residential landscape microclimate, the landscape ecological law and the four-dimensional spatial characteristics of the form experience, combined with the investigation and questionnaire, the interaction mechanism between the two is proposed, which provides the theoretical basis for the ecological health landscape planning of the elderly. At the same time, the project aims to make organic transition and combination of health care buildings and surrounding landscape, embed nostalgic elements, and build a participatory ecological sustainable health care community. The project can not only help the elderly to improve their living environment through scientific and technological means, but also enable them to trace the past time through nostalgic landscape elements, so as to enhance the participation and sense of belonging of the elderly.

For further information  
**Máster d'Arquitectura del Paisatge -DUOT - UPC**  
T: + 34 93 401 64 11 / +34 93 552 0842  
Contact via email at: [biennal.paisatge@upc.edu](mailto:biennal.paisatge@upc.edu)

**Máster d'Arquitectura del Paisatge -DUOT - UPC**  
ETSAB- Escola Tècnica Superior  
d'Arquitectura de Barcelona  
Avenida Diagonal, 649 piso 5  
08028 Barcelona-Spain



# CLIMATE CHANGE AGAIN

11th International Biennial Landscape Barcelona

Barcelona September 2020  
SCHOOL PRIZE

# Pre-phase Analyses



## Tai'an Taishan health care center



### Existing Problem



- ① A climate of hot summer and cold winter
- ② Bare vegetation and poor landscape effect



In 2021, there will be one elderly person over 60 for every five people.

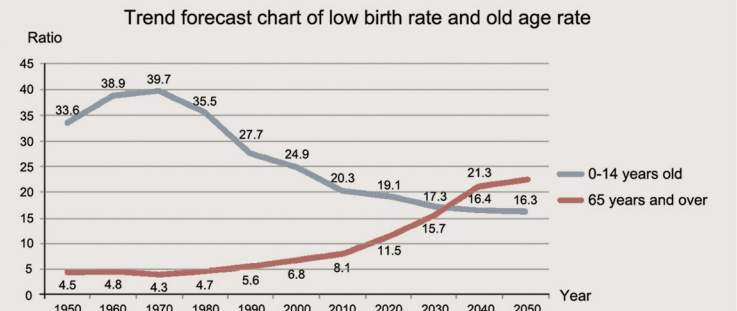

Old people used to work in the fields and work hard all day.



Nowadays, the elderly have a lot of leisure time. They need more suitable places for cultural activities.



③ Lack of entertainment facilities for the elderly and single activity items



④ Noise pollution of surrounding roads and construction site



According to the characteristics of the elderly, it is necessary to establish an ecological sustainable landscape health care community with nostalgia.

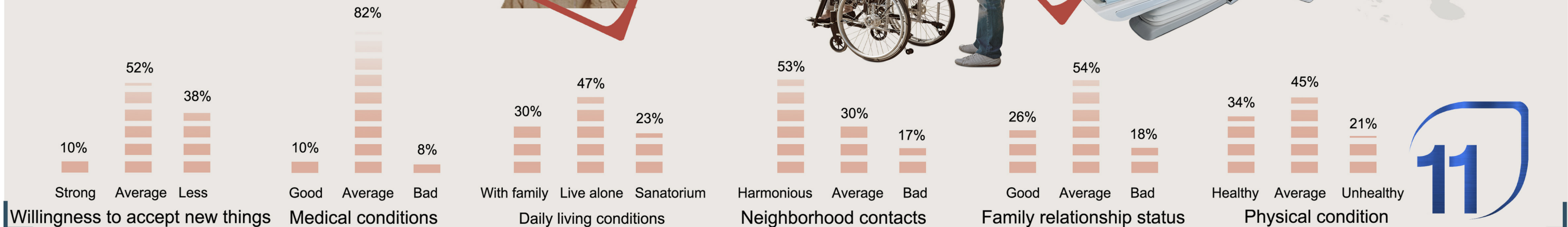

# Design Strategy

Plant physiotherapy: Aromatherapy + Color therapy + Touch therapy

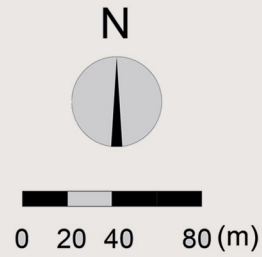
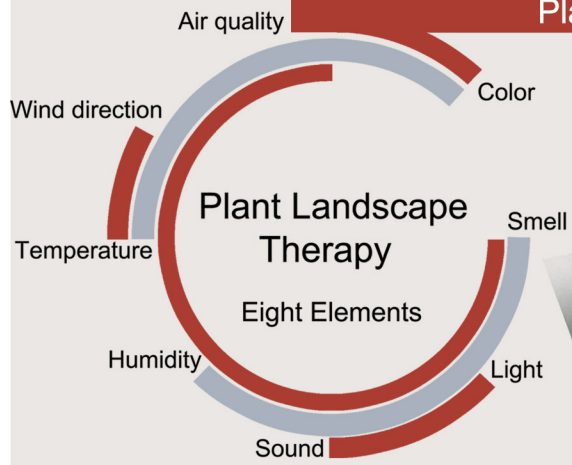

- Comprehensive service building
- Half moon garden
- Medical maintenance building
- Medical maintenance building
- Yun'an Garden
- Recuperation building
- Flying Garden
- Administrative training building
- Entrance

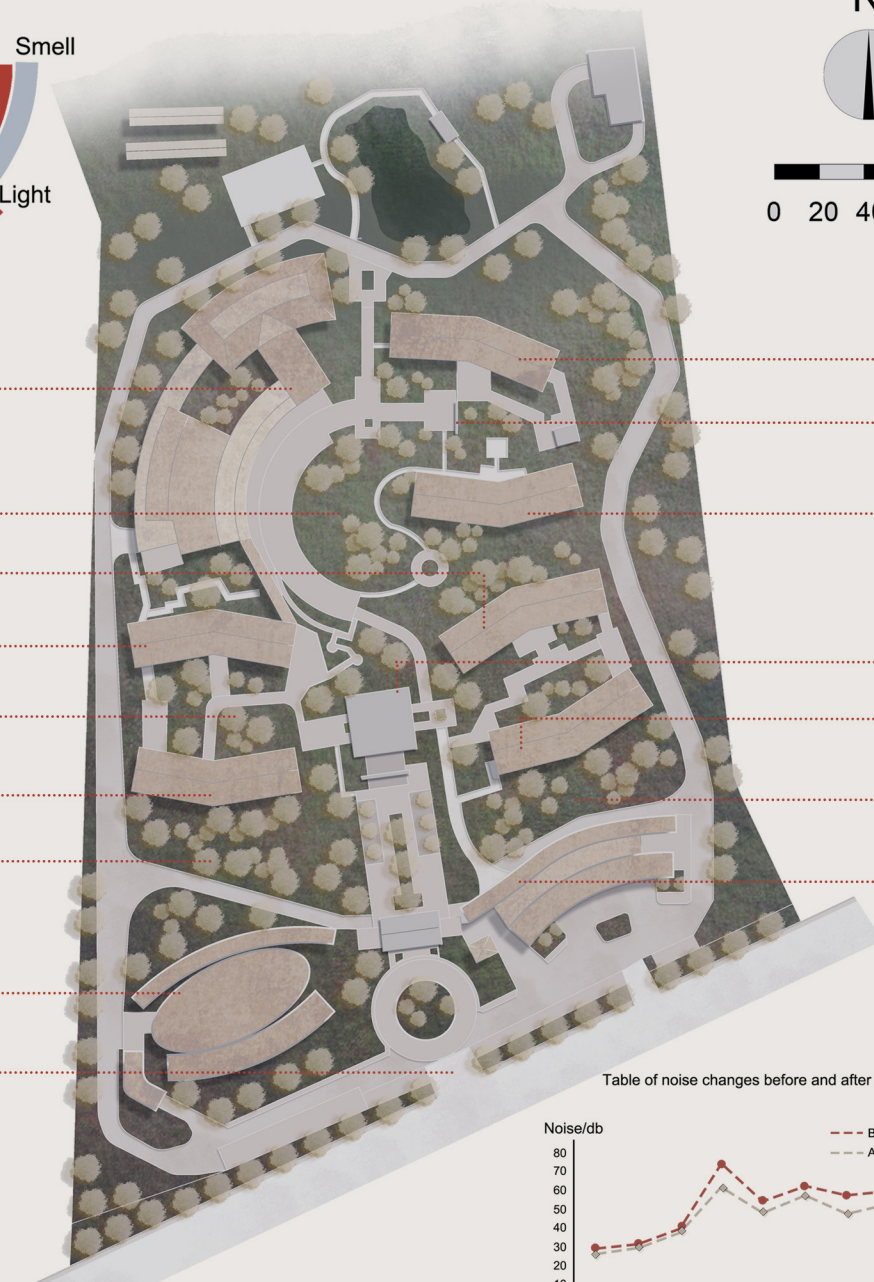

- Medical maintenance building
- Leaky wall
- Half moon garden
- Middle ancient pavilion
- Recuperation building
- Lancui yuan
- Medical building

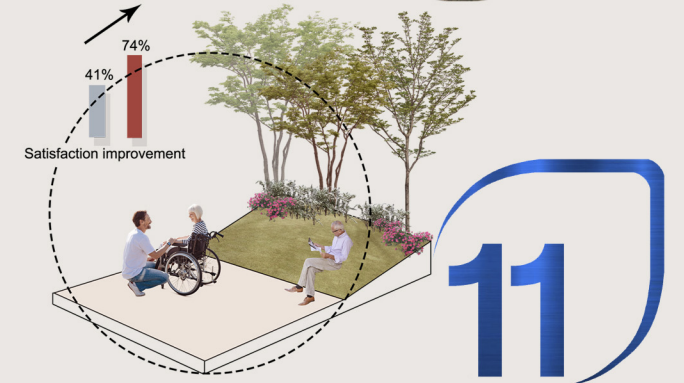
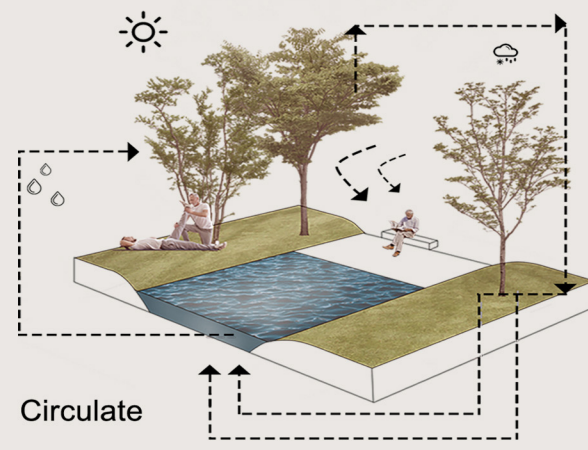
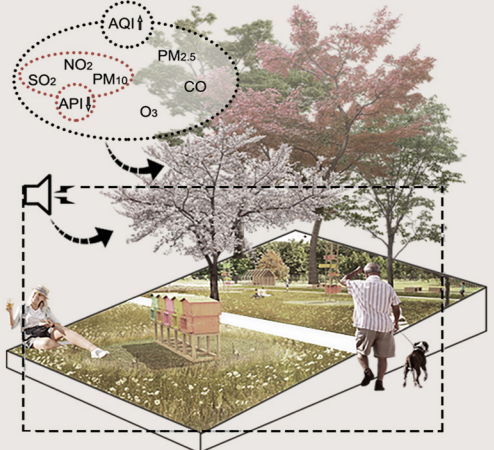
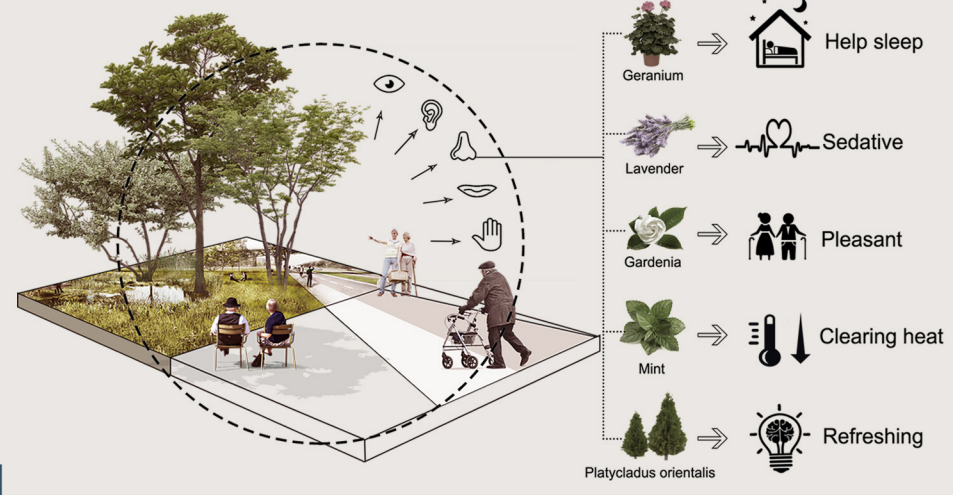
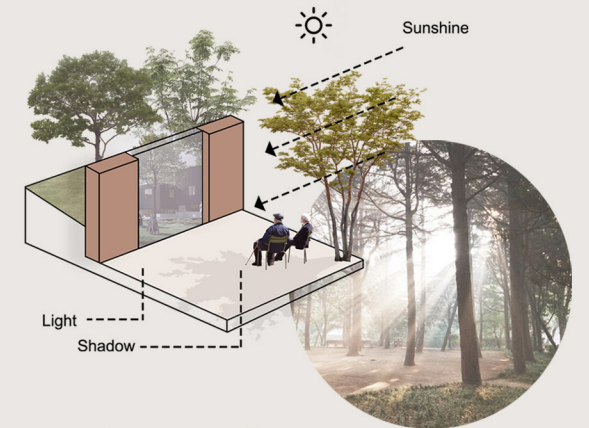
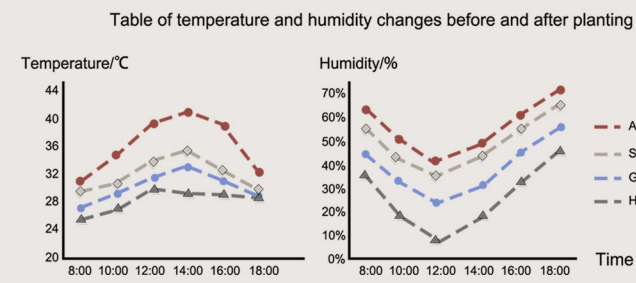
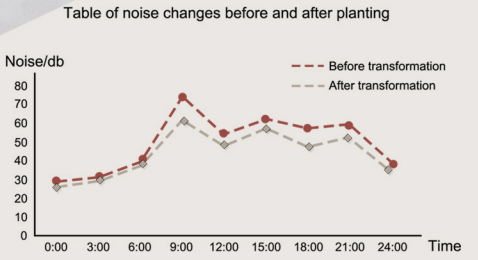
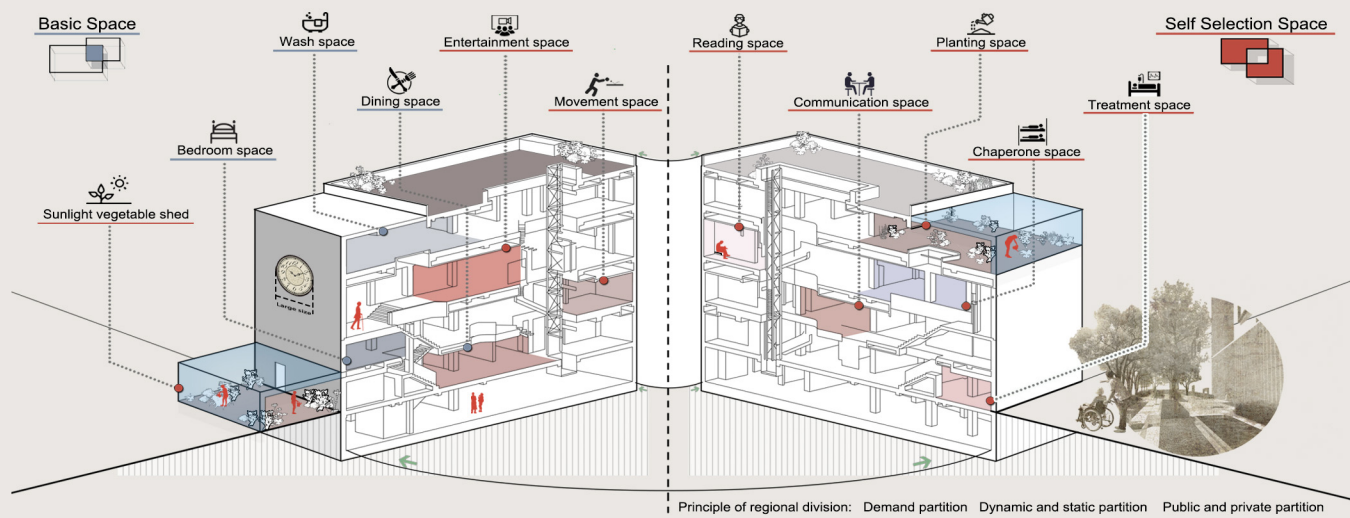
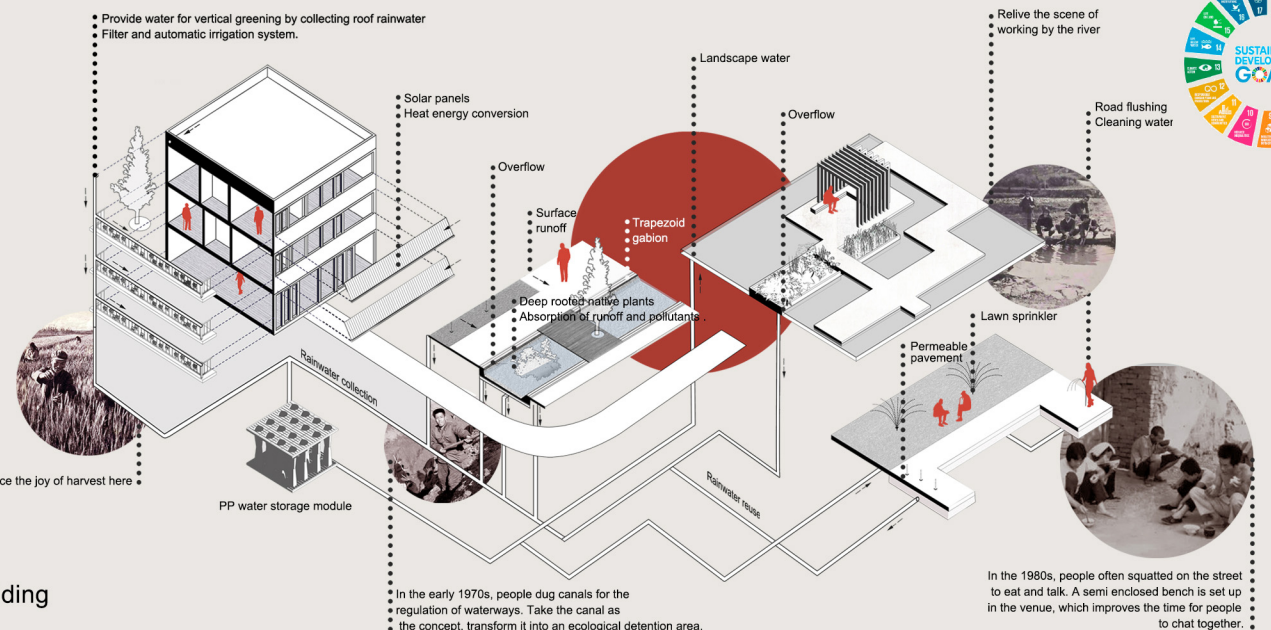

# Design outlook

The project embeds nostalgia elements, fully considers the special needs of the elderly and the adaptability of microclimate, and constructs a participatory ecological sustainable health care community.



Seagull camera was a professional camera in the 1980s. At that time, there were not many people with such a professional camera.

In the 1970s and 1980s, black-and-white television began to enter the families of the common people. At night, people in the village ran to the families with TV, and everyone gathered to watch TV.

The old clock is a type of old clock. Generally produced before the end of 1970s and widely used in the 1980s. It is a kind of mechanical clock.

If anyone has a phoenix bike in his home, don't mention how proud he is.

For a long time, sewing machine was one of the four big things in family life, and it was still a hot commodity until the middle and late 1980s.

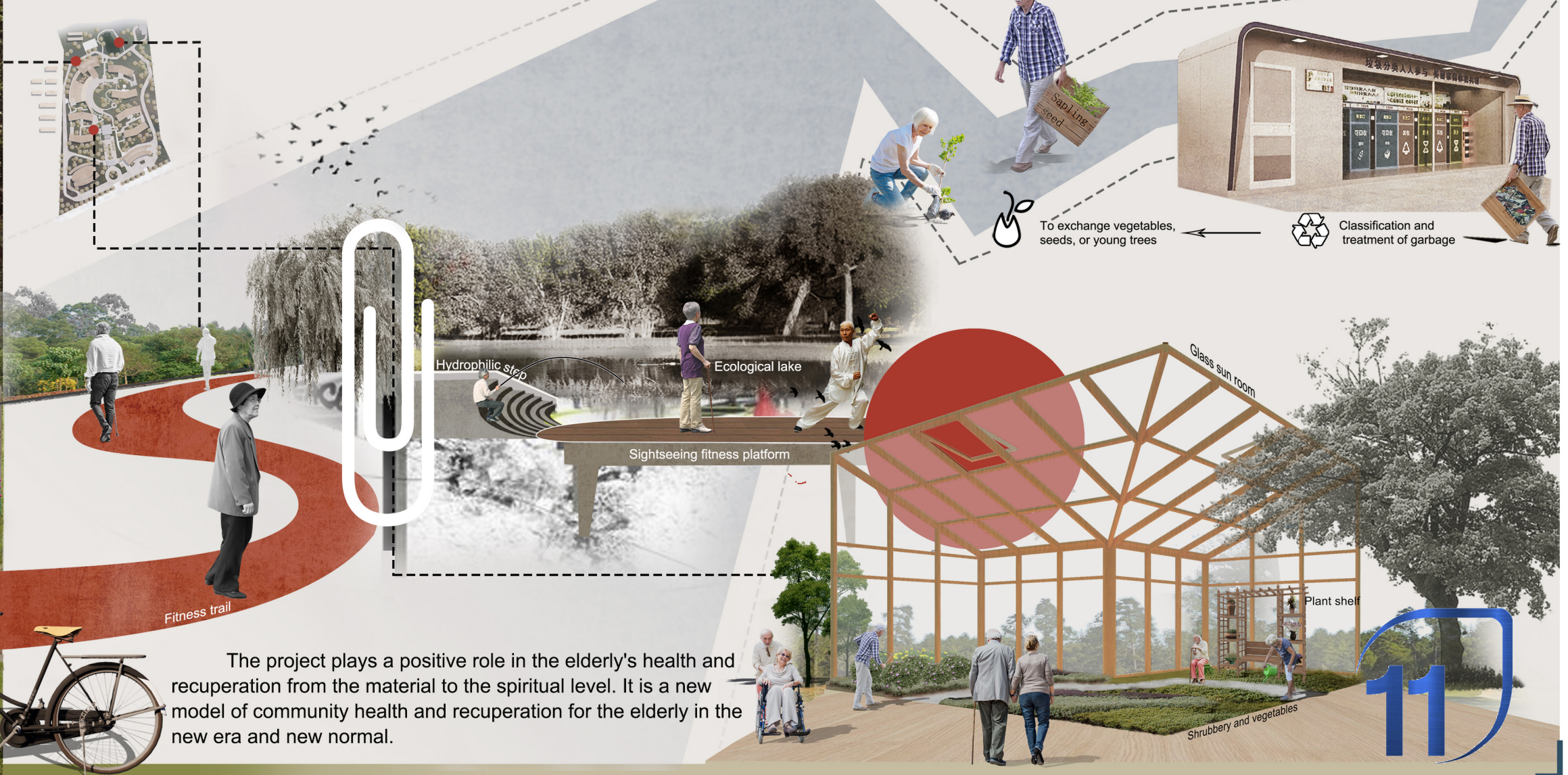

The project plays a positive role in the elderly's health and recuperation from the material to the spiritual level. It is a new model of community health and recuperation for the elderly in the new era and new normal.

