



Collage depicting future activities. Co-created with Luisa Fernanda Torres

Country /City Colombia/Medellín
University / School Universidad Pontificia Bolivariana
Academic year 2020
Title of the project Convergent Node
Authors Manuela Morales Guzmán

TECHNICAL DOSSIER

Title of the project	Convergent Node
Authors	Manuela Morales Guzmán
Title of the course	Design Studio 2
Academic year	2020
Teaching Staff	Arch. Mg Lina María Escobar, Arch. MSc Juan Esteban Correa, Land Arch. María Bellalta
Department / Section / Program of belonging	School of Architecture and Design, Faculty of Architecture, Master in Landscape Design
University / School	Universidad Pontificia Bolivariana



Written statement, short description of the project in English, no more than 250 words

Immersing in the captivating world of the Barrio Perpetuo Socorro Creative District Landscape Master Plan is discovering a visionary plan that proposes to harmonize sustainability, resilience, and social cohesion, weaving them into the fabric of an urban oasis.

Nestled amidst the enchanting eastern hills, the master plan unites the natural and social components. Six strategies guide the neighborhood's transformation: Ecology and Biodiversity cultivate an ecological corridor, native vegetation, microclimates, and proper rainfall management. Diversity springs forth in public spaces, celebrating the plurality of the community. Economy and Connectivity create circuits for all mobility types, utilizing existing spaces and triggering vibrant activity.

Education fosters connection through plant species, local materials, and digital interactions. Identity and Vocation enhance the area's scenic beauty, centering around the Our Lady of Perpetuo Socorro church. Resilience blossoms with green roofs, facades, community gardens, and sustainable drainage systems. Natural materials and permeable surfaces ensure longevity.

At the heart of the plan lies the Convergent Node, a strategic intervention point. It serves as a catalyst for the entire proposal, connecting vital corridors and anchoring the community around the church. Here, the city's essence embraces nature, preserving its intrinsic bond.

Barrio Perpetuo Socorro Creative District Landscape Master Plan thrives on sustainability, resilience, and social cohesion. Step into this vibrant tapestry of coexistence, where nature and community flourish in perfect harmony.

For further information

Máster d'Arquitectura del Paisatge - UPC

Contact via email at:
master.paisatge.comunicacio@gmail.com

biennal.paisatge@upc.edu

Máster d'Arquitectura del Paisatge - UPC

Sede ETSAB - Universitat Politècnica de Catalunya

Calle Jordi Girona, 15. Edificio Omega 1-3
08034 Barcelona - Spain

COAC - Colegi oficial d'Arquitectes de Catalunya

Carrer Arcs, 1-3
08002 Barcelona - Spain

12th International Biennial Landscape Barcelona

Barcelona October 2023

SCHOOL PRIZE

CONVERGENT NODE

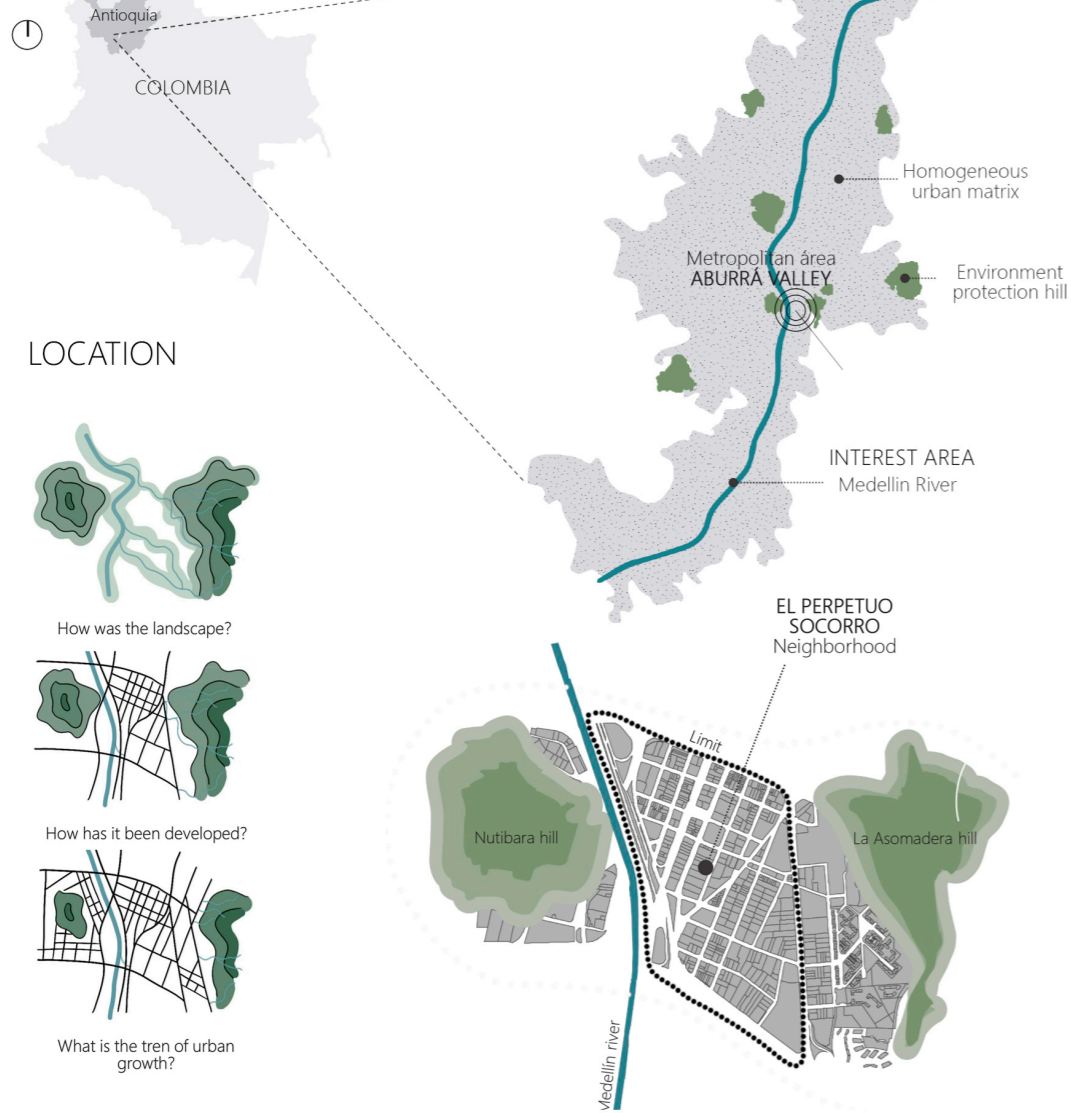

LOCATION

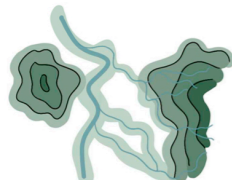

How was the landscape?



How has it been developed?



What is the tren of urban growth?

Ecology and Biodiversity



Plurality



Economy and Connectivity



Education



Resilience



Identity and Vocation



Co-created with Luisa Fernanda Correa, Diana Rúa, Laura Buelvas

The Barrio Perpetuo Socorro Creative District Landscape Master Plan is a mesmerizing urban oasis that celebrates sustainability, resilience, and social cohesion. Crafted with the utmost care, this visionary proposal interweaves nature and society, creating an enchanting tapestry of transformation.

At the heart of this vision lies the Convergent Node—a catalyst at the intersection of vital corridors. Here, the community finds solace amidst the urban bustle, preserving the bond between humanity and its environment.

In the Barrio Perpetuo Socorro Creative District Landscape Master Plan, sustainability thrives, resilience reigns, and social cohesion flourishes. Step into this vibrant tapestry of harmonious coexistence, and let your spirit soar amidst nature's breathtaking symphony.

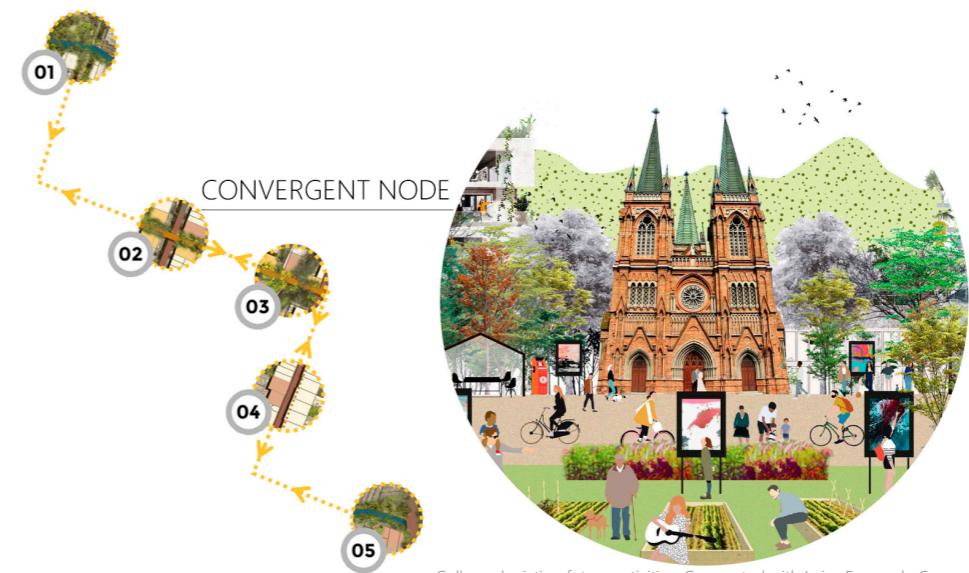

Collage depicting future activities. Co-created with Luisa Fernanda Correa

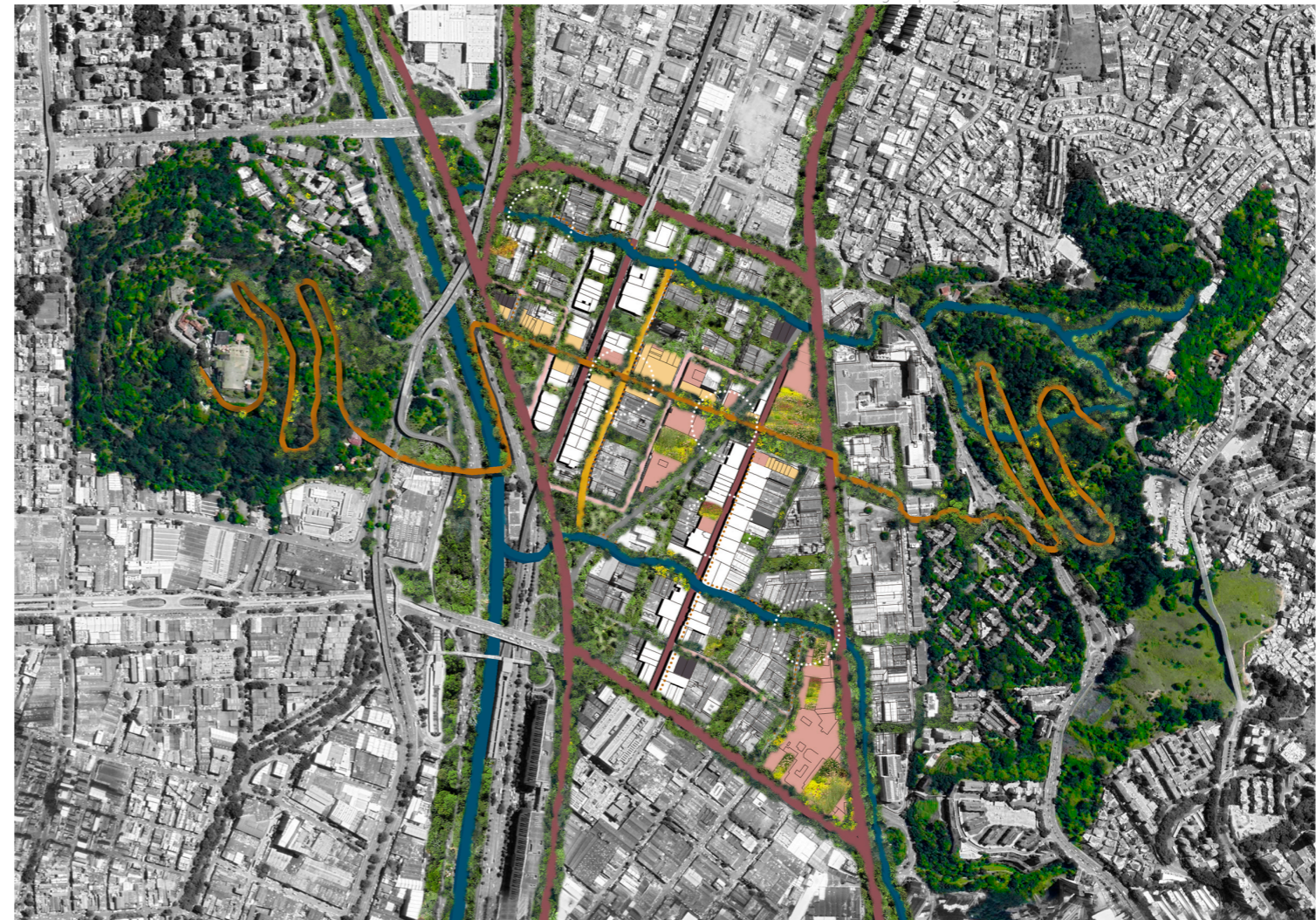

Collage depicting future activities. Co-created with Luisa Fernanda Correa

CONVERGENT NODE

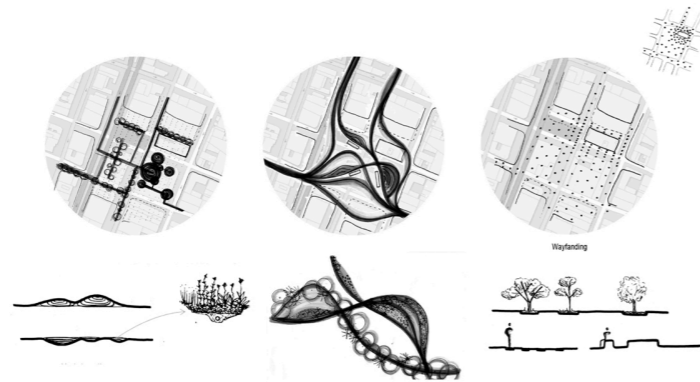
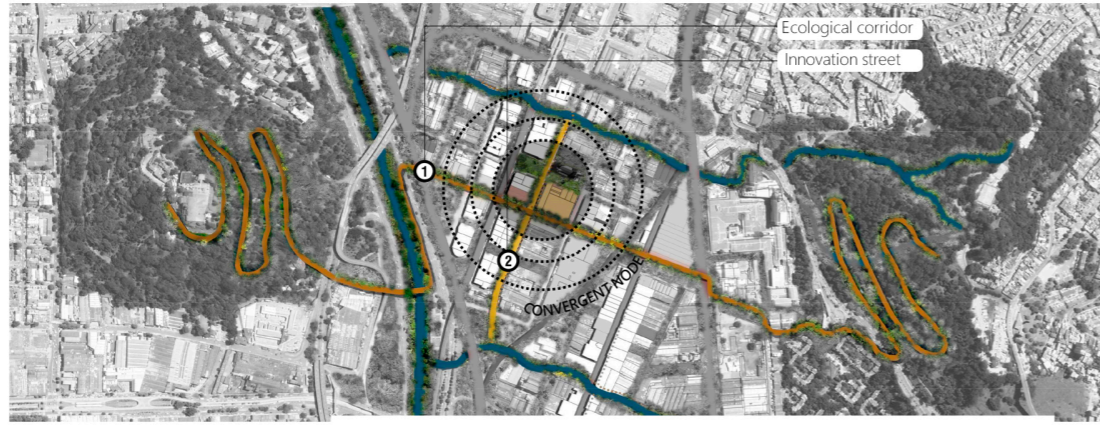

Square of light

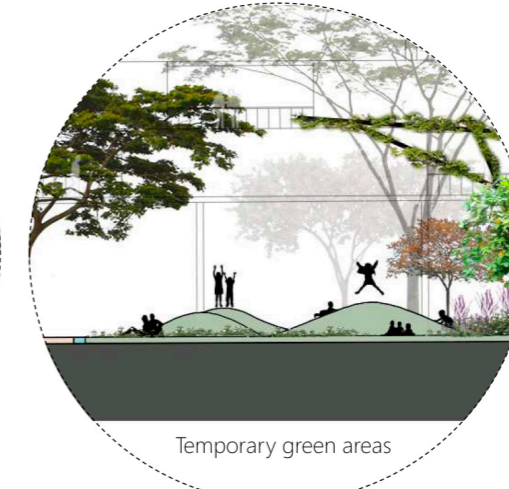

Temporary green areas



Biodiversity pavilion

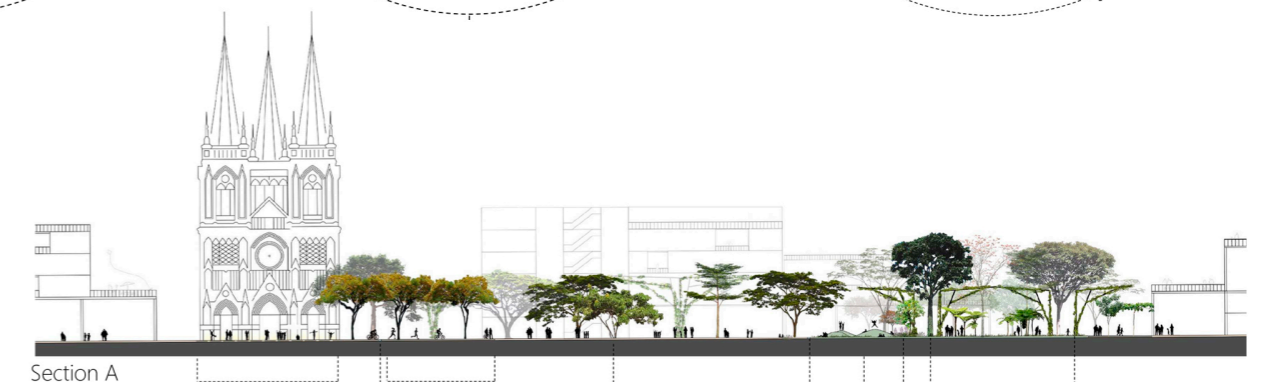

Section A

- 14
- 7
- 8
- 10
- 7
- 3
- 13
- 1
- 2

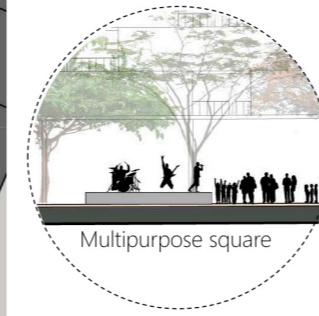

Multipurpose square

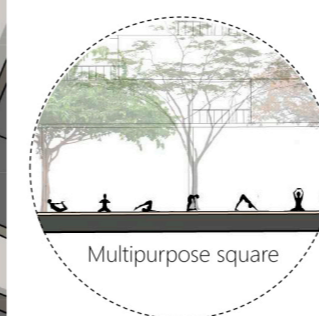

Multipurpose square

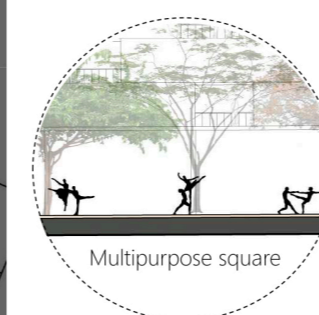

Multipurpose square



Section B

- 10
- 9
- 10
- 8
- 15
- 7
- 4
- 6
- 5

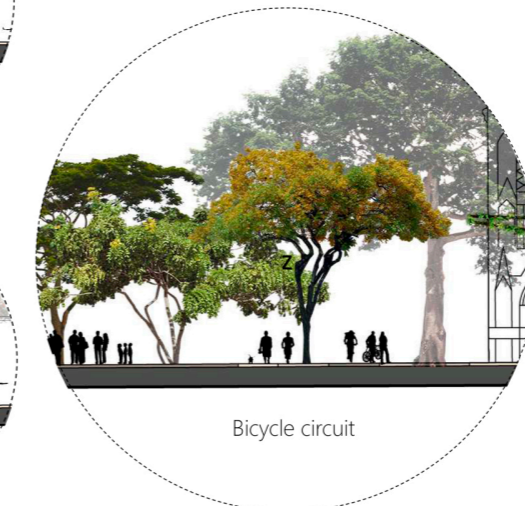

Bicycle circuit



Rain gardens

PROGRAM

- 1 Trees for wildlife
- 2 Biodiversity pavilion
- 3 Temporary green areas
- 4 Rain gardens
- 5 Multipurpose modules
- 6 Large trees
- 7 Waterways
- 8 Bicycle circuit
- 9 Multipurpose square
- 10 Umbrella-shaped trees
- 11 Environmental rooms
- 12 Urban vegetable garden
- 13 Butterfly garden
- 14 Square of light
- 15 Innovation pavilion



Floor plans

CONVERGENT NODE



Current status



Current status



Current status

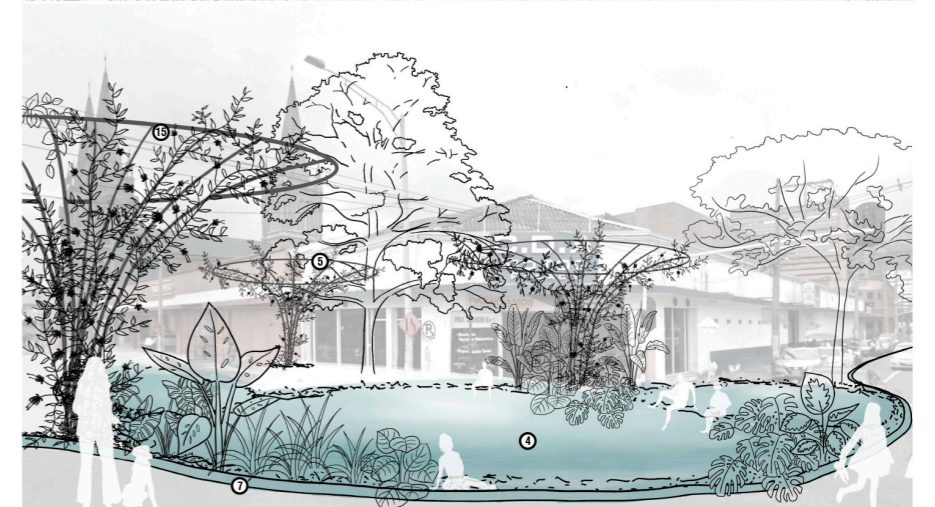

Intervention proposal

Landscape design according to the shape of the trees



Common name Scientific name

- 1 Loro *Dilodendron costaricense*
- 2 Pasquín *Albizia carbonaria*
- 3 Samán *Albizia saman*
- 4 Tambor *Schizolobium parahyba*
- 5 Pacó *Cespedesia spathulata*
- 6 Guayacán amarillo *Handroanthus chrysanthus*
- 7 Guayacán de bola *Bulnesia arborea*
- 8 Rayo *Parkia pendula*
- 9 Acacia amarilla *Caesalpinia pluviosa*
- 10 Almendro *Terminalia catappa*
- 11 Suribio *Zygia longifolia*
- 12 Olivo negro *Bucida buceras*
- 13 Terminalia *Terminalia ivorensis*
- 14 Mulí *Buchenavia tetraphylla*
- 15 Carbonero *Calliandra pittieri*
- 16 Pandurata *Ficus lyrata*
- 17 Aguacatillo *Persea caerulea*
- 18 Ceiba *Ceiba pentandra*
- 19 Cábulo *Erythrina poeppigiana*
- 20 Caracolí *Anacardium excelsum*

Common name Scientific name

- 21 Búcaro *Erythrina fusca*
- 22 Gualanday nativo *Jacaranda hesperia*
- 23 Caoba *Swietenia macrophylla*
- 24 Vara Santa *Triplaris americana*
- 25 Borombolo *Andira inermis*
- 26 Madroño *Garcinia madruno*
- 27 Guayabo de mico *Psidium guajava*
- 28 Noro *Byrsonima crassifolia*
- 29 Hoja de lanza *Miconia caudata*
- 30 Coralito *Hamelia patens*
- 31 Caimito *Chrysophyllum cainito*
- 32 Guayacán azul *Guaiacum officinale*
- 33 Carate *Vismia baccifera*
- 34 Azuceno *Tabernaemontana litoralis*
- 35 Chirlobirlo *Tecoma stans*
- 36 Drago *Croton magdalenensis*
- 37 Arizá *Brownea ariza*
- 38 Coralillo *Isertia haenkeana*
- 39 Chaparrio *Adenaria floribunda*
- 40 Magnolio *Magnolia grandiflora*

ECOSYSTEM FUNCTION



LANDSCAPE TEXTURES