

Country /City Chile, Santiago

University / School Pontificia Universidad Católica de Chile, Magíster en Arquitectura del Paisaje

Academic year 2020

Title of the project Ecological Reserve "Los Maitenes".

Authors Javiera Pizarro Osorio

## TECHNICAL DOSSIER

<b>Title of the project</b>	Ecological Reserve "Los Maitenes"
<b>Authors</b>	Javiera Pizarro Osorio
<b>Title of the course</b>	Graduation project workshop
<b>Academic year</b>	2020
<b>Teaching Staff</b>	Paula Aguirre and Gonzalo Schmeisser
<b>Department / Section / Program of belonging</b>	Magíster en Arquitectura del Paisaje - MAPA
<b>University / School</b>	Pontificia Universidad Católica de Chile



### Written statement, short description of the project in English, no more than 250 words

The project seeks to recover the Campiche wetland and its surroundings, located in Puchuncaví, Valparaíso, Chile, by transforming the wetland into an Ecological Reserve that promotes socio-environmental justice and provides spaces for the community's encounter, research and enjoyment through three main operations: topographic modeling, ecological rehabilitation and infrastructure construction. The aim is to integrate the vestiges of the site's past and transform the territory into a cohesive territorial unit incorporating the present industrial landscape. The reserve is conceived as a center for research and environmental remediation, focusing on scientific, cultural and environmental activities. Rest, leisure and recreation areas for visitors are also established, as well as infrastructure for workshops, libraries, environmental education, ecological monitoring, crops and community gardens, among others. The project strategies aim to make the different forms of water present in the site flow. The soil, a complex, degraded element in the process of repair, is the unifying element, where the modeling of its topography, the management of light and dark, wetlands, the construction of pools and the control of runoff to capture water, among others, will weave the site as a single artifact. The project is expected to expand into the surrounding areas and to continue working on infrastructures that are currently in obsolescence due to the country's decarbonization process.

For further information

**Máster d'Arquitectura del Paisatge - UPC**

Contact via email at:  
master.paisatge.comunicacio@gmail.com

biennal.paisatge@upc.edu

**Máster d'Arquitectura del Paisatge - UPC**

Sede ETSAB - Universitat Politècnica de Catalunya

Calle Jordi Girona, 15. Edificio Omega 1-3  
08034 Barcelona - Spain

COAC - Colegi oficial d'Arquitectes de Catalunya

Carrer Arcs, 1-3  
08002 Barcelona - Spain

**12th International Biennial Landscape Barcelona**

**Barcelona November 2023**

**SCHOOL PRIZE**

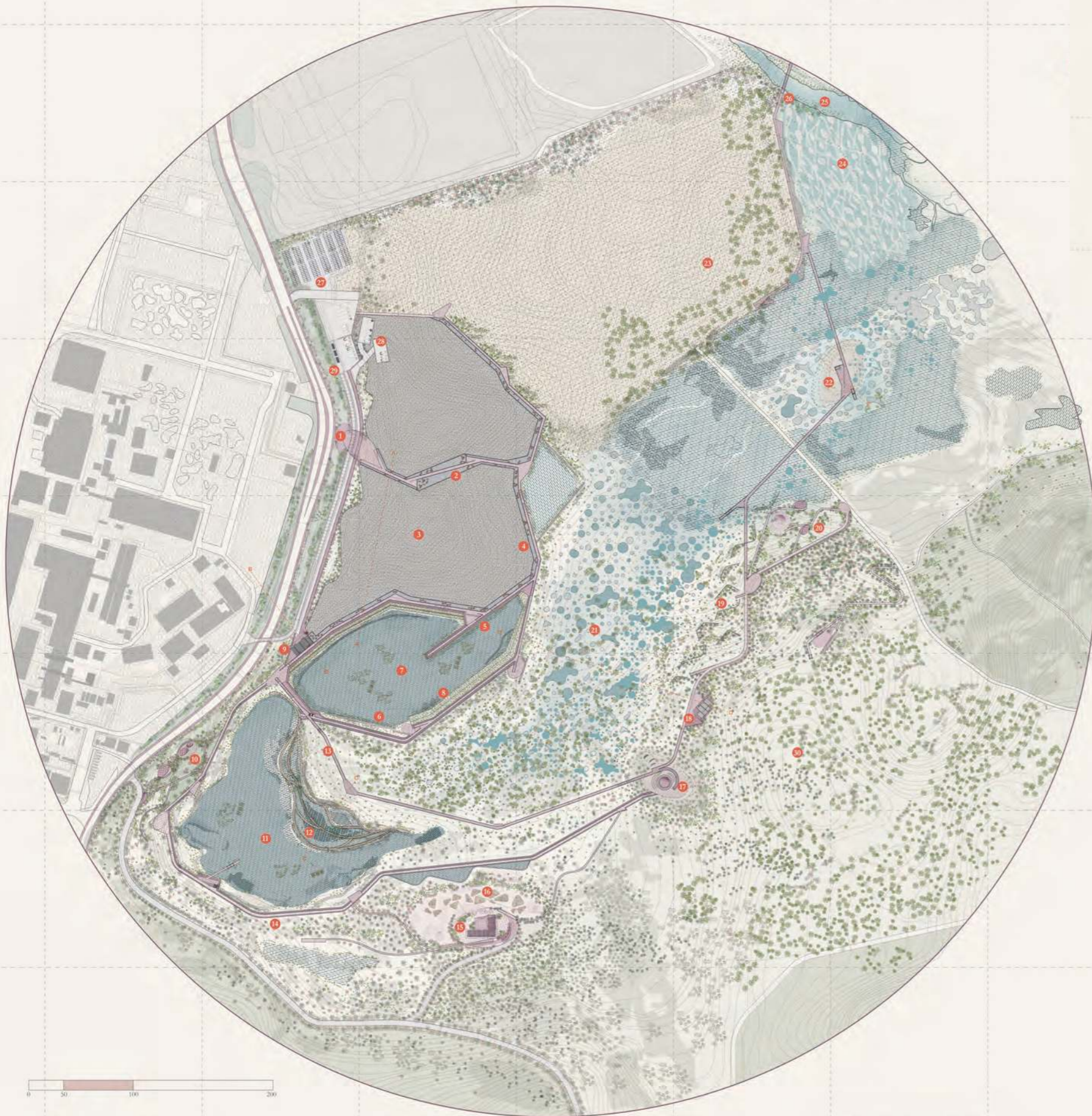

Project plan

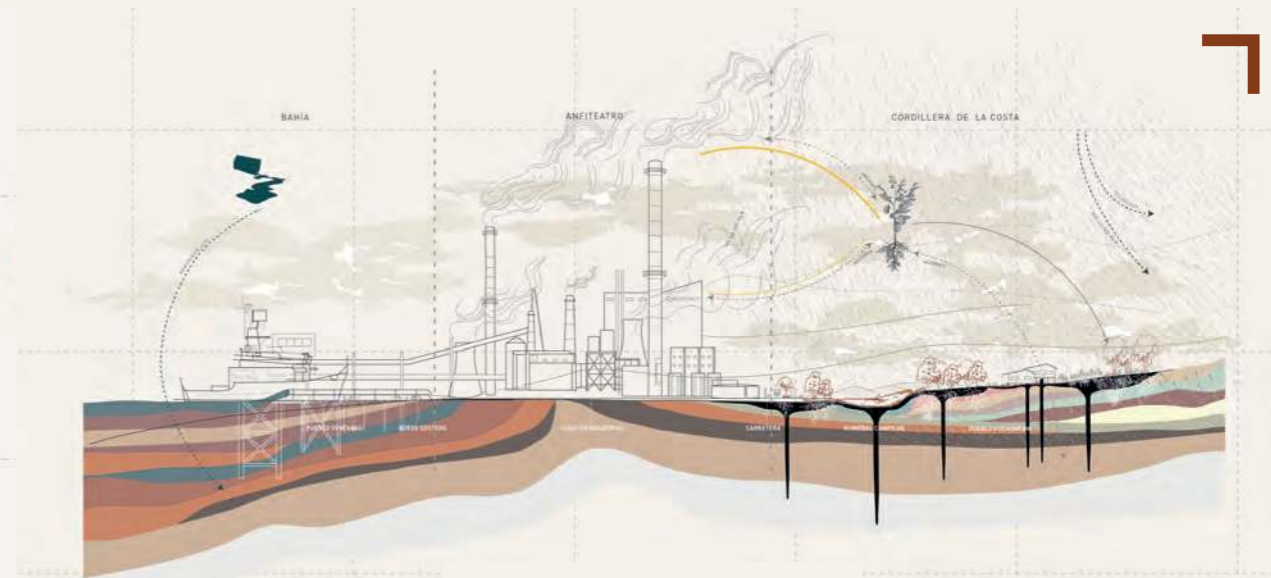

The problem

Program and project area

- |  |  |
|--|--|
| 1. Access / Exit from de industrial area | 16. Experimental greenhouses                     |
| 2. Artificial wetland                    | 17. Amphitheater                                 |
| 3. Escoria                               | 18. Services: library, bathrooms and coffee shop |
| 4. Underground trail                     | 19. Stone walls                                  |
| 5. Viewpoint                             | 20. Border park                                  |
| 6. Biorelts and bioslands                | 21. Water garden                                 |
| 7. Depurated wetland                     | 22. Viewpoint                                    |
| 8. Artificial wetland                    | 23. Dunes  |
| 9. Biochemical laboratory                | 24. Stream Irrigation                            |
| 10. Border park                          | 25. PUNCHAVI stream                              |
| 11. Campiche wetland                     | 26. Acces / exit to urban zone                   |
| 12. Superficial flow wetland             | 27. Parking lots                                 |
| 13. Elevated trails                      | 28. Parking lots with escoria deposits           |
| 14. Campiche wetland border trail        | 29. Cargo train                                  |
| 15. Agricultural laboratory              | 30. Reforestation                                |

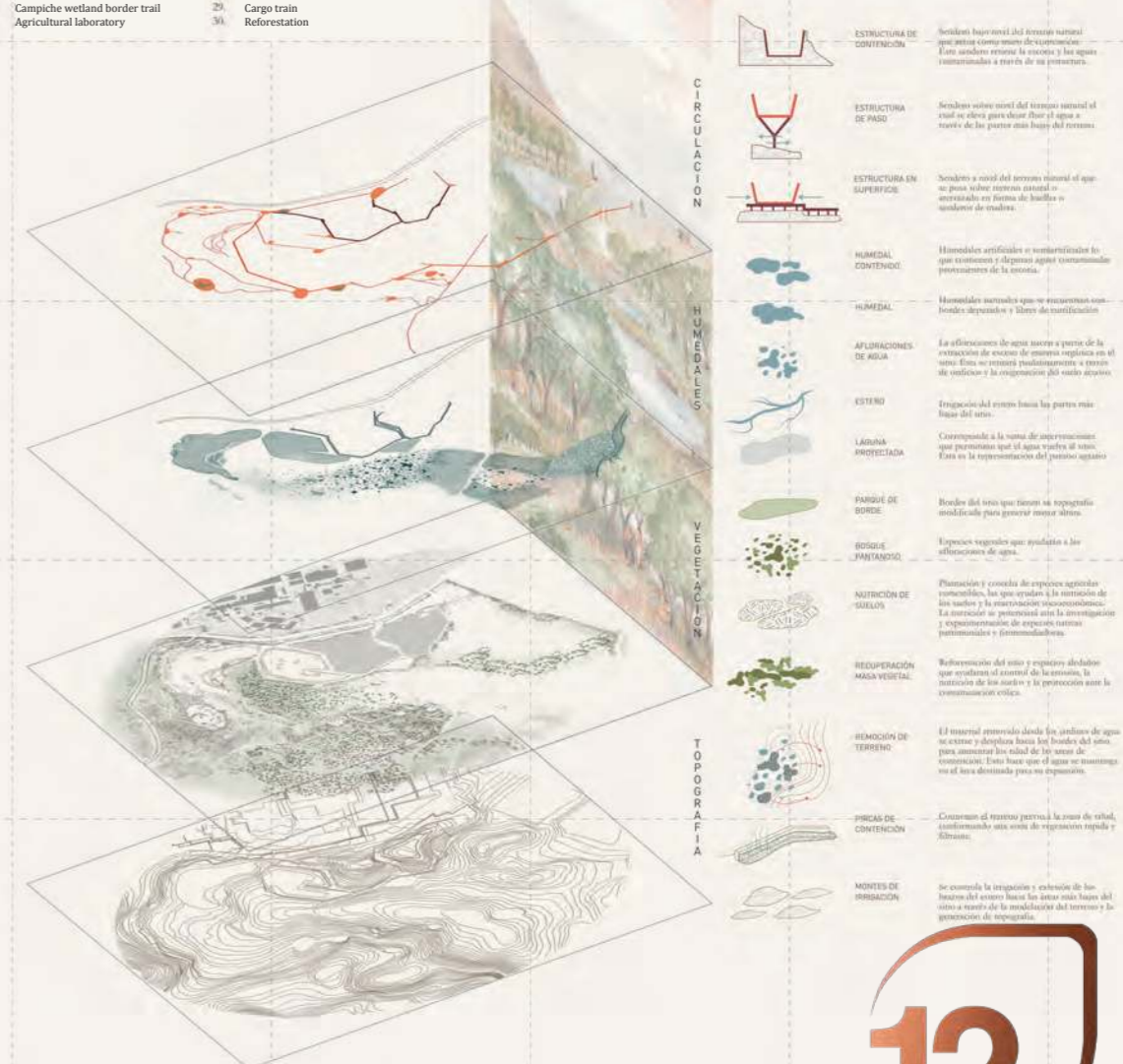

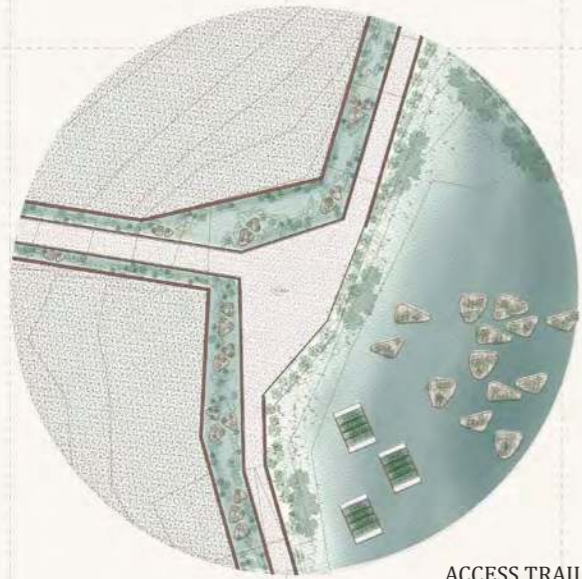

ACCESS TRAIL AND FIRST VIEW OF THE RESERVOIR



UNDERGROUND GROUNDWALK AND LABS

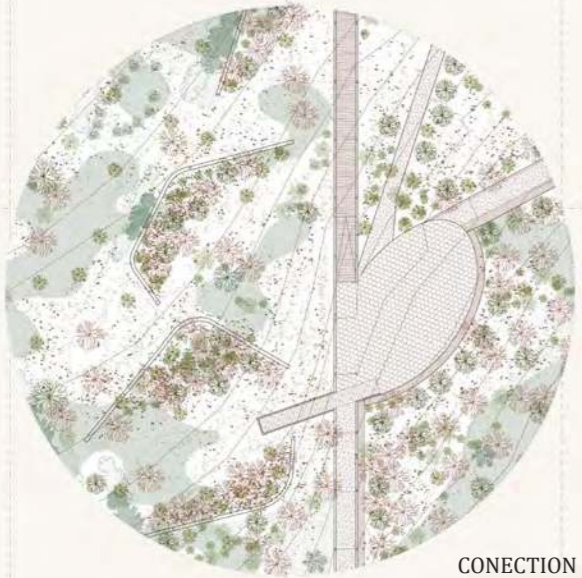

CONNECTION BETWEEN ELEVATED GROUNDWALK AND BORDER PARK

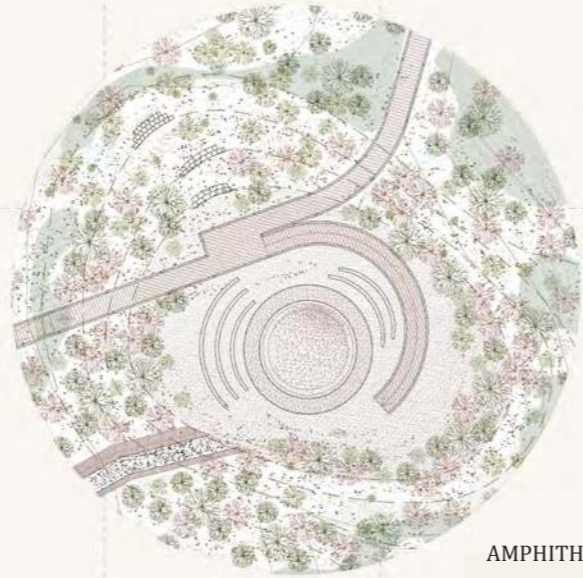

AMPHITHEATER

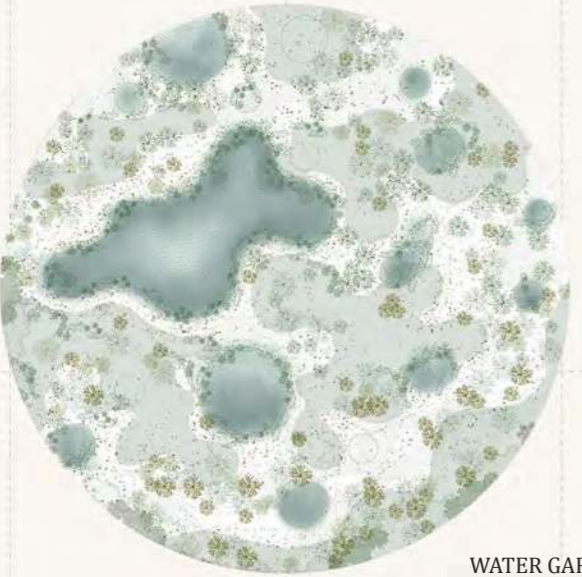

WATER GARDEN

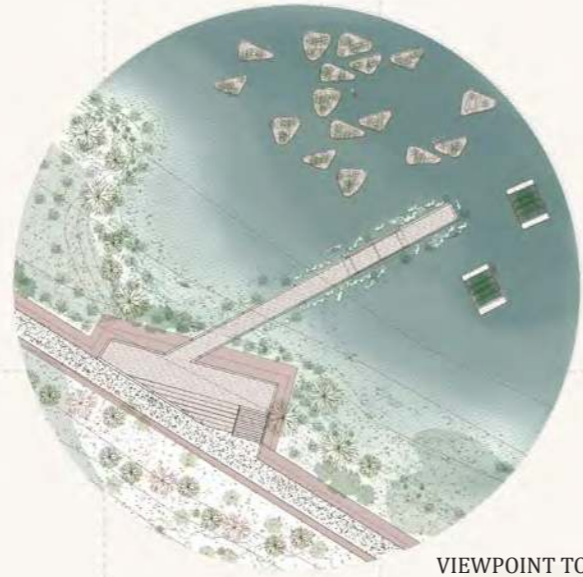

VIEWPOINT TO CAMPICHE WETLAND

Plan details

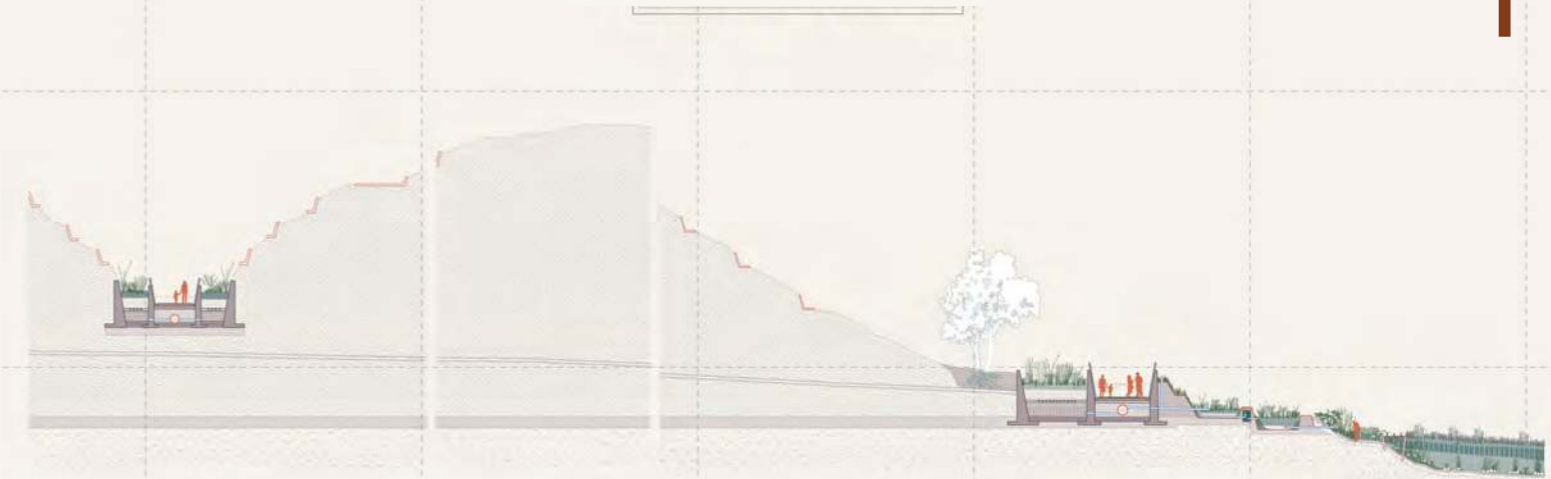

Desolation: escoria

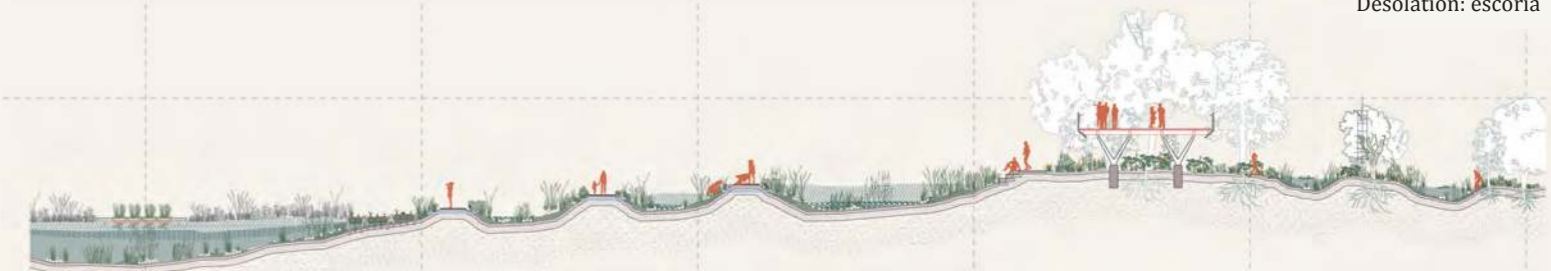

Destruction: Campiche wetland

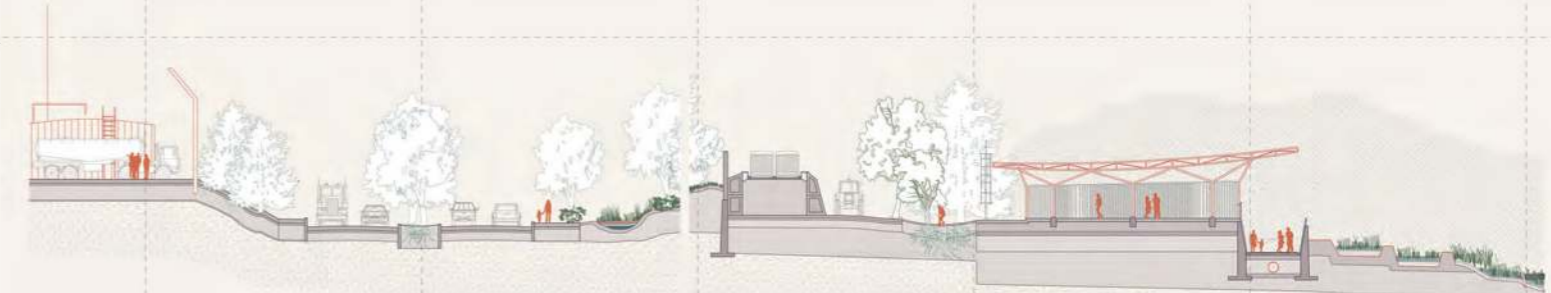

The empire: the industry

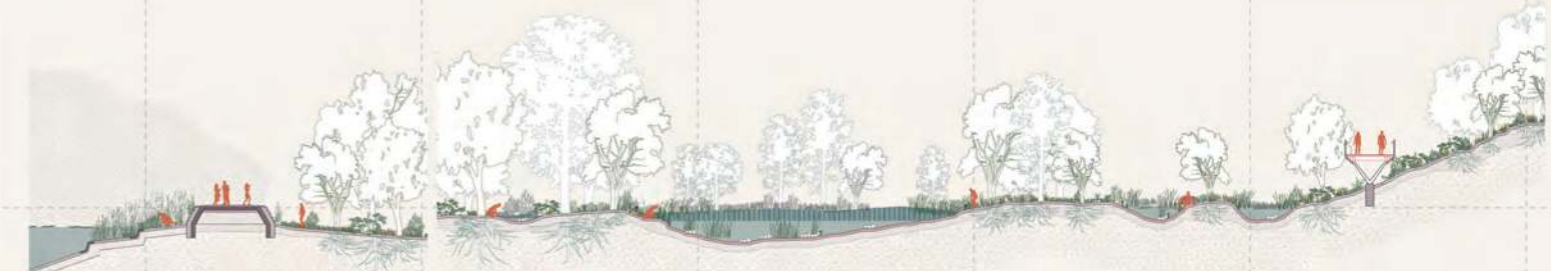

The pastoral state: the water garden

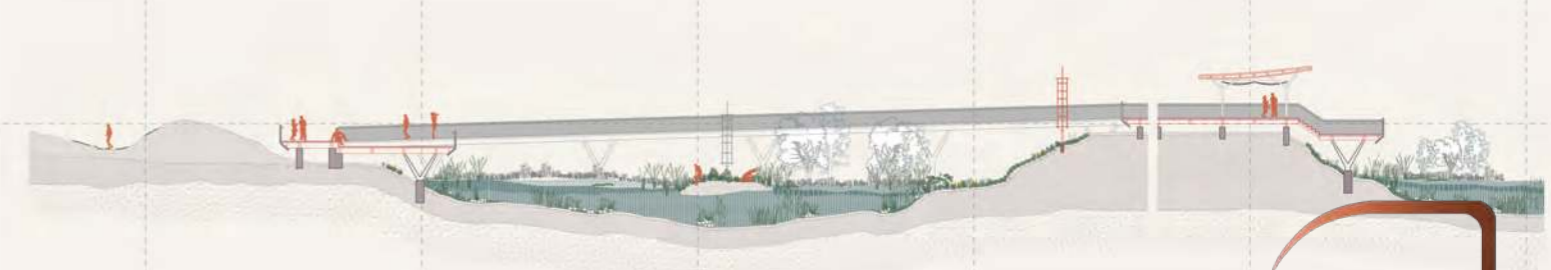

The wild state: the lagoon

Sections

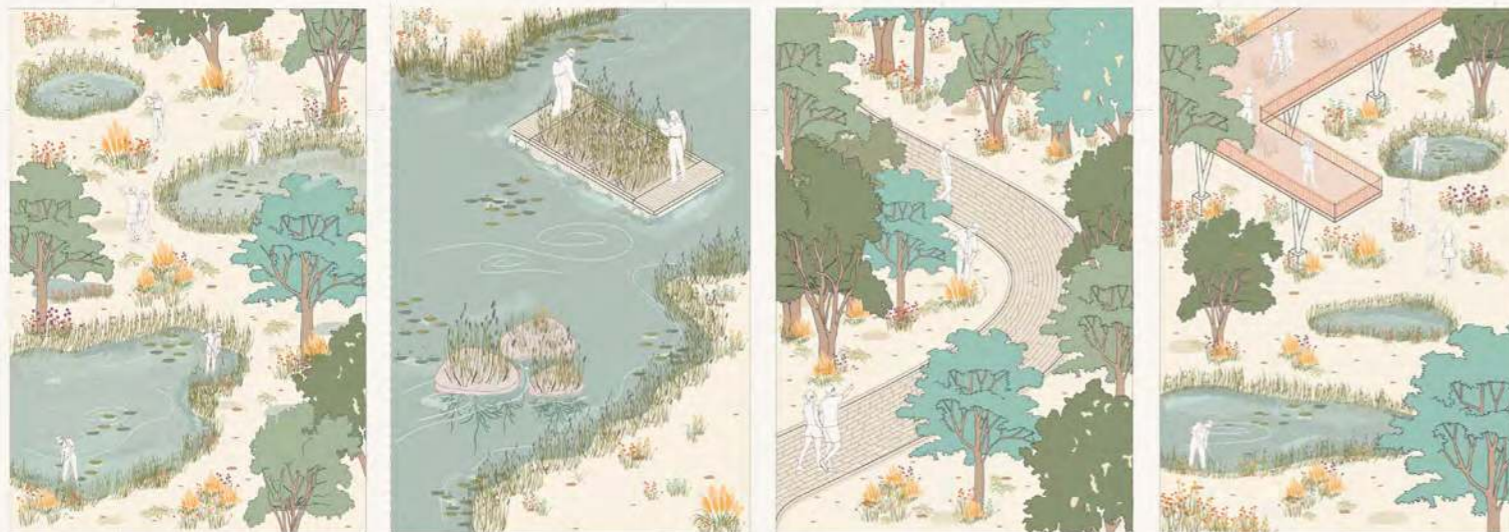
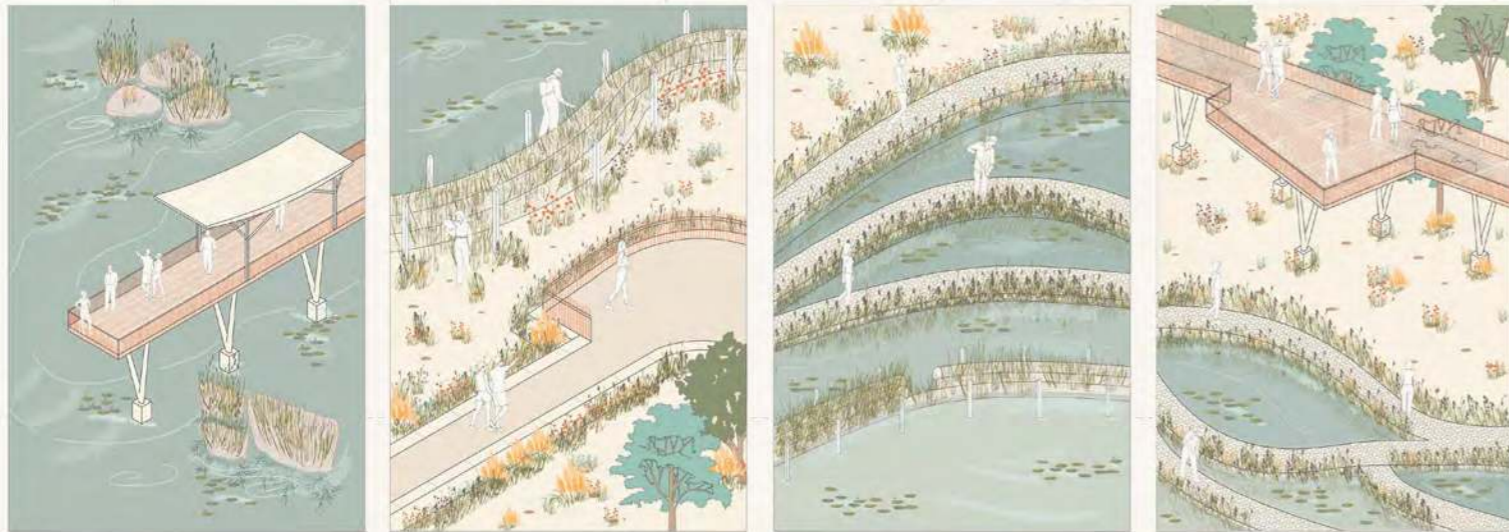
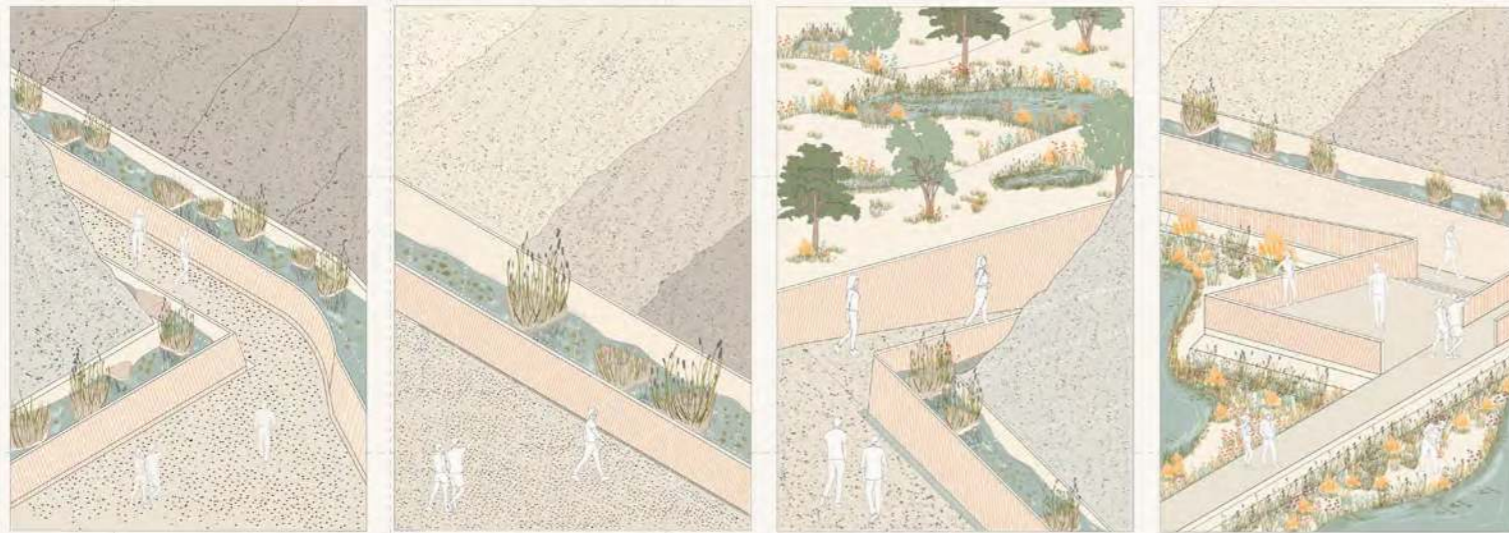

Imaginary

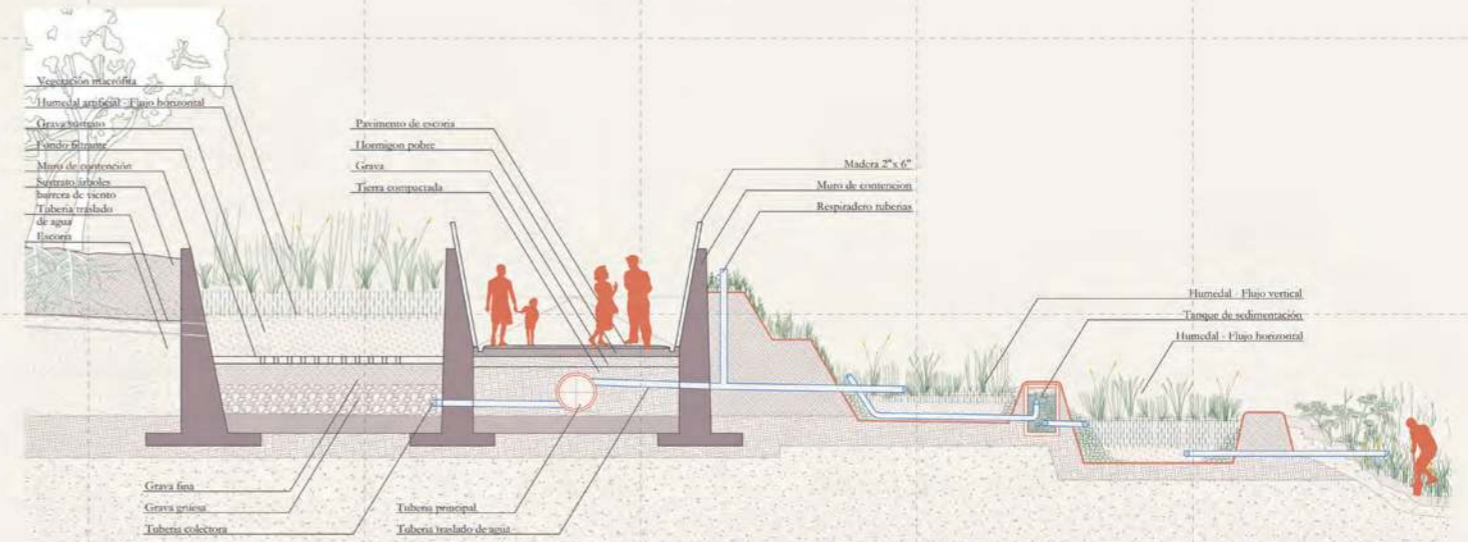

Underground trail and wetlands

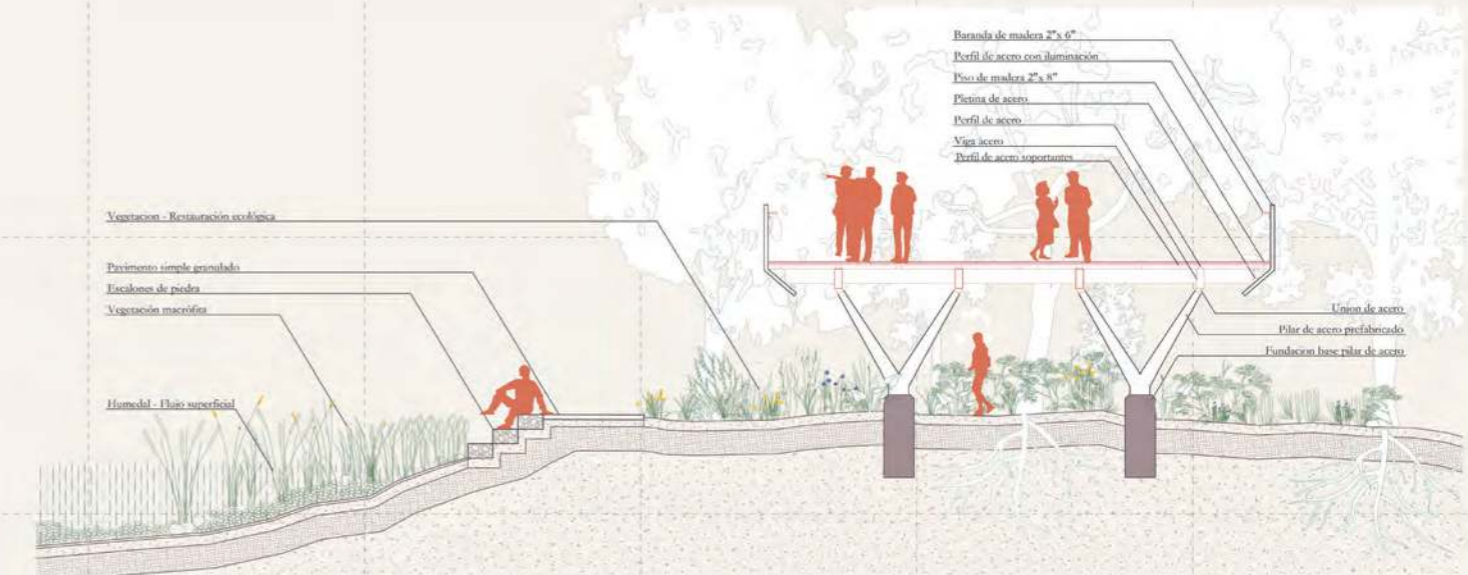

Elevated trail

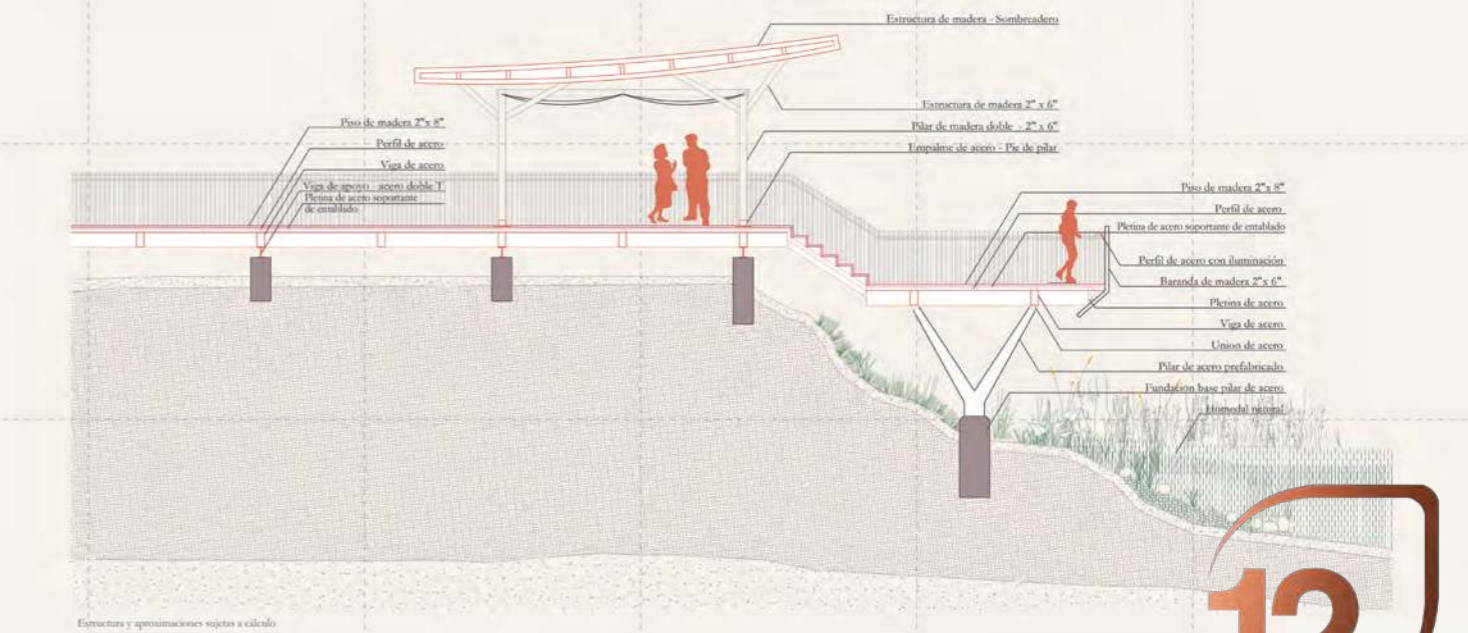

Estructura y optimizaciones sujetas a cálculo

Section details

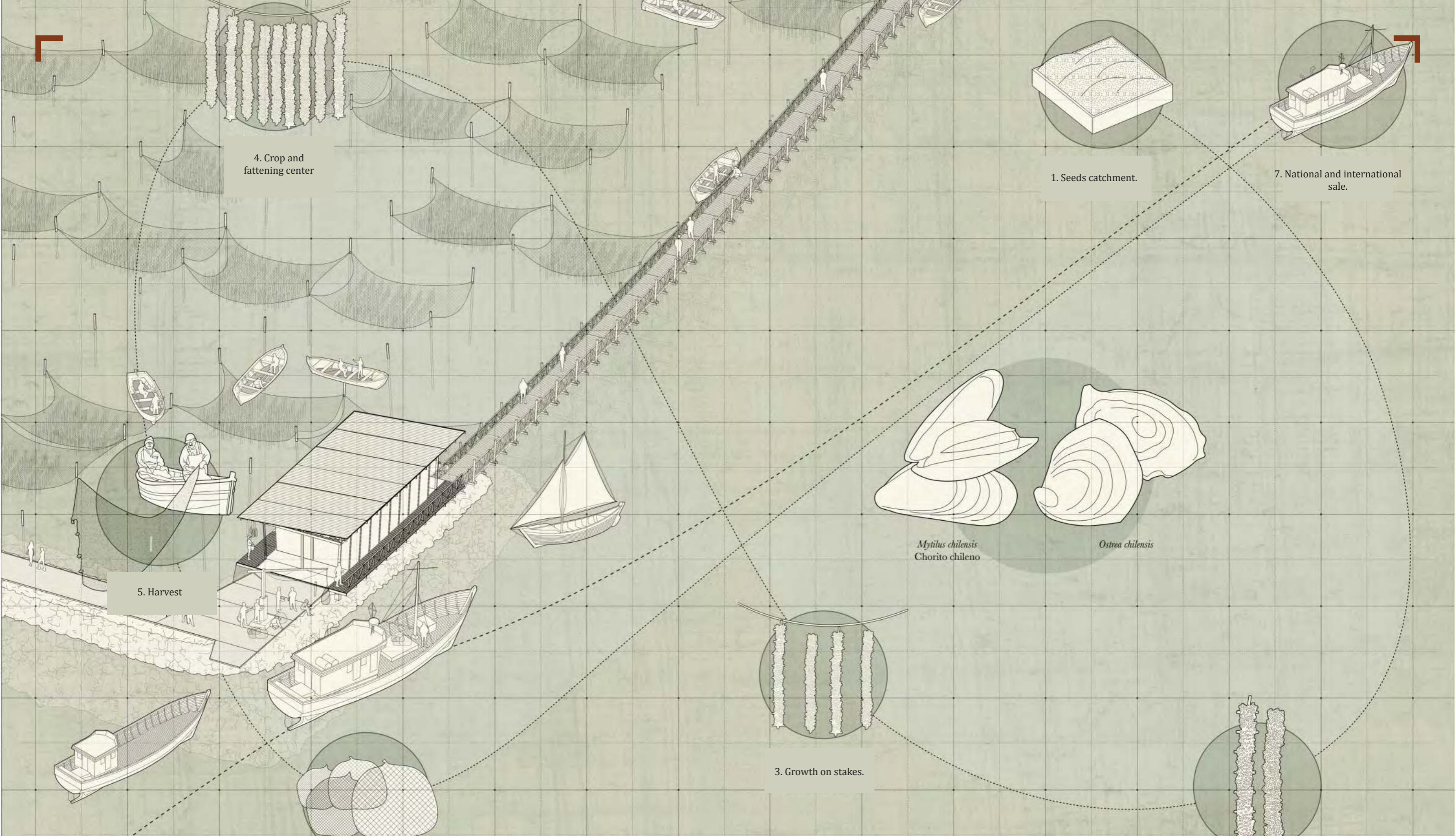

Country /City Chile, Santiago

University / School Pontificia Universidad Católica de Chile, Magíster en Arquitectura del Paisaje

Academic year 2020

Title of the project Productive and mitigation park on the the Caguach Island.

Authors Beltrán Lihn Gazitúa

## TECHNICAL DOSSIER

<b>Title of the project</b>	Productive and mitigation park on the the Caguach Island.
<b>Authors</b>	Beltrán Lihn Gazitúa
<b>Title of the course</b>	Graduation project workshop
<b>Academic year</b>	2020
<b>Teaching Staff</b>	Paula Aguirre and Gonzalo Schmeisser
<b>Department / Section / Program of belonging</b>	Magíster en Arquitectura del Paisaje - MAPA
<b>University / School</b>	Pontificia Universidad Católica de Chile



### Written statement, short description of the project in English, no more than 250 words

The Chiloé Archipelago, located in the Chilean region named Los Lagos, stands out for its unique geography of channels and islands that form an inland sea between the Big Island of Chiloé and the Andes Mountain range. This configuration has given rise to a culture deeply rooted in the interaction between land and sea, shaping the territory as a palimpsest throughout history. Chiloé presents itself as a distinctive cultural landscape, a "maritorium" where the culture has managed to "territorialize" the ocean through navigation and inhabitation along the coastline.

However, in recent decades, the Maritorium landscape has faced rapid political, communicational, and economic growth, displacing material and immaterial vestiges to the smaller and more isolated islands of the archipelago. The industrialization of aquaculture and the imbalances caused by global warming have led to a social and environmental crisis that threatens the sustainability of the Chiloé landscape. Therefore, it is urgent to implement measures to protect and revalue the Maritorium. In this context, this research aims to reveal the unique qualities of this landscape and its multiple layers, providing a projective basis to propose solutions to the current crisis through the study and work in the territory. This is done in pursuit of achieving the permanence and adaptation of the Maritorium to the current and future context.

For further information

**Máster d'Arquitectura del Paisatge - UPC**

Contact via email at:  
master.paisatge.comunicacio@gmail.com

biennal.paisatge@upc.edu

**Máster d'Arquitectura del Paisatge - UPC**

Sede ETSAB - Universitat Politècnica de Catalunya

Calle Jordi Girona, 15. Edificio Omega 1-3  
08034 Barcelona - Spain

COAC - Colegi oficial d'Arquitectes de Catalunya

Carrer Arcs, 1-3  
08002 Barcelona - Spain

**12th International Biennial Landscape Barcelona**

**Barcelona November 2023**

**SCHOOL PRIZE**

Topography around Chile

North zone

Central zone

South zone

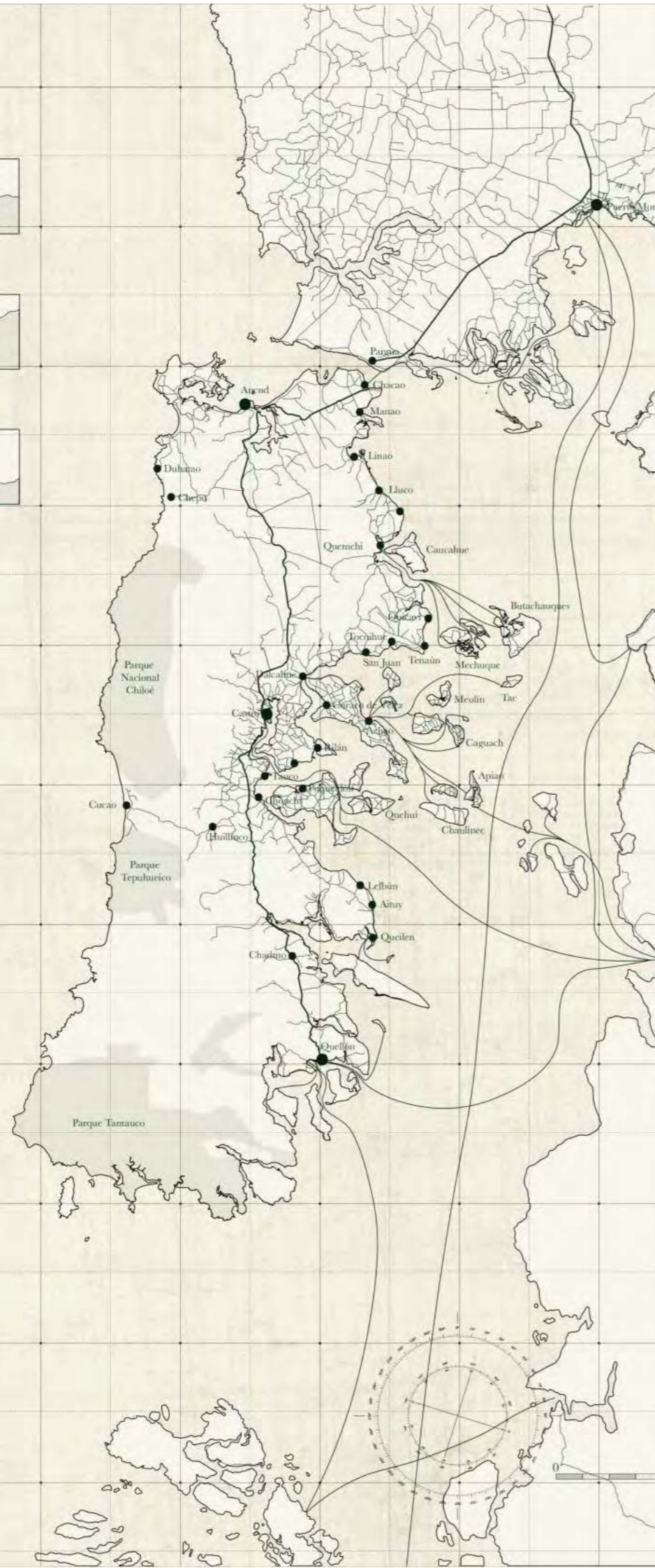

Chiloé Archipelago and its cultural elements



Interior sea palimpsests



Caguach Island, social and religious center



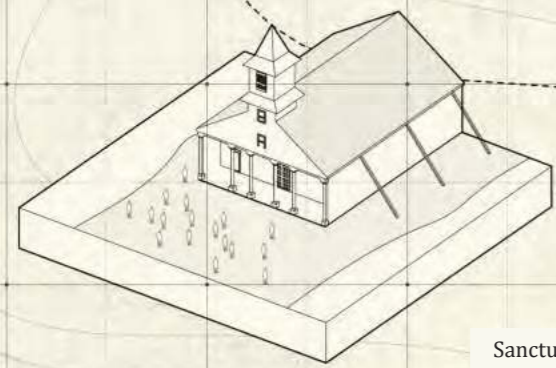

Sanctuary

Sanctuary and church  
Cemetery

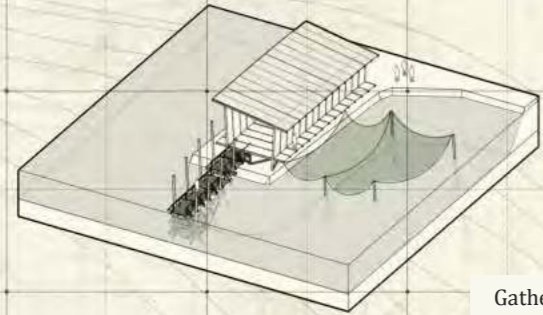

Gathering

Pier  
Shelters for Nazarene celebration

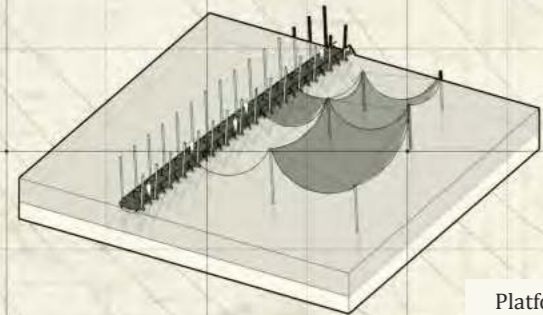

Platform

Isla Guachac corral

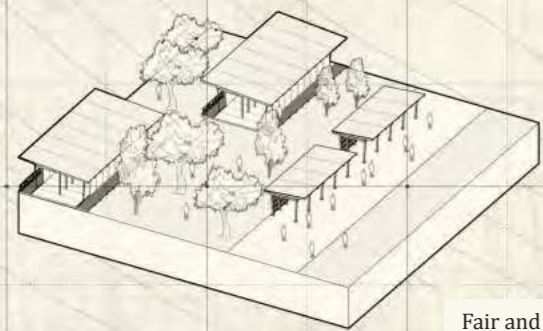

Fair and shelter

Isla Chaulinec corral

Isla Apiao corral

Ceremonial center and viewpoint

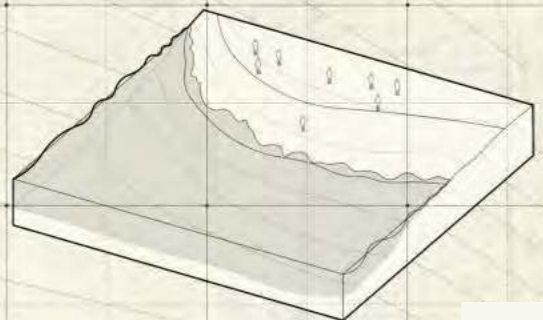

Productive and mitigation park

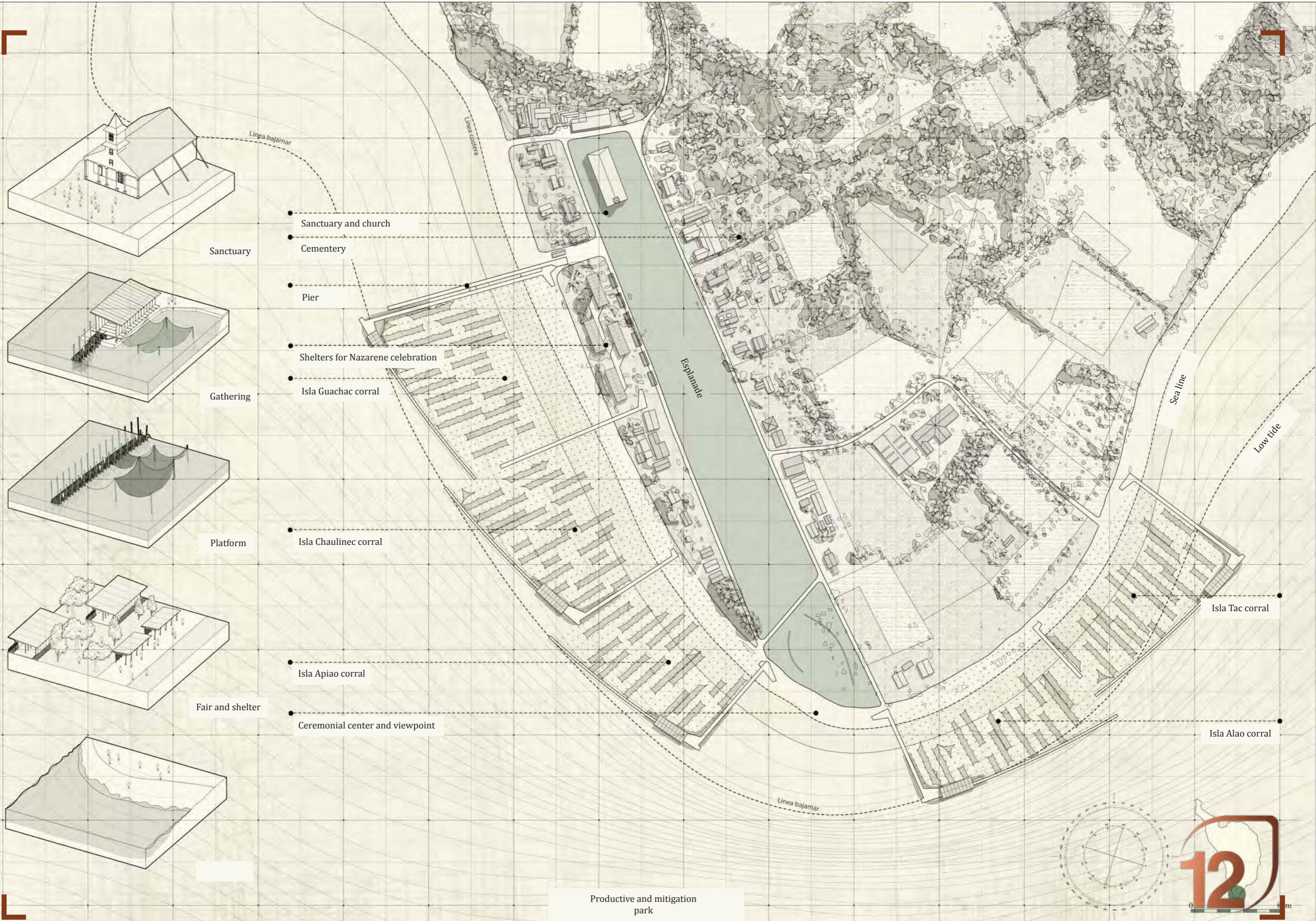

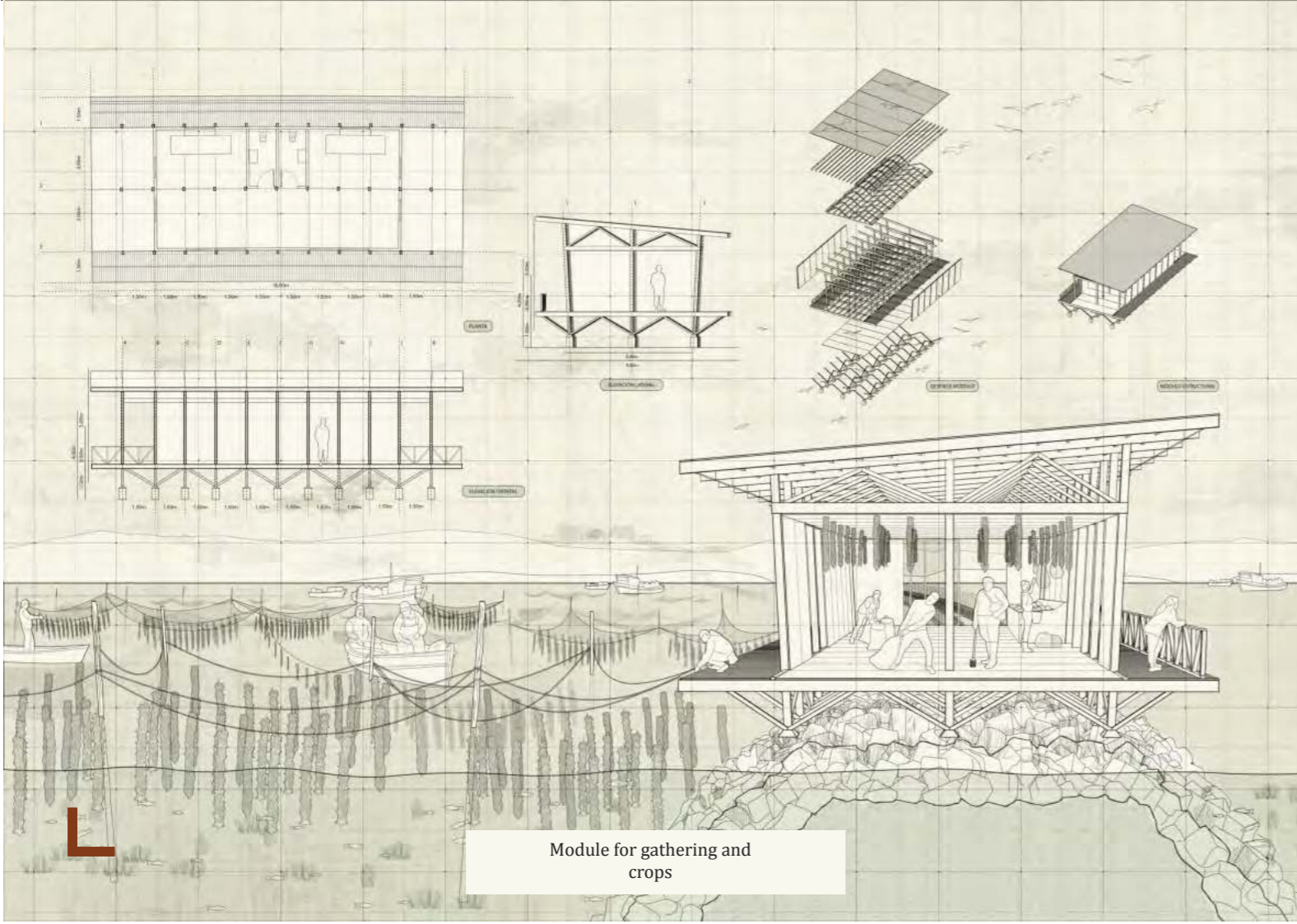
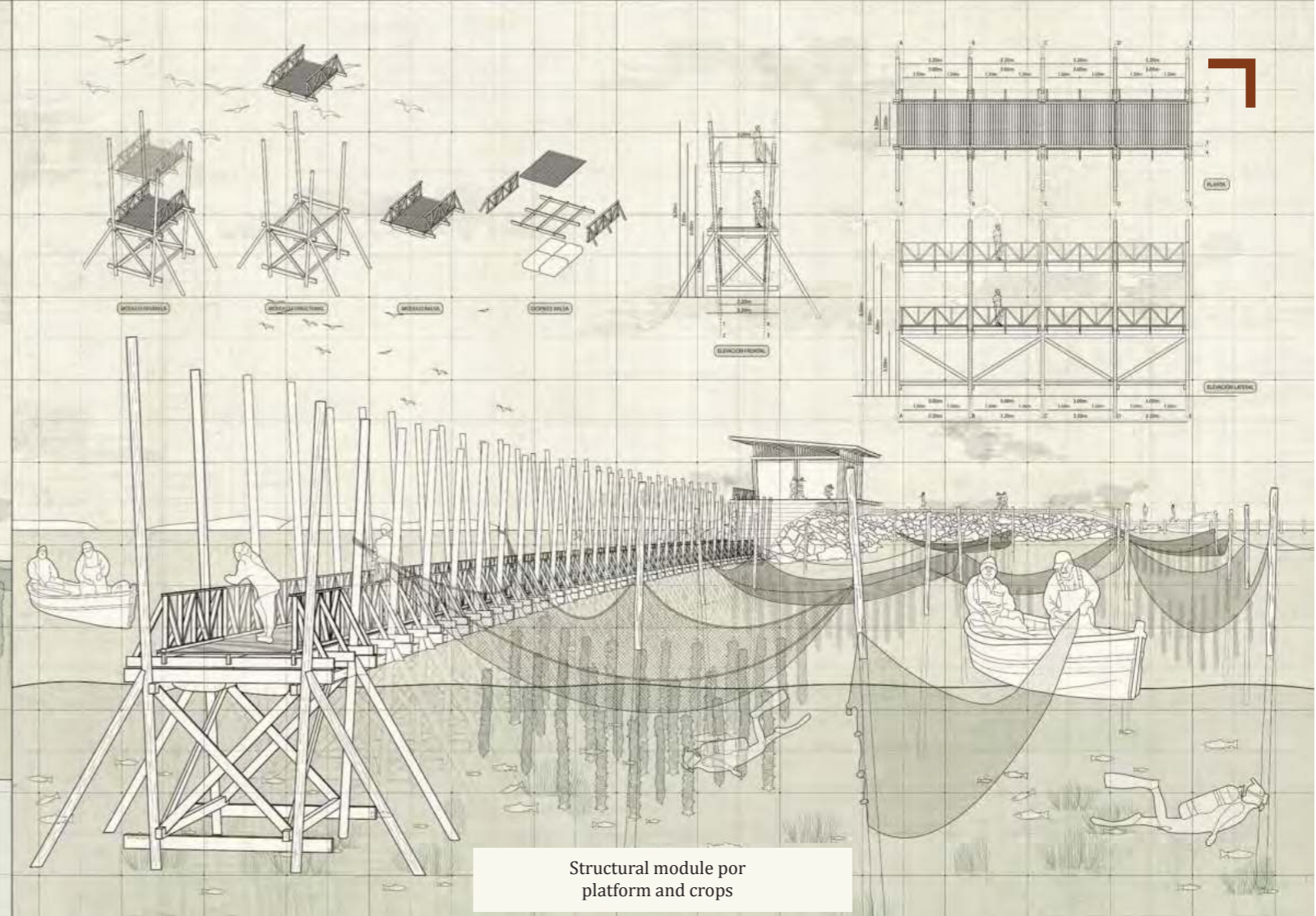
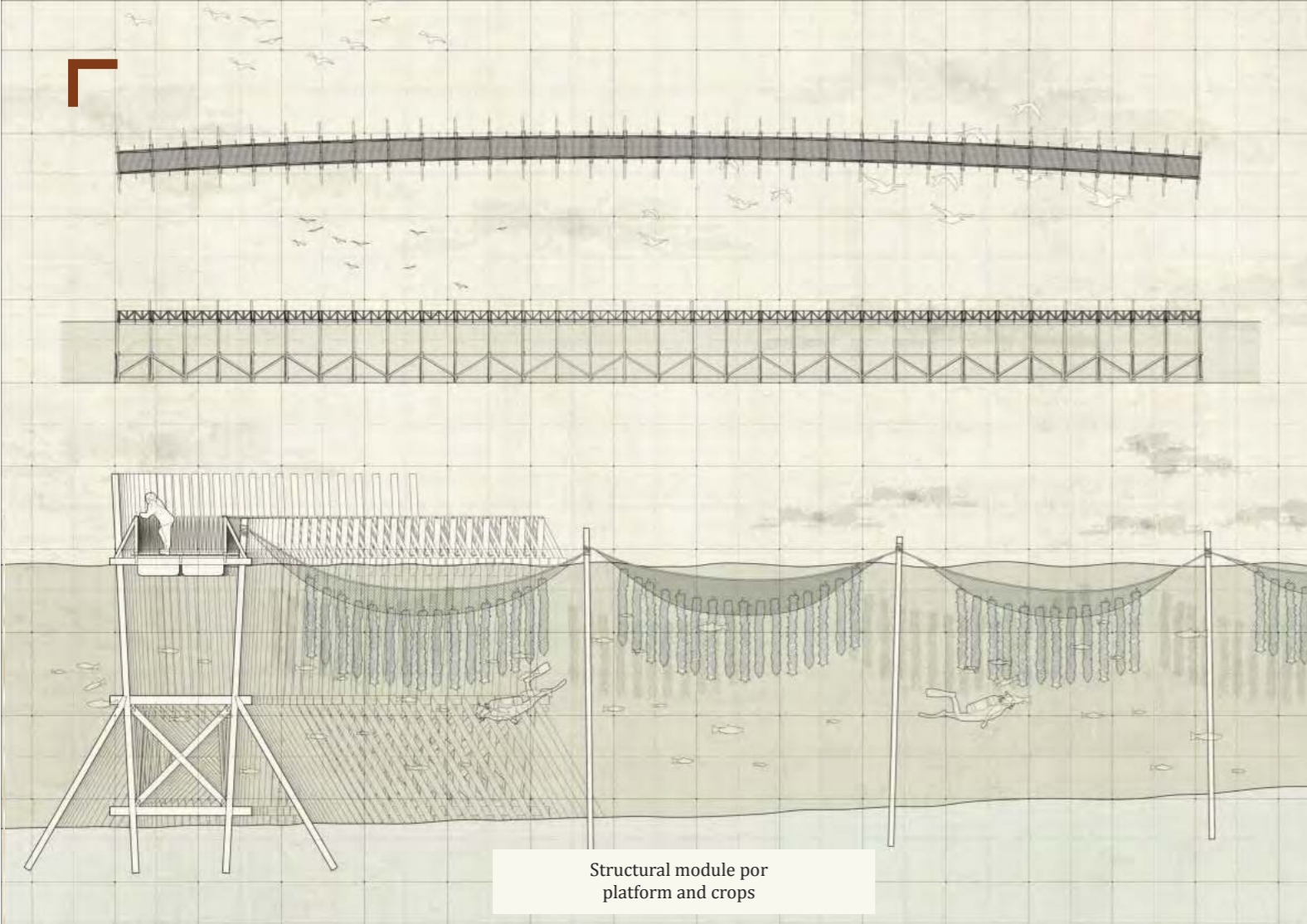

UNEXPLORED AREAS

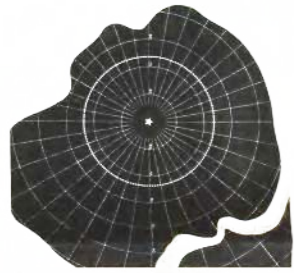

1760



1775

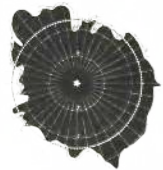

1821



1835



1845



1905

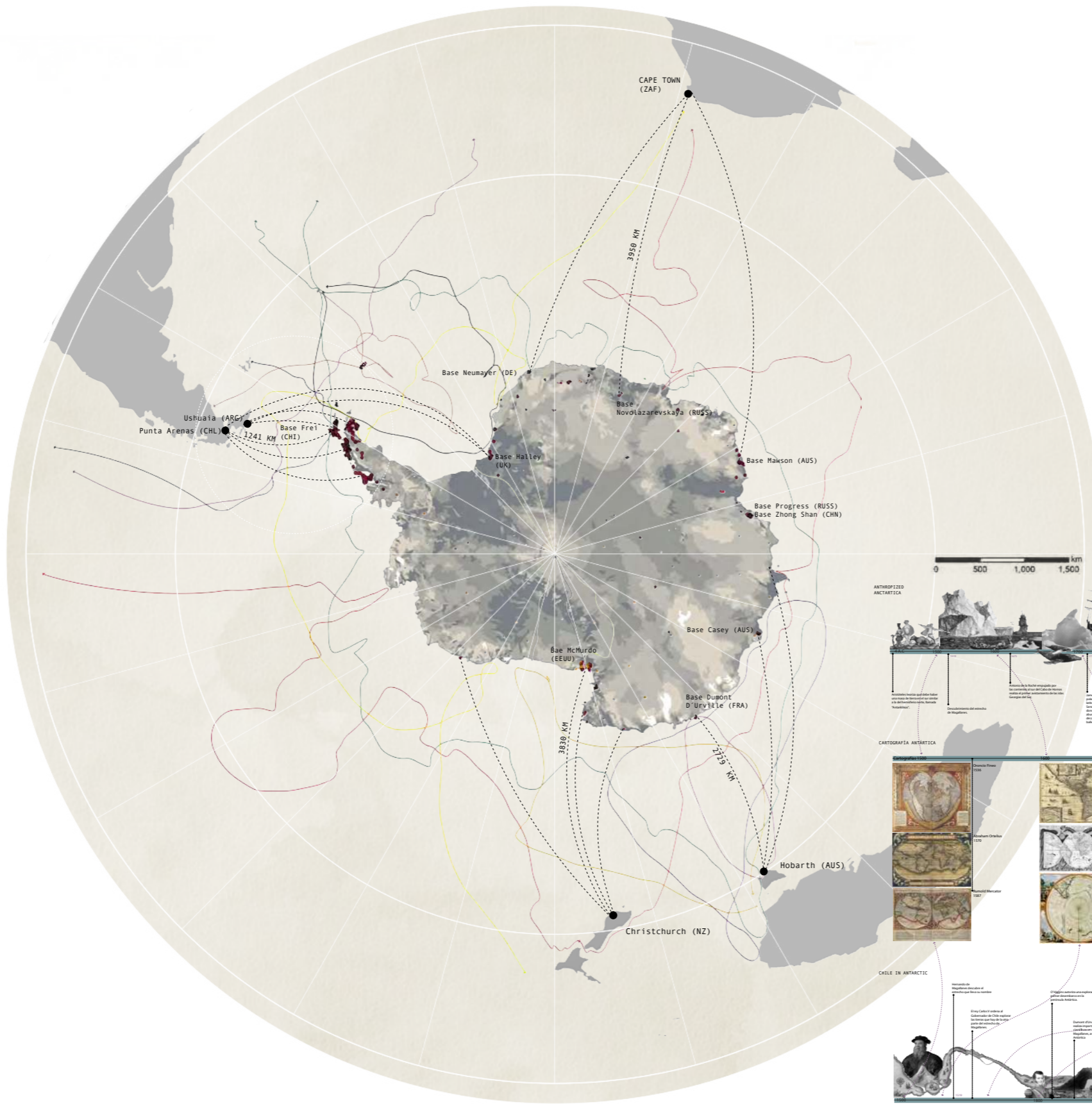

HEROIC EXPLORATIONS

- ANTHONY DE LA ROCHE 1675
- JAMES COOK 1772-74
- WILLIAM SMITH 1819
- BELLINGSHAUSEN 1819-21
- JAMES WEDDEL 1823-23
- DUMONT D'URVILLE 1839-40
- JAMES ROSS 1840-41
- CHARLES WILKES 1839-42
- AMUNDSEN 1911
- SCOTT 1911-12
- SHACKLETON 1914-16
- TRANS-ANTARCTIC 1958

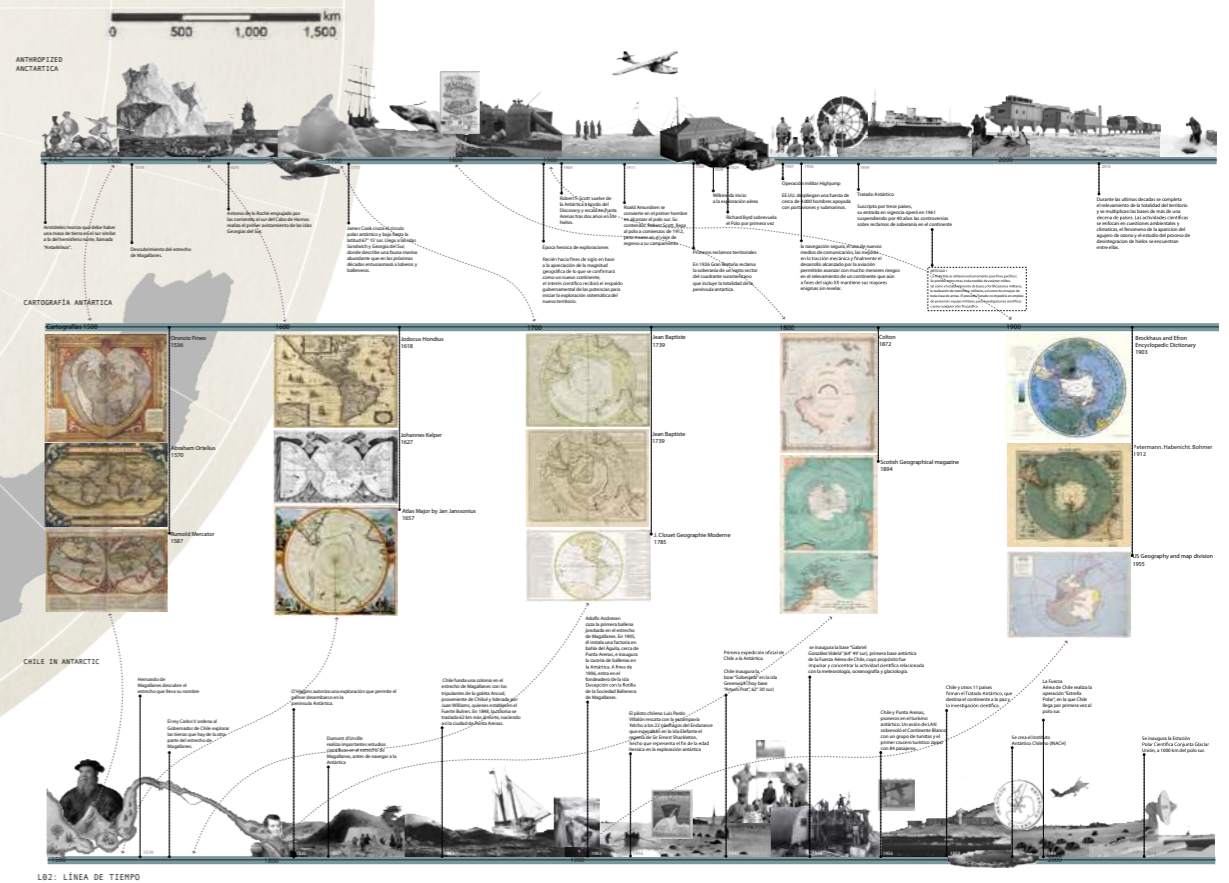

Country /City Chile, Santiago

University / School Pontificia Universidad Católica de Chile, Magíster en Arquitectura del Paisaje

Academic year 2020

Title of the project Visualization and valorization of the emerging meltwater landscape in Fildes Peninsula. Transfer park as an articulator of Antarctic dynamics.

Authors Pascale Mondión Klapp

## TECHNICAL DOSSIER

<b>Title of the project</b>	Visualization and valorization of the emerging meltwater landscape in Fildes Peninsula. Transfer park as an articulator of Antarctic dynamics.
<b>Authors</b>	Pascale Mondión Klapp
<b>Title of the course</b>	Graduation project workshop
<b>Academic year</b>	2020
<b>Teaching Staff</b>	Osvaldo Moreno and Arturo Lyon
<b>Department / Section / Program of belonging</b>	Magíster en Arquitectura del Paisaje - MAPA
<b>University / School</b>	Pontificia Universidad Católica de Chile



### Written statement, short description of the project in English, no more than 250 words

Antarctica is often imagined as a pristine, pure, and vast territory. Yet, since its discovery in the 18th century to the present, it has undergone intense infrastructure deployment and logistical movements. Contrary to the collective imagination, Antarctica is a highly anthropized territory marked by different traces related to its various stages of occupation: initially as a resource exploitation center, then as a site of sovereign interest and territorial claims, and finally as a reserved place for knowledge and scientific research. This work proposes the existence of a transversal layer independent of these traces, as crucial for rethinking the ways of inhabiting Antarctica: the layer of emerging meltwater landscape. This layer is characteristic of the continent's edges and is constantly expanding inland because of climate change. Its presence promotes the emergence and spread of new vegetation that will completely modify this landscape. Therefore, the project aims to define the emerging landscape based on its relationship with the existing traces in Antarctica, focusing on the case of Fildes Peninsula on King George Island, as it possesses the highest concentration of anthropic activity on the continent. Specifically, the proposal consists on a transfer park for the Frei Base on King George Island, that articulates the coexistence of a highly sensitive forming ground and the extremely invasive logistical movements currently taking place at the base.

For further information

**Máster d'Arquitectura del Paisatge - UPC**

Contact via email at:  
master.paisatge.comunicacio@gmail.com

biennial.paisatge@upc.edu

**Máster d'Arquitectura del Paisatge - UPC**

Sede ETSAB - Universitat Politècnica de Catalunya

Calle Jordi Girona, 15. Edificio Omega 1-3  
08034 Barcelona - Spain

COAC - Colegi oficial d'Arquitectes de Catalunya

Carrer Arcs, 1-3  
08002 Barcelona - Spain

**12th International Biennial Landscape Barcelona**

**Barcelona November 2023**

**SCHOOL PRIZE**

# ANCTARTIC LOGISTICS | PENINSULA

- BASES
- AIR ROUTES
- SEA ROUTES
- ANCTARTIC PROGRAMS THAT OPERATE THROUGH:
- USHUAIA:
  - ARGENTINA
  - EEUU
  - ITALIA
  - NUEVA ZELANDIA
- PUNTA ARENAS:
  - (51% de los países consultivos del Tratado Antártico)
  - CHILE
  - USA
  - SPAIN
  - KOREA
  - GERMANY
  - CHINA
  - UK
  - BRAZIL
  - RUSSIA
  - URUGUAY
  - ECUADOR
  - PERU
  - UKRAINE
  - CZECH REPUBLIC
  - BULGARIA

NAVY SHIPS, INACH (public)  
 TOURISM OPERATORS (private)

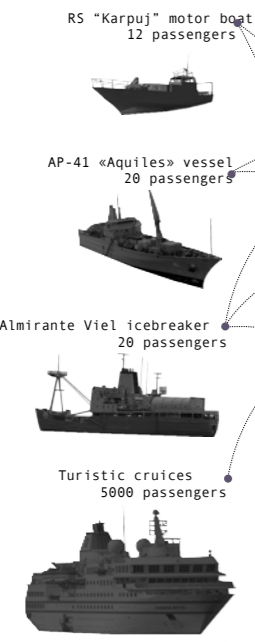

## SERVICES

- LOAD (energy, food, materials, waste)
- CIENTIFIC PERSONEL
- TOURISM TRIPS
- INVESTIGATION ACTIVITIES
- MEDICAL CARE

FACH, FAU and FAB airplanes (public) and DAP (private)

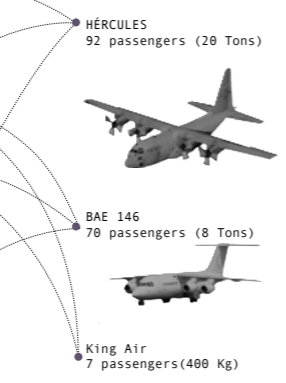

- Intercontinental airfield
- Bases
- Air routes
- "FOOTPRINT" ( ± SD)
  - 40 +
  - 30-39.9
  - 20-29.9
  - 10-19.9
  - 0-9.9

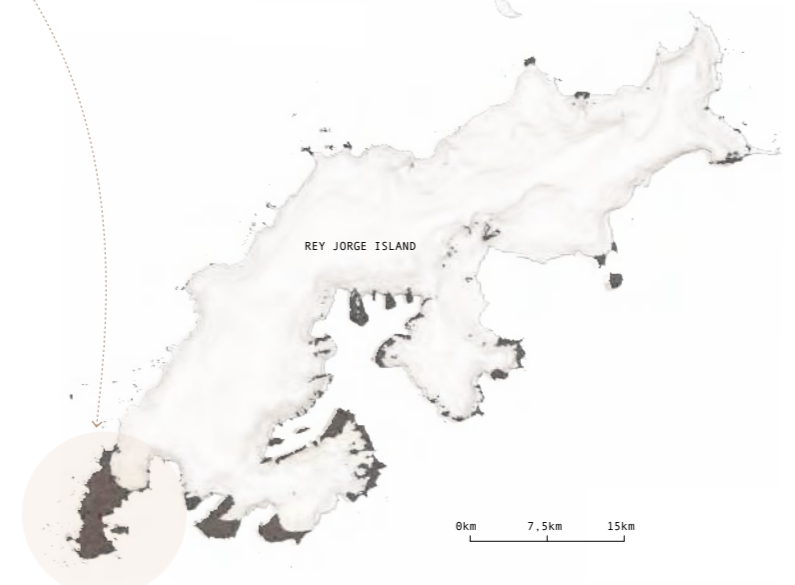
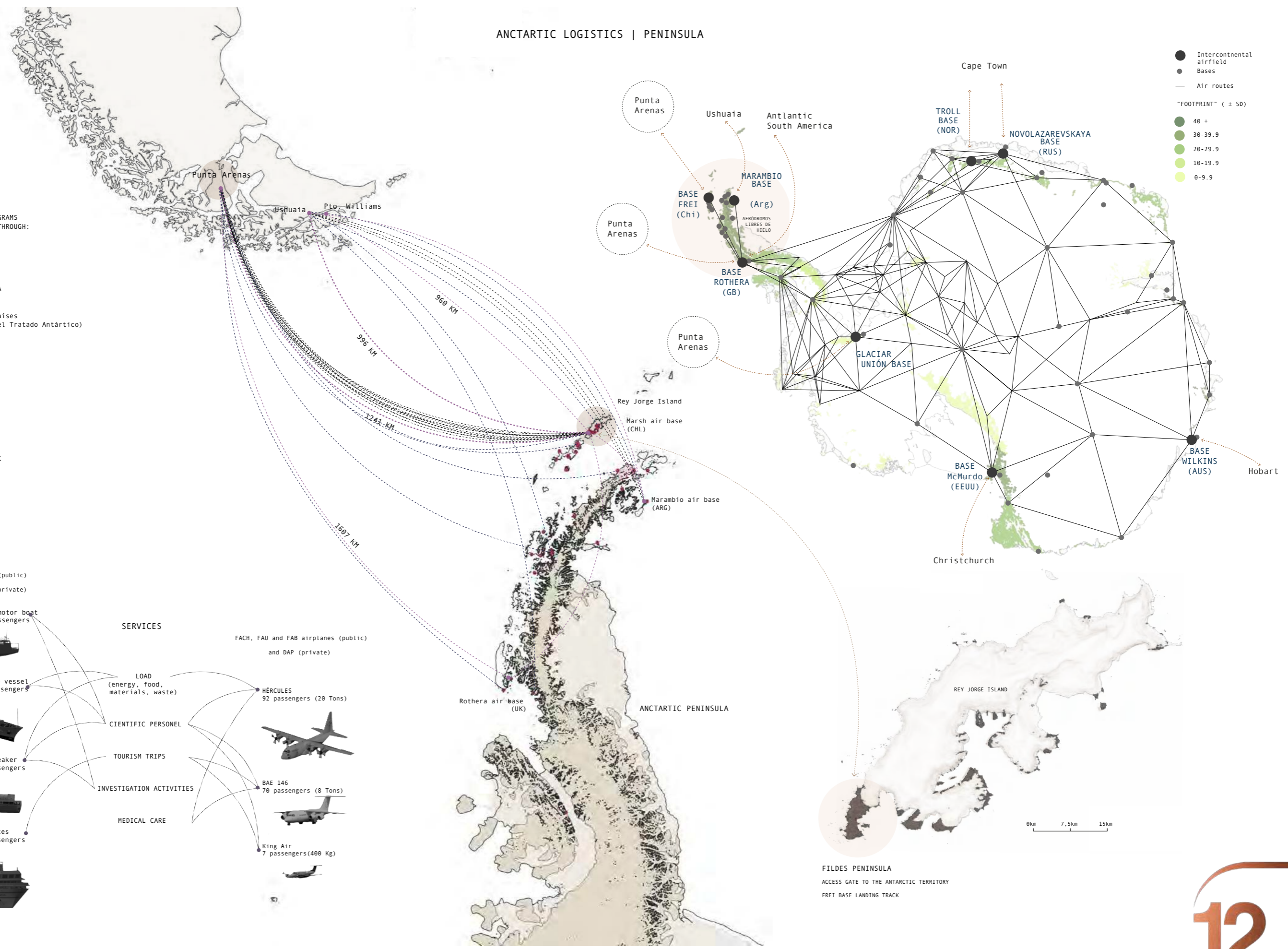

FILDES PENINSULA

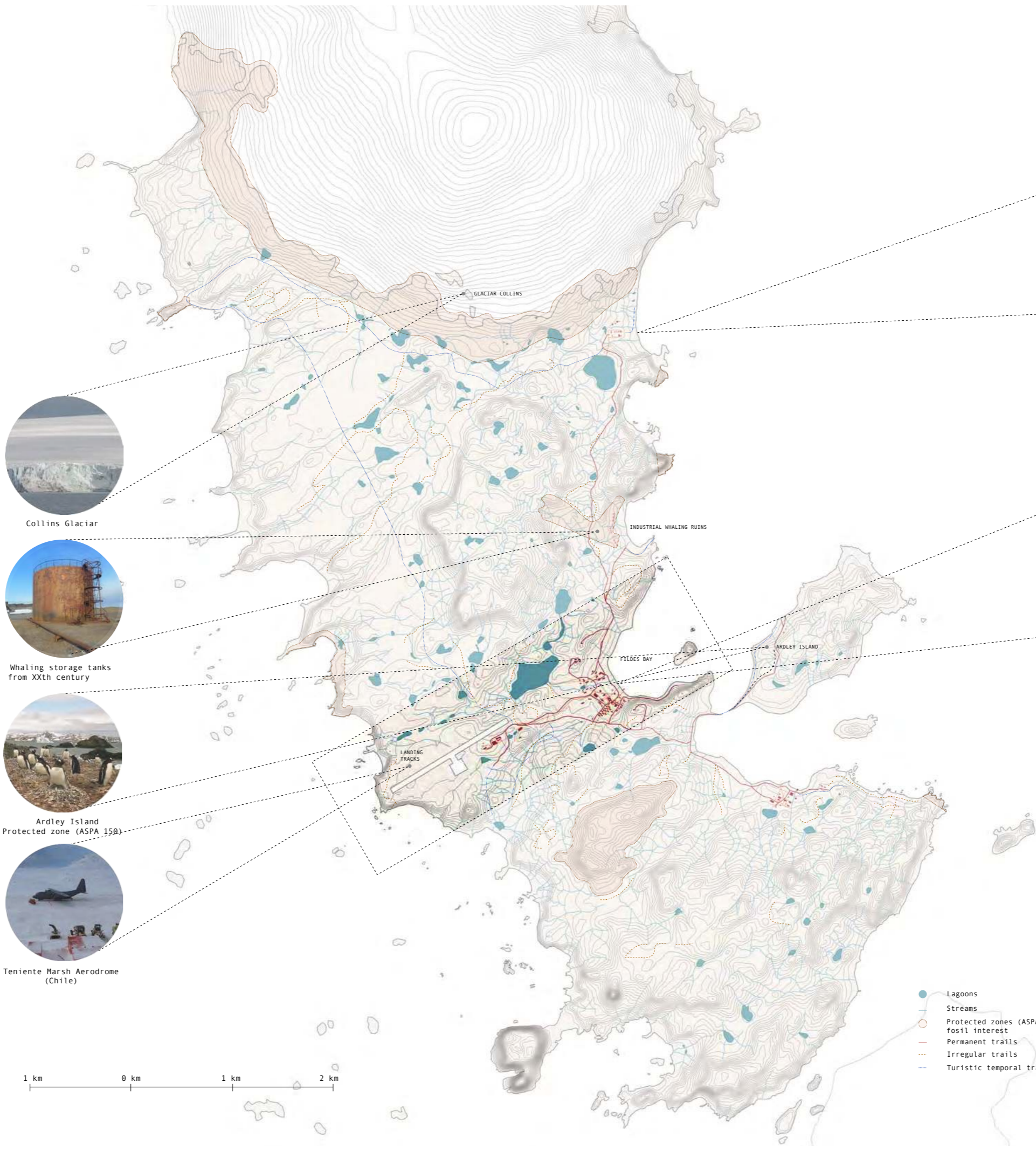
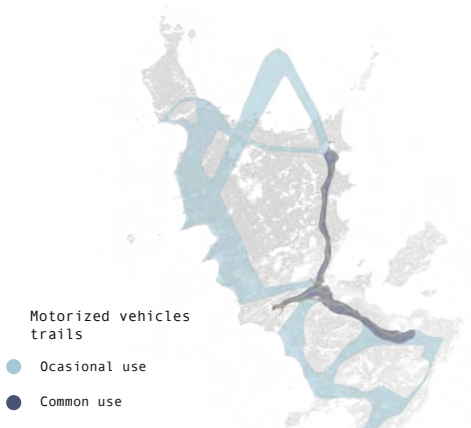
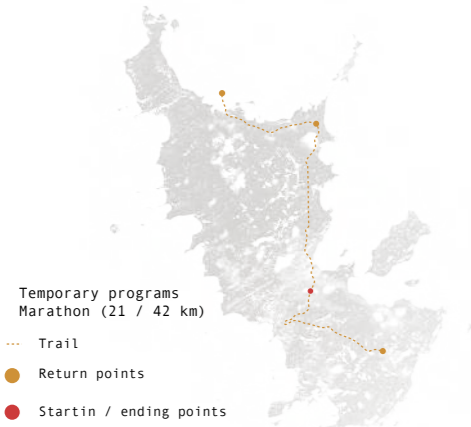
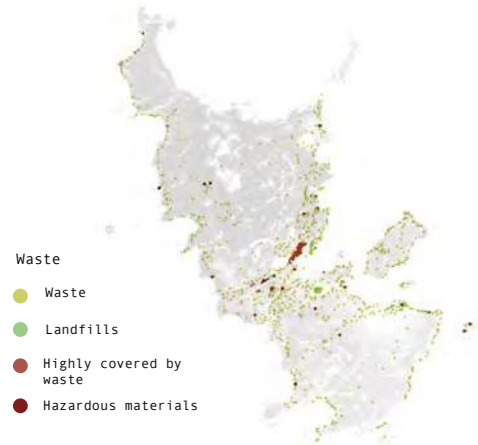
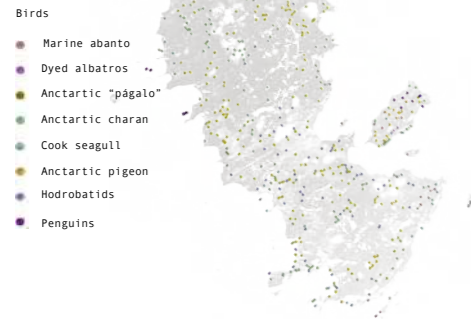

Collins Glaciar



Whaling storage tanks from XXth century



Ardley Island Protected zone (ASPA 150)



Teniente Marsh Aerodrome (Chile)

BASE ARTIGAS / Permanente (Uruguay)  
Capacidad personas: 60 verano / 9 invierno



BELLINGSHAUSEN BASE / Permanent (Rusia)  
People capacity: 38 summer / 25 winter



FREI BASE / Permanent (Chile)  
People apacity: 150 summer/ 80 winter



GREAT WALL BASE / Permanent (China)  
People capacity: 40 summer/ 14 winter



- Lagoons
- Streams
- Protected zones (ASPA 125) fossil interest
- Permanent trails
- Irregular trails
- Turistic temporal trails

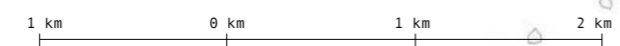

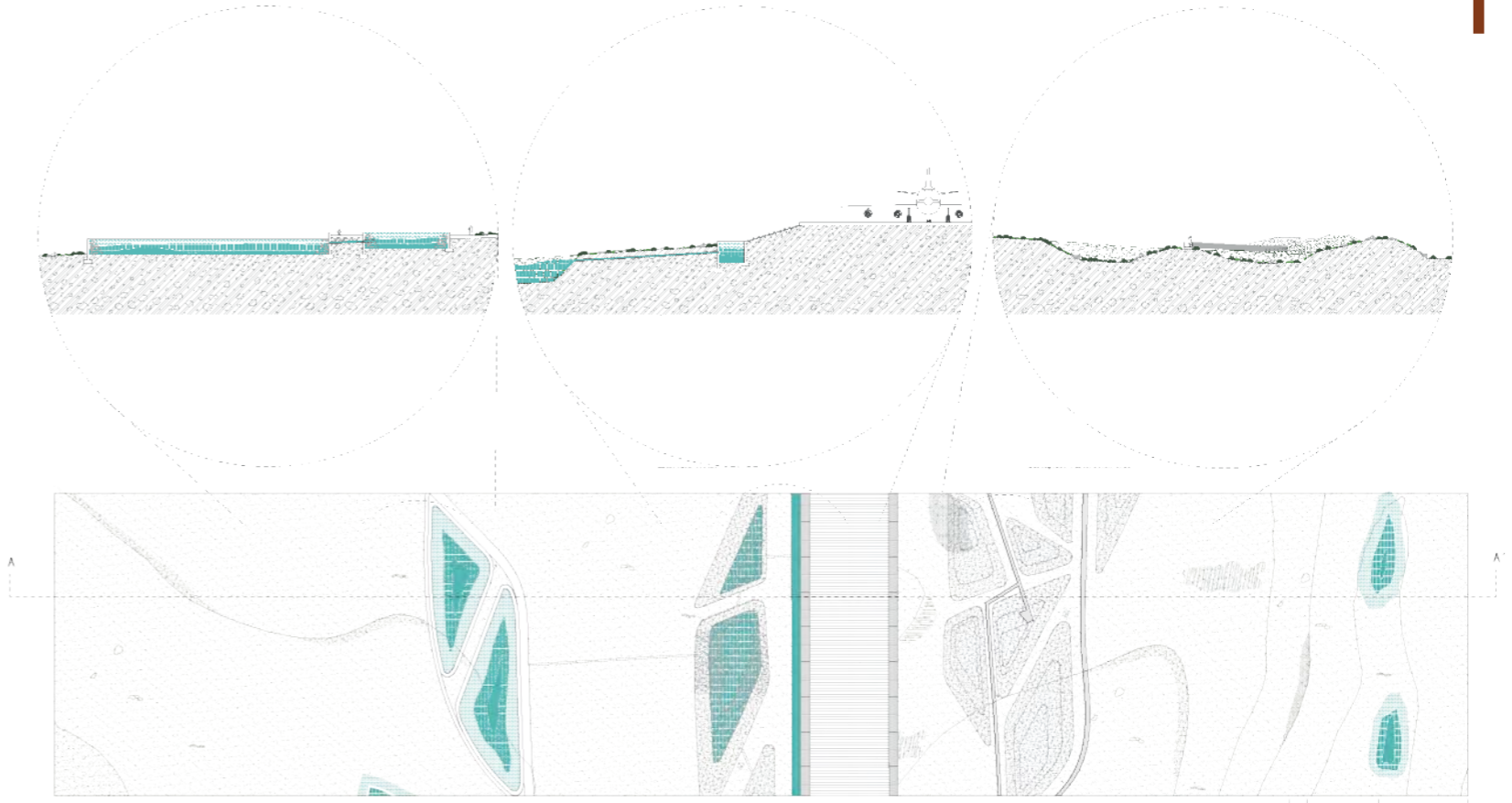

SNOWMELT EMEGMENT LANDSCAPES / Fildes Peninsula

LANDSCAPE UNITS /



heterogeneous mosses and liquiens

mossy and homogeneous matress

mosses and lichens attached to rocks

terrestrial and snow algae

MARINE COASTAL EDGE

FRESH WATER COURSES

ROCK CAMPS

GLACIAL EDGES

DUMP SOIL

DRY SOIL

FROZEN FLOORS

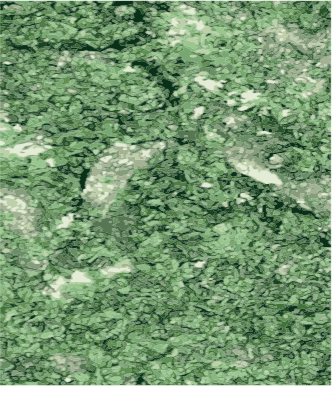
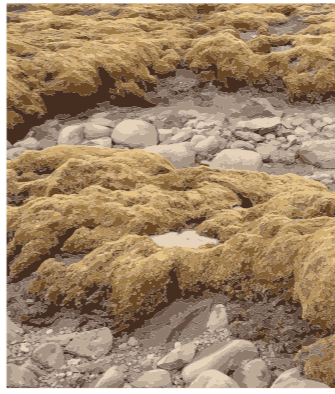
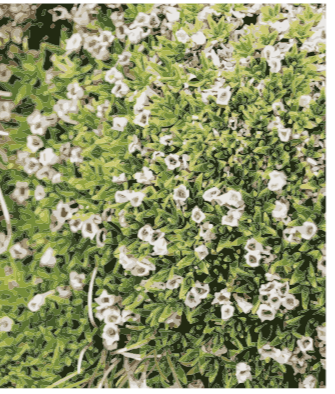

**WATER BEACH PARK ON ISLA MAIPO**  
LANDSCAPE ARCHITECTURE PROJECT

STRATEGIES DIAGRAMS

PROJECT PLAN

TOPOGRAPHIC WORK



a) River borders redefinition upon topographic modelation.

- 1. Redefinition of the urban border
- 2. Lagoon modeling
- 3. Topographic pattern for the natural succession of the river
- 4. Seasonal wetlands modeling



b) Interior patches ecological recovery and programatic activation.

- 1. Phytodepuration
  - a. Rain water filters
  - b. Primary, secondary and tertiary treatment
  - c. Complementary treatment (wetlands)
- 2. Public beach
- 3. Natural buffer
  - a. Urban buffer and tree lined avenue
  - b. Identitary vegetation
  - c. Riparian woods restoration
  - d. Water purifying plants
  - e. Wetland vegetation



c) Itineraries and circuits around the water.

- 1. Programatic border: streams and irrigation ditches
- 2. Interior trails: lagoons and vegetation patches
- 3. River border promenade: river and geographical context

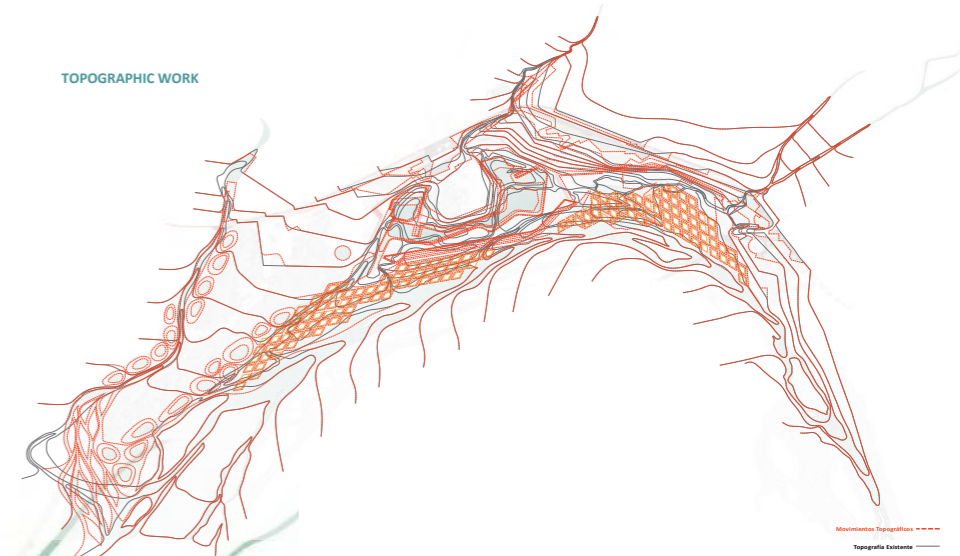
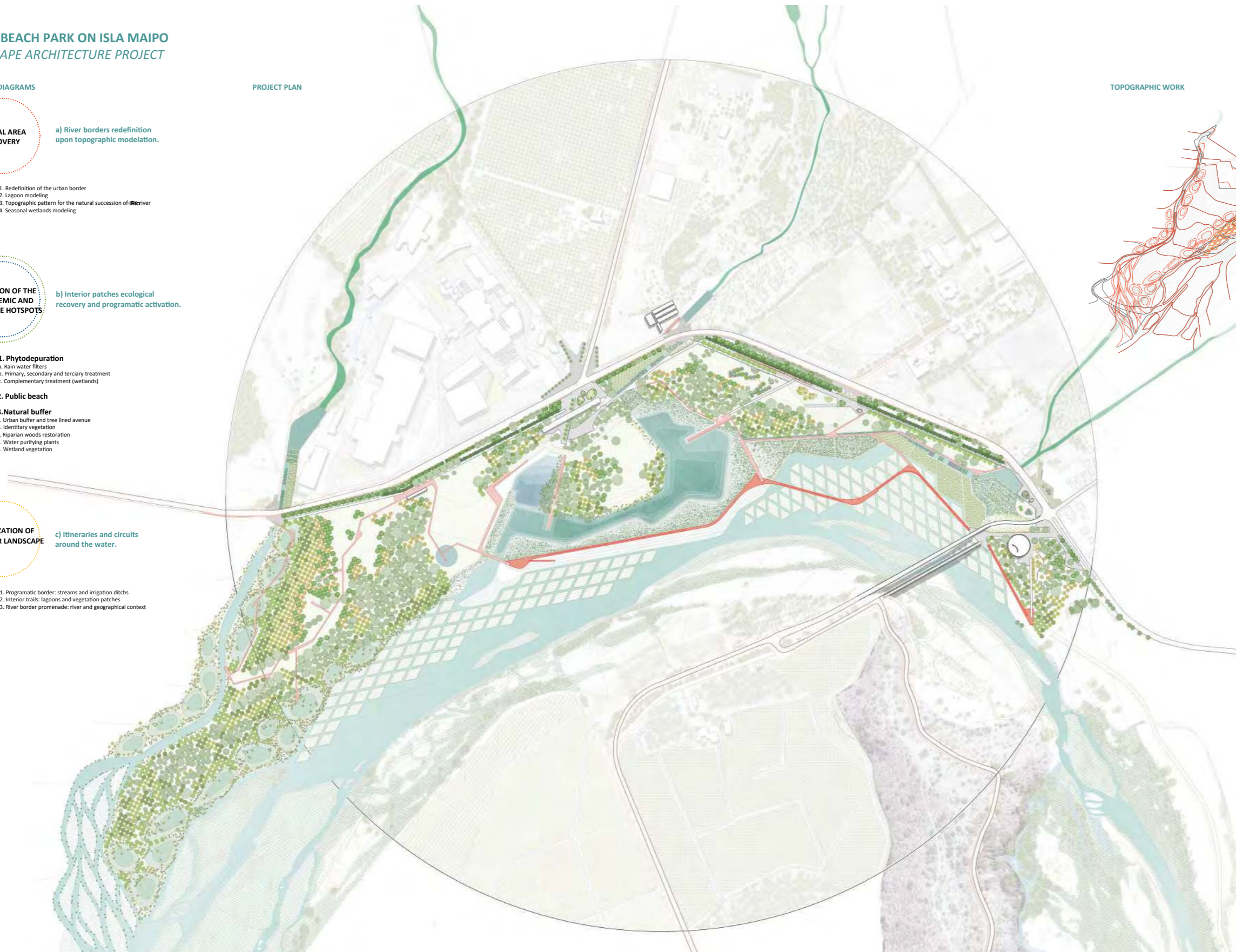

Country / City Chile, Santiago

University / School Pontificia Universidad Católica de Chile, Magíster en Arquitectura del Paisaje

Academic year 2021

Title of the project Revalorization of a Woven Landscape at the Downstream Confluence. Water Routes and Park in Isla de Maipo.

Authors Aníbal Andrés Retamal Espinoza



## TECHNICAL DOSSIER

**Title of the project** Revalorization of a Woven Landscape at the Downstream Confluence. Water Routes and Park in Isla de Maipo.  
**Authors** Aníbal Andrés Retamal Espinoza  
**Title of the course** Graduation project workshop  
**Academic year** 2021  
**Teaching Staff** Sandra Iturriaga Del Campo  
**Department / Section / Program of belonging** Magíster en Arquitectura del Paisaje - MAPA  
**University / School** Pontificia Universidad Católica de Chile



### Written statement, short description of the project in English, no more than 250 words

The confluence of the Mapocho and Maipo rivers encompasses a territory on the outskirts of Santiago, where physical and operational events of a territorial-scale confluence shape a unique space where ecological, cultural, and landscape variables stand out within the basin.

This geographic enclave mediated by water, forms a complex river system that shapes a way of inhabiting and interacting with the territory, where human variables and ecological processes are linked to the fabric of water.

However, the neglect of this network of rivers, streams, and channels, places this landscape in a condition of fragility, where pressures such as unplanned urban expansion and water pollution contrast with the inherent landscape and ecosystem value of this woven network of diverse river corridors.

Thus, Isla de Maipo positions itself as a site of opportunity within the confluence, where the diversity of the water fabric and its fragilities multiply, requiring the application of a strategic design that reconsiders the role of river corridors and confluence areas, as catalysts for change in the face of a degraded and fragmented landscape through landscape infrastructures.

For further information

**Máster d'Arquitectura del Paisatge - UPC**

Contact via email at:  
master.paisatge.comunicacio@gmail.com

biennal.paisatge@upc.edu

**Máster d'Arquitectura del Paisatge - UPC**

Sede ETSAB - Universitat Politècnica de Catalunya

Calle Jordi Girona, 15. Edificio Omega 1-3  
08034 Barcelona - Spain

COAC - Colegi oficial d'Arquitectes de Catalunya

Carrer Arcs, 1-3  
08002 Barcelona - Spain

**12th International Biennial Landscape Barcelona**

**Barcelona November 2023**

**SCHOOL PRIZE**

**SELECTION OF THE PROJECT AREA**

**1. Confluence areas as ecosystemic hotspots**

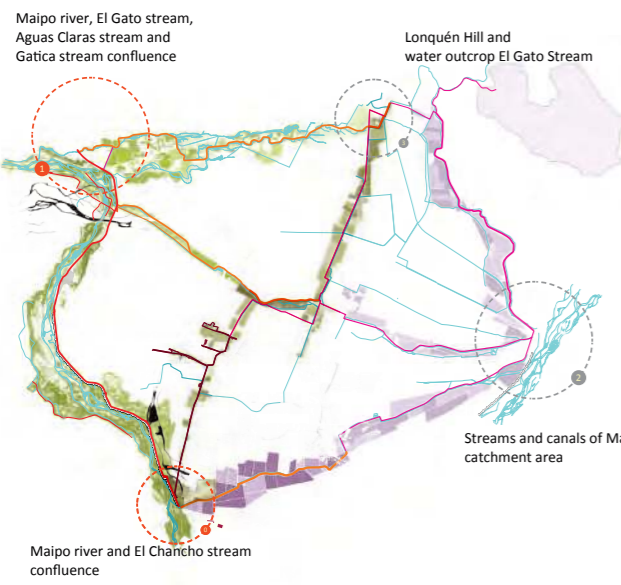

**2. Economical alterations over confluence areas**

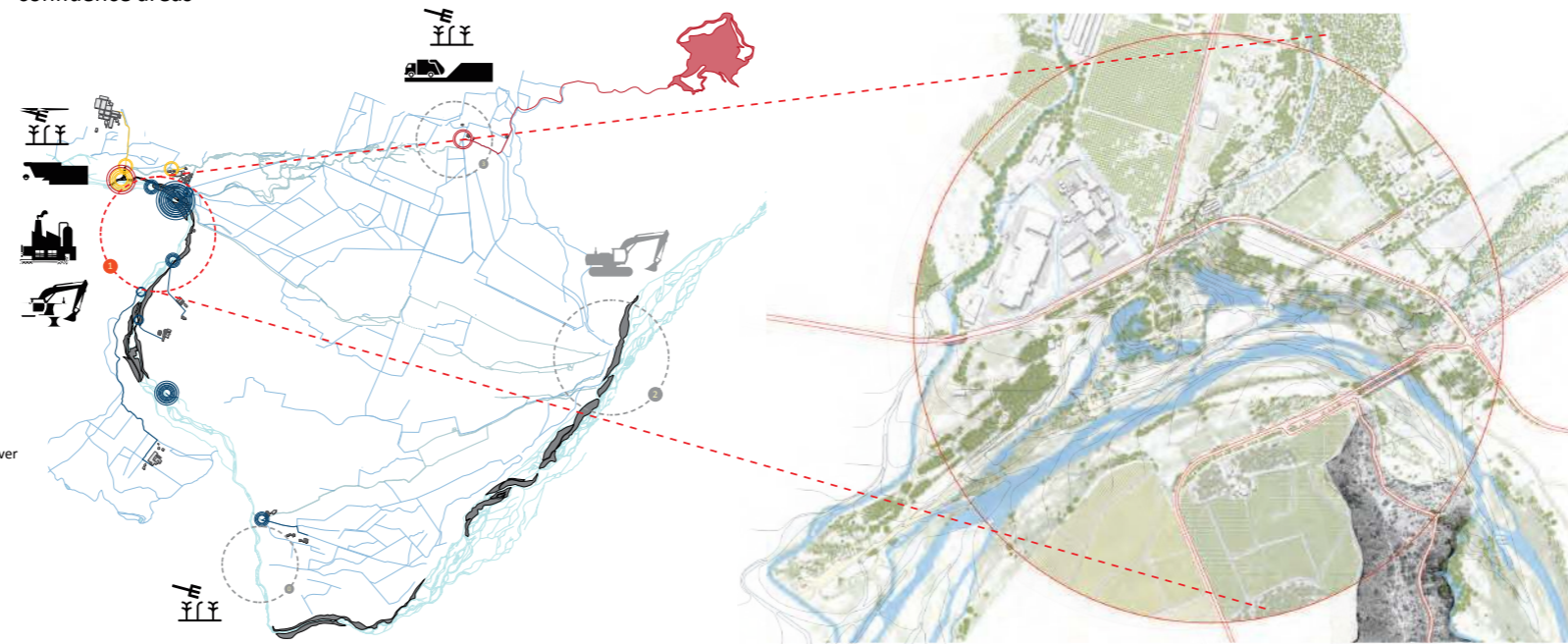

**3. Water forms of confluence areas / Selected area**

**WATER ROUTES AND CIRCUITS**

**ISLA MAIPO WATER ROUTE  
CANAL ROUTES  
Viticulture hill and valley circuit**

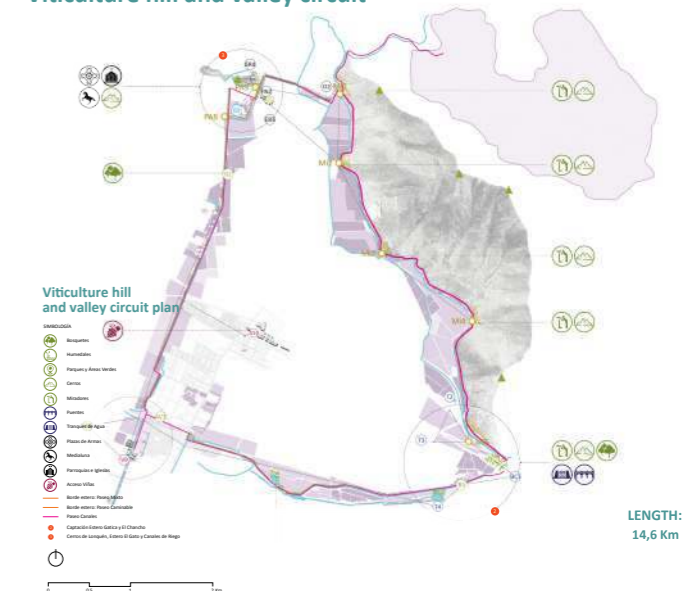

**WATER ROUTES AND CIRCUITS**

**ISLA MAIPO WATER ROUTES  
RIVER AND STREAM ROUTE  
Island circuit**



**ISLA MAIPO WATER ROUTE  
RIVER AND STREAM ROUTE  
El Gato - Aguas Claras stream  
beach circuit**



**ISLA MAIPO WATER ROUTE  
CANAL ROUTE  
Vineyards circuit**



# WATER BEACH PARK ON ISLA MAIPO

## DECOMPOSITION

### Water

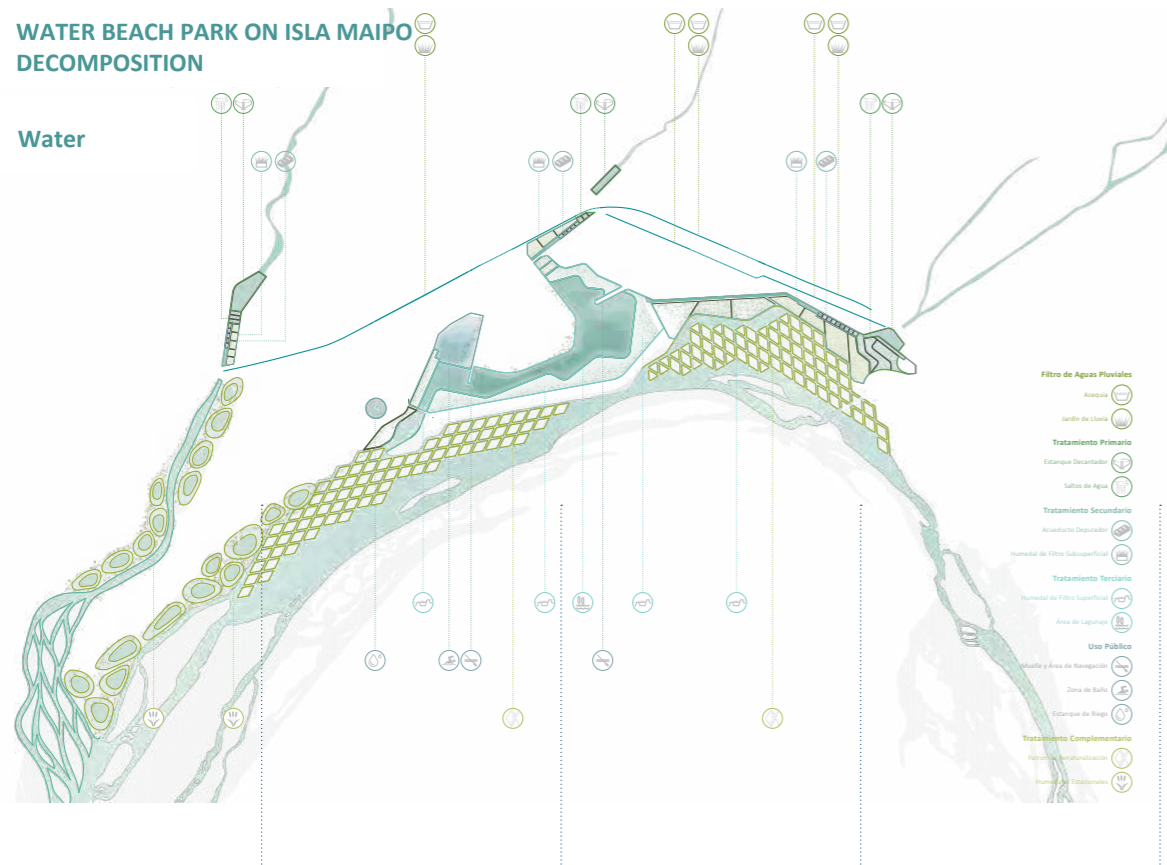

### Circulations

#### River promenade | River and geographical context

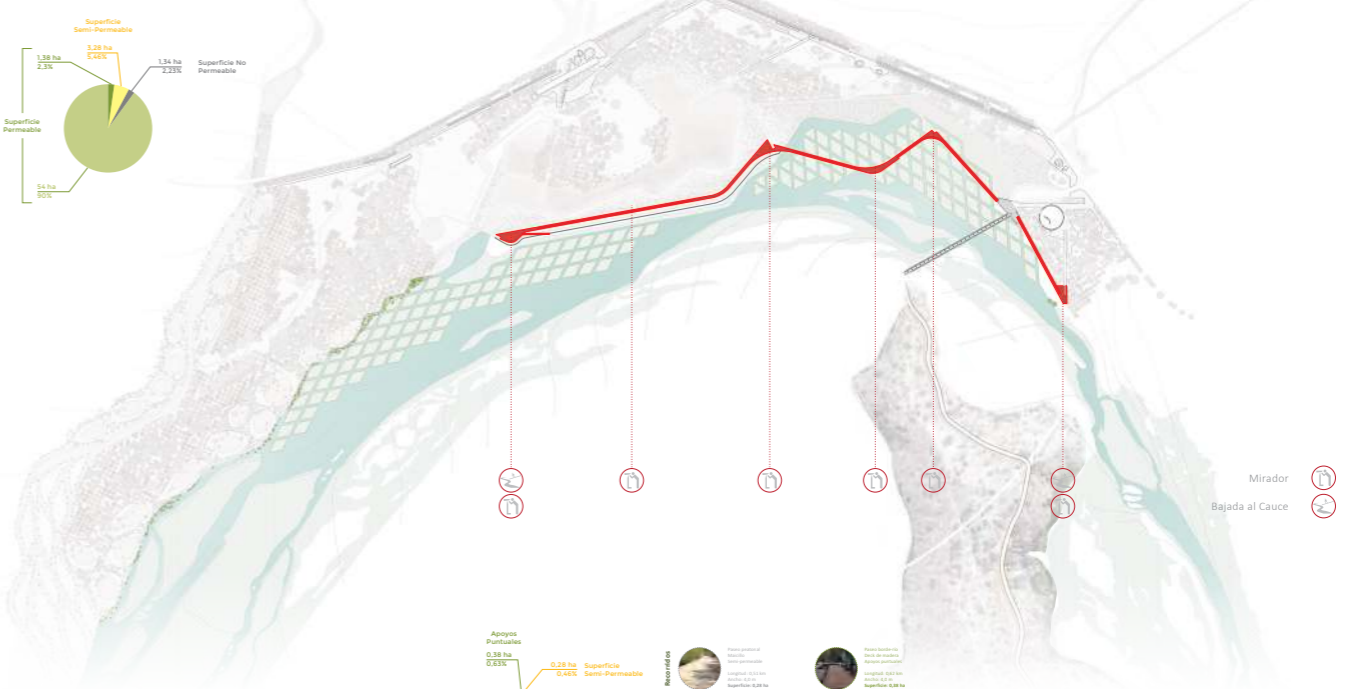

### Materials diagram



### Vegetation



### Constructive details

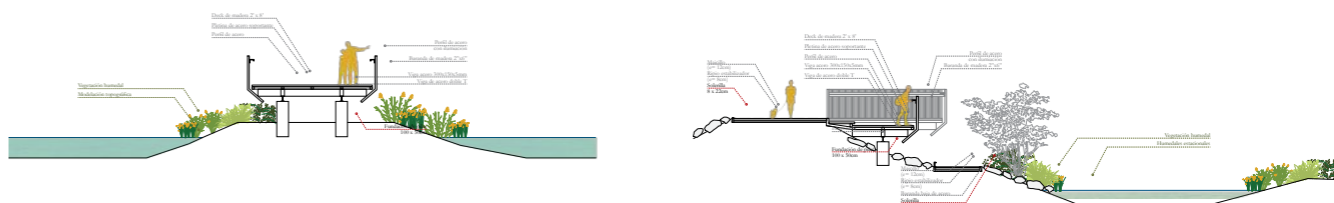

## Circulations

Interior trails | Lagoons and vegetation patches

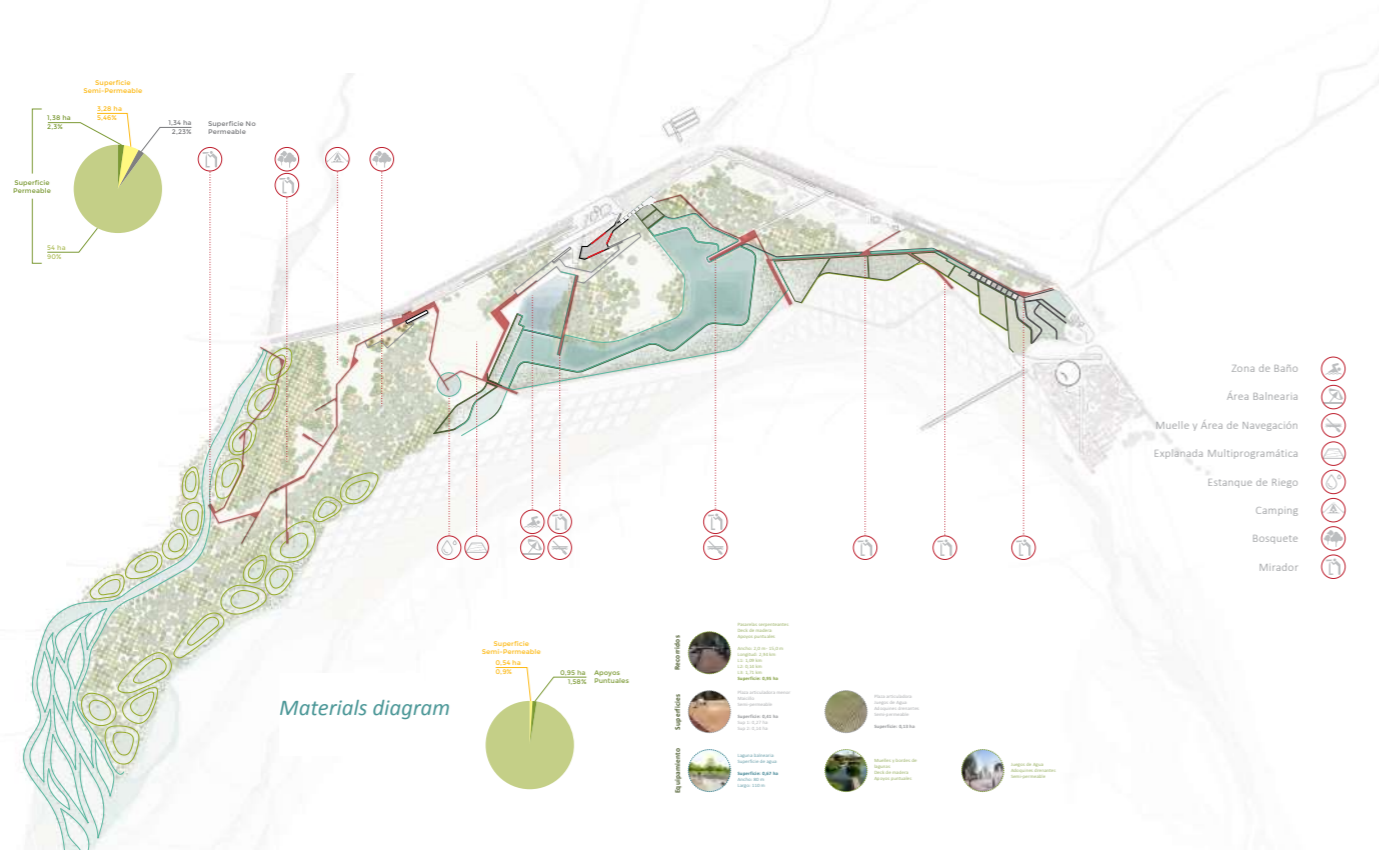

## Circulations

Programatic border | Streams and irrigation ditches

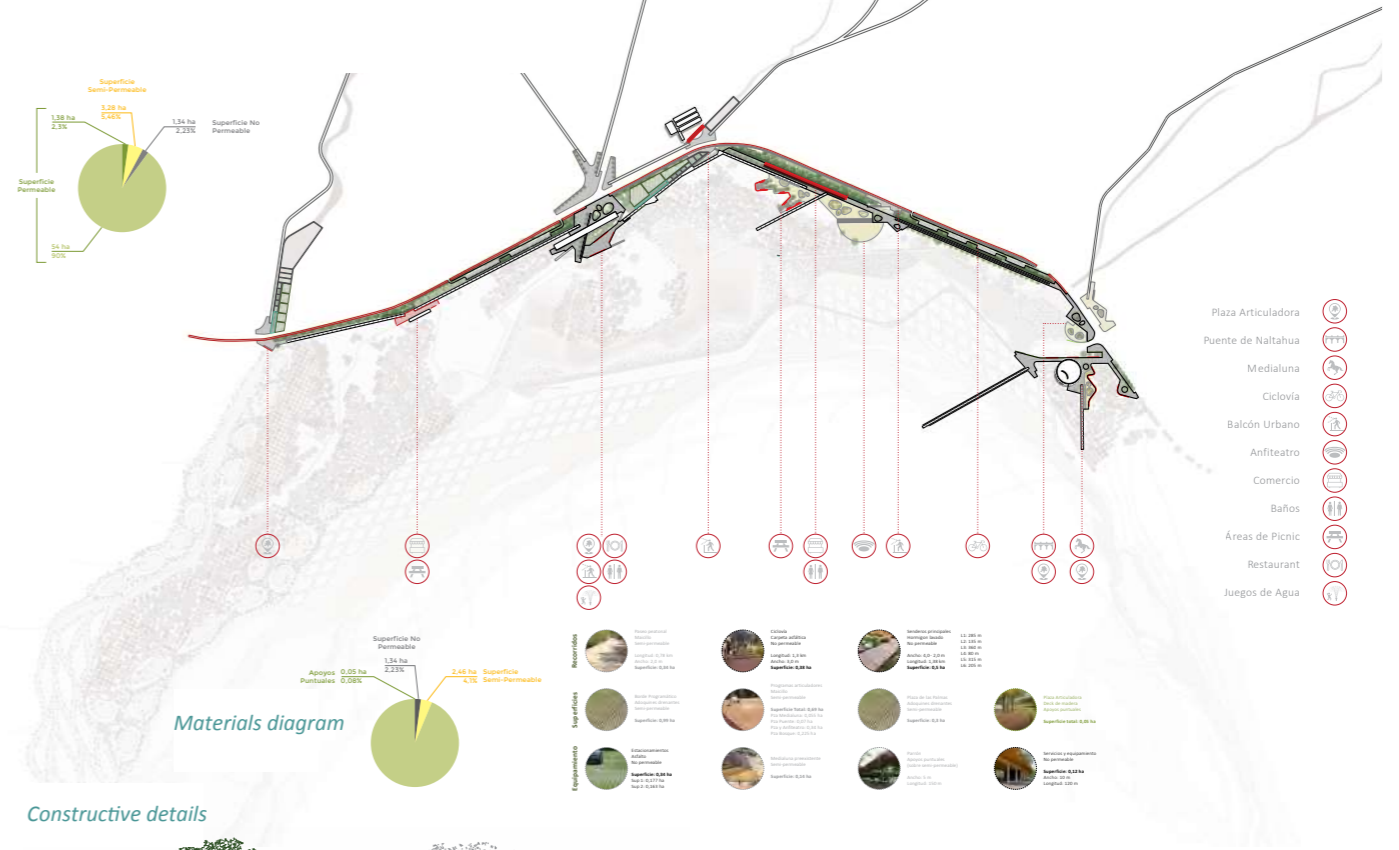

## Constructive details

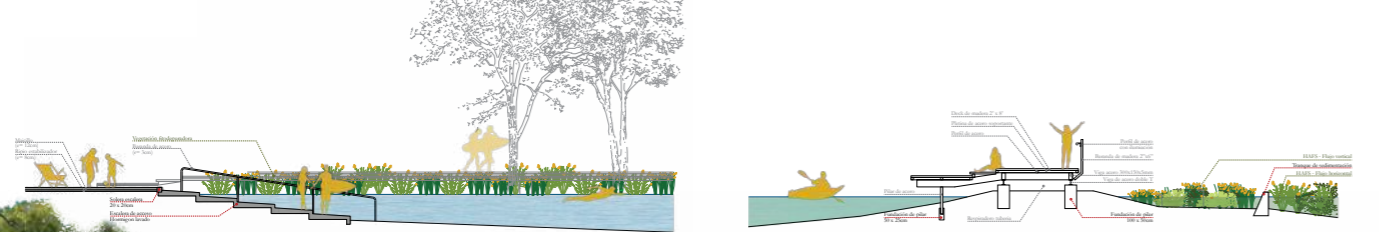

## Constructive details

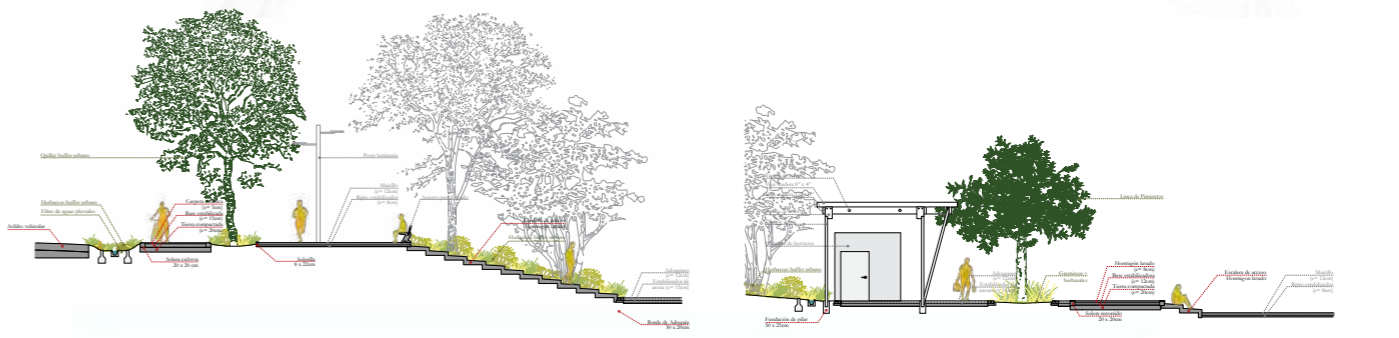



Country /City Chile, Santiago

University / School Pontificia Universidad Católica de Chile, Magíster en Arquitectura del Paisaje

Academic year 2022

Title of the project Landscape insertion operation projects as healing elements on the banks of the Bogotá River. River ridge: reunion with the water.

Authors Carlos Martínez

## TECHNICAL DOSSIER

<b>Title of the project</b>	Landscape insertion operation projects as healing elements on the banks of the Bogotá River. River ridge: Reunión with the water
<b>Authors</b>	Carlos Martínez
<b>Title of the course</b>	Graduation project workshop
<b>Academic year</b>	2022
<b>Teaching Staff</b>	Gloria Saravia Ortiz and Andrew Harris Diez
<b>Department / Section / Program of belonging</b>	Magíster en Arquitectura del Paisaje - MAPA
<b>University / School</b>	Pontificia Universidad Católica de Chile



### Written statement, short description of the project in English, no more than 250 words

The pre-Hispanic peoples understood the Bogotá River as a sacred element in their cosmogony, but the arrival of the Spaniards in the region in 1537 generated a conflict scenario where the accelerated urban, tourist and industrial growth has turned this landscape of water, in a degraded and battered one. A reading of the landscape is proposed through the creation of water catalogs and the insertion of projects that act as healing elements.

The Camellón del río project: reunion with water, establishes a new pedestrian connection between the urban area of Tocaima and the Bogotá River, as a reconciliatory act between human beings and water. Through the reconnection of different sections that today are understood as separate elements, creating a route that connects the municipality with the river. The project speaks, but in a low voice, and leads to the riverbank, in order to have contact with it, to make it visible.

Through a detailed analysis of the landscape where it is inserted, the project is understood as one that has two moments: One dry and one wet. This duality proposes the story of water as the guiding thread of the entire proposal, through a rainwater management system of canals and flood protection rods, as well as seasonal gardens and the revaluation of the trade of cane basketry as an ancestral practice. A line, a single gesture, a healing act.

For further information

**Máster d'Arquitectura del Paisatge - UPC**

Contact via email at:  
master.paisatge.comunicacio@gmail.com

biennal.paisatge@upc.edu

**Máster d'Arquitectura del Paisatge - UPC**

Sede ETSAB - Universitat Politècnica de Catalunya

Calle Jordi Girona, 15. Edificio Omega 1-3  
08034 Barcelona - Spain

COAC - Colegi oficial d'Arquitectes de Catalunya

Carrer Arcs, 1-3  
08002 Barcelona - Spain

**12th International Biennial Landscape Barcelona**

**Barcelona November 2023**

**SCHOOL PRIZE**

Urgent sanitary action: River ridge | Reunion of Tocaima with the Bogotá river / Project plan



Dry season

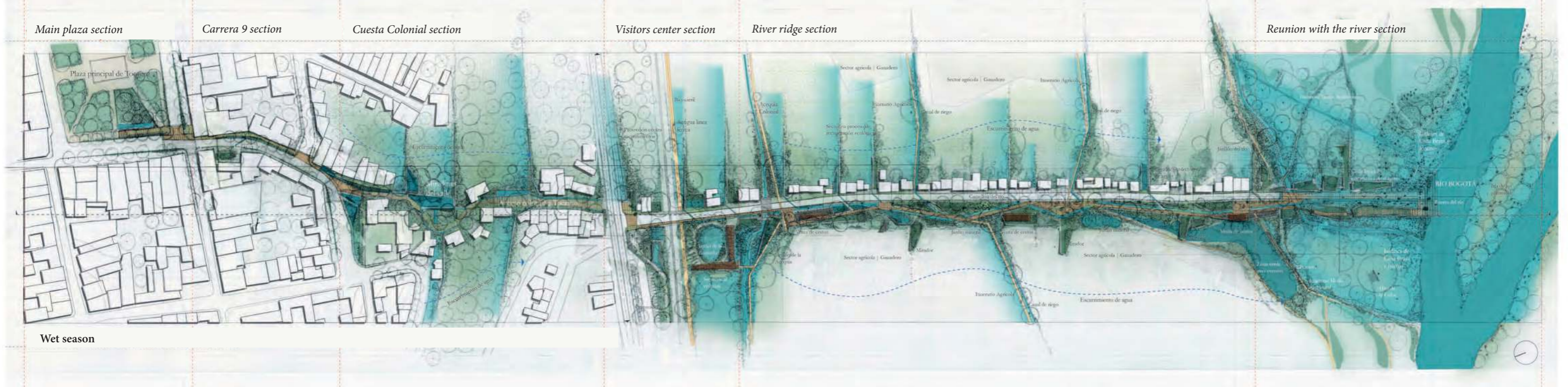

Wet season

Main plaza section

Carrera 9 section

Cuesta Colonial section

Visitors center section

River ridge section

Reunion with the river section



Constructions



Water



Rocks



Trees

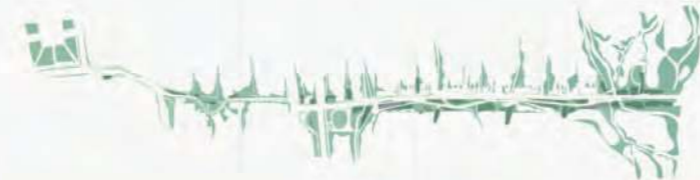

Gardens

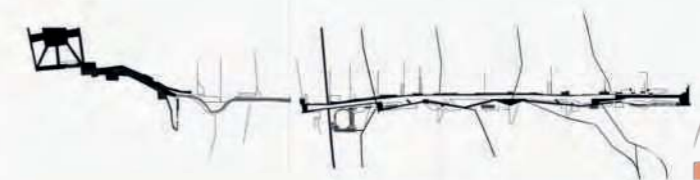

Ground and pavements

SECTION A-A'

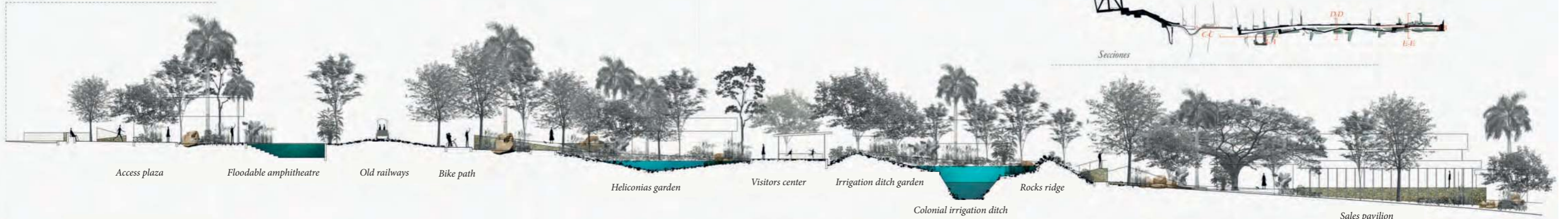

SECTION B-B'

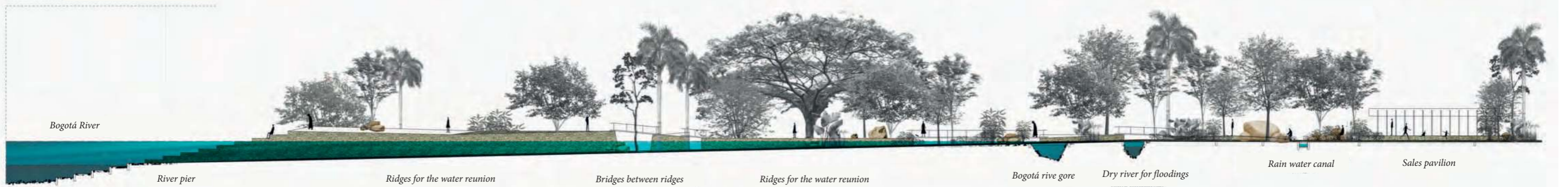

SECCIÓN C-C'

Vista general sector ancho del Camellón

Camellón del reencuentro con el agua





REUNION WITH WATER



RIVER FRONT PROMENADE

Malecón del río, reencuentro con el agua es un proyecto que va de menor a mayor, del hilo de agua más tenue en la plaza central, al río Bogotá. De la roca más chibca del suelo suelto, pasando por las piedras medianas, las lajas y, finalmente, a las topografías, que a la manera de rocas gigantes elevan al visitante del suelo. Ese ir y venir entre escalas permite momentos de inflexión, de reflexión sobre lo que sucede, sobre dónde estamos.

*"El agua no tiene principio ni fin. Al nacer la mano a un río estamos, retornando a nuestro punto de origen, atravesamos ennes y rocas en el instante primordial, inconcebiblemente lejano en el tiempo, en que los cuerpos celestes, quejidos en forma de cometas congelados, entraron en colisión con la Tierra y trajeron el aliento de la vida a un planeta yermo y solitario, que giraba en el vacío terciopelo del espacio."*

Margherita Wadi Daris

Topography



Gardens



Elevated places



Plazas

Trails through shadows

Sacred trail



Algunas partes de Malecón del río - Sección sinilar a la señal y canal central | ESC 1:200