



Country /City UK / London
University / School University of Greenwich / School of Design
Academic year 2023 - 2024
Title of the project A Giant, Two Serpent's and The Girls: Going to Ground with Grief in a Time
Authors Gemma Hoult

TECHNICAL DOSSIER

Title of the project	A Giant, Two Serpent's and The Girls: Going to Ground with Grief in a Time
Authors	Gemma Hoult
Title of the course	Master of Landscape Architecture (MLA)
Academic year	2023 - 2024
Teaching Staff	Emma Colthurst and Honoré van Rijswijk
Department / Section / Program of belonging	Landscape Architecture and Urbanism
University / School	University of Greenwich / School of Design



Written statement, short description of the project in English, no more than 250 words

This year we have been investigating how landscapes can be redefined through collective practices, this has been framed in multiple ways. We have been engaging with human and more-than-human beings, with materials, policy and environments to speculate on how collective, situated and radical landscape practices can bring about change.

A Giant, Two Serpent's and The Girls proposes a radical reworking of how we can process grief in collaboration with our landscapes. Situated in South-east London and within a possible climate future of the Gulf Stream collapsing, the project draws on the ancient dialogue between mythmaking and landscape to explore how grief both personal and collective can be liberated from the static dimensionality of cemeteries, and re-spatialised into the public realm. To activate the project, *A Giant, Two Serpent's and The Girls* uses stories and storytelling as a collective practice to develop emotional, social and spatial responses to the ecological crisis we are facing. These responses are drawn from the subtle physicality of the site, the water, the undulating topography, the bedrock, the atmosphere and the distribution of human and non-human beings, and provide spaces and moments where the community can come together to act out their grief within the landscape, allowing this intimate practice to shape their surroundings.

For further information

Máster d'Arquitectura del Paisatge - UPC

Contact via email at:
master.paisatge.comunicacio@gmail.com

biennal.paisatge@upc.edu

Máster d'Arquitectura del Paisatge - UPC

Sede ETSAB - Universitat Politècnica de Catalunya

Calle Jordi Girona, 15. Edificio Omega 1-3
08034 Barcelona - Spain

COAC - Colegi oficial d'Arquitectes de Catalunya

Carrer Arcs, 1-3
08002 Barcelona - Spain

12th International Biennial Landscape Barcelona

Barcelona November 2023

SCHOOL PRIZE

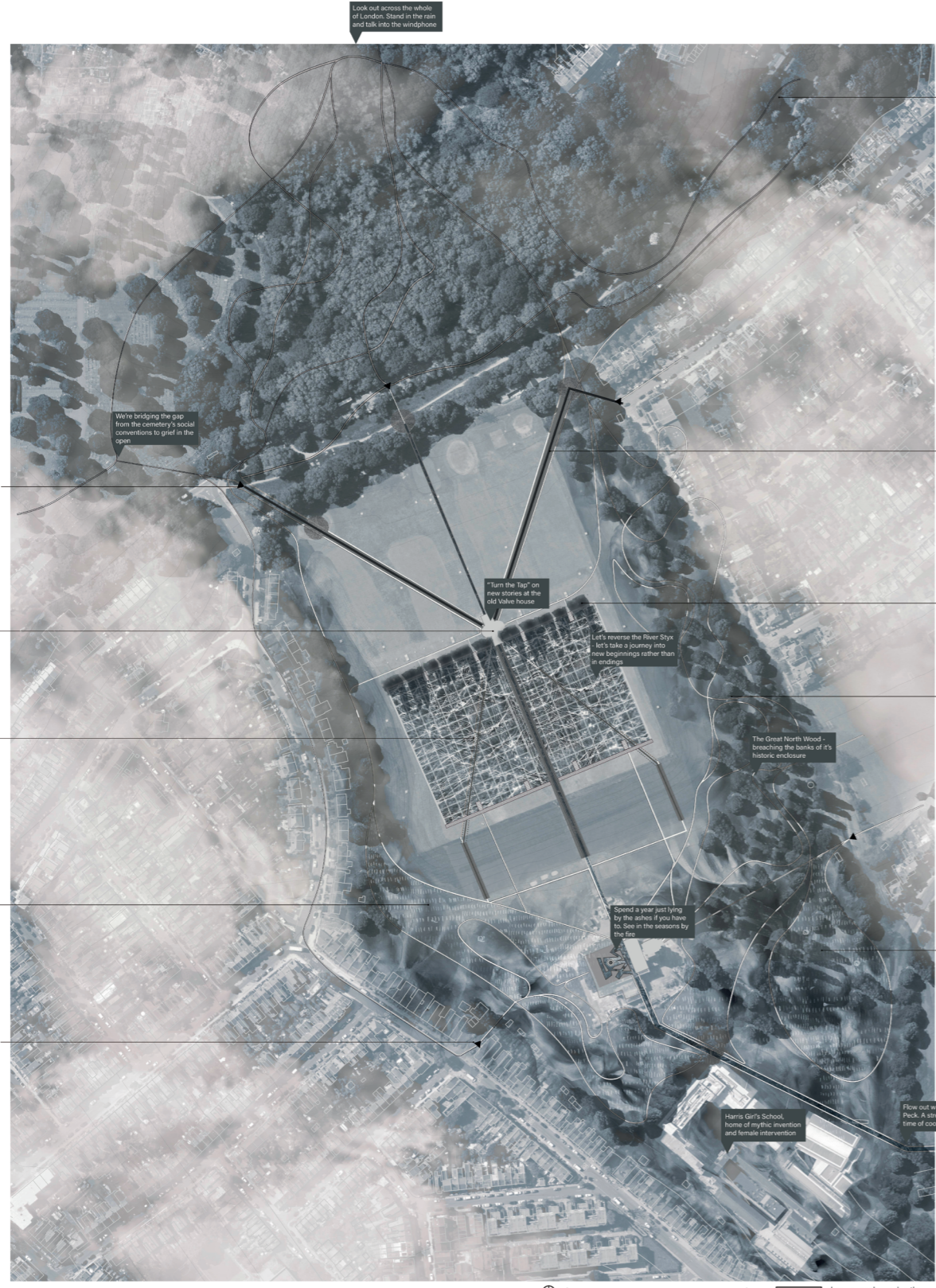

Let's have a look at how we can return to the land. Where the space for all to grieve, and time for all to comprehend it.

For sorrow (English proverb for magpies)

- decomposed gravel path
- dirt path
- cutting
- contained water
- access
- covered route
- boat route
- wooden decking + pontoons
- Trees and vegetation - inc. Quercus spp, Acer spp, Corylus avellana and
- water formed landscape - inc. meandering streams, migratory marshes and pooling springs.

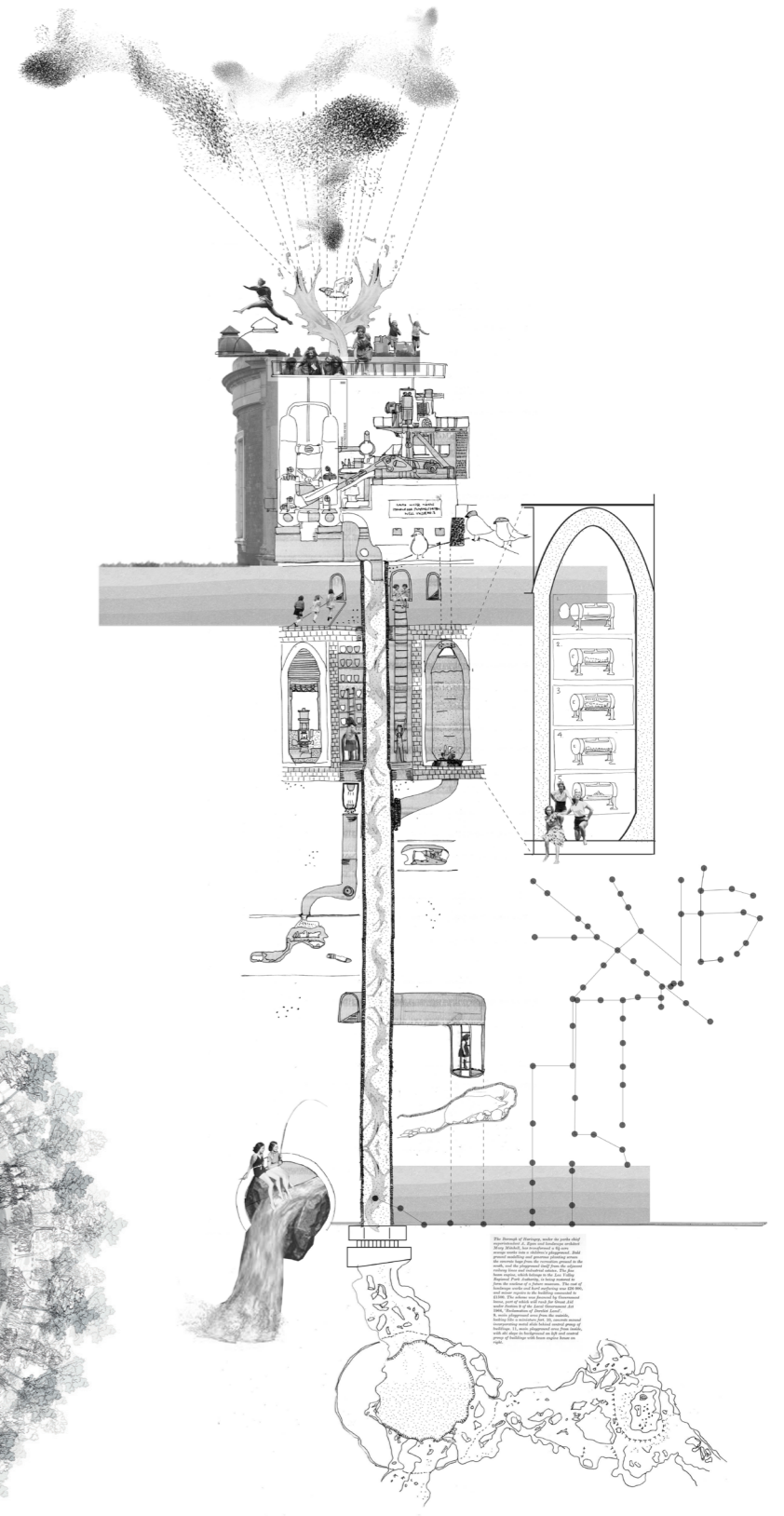
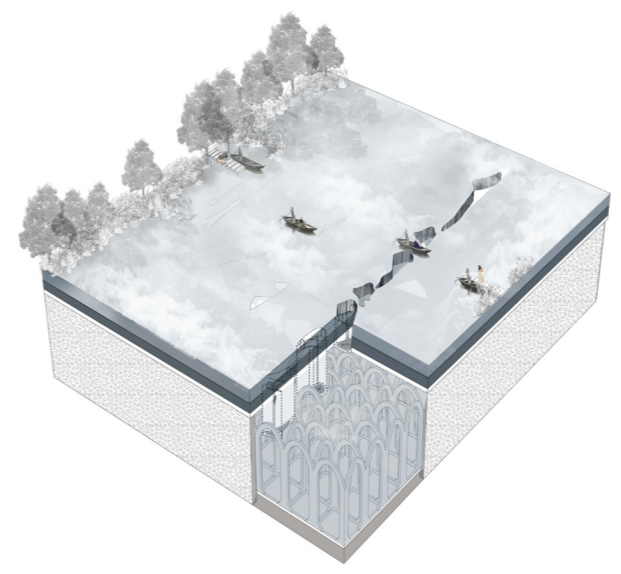

For A Moment the Clouds Parted

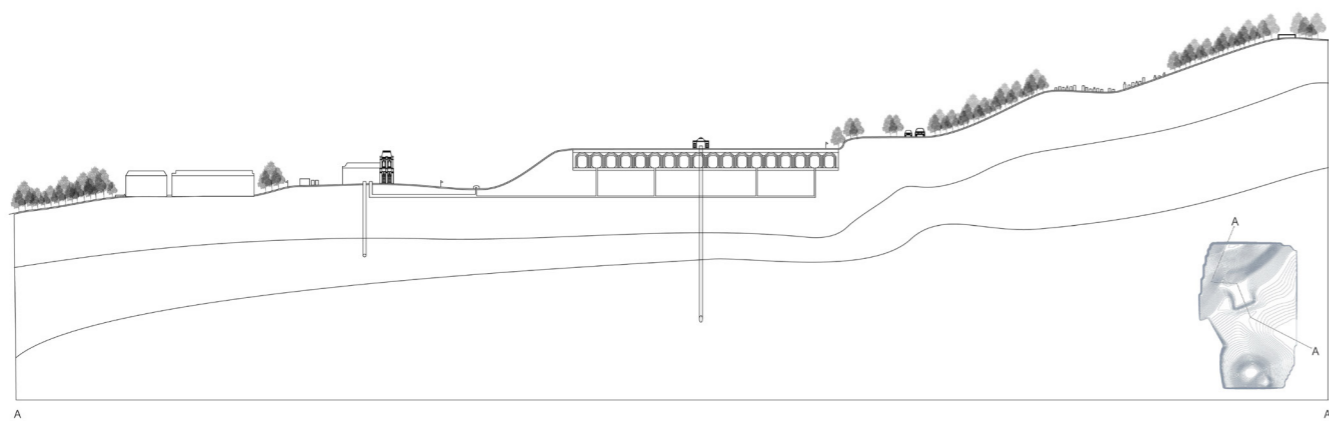
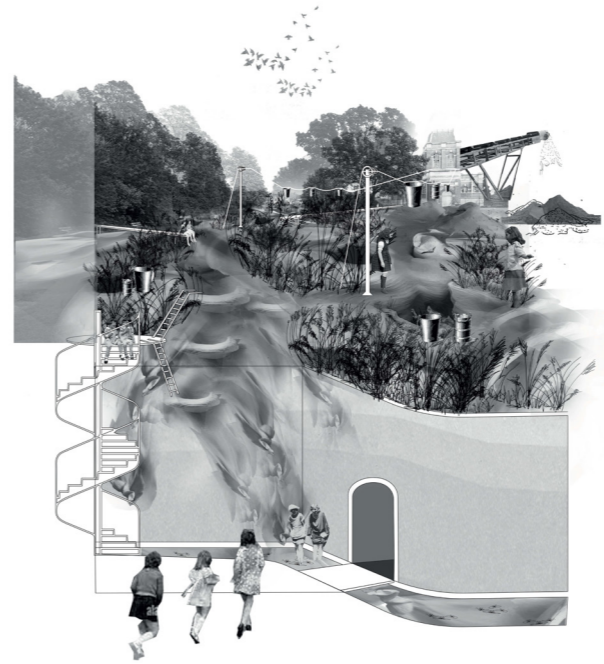
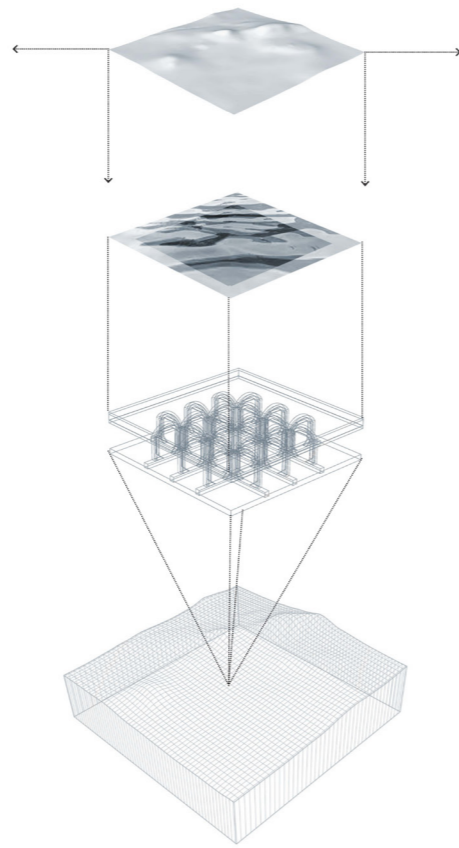

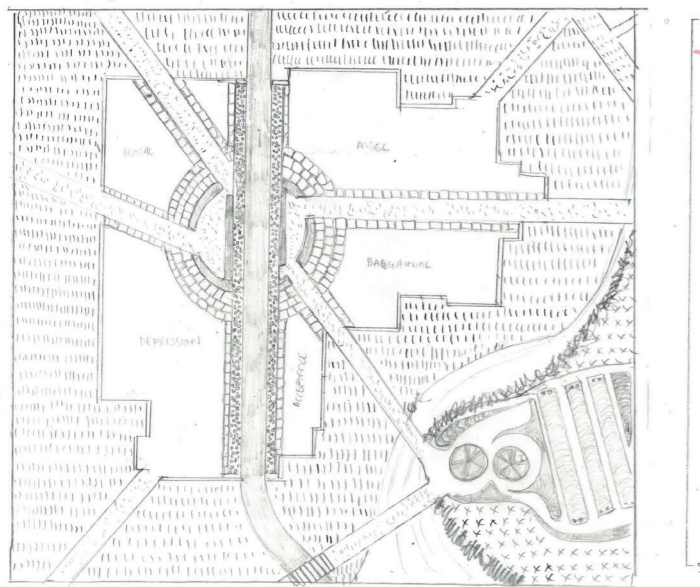
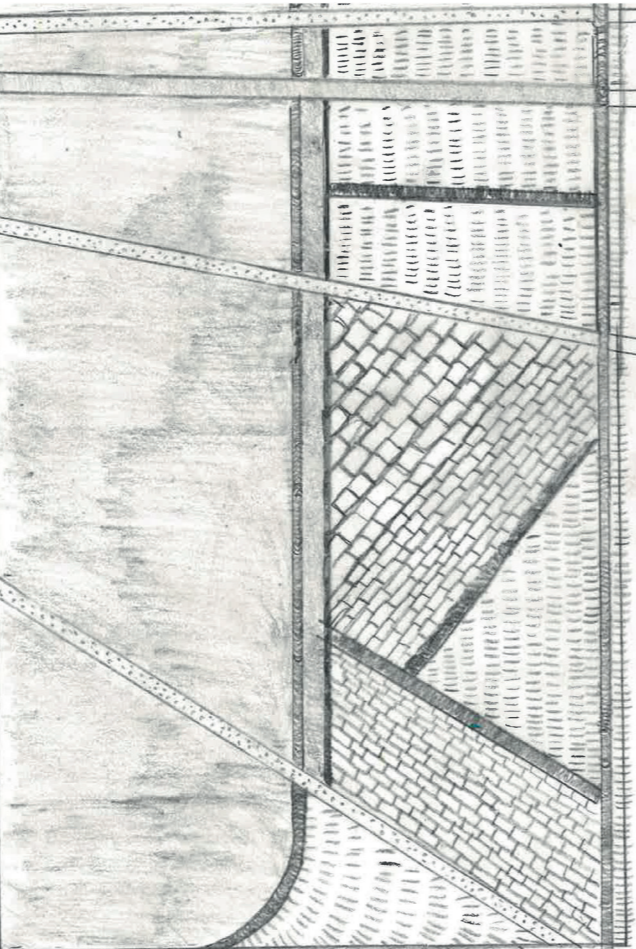
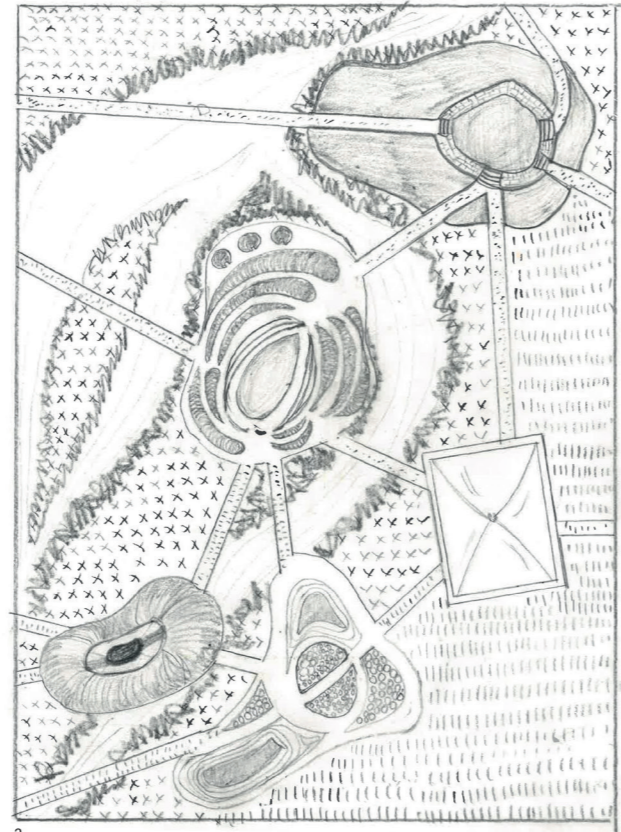
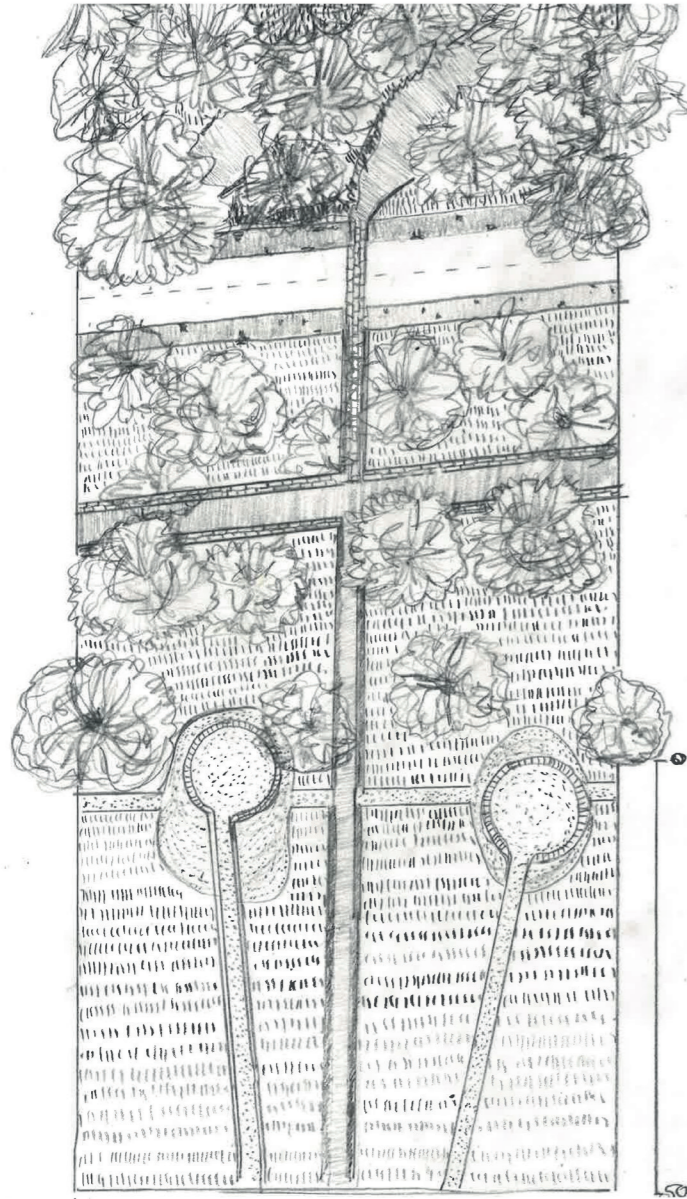

1. entering the site through geometric initiation
2. parametric zoning amongst the shifting marshland
3. ash vs. brick, clay vs. water, channeled vs. generative
4. layering brickwork, cutting earth

SLEEPING

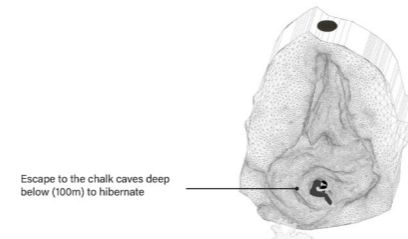

Escape to the chalk caves deep below (100m) to hibernate

LYING

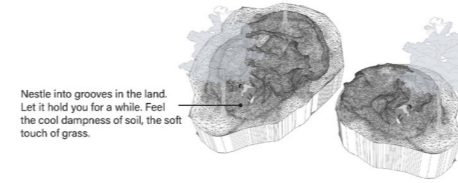

Nestle into grooves in the land. Let it hold you for a while. Feel the cool dampness of soil, the soft touch of grass.

SITTING

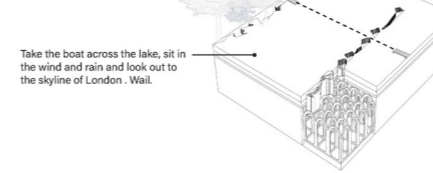

Take the boat across the lake, sit in the wind and rain and look out to the skyline of London. Wait.

STANDING



Stand in the elements and call out in the wind. Scream!

WALKING

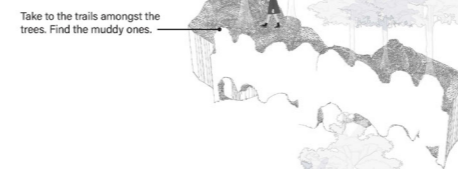

Take to the trails amongst the trees. Find the muddy ones.

TALKING

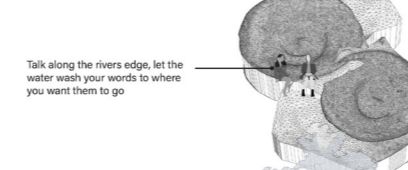

Talk along the rivers edge, let the water wash your words to where you want them to go

LISTENING

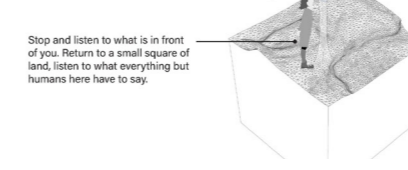

Stop and listen to what is in front of you. Return to a small square of land, listen to what everything but humans here have to say.

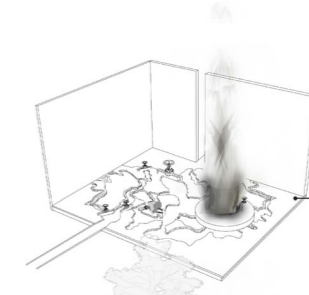

Lie with the ashes for a while

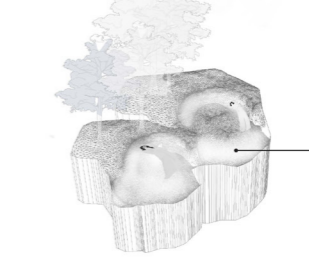

Submerge yourself in pools of lyre (water and ash)

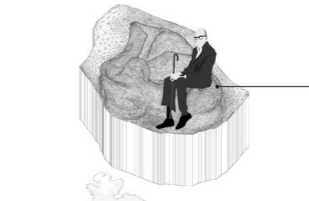

Site for a while on a bench that is sculpted directly from the earth

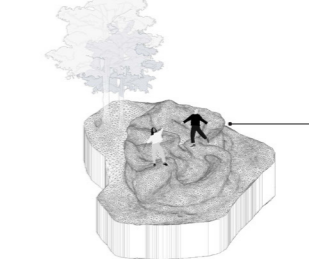

Stand on the river banks and watch the water flow by, get lost as the light dances on the surface

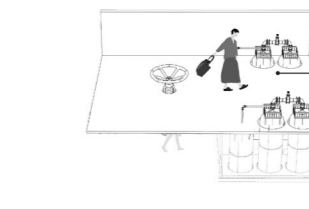

Walk amongst the infrastructure. It's okay to feel small here.



Talk to strangers. Sometimes it's easier than talking to friends.

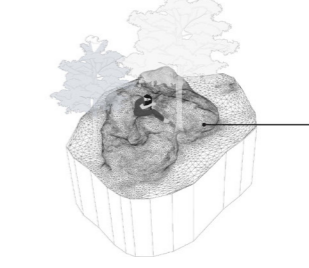

Listen to big things in small places. Listen to your emotions for a little while.