

echoes of Yedikule: a journey through ecofeminist spatial justice

The walls, once symbols of defense and boundaries, now felt like barriers, creating an isolating atmosphere.

'care is absent'

this sense of **insecurity** is not just personal—it is structural, historical, and gendered.

dichotomy—the very separation that **ecofeminists critique**, where spaces are either controlled and protected or left to decay.

The act of **fencing off** an area isolates it not only from people but also from the potential for ecological regeneration or human connection.

As neighborhoods experience **gentrification**, urban transformation, this spatial exclusion creates a sense of displacement + insecurity.

echoes of Yedikule: a journey through ecofeminist spatial justice

collective space is the new public space.

+ in a need of care the walls are not isolated but became a part of the daily life of the community.

'care is maintained'

+ **flexible spaces**, integrating the idea of community dominancy, spaces that can be defined to their usage.

+ promoting **bostans**, integrating the daily life ecofeminist practices to create communal resiliency.

+ along the walls, isolated spaces turn into the spatial transformation creates an **ecofeminist route**.

'How can care as a principle of ecofeminism, be embedded not just in the built environment but also in urban policies, practices, and daily life routines within Yedikule?'

'What role can nature play in fostering not just environmental resilience but also social cohesion and healing in Yedikule, after the trauma of displacement / disaster?'

Readings: Leslie Kern--Feminist City

Country/City Turkey, İstanbul
University / School İstanbul Technical University
Academic year 2024-2025
Title of the project Landscape Design IV
Authors Simay Habiboğlu

TECHNICAL DOSSIER

Title of the project	Detoxifying Yedikule through <i>[eco]feminism</i>
Authors	Simay Habiboğlu
Title of the course	Landscape Design IV
Academic year	2024-2025
Teaching Staff	Prof.Dr. Hayriye Eşbah Tunçay , Res.Asst. Mürsit Sönmez
Department / Section / Program of belonging	Landscape Architecture
University / School	Istanbul Technical University



Written statement, short description of the project in English, no more than 250 words

*Rooted in **ecofeminism***, the project considers urban design as a tool that fosters ***care, inclusivity and resilience***, focusing on healing historical divisions and promoting social equality. While preserving the ***urban memory***, it integrates ecological restoration with the strengthening of the existence of marginalized communities and women+ in Yedikule. By reinterpreting 'care' as both a social and environmental responsibility, the project aims to reconstruct the connections between people, space and nature, with a 'resilient' society and city ideology formed with this new fiction, capable of resisting any disaster, supporting collective unity, safe, It aims to create accessible and resilient urban spaces. The design strategies developed for this purpose question and redefine the past/contemporary characteristics of Yedikule from an ecofeminist perspective. It re-evaluates the concept of a durable and resilient city from an ecofeminist perspective by passing the reasons for social/spatial distinctions through the filter of history/present day and developing the 'collective space' construct developed by the reflection of ecofeminist practices on daily life in Yedikule. and it all comes to the discourse: ***'Collective space is the new public space.'***

Barcelona International Landscape Biennial

Contact via email:
biennialadm@coac.net

Venue:
COAC - Col·legi Oficial d'Arquitectes de Catalunya
Carrer Arcs 1-3, 08002 Barcelona - Spain

*detoxifying Yedikule through *[eco]feminism*

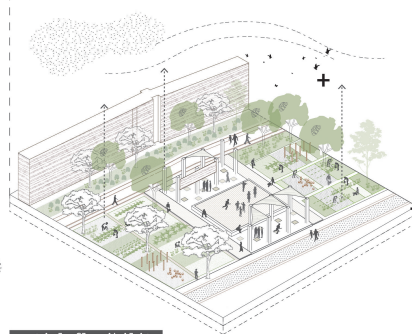

spatial flexibility

flexibility of the space offers to user to functionalize the space linked to ecofeminist idea on urban specialization. dynamic usage of the space gives offers to users, creating connections with communal gardens.

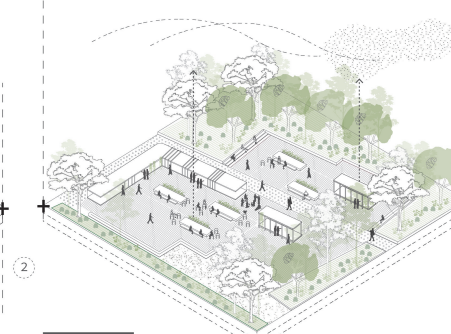

*co-kitchen

food production is an element of Yedikule as an act based on the ecofeminist idea works as an urban policy for providing communal resiliency. Linked to the local activities with the street market place.



communal garden relations

as a ecofeminist strategy, integrating proposed bostans, communal gardens, with existing bostans, emphasizes continuity, community, and ecological+ communal resilience. Generalize daily ecofeminist practices.

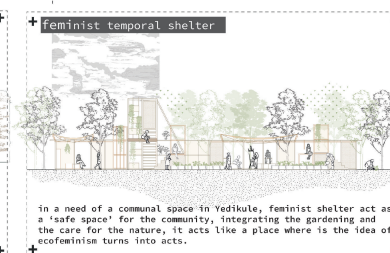
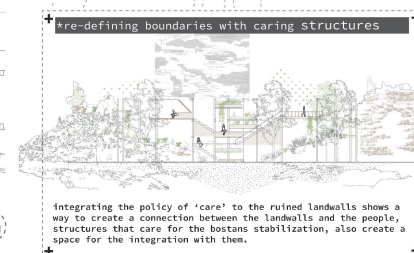
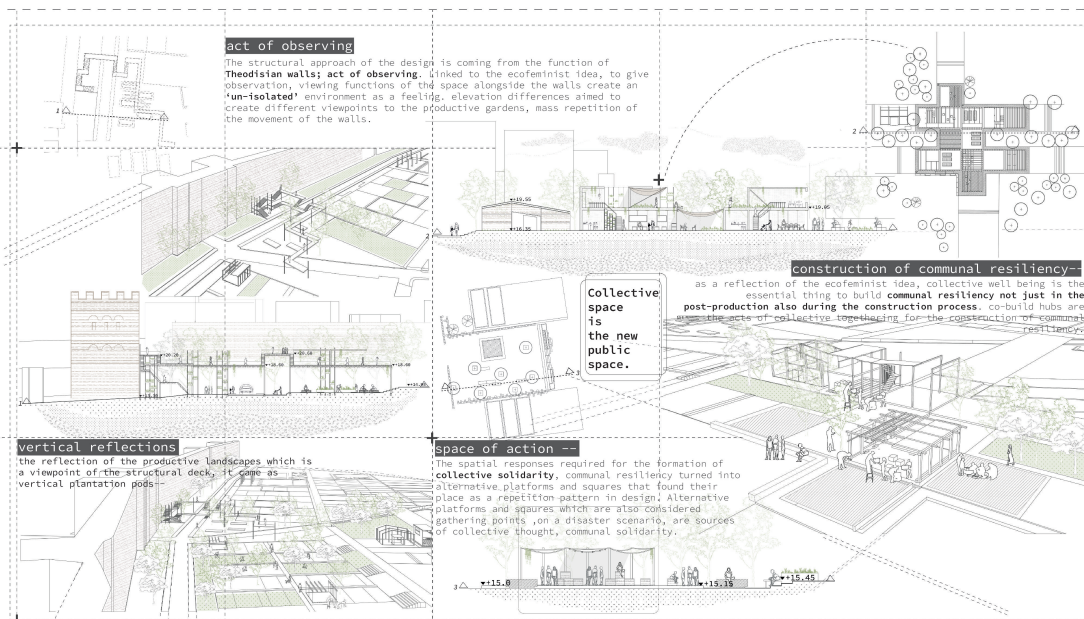
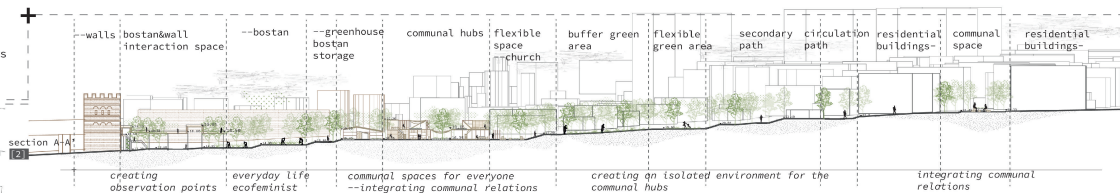

Design Led-Questions

Is it possible to create a design works for both the contemporary situation + post disaster scenario?